

CEMETERY

BOND SUPPORT

The Community Councils of both Chugiak/Eagle River and Girdwood support a proposed \$11 million bond initiative that increases capacity of Anchorage's current and only public cemetery. Engaged stakeholders worked with the Heritage Land Bank to identify and plan for additional local cemeteries. Throughout the documented public process, community members supported the analysis, including land management and environmental considerations.

Moving forward with this combined and supported bond initiative, these communities request your support by approving a Spring 2023 Bond.



BOND INITIATIVE COST ESTIMATES

Anchorage Memorial Park's required renovations are estimated at \$3 million.

Girdwood's cemetery cost estimate is \$5 Million.

Chugiak/Eagle River's chosen cemetery site development is estimated at \$3 million.

PUBLICLY
AVAILABLE
INFORMATION
An abridged list



[Anchorage Memorial Park](#)



[Girdwood Cemetery Committee](#)



[Chugiak/Eagle River Cemetery Update](#)



[Cemetery Selection Presentation](#)

HISTORY 2015

68% of Girdwood's voters voted to tax themselves for the cost of establishing and maintaining a cemetery. Girdwood and the Heritage Land Bank identified a parcel to study.

ANALYSIS 2016-2019

Girdwood Cemetery Committee presented to the public a Feasibility Study, a Master Plan Analysis Report, and a Schematic Report detailing the proposed cemetery's four phases.

FORECASTING 2020

Anchorage Daily News reported on June 22, 2020, that the Anchorage Memorial Park, established in 1915 and our only public cemetery, would run out of space for public burials by 2027.

SELECTION 2021

Combined community councils in both Eagle River/Chugiak and Birchwood selected a proposed cemetery site in Eagle River.

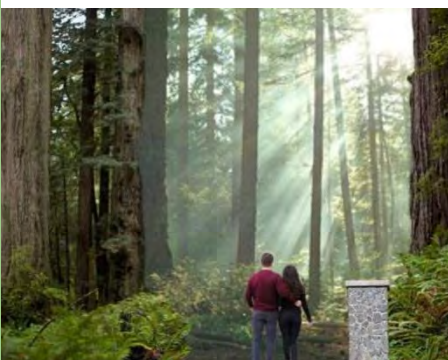

"People want to be buried at home. For many, Alaska is home. Prepare a space for yourself and loved ones by supporting this bond."

Tommy O'Malley
Girdwood Cemetery Committee Chair

Figure 10 – Girdwood Cemetery Phasing Plan

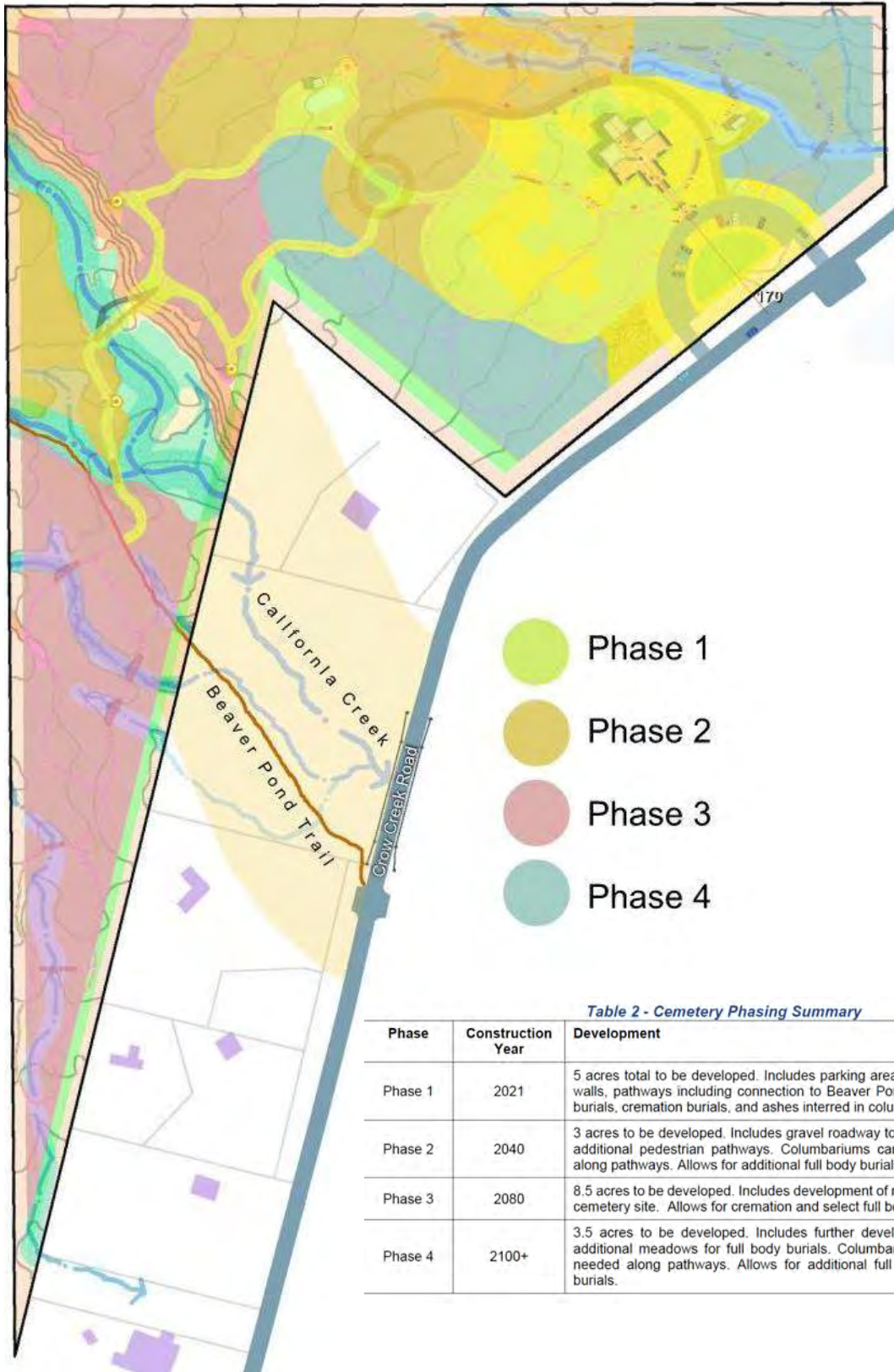

Table 2 - Cemetery Phasing Summary

Phase	Construction Year	Development
Phase 1	2021	5 acres total to be developed. Includes parking areas, shelters with columbarium walls, pathways including connection to Beaver Pond Trail. Allows for full body burials, cremation burials, and ashes interred in columbarium
Phase 2	2040	3 acres to be developed. Includes gravel roadway to northwest portion of site and additional pedestrian pathways. Columbariums can be constructed as needed along pathways. Allows for additional full body burials and cremation burials.
Phase 3	2080	8.5 acres to be developed. Includes development of remote southern portion of the cemetery site. Allows for cremation and select full body burials
Phase 4	2100+	3.5 acres to be developed. Includes further development of the site including additional meadows for full body burials. Columbariums can be constructed as needed along pathways. Allows for additional full body burials and cremation burials.

8. Cost Estimate

The following table summarizes project costs per phase. Detailed cost estimates are included in Appendix B.

Table 3 - Summary of Estimated Project Costs

Description	Estimate
Phase 1	
Parking Area and Vehicle Access	\$500,000
Central Activity Area	\$660,000
Storage Yard	\$15,000
Pedestrian Walkways and Fencing	\$405,000
Meditation Areas	\$40,000
California Creek Bridge	\$250,000
Columbariums/Cenotaphs	\$500,000
Subtotal:	\$2,370,000
Construction Contingency (25%)	\$595,000
Engineering and Construction Management (35%)	\$830,000
Permitting	\$200,000
Total for Phase 1	\$3,995,000
Phase 2	
Gravel Roadway	\$50,000
Pedestrian Walkways	\$115,000
Subtotal:	\$165,000
Construction Contingency (25%)	\$41,000
Engineering and Construction Management (35%)	\$58,000
Total for Phase 2	\$264,000
Phase 3	
Pedestrian Walkways	\$355,000
Subtotal:	\$355,000
Construction Contingency (25%)	\$89,000
Engineering and Construction Management (35%)	\$124,000
Total for Phase 3	\$568,000
Phase 4	
Pedestrian Walkways	\$200,000
Subtotal:	\$200,000
Construction Contingency (25%)	\$50,000
Engineering and Construction Management (35%)	\$70,000
Total for Phase 4	\$320,000
Grand Total:	\$5,147,000

Suggestions for the Q&A:

- **Doesn't Girdwood already have a cemetery?** Girdwood had a cemetery that was closed? disturbed? damaged? after/in the 1964 earthquake; burials were moved to the cemeteries in Hope and Sunrise. Girdwood doesn't currently have a cemetery.
- **Why does Girdwood need a cemetery?** Cemeteries provide a sense of history and permanence to the people who live here and for future generations of residents and visitors. Girdwood is a place that people think of as "home", is a place that many people who don't live here love, and is a place that people have expressed a desire to be buried or memorialized at. There is a great need for public cemeteries in the Municipality. It is estimated that the public portions of the Anchorage Memorial Park Cemetery will be full in less than 7 years.
- **Where will the cemetery be located?** The Municipality's Heritage Land Bank offered several pieces of land, and the Cemetery Committee selected the site at MP.5 on Crow Creek Road, opposite the school bus turnaround. The site is undeveloped, mostly forested land.
- **What type of cemetery will this be?** The Girdwood Cemetery Committee and our engineering firm are dedicated to retain as much of the wild character of the current setting as possible. Forested areas will remain, alder meadows will be replaced with grassy meadows. Looping trails and paths will weave between the various burial areas. The structures that are built will be consistent with our community's forested character and grounds-keeping will be minimal and low maintenance.

The cemetery will be a quiet place for reflection, grieving, celebration, and honoring of the deceased. The cemetery will be an inclusive public space available to all religious denominations and spiritual communities.

The Girdwood Cemetery will offer a variety of types of burial and disposition of human remains:

- green or natural burials: green or natural burials are full body interments into the ground in a manner that does not inhibit decomposition. They do not include a vault, use non-toxic body preparation methods, and use containers made of organic materials, including shrouds. Green or natural burials protect worker health, reduce carbon emissions, conserve natural resources, and preserve habitat.
- conventional burials: conventional burials may include the use of burial vaults, burial containers made of non-organic materials, and bodies prepared using embalming chemicals
- burial and placement of cremains: the cemetery will include locations for cremains (cremated remains) to be buried, a columbarium structure for the placement of urns with cremains, as well as an area for cremains to be spread. All of these options will include a plaque or other marker to commemorate those who are interred, placed or spread there.

Commented [A1]: Not sure what is most accurate here?

Commented [A2]: Will it necessarily be the same firm from now until construction begins? Can we just say the Committee and the Muni, or something?

Commented [A3]: Is 'replaced' the right word? Are we really going to cut them down and plant grass? Or will we just cut alders as needed, which will then grow back with grass?

Commented [A4]: This Q/A removed because Muni code currently prohibits animal burials in Muni cemeteries. Group determined that pet burials (full body/cremation) is a good idea for this cemetery, but that we will have to address it, and the code issue, at a later date.

- **How long will the cemetery last?** The cemetery will be able to accommodate burials for over 100 years. The site will be maintained and managed as a cemetery forever.
- **How much will it cost?** Our Schematic Design includes multiple phases for construction (. The cost of phase 1 is approximately 4 million dollars and includes the majority of the infrastructure needed to open and operate the cemetery. These funds will be secured through an area wide bond.
- **How do we pay for this?** Cemetery services are an Areawide function of the Municipality of Anchorage. To build a cemetery, we will request a bond to be approved by Areawide voters in 2022. Eagle River is also currently working on a similar cemetery project. The two cemetery projects may be bonded together.
- **Who will manage the cemetery?** Cemeteries are managed by the Municipality of Anchorage's Department of Health. Snowplowing will be handled by Girdwood Valley Service Area.
- **Where can I find more information?** You can find more information about the cemetery and the Cemetery Committee on the Girdwood Board of Supervisor's webpage: www.muni.org/gbos
- **How can I get involved?** If you are interested in learning more or participating in ongoing planning for this project, please

Commented [A5]: Attend a CC meeting? Write a letter of support for this project to your Assembly member? Etc?

Eagle River Cemetery Site Selection Study

- Site Options and Preferred Sites
 - Analysis of Preferred Sites
- Site Utilization and Capacity Studies

February 4, 2021

Municipality of Anchorage
Heritage Land Bank

The Boutet Company

Jack Goodnoe – Cemetery Planning & Design



Yosemite Drive



200'

Eagle River High School

A-2
Air Photo with Topography

Hiland Mountain Correctional Center

Alaska Division of Forestry Maintenance Shop



Phase 2
4.7 acres
4,700 FB Burials

Phase 3
5.2 acres
5,200 FB Burials

Phase 1
7.7 acres
7,700 FB Burials

1 acre



200'

- Cemetery Development Units
- Non-Wetlands Flatland
- 100' Vegetation Buffer

060-041-25-000
Eagle River High School

A-2 Phasing Plan and Site Capacity

Total Buildable Acres = 17.6 acres
Total Capacity = 17,600 Full Body Burials

Jack Goodnoe - Cemetery Planning & Design

A-2

Phase 1
7.7 acres
7,700 FB
Burials



@ 25 Burials/yr.
1 acre
= 40 years of burial

E-4

Phase 1
5.3 Acres
5,300 FB
Burials



A-5

Phase 1
7.6 Acres
7,600 FB
Burials

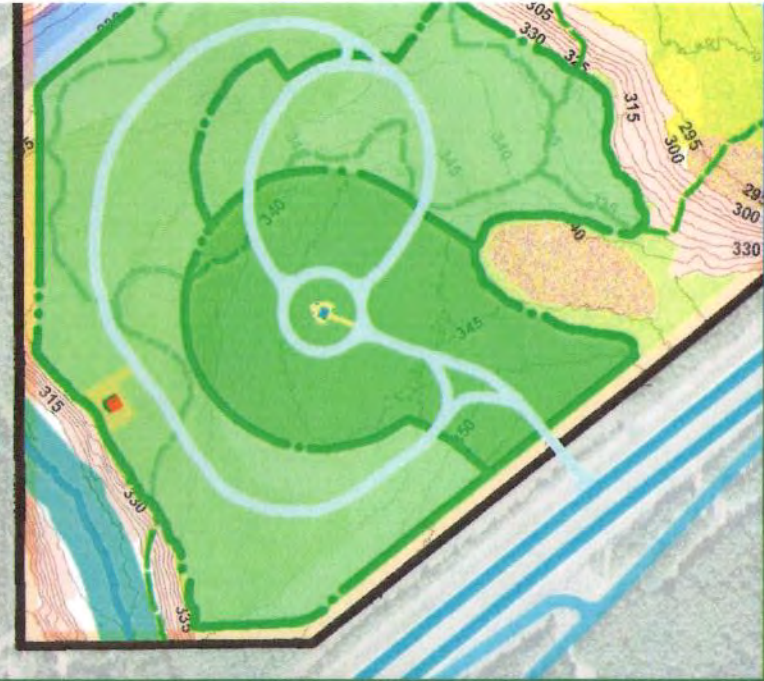

E-5

Phase 1
13 Acres
13,000 FB
Burials



TABLE 1

**Chugiak - Eagle River Cemetery
Site Selection Criteria Comparison Summary - MOA Properties**

+ = Known Positive
- = Known Negative
* = Additional Information Needed

A-2



A-5



	Site A-1:	Site A-2:	Site A-3:	Site: A-4	Site A-5:
Site Feasibility					
Parcel ID	051-361-500-00	060-031-39-000	051-011-52-000	051-011-44-000	051-011-69-000
Location	+ Harry McDonald Rd.	+ Yosemite Dr.	+ Camp Gorsuch Rd. (S)	+ Paradis Ln.	+ Mirror Lake Middle School
Ownership	+ MOA	+ MOA	+ MOA	+ MOA	+ MOA
Zoning	+ CE-PLI	+ CE-PCD	+ CE-PLI	+ CE-PLI	+ CE-PLI
Existing Use	+ Vacant	+ Vacant	* Edmonds/Mirror Lake Park	* Edmonds/Mirror Lake Park	* Edmonds/Mirror Lake Park
Adjacent Use	+ CE-B3, CE-PLI	+ CE_PLI, CE-PCD	+ CE-R7, CE-PLI, WS	+ CE-PLI, CE-R6	+ CE-TR, CE-PLI
Size (acre)	+ 29	+ 25	+ 38	+ 28	+ 235
Vehicular Access	+ Harry McDonald Rd.	+ Yosemite Dr.	+ Camp Gorsuch Rd.	+ Paradis Ln.	+ Paradis Ln.
Topography	+ Suitable	+ Suitable	* Approximately 25 suitable acres. Slopes north of Camp Gorsuch Rd leading to Edmonds Lake are unsuitable.	- Approximately 18 suitable acres. Slopes south of Paradis Ln are unsuitable.	+ Suitable
Positive Drainage/ Wetlands	+ No known flood hazard, wetlands or drainage issues	+ No known flood hazard, wetlands or drainage issues	* 1.5 ac within 100-yr flood area along Edmonds Lake.	- 5 ac within 100-yr Flood area along Edmonds Lake/Creek, 1.25 ac "A" wetlands along Edmonds Creek	* Edmonds Creek & Mirror Creek flow through the parcel. 12 ac "A" wetlands along Edmonds Creek, 17 ac "B" wetlands in near north P.L., 6 ac "B" wetlands between Edmonds Creek/ Mirror Creek, 1.5 ac "C" wetlands near S.E. corner.



Anchorage Memorial Park Cemetery White Paper

Planning beyond the first 100 years...

DRAFT

Robert G. Jones, Cemetery Director

September 2017



Municipality of Anchorage

Ethan Berkowitz Mayor

Anchorage Memorial Park Cemetery

Robert G. Jones Director

535 East 9th Avenue, Anchorage
(907) 343-6814 – JonesRG@muni.org

Department of Health and Human Services

Melinda Freemon, MS, LPC, CCS Director

825 L Street, Suite 410, Anchorage
(907) 343-4650 – FreemonML@muni.org

Anchorage Memorial Park Cemetery Advisory Board Members

Dianne Courtney

James Fero

Robert “Bob” Ferrell

Arni Thomson

James Zuke

TABLE OF CONTENTS

History	4
Background.....	3
The Changing Landscape of Anchorage Memorial Park Cemetery from 1915 to the Present	5
Problem Statement	6
Recommendations	6



Conclusion	7
Appendix.....	8
Cemetery Capacity	10
Cemetery Capacity Map	11
Executive Order, Alaska. Chugach National Forest	12
Signed: 31 August, 1915 – President Woodrow Wilson	
Executive Order, Alaska. Anchorage Town site	14
Signed: 10 April, 1918 – President Woodrow Wilson	
Photo – Decoration Day – 30 May, 1918 - Anchorage	16

Established in 1915, the Anchorage Memorial Park Cemetery serves as a beautiful setting for honoring those who have died in our community. With the current number of interments increasing each year, the cemetery is projected to be out of gravesite space for burials in the public sections of the cemetery by 2028.

The cemetery has a total of 17,525 gravesites, both public and private, and is running out of sites in the public areas for burials of adult caskets. Today 66% or 11,568 of the total gravesites are either occupied or reserved. Of the remaining 34% or 5,957, only 2,400 are available in the public areas. At the current burial and reservation rates, the public areas will reach capacity in just over 10 years or by 2028. When that occurs, at-need burial sites for adult caskets will no longer be available to the public and only reservations will be honored in the public areas.

The timeline for private areas reaching their capacity varies from 60 years for the Catholic Archdiocese of Anchorage to 300 years for the tract owned by the Loyal Order of the Moose #1534.

The Columbarium Wall is an outdoor above ground structure that offers families a year round option for interment for those who have chosen cremation. The Columbarium Wall was dedicated in 2003 and is designed with three differently sized receptacles or niches. The 3,861 niches in the wall can hold up to 9,243 urns. To date, 469 niches have been sold which equals 12% of the total space available. On average, families purchase 30 niches each year. If that trend continues, the Columbarium Wall niches will be available for the next 100 or more years.

Background

In 1915, the Anchorage Memorial Park Cemetery was established by President Woodrow Wilson’s Executive Order. The 22 acre cemetery includes gravesites, a Columbarium Wall, service buildings, the cemetery office and meeting room, roads, parking areas and landscaping features with



approximately 20 acres available for burials. In 1918, President Wilson authorized the sale of half of the cemetery's 20 Tracts (approximately $\frac{3}{4}$ of an acre each) to local organizations wishing to honor their deceased members. Of the 10 private Tracts that were sold, three now belong to the Pioneers of Alaska Igloo 15, two are owned by the Catholic Archdiocese of Anchorage, one each to the Benevolent and Protective Order of Elks, the Free and Accepted Masons Anchorage Lodge #17, Loyal Order of Moose #1534, and the American Legion Jack Henry Post 1. In 1951 six acres of unutilized cemetery property was conditionally sold to the Alaska Housing Authority for the Willow Park apartment buildings. The Municipality was designated as the managing agency of the cemetery in 1979. The Willow Park apartments were demolished in 1991 and the property reverted back to the cemetery adding 4,500 gravesites.

Annually, the cemetery conducts an average of 175 burials in the public Tracts. In addition, the Cemetery Director receives reservations for approximately 50 more gravesites. Those arrangements take 225 gravesites off the list of available public sites. Private Tract burial rates vary from group to group. The Catholic Archdiocese of Anchorage averages 12 burials a year while the Loyal Order of the Moose #1534 averages 1 burial a year. Occupancy (burials and reservations) rates in the private Tracts also varies. The Catholic Archdiocese of Anchorage Tract is at 52% of capacity and the Loyal Order of Moose #1534 Tract is currently at 23% of capacity.

The Anchorage Memorial Park Cemetery Advisory Board was established in 1991. The Advisory Board reviews the operation of the cemetery and makes recommendations to the Administration, and to the Cemetery Director regarding the revision of rules and regulations for cemetery services. Since its inception, the Advisory Board has recommended numerous improvements to the cemetery. One of the most significant improvements includes the installation of the wrought-iron fence around the perimeter of the cemetery as well as the Columbarium Wall and the purchase and installation of a carillon bell tower.

In 1993 the cemetery was listed in the National Register of Historic Places. The cemetery internet website was established in 1999 and formal mapping of the graves was added in 2001. In 2006 the cemetery installed an underground irrigation system and shortly thereafter, a well was added to the system. This addition saved thousands of dollars in utility costs every year.

In 2009 local volunteers created the Cemetery Stories tour. In addition, the John Bagoy Solstice Tour is offered during the summer months and both events have brought positive attention to the unique individuals interred in the cemetery. These public education events have remained very popular for both visitors and residents.

In 2013 the cemetery was one of first in the nation to embrace Quick Response (QR) codes utilized with mobile devices as a way to enhance the memorialization opportunities for families with online obituaries, photos and guest books. In 2014 with the Advisory Board's support, and with the Anchorage Assembly's approval, the prohibition against upright markers in Tracts A & B was



reversed. This change in policy allowed families to install above ground markers and provides an opportunity to locate the gravesites in the winter months which is not possible with flat markers.

The 2015 centennial celebrations were capped off with the “burial” of a 100 year time capsule with items from the Municipality, Tract holders, business partners, board members and friends. In 2016 the cemetery was selected as the fifth cemetery in the nation to receive the Tears Foundation Angel of Hope monument. The Angel of Hope monument allows families grieving the death of an infant to memorialize their child by having their child’s name carved into a wing of the angel. In 2017 the Anchorage Parks Foundation began a campaign to raise funds for an electronic carillon bell tower as an enhancement to the cemetery. The new bell tower and seating area will serve the cemetery visitors and neighboring community with beautiful music and enhance the spirit of the cemetery as its new, iconic landmark.

The Changing Landscape of Anchorage Memorial Park Cemetery from 1915 to the Present

Burial requirements have changed many times since 1915. Historical records indicate the space needed for one adult casket in the older part of the cemetery (Tracts 1-20) was a gravesite measuring 4 feet x 6 feet. The number of gravesites per Tract is based on those dimensions and varies between 580 and 640. In 1997 burial vaults (protective covers over the casket) were required for all casket burials. The burial vaults help ensure the cemetery grounds remain as level as possible. Due to the size of the vaults, the space needed for one adult casket increased to 5 feet x 10 feet. Those dimensions were superimposed over the established 4’ x 6’ gravesites and thus eliminated hundreds of the adult burial gravesites that existed due to a lack of space. Honoring reservations made prior to the vault requirement is a challenge since the dimensions have changed and the grave may encroach on the surrounding gravesites.

Gravesites that cannot accommodate an adult vault are labeled as “short” gravesites. These short sites are appropriate for families that need to bury an urn, bury an infant or child’s casket and for those who are interested in placing a memorial marker in the cemetery. Because the number of the remaining gravesites includes these short gravesites, trees, bushes and irrigation stations, a firm number of available adult gravesites is difficult to determine.

Grave mapping software is available that could record the locations and dimensions of every gravesite and more accurately identify viable gravesites. A Geographic Information System (GIS) could blend digital mapping and cemetery record management software with the historical paper and pencil record and the current web based database. Migrating the historical burial data, maps and documents to an electronic record would also be very beneficial if anything drastic were to happen to the cemetery office building although photographs of the maps have been completed. A digital map of the cemetery would also help visitors locate individual gravesites with more accuracy and be useful when the staff are unavailable. The current mapping is vague, not entirely accurate, not user friendly and does not take advantage of commonly available technology such as GPS or Google Earth.



Problem Statement

When the available gravesites are either occupied or reserved, the cemetery will be at capacity. 6 of the original 20 Tracts are already at capacity. The remaining public Tracts will be at capacity in 10 years. The private Tracts will be at capacity in 60-300 years depending on the organization. When the cemetery reaches capacity, burials for reservation holders will only be conducted during the summer season due to the frozen ground and snow cover occurring in the fall and winter months. Winter burials require an insulated gravesite. The winter burials are assigned an insulated lot (1 of 70) on a next in line basis.

Insulated lots are still susceptible to a deep freeze and the cemetery contractor may not be able to prepare a winter gravesite depending on the location in relationship to other gravesites. The lots in the older Tracts (1-20) are very difficult to access and identify in the winter months since the snow will cover the markers. Lots in Tract A & B are slightly less challenging to locate in the winter, but they will still be frozen and covered with snow, thus rendering them inaccessible except in the summer months.

Except for members of the Jewish, Muslim and Catholic faiths winter burial will not be an option. Burials for the Jewish and Muslim faiths should be conducted within 24 hours of the death and require preparation of a few graves in the fall for use in the winter months. From time to time the Catholic Archdiocese of Anchorage has also requested graves be prepared in the fall.

Recommendations

1 to 5 years

Develop a cemetery record management system utilizing GIS technology to preserve the cemetery burial records.

Acquire a minimum of 10 acres for another municipal cemetery in the Anchorage bowl. Adding space to the existing 22 acres is not feasible in the next five years.

The cemetery has an option to revoke reservations if no re-confirmation has been made by the reservation holder after 20 years. The number of sites to reclaim varies from year to year with the average being five per year. This process would add a few more sites every year, but not a significant number.

Encourage “stack burial” arrangements. Placing two family member’s caskets in the same gravesite uses one site for two caskets. However, due to the space required and the impacts to the surrounding area, stack burials can only be conducted safely in certain public areas of the cemetery. This option may save a few sites every year, but not a significant number.

Return private Tract land for public burial sites. If the private Tract owners were willing to give unused portions of their property back to the cemetery this would add to the number of available public sites. However, because most private Tracts have burials recorded in a scattered pattern and not in rows, their deceased members could be buried among members of the public who are not necessarily members of their organization. In 2001, the Masons offered to return to the cemetery a portion measuring 30 feet x 200 feet, of their unoccupied property equaling 100 gravesites. At the time, they were informed that the parcel was too small for the Municipality to accept.



6 to 15 years

Move the Community Work Service program out of the east portion of the cemetery office building and convert that space into an indoor columbarium with a minimal renovation/installation investment. An indoor columbarium with 500 glass/bronze fronted niches would generate \$500,000 at current rates before it reached capacity.

Demolish the “barn area” and outdoor storage area and convert that space into 140 gravesites. The fenced “barn area” houses the contractor’s office in a “movable building.” The area also serves as storage for three 10 yard mounds of dirt/sand/gravel, two 300 gallon fuel tanks, maintenance equipment, the markers to be set, and the cemetery back hoe. When the cemetery is in need of these gravesites, on-site storage or storage in close proximity should be provided for the equipment as it needs to be available for daily use or with little notice.

Demolish the barn and erect a mausoleum for above ground interments. Depending on the style, 60 crypts could be offered to purchase.

A five acre cemetery in Girdwood will be developed in the next few years and the Municipality will be the managing agent. The acreage and development plan in Girdwood may not be suitable as an alternative burial site for residents of the Anchorage bowl. Its distance from the Anchorage bowl, and non-traditional burial plans, may be a factor as families make plans for honoring their deceased family members.

16 to 25 years

Demolish the barn area, the shop and the cemetery office buildings. Convert the land into another columbarium, a mausoleum and/or new gravesites.

Convert all or part of Fairbanks Street to the east of the cemetery into cemetery property adding 700 gravesites.

Move east to Gambell Street. Remove the buildings on the east side of Fairbanks Street and convert the area to cemetery property. This could potentially add 8000 gravesites and extend the life of the cemetery another 50 years.

When the public part of the cemetery is full, the municipality will honor the reservations and inform the public of local burial options in Girdwood, Angelus Memorial Park and Ft. Richardson National Cemetery. The cemetery will continue to honor all of the deceased and be maintained as a place of quiet reflection and dignity.

Conclusion

If current burial trends continue, the cemetery will be at capacity in the public Tracts by 2028. If the Municipality plans to continue providing burial space for the community, there are several options that may be considered. The Administration may choose to obtain additional land in the Anchorage bowl with a long term goal of several decades of useful life for adult casket burials. A new cemetery without the free land provision would enable the Municipality to obtain a revenue source for years to come. Pet memorials and burials, private and public mausoleums, scattering gardens and other popular options may be considered. An onsite committal shelter or indoor chapel would also



enhance the options for honoring loved ones and could extend the life of the cemetery. With the public Tracts reaching capacity by 2028, it will be necessary for the Administration, in partnership with the Anchorage Assembly and the Anchorage Memorial Park Cemetery Advisory Board, to develop a strategic plan for the cemetery.

APPENDIX



Anchorage Memorial Park Cemetery

Capacities

Tract Owner	Trct #'s	# of graves	# of avail	% avail	5yr avg burial/yr	est. yrs to capacity	yr
Pioneers of AK Igloo 15	1, 10, 11	1784	976	54.71%	8.2	119.02	2136
BPO Elks	2	630	278	44.13%	0.8	347.50	2365
Catholic Archdioces of Anch	5,6 & RUP AA	1578	767	48.61%	12.8	59.92	2077
F. & A. Masons	9	640	403	62.97%	1.2	335.83	2353
LO Moose	12	640	494	77.19%	1.6	308.75	2326
American Legion Post 1	20	580	349	60.17%	2.2	158.64	2176
Cong Beth Shalom	RUP BB	320	288	90.00%	1.2	240.00	2257
		6,172	3,555		28	208.64	
Public Tract		11,353	2,400	21.14%	240	10.00	2027
					burial/resv		
		17,525					



SHERATON HOTEL

SIXTH AVENUE

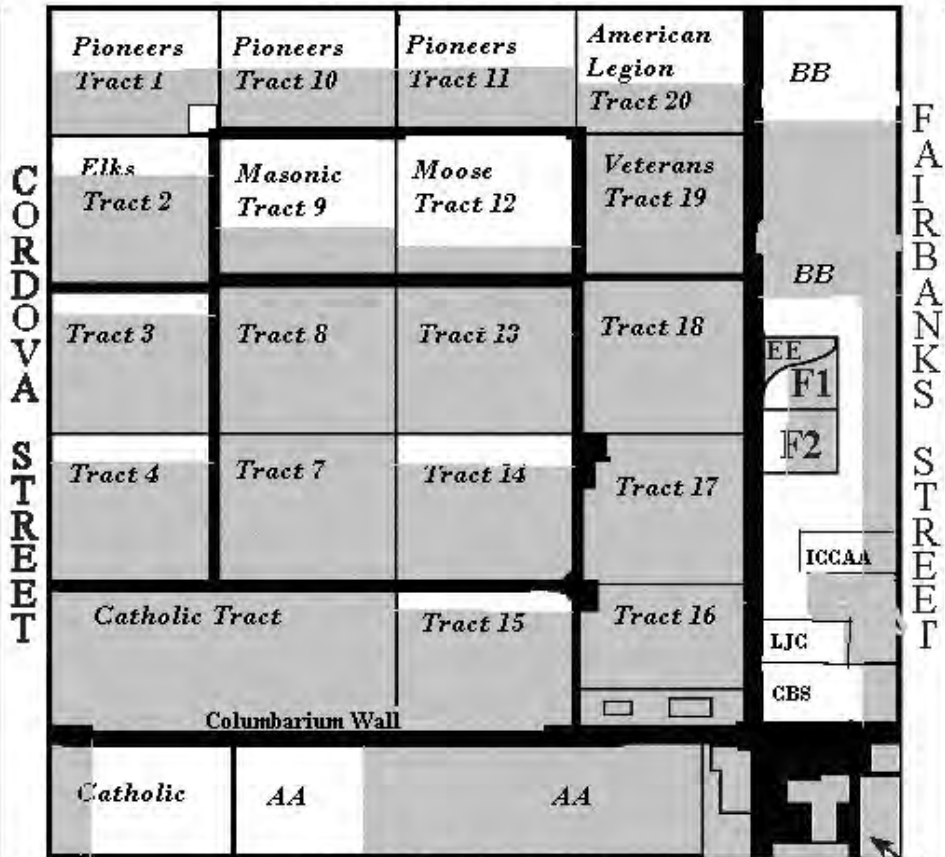

CORDOVA STREET

FAIRBANKS STREET



EE = Cremains
 F1 = Infant
 F2 = Child

Gray areas are occupied or reserved

NINTH AVENUE

CEMETERY OFFICE





EXECUTIVE ORDER

CHUGACH NATIONAL FOREST
ALASKA

It is hereby ordered, under authority of the Act of Congress approved June 4, 1897 (30 Stat., 11, 34-36), that the tracts of land in Alaska bounded as hereinafter described be excluded from the Chugach National Forest, and that such tracts, pursuant to the provisions of the Act of Congress approved March 12, 1914 (38 Stat., 305), be, and they are hereby, withdrawn from settlement, location, sale, entry, or other disposition, and reserved for townsite purposes and for other purposes in connection with the construction and operation of railroad lines under said act, under such regulations as have been or may hereafter be prescribed:

Southern Addition to Anchorage Townsite

Beginning at meander corner No. 3 of Anchorage Townsite, thence East 73.84 chains; thence South 41.48 chains; thence West 117.04 chains to meander corner at the mouth of Campbell Creek; thence with the meanders of Knik Arm North 44° 03' 23" East 57.77 chains to the point of beginning, containing 402.11 acres;

Eastern Addition to Anchorage Townsite

Beginning at the true point for the quarter section corner on the south boundary of Section 8, T.



13 N., R. 3 W., Seward Meridian, thence West 39.95 chains to corner of Sections 7, 8, 17 and 18, said township; thence South 0° 08' East 14.28 chains; thence West 29.07 chains to corner No. 1 of Anchorage Townsite; thence South 28.18 chains; thence East 13.03 chains; thence South 13.03 chains; thence West 13.03 chains; thence South 2.88 chains to corner No. 2 of Anchorage Townsite; thence East 89.00 chains; thence North 58.35 chains to the point of beginning, containing approximately 344.08 acres;

Alaska Railroad Terminal Reserve

Beginning at the corner of Sections 7, 8, 17 and 18, T. 13 N., R. 3 W., Seward Meridian, thence East 39.95 chains to the true point for the quarter section corner on the south boundary of Section 8; thence North 0° 05' West 39.96 chains; thence West 99.96 chains along the quarter section line through Sections 8 and 7 to its intersection with ordinary high water mark on the east shore of Knik Arm; thence southwesterly along ordinary high water mark on the eastern shore of Knik Arm and crossing the mouth of Ship Creek to the northwest corner of Anchorage Townsite; thence East 89.06 chains; thence North 0° 08' West 14.28 chains to the point of beginning, containing 551.63 acres;

Cemetery Reserve

Beginning at a point on the east boundary of Anchorage Townsite in T. 13 N., R. 3 W., Seward Meridian, 15.91 chains North of the southeast corner thereof, thence East 13.03 chains; thence South 13.03 chains; thence West 13.03 chains; thence North 13.03 chains to the point of beginning, containing 16.98 acres.

Andersen
----->

THE WHITE HOUSE,

31 August, 1915.



EXECUTIVE ORDER.

ALASKA

Anchorage Townsite.



Under the provisions of the Act of Congress, approved March 13, 1914 (38 Stat., 305), entitled: "An Act To authorize the President of the United States to locate, construct, and operate railroads in the Territory of Alaska, and for other purposes", it is hereby ordered that the tract of land designated as a "Cemetery Reserve" on the plat of Anchorage Townsite with South and East Additions, approved May 8, 1916, be subdivided into appropriate tracts or blocks and the Secretary of the Interior is hereby authorized to dispose of such tracts or blocks at private sale to religious or fraternal organizations qualified to hold title to real estate, at an appraised price to be fixed under such rules and regulations as the Secretary may prescribe; Provided, that not more than one half in the aggregate of said "Cemetery Reserve" shall be so sold; and Provided further, that at least one half of said Reserve shall be surveyed into burial lots of suitable size which shall be open to burial privileges by the public without charge for the land, a record of such burials to be kept as may be directed in said regu-

2836



lations and turned over to the municipal authorities
when the town is incorporated, and that a patent shall
then be issued to said authorities for all portions
of said "Cemetery Reserve" remaining unsold.

Woodrow Wilson

The White House,

10 April , 1918.

-2-

2836



