

WIND DATA

NOTE: WIND SPEED IS INDICATED IN KNOTS.

ALL WEATHER WIND DATA		
RUNWAY	10.5 KT	13 KT
RW 8-26	97.97%	98.80%
RW 17-35	99.65%	99.82%
RW 5-23	98.17%	99.04%
COMBINED	99.97%	100.00%

SOURCE: MERRILL FIELD WIND DATA
 FAA AIRPORT DATA AND INFORMATION PORTAL
 MAY 5, 2023
 PERIOD: 2013 - 2022

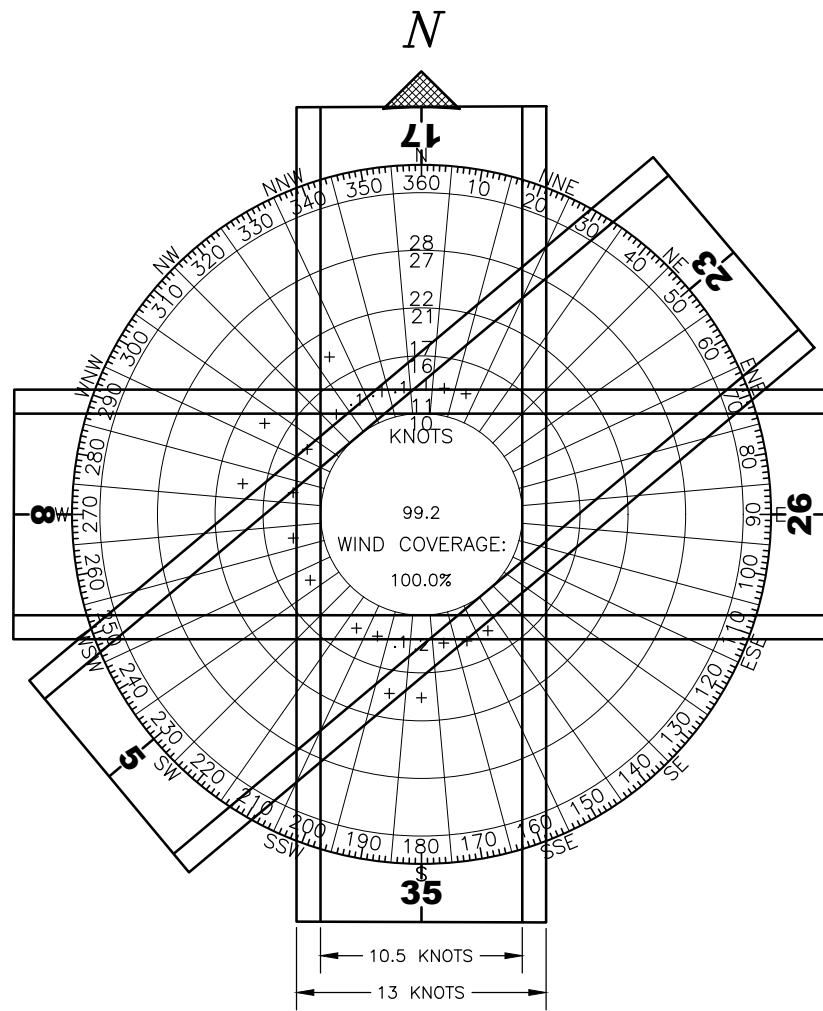

WIND DATA

NOTE: WIND SPEED IS INDICATED IN KNOTS.

IFR WIND DATA		
RUNWAY	10.5 KT	13 KT
RW 8-26	99.32%	99.59%
RW 17-35	99.95%	99.97%
RW 5-23	99.39%	99.70%
COMBINED	100.00%	100.00%

SOURCE: MERRILL FIELD WIND DATA
 FAA AIRPORT DATA AND INFORMATION PORTAL
 MAY 5, 2023
 PERIOD: 2013 - 2022

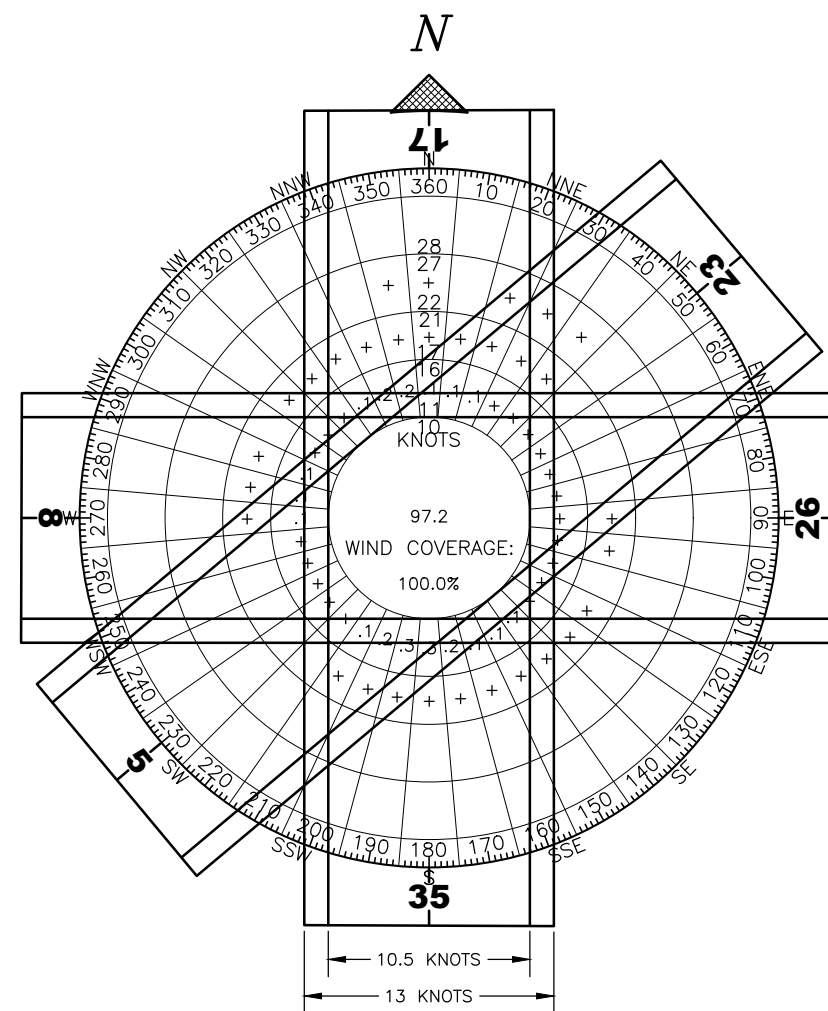

WIND DATA

NOTE: WIND SPEED IS INDICATED IN KNOTS.

VFR WIND DATA		
RUNWAY	10.5 KT	13 KT
RW 8-26	97.79%	98.69%
RW 17-35	99.60%	99.80%
RW 5-23	98.00%	98.95%
COMBINED	99.96%	100.00%

SOURCE: MERRILL FIELD WIND DATA
 FAA AIRPORT DATA AND INFORMATION PORTAL
 MAY 5, 2023
 PERIOD: 2013 - 2022

MERRILL FIELD AIRPORT (MRI)

ANCHORAGE, ALASKA

WIND DATA

REVISION

SHEET NO.:

4 OF 25

HALF-SCALE @ 11 X17

BUILDING DATA TABLE						
ID #	DESCRIPTION	STATION	OFFSET	TOP ELEV. (MSL)	OBSTRUCTION	DISPOSITION
14	AIRFRAMES ALASKA	125+00.16	442.6' LT	163.8'	N	-
15	CHUGACH HANGARS	128+31.22	424.6' LT	166.3'	Y	LIGHT
16		129+43.33	424.3' LT	163.2'	N	-
17	NORTH EDGE	130+60.97	424.1' LT	164.2'	Y	LIGHT
18		132+61.53	434.8' LT	172.8'	Y	LIGHT
19	STODDARD'S	138+68.33	422.5' LT	170.2'	N	-
57	ALASKA AIRCRAFT ENGINES	125+37.39	465.8' RT	180.5'	Y	LIGHT
58		126+77.93	469.5' RT	160.9'	N	-
59	LAKE CLARK AIR	128+81.66	468.3' RT	166.7'	N	-
60	UAA AVIATION	130+45.21	528.4' RT	167.4'	N	-
61		135+70.48	441.6' RT	176.5'	Y	LIGHT
74	CAMPGROUND TRANSIENT PARKING	55+65.64	318.7' LT	133.9'	N	-

- NOTES:
- STATIONS READING 90+00.00 THROUGH 150+00.00 RELATE TO RUNWAY 8-26.
 - STATIONS READING 0+00.00 THROUGH 60+00.00 RELATE TO RUNWAY 5-23.
 - (X) TAXIWAY IDENTIFIER. SEE TAXIWAY DATA TABLES (SHEET 3) FOR TAXIWAY INFORMATION.

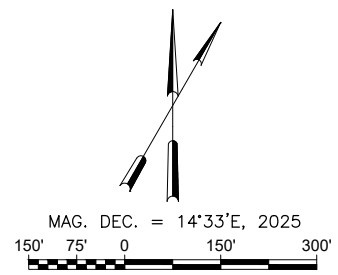
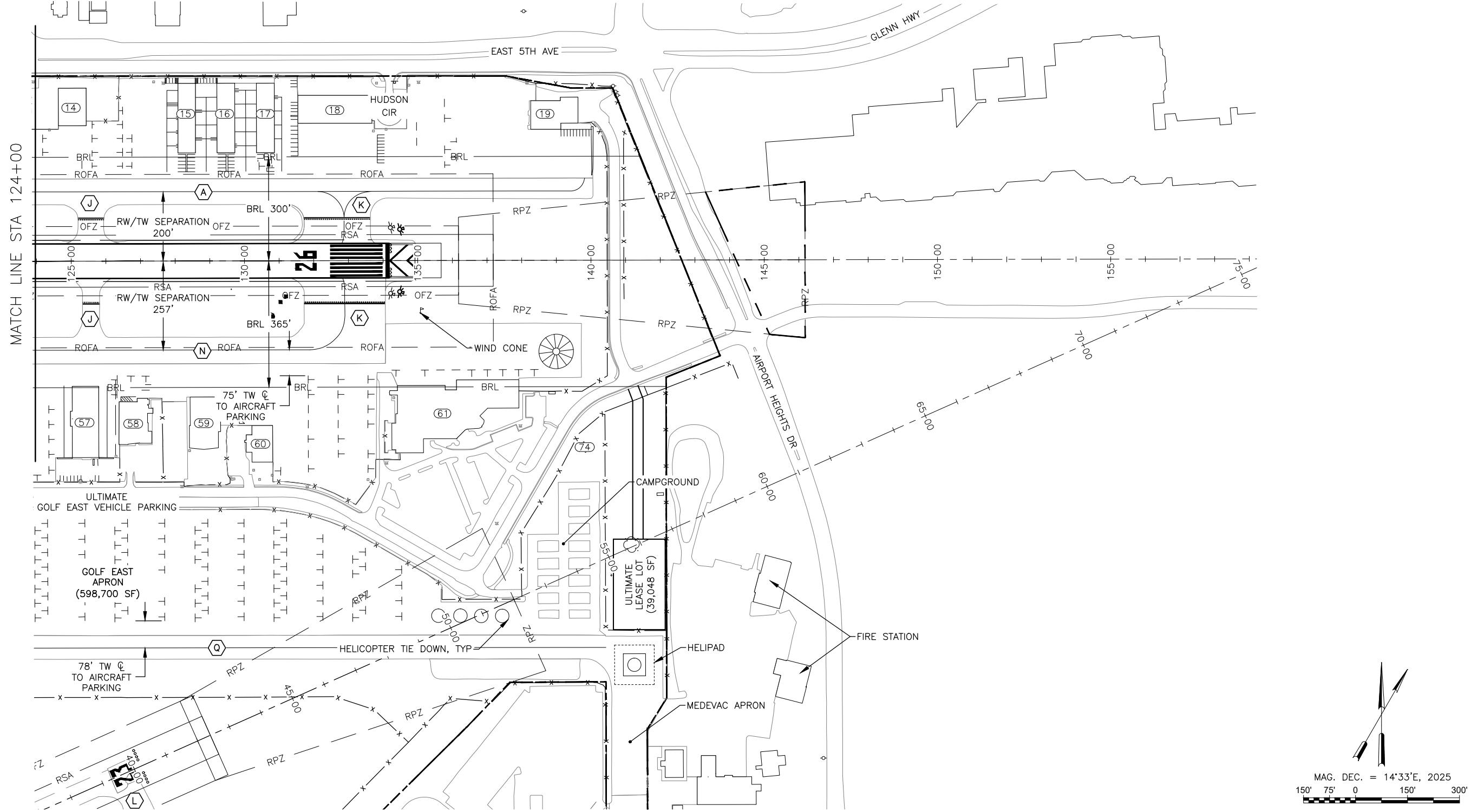

MERRILL FIELD AIRPORT (MRI)
 ANCHORAGE, ALASKA
 TERMINAL AREA - SHEET 2 OF 3

NO.	BY	DATE	REVISION

SHEET NO.:
 8 OF 25
HALF-SCALE @ 11 X 17

BUILDING DATA TABLE						
ID #	DESCRIPTION	STATION	OFFSET	TOP ELEV. (MSL)	OBSTRUCTION	DISPOSITION
28	PREMIER HANGARS	287+76.07	250.3' LT	154.1'	Y	RELOCATE
29	1025 ORCA	286+17.89	243.7' LT	154.8'	Y	RELOCATE
30	USGS SWOOP	280+90.35	314.4' LT	161.1'	Y	LIGHT
31		281+06.10	218.5' LT	150.6'	Y	RELOCATE
32	NORTH STAR HANGARS	276+31.54	254.0' LT	142.9'	Y	LIGHT
33	JANESSEN HANGARS	272+82.25	255.3' LT	141.2'	Y	LIGHT
37	EXECUTIVE HANGARS	288+31.25	369.6' RT	156.4'	Y	LIGHT
38	DENA'INA AIR TAXI	286+73.11	412.2' RT	143.5'	N	-
39	CLEARWATER AIR	285+39.59	393.6' RT	147.5'	N	-
73	LONG TERM PARKING	34+03.42	501.1' LT	153.1'	N	-
75	CROWLEY FUELS, AV/FUEL	28+55.58	319.1' RT	148.4'	N	-
76		28+58.61	357.5' RT	144.6'	N	-
77		28+76.03	374.0' RT	145.8'	N	-
78	CRAIG PROPERTIES LLC	283+60.32	246.7' LT	152.6'	Y	REMOVE

NOTES:

- STATIONS READING 270+00.00 THROUGH 370+00.00 RELATE TO RUNWAY 17-35.
- STATIONS READING 0+00.00 THROUGH 60+00.00 RELATE TO RUNWAY 5-23.
- (X) TAXIWAY IDENTIFIER. SEE TAXIWAY DATA TABLES (SHEET 3) FOR TAXIWAY INFORMATION.

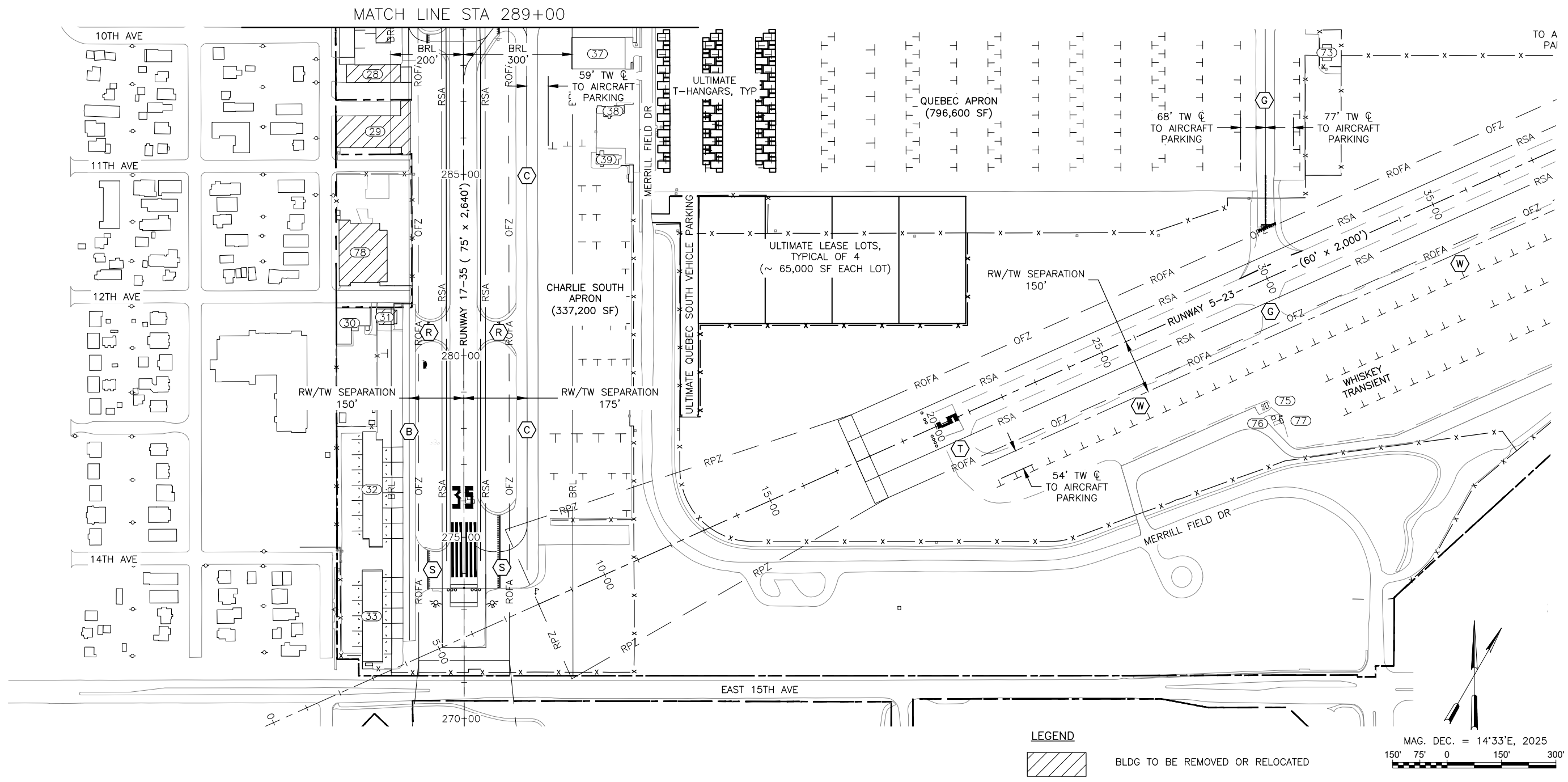

NO.	DATE	REVISION

SHEET NO.:
9 OF 25
HALF-SCALE @ 11 X17

FILE PATH AND NAME: \\jobs\24-020 Merrill Field Airport Engineering (MRI)\06_MRI_ALP_Update\CAD\Drawings\ALP-MRI-Inner Approach_RW 7-25.dwg DATE: 06/25/2025 DRAWN BY: AVA, VN REVIEWED BY: CUB

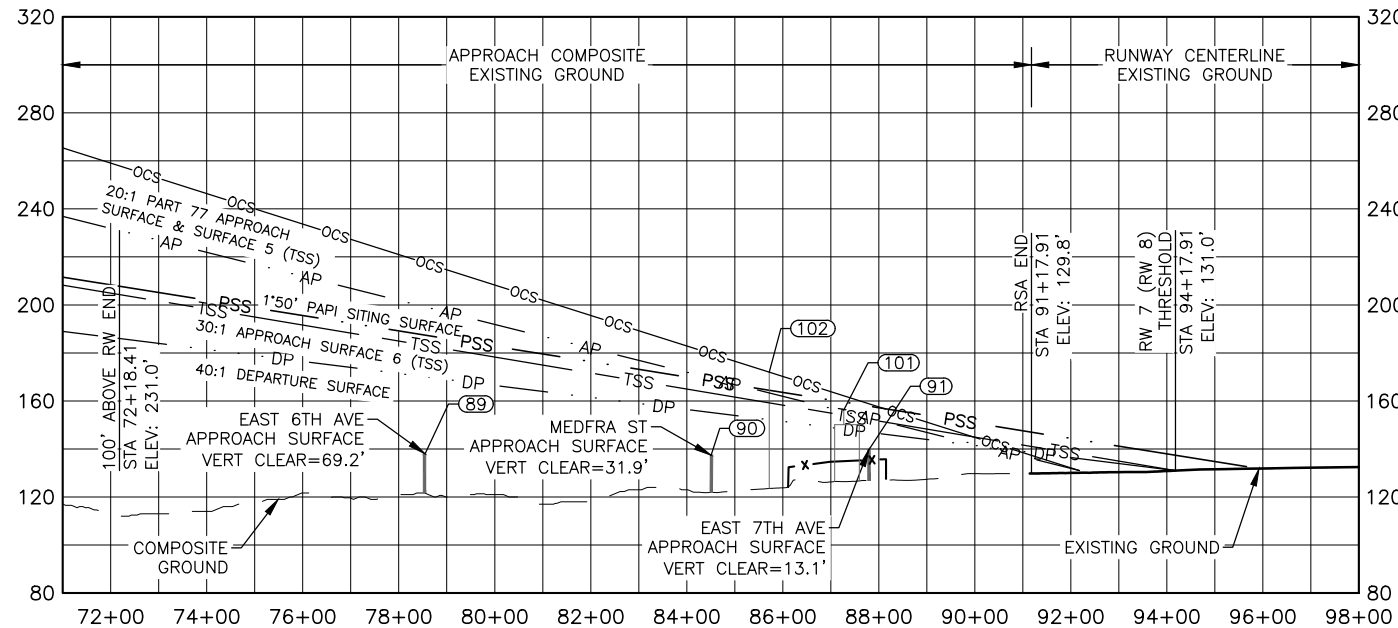
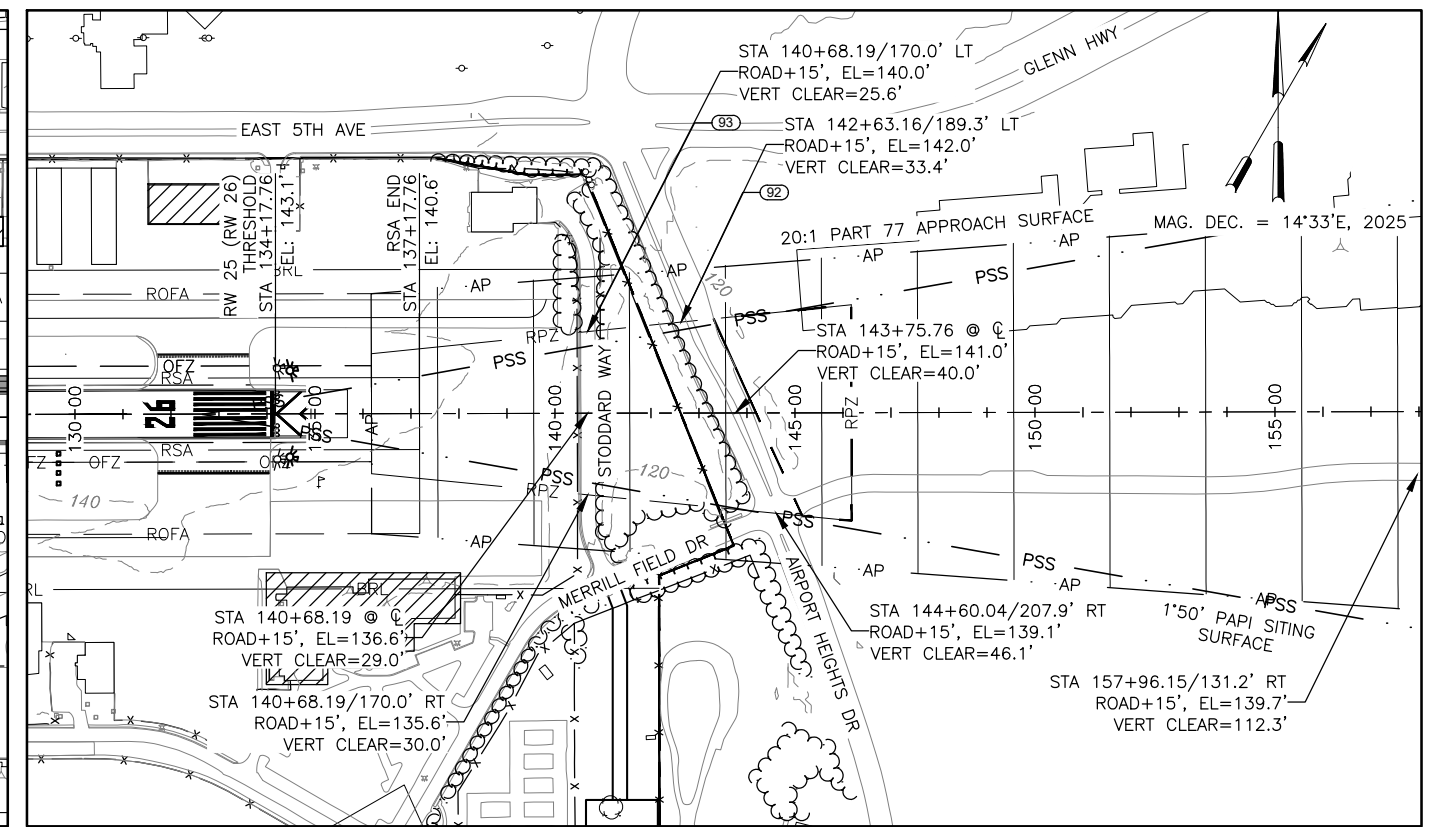
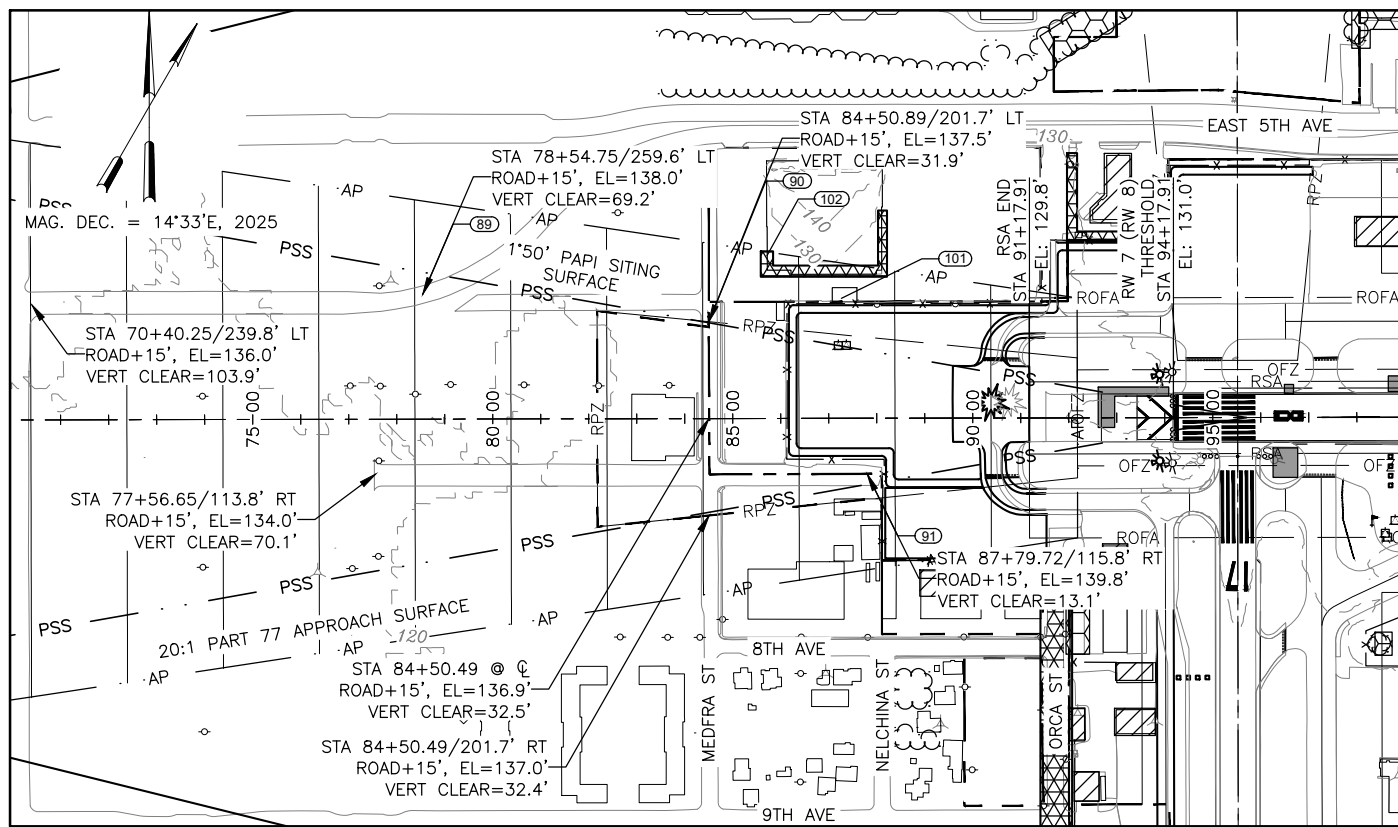

RUNWAY 7 (RW 8) APPROACH SURFACE

200' 100' 0 200' 400'
HORIZONTAL TO VERTICAL RATIO 1:5

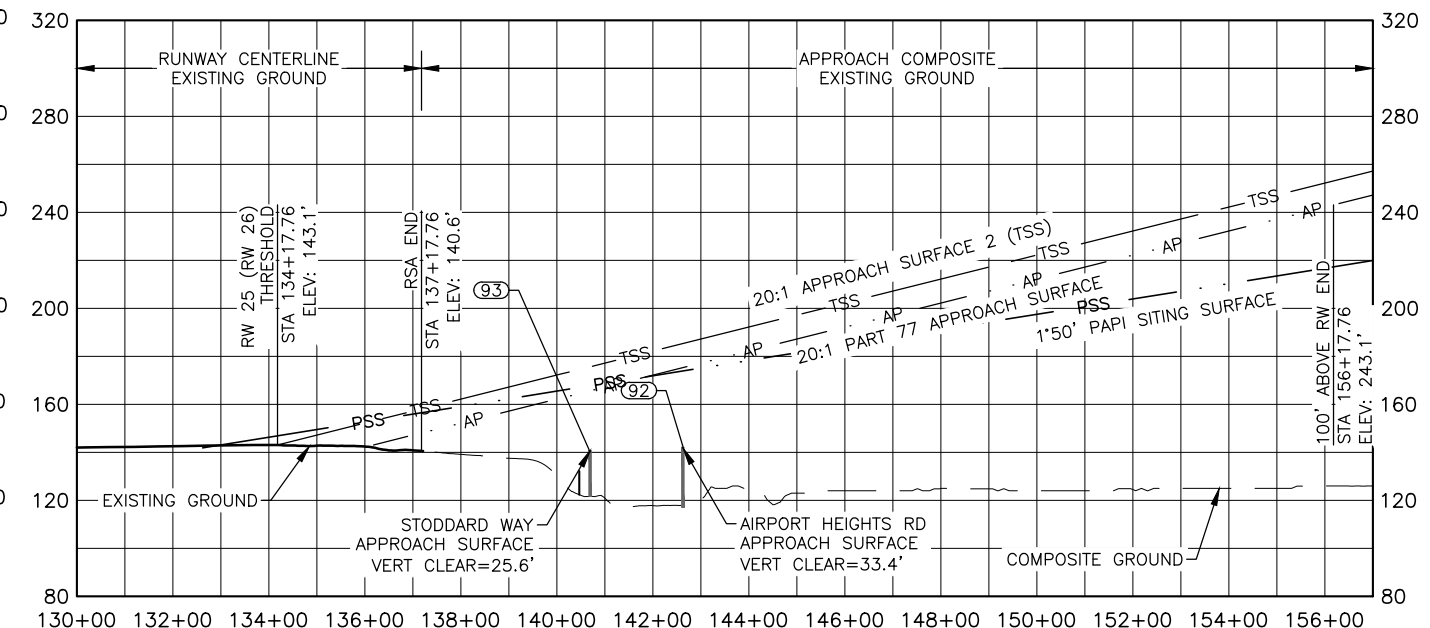

RUNWAY 25 (RW 26) APPROACH SURFACE

200' 100' 0 200' 400'
HORIZONTAL TO VERTICAL RATIO 1:5

NOTES:

- (HP) = POINT OF HIGHEST PENETRATION
- THE CONTROLLING OBSTRUCTION FOR THE APPROACH TO RUNWAY 7 (RW 8) IS A POLE. THE OBSTRUCTION CLEARANCE SLOPE IS ESTABLISHED AS 15:1 PER AIRPORT GIS DATA INFORMATION PORTAL (ADIP), AIRPORT MASTER RECORDS DATA DICTIONARY, DATA ELEMENT 57.
- THERE IS NO CONTROLLING OBSTRUCTION FOR THE APPROACH TO RUNWAY 25 (RW 26). THE OBSTRUCTION CLEARANCE SLOPE IS ESTABLISHED AS 20:1 PER AIRPORT GIS DATA INFORMATION PORTAL (ADIP), AIRPORT MASTER RECORDS DATA DICTIONARY, DATA ELEMENT 57.
- THRESHOLD SITING CRITERIA FOR RUNWAY 7-25 (RW 8-26) IS DEFINED PER FAA AC 150/5300-13B FOR APPROACH END OF RUNWAY THAT SUPPORTS DIFFERENT TYPES OF INSTRUMENT FLIGHT PROCEDURES.
- SEE AIRPORT AIRSPACE (SHEETS 17-19) FOR OBSTRUCTIONS TO 14 CFR PART 77 SURFACE.

LEGEND

- 14 CFR PART 77 BRUSH OBSTRUCTION
- 14 CFR PART 77 LIGHT POLES, CATENARY OBSTRUCTION
- 14 CFR PART 77 TREES OBSTRUCTION
- 14 CFR PART 77 CHAIN LINK FENCE OBSTRUCTION
- 14 CFR PART 77 BUILDING OBSTRUCTION
- OBSTRUCTION SEE PLAN VIEW

MERRILL FIELD AIRPORT (MRI)

ANCHORAGE, ALASKA

INNER PORTION OF RW 7-25 (RW 8-26) APPROACH SURFACE

REVISION

SHEET NO.:

10 OF 25

HALF-SCALE @ 11 X 17

FILE PATH AND NAME: \\jobs\24-020 Merrill Field Airport Engineering (MRI)\06_MRI_ALP_Update\CAD\Drawings\ALP-MRI-Inner Approach_RW 16-34.dwg DATE: 05/27/2025 DRAWN BY: AVA, VN REVIEWED BY: CJB

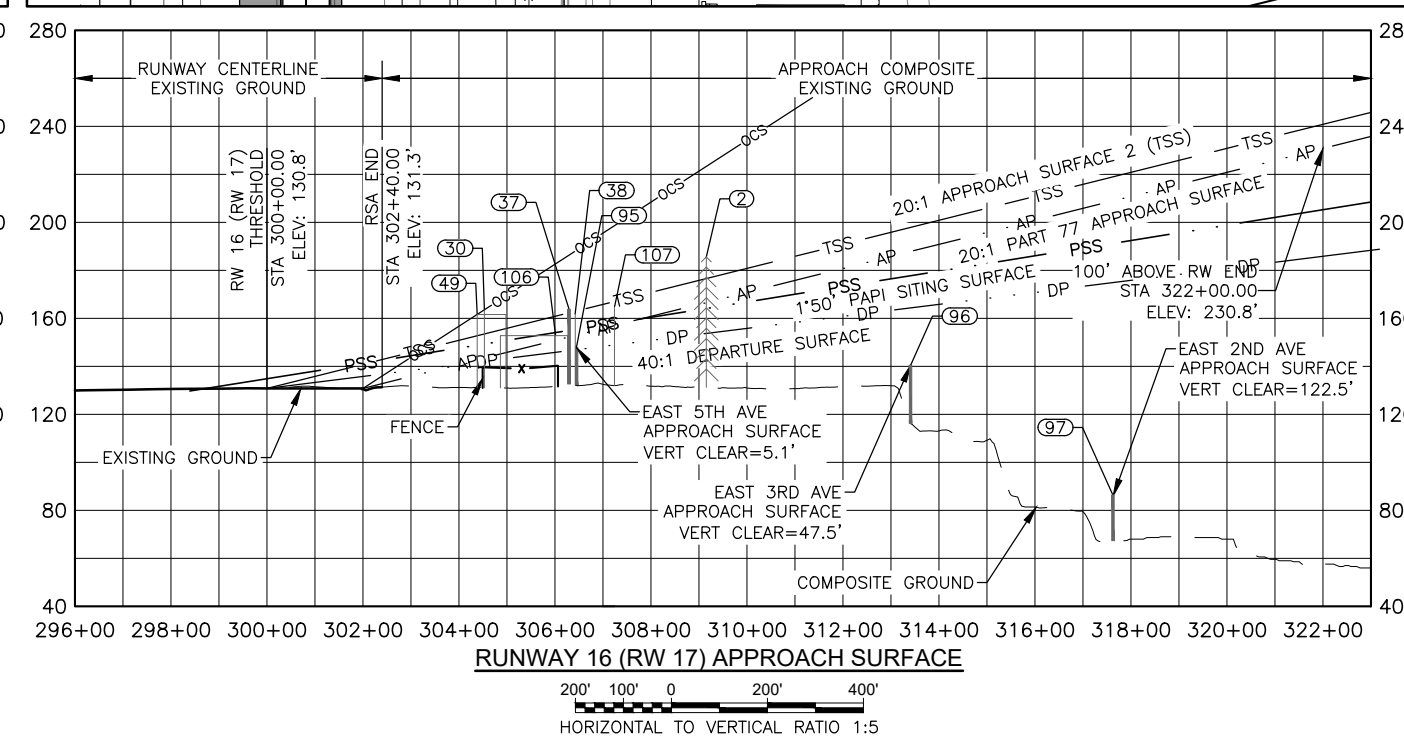
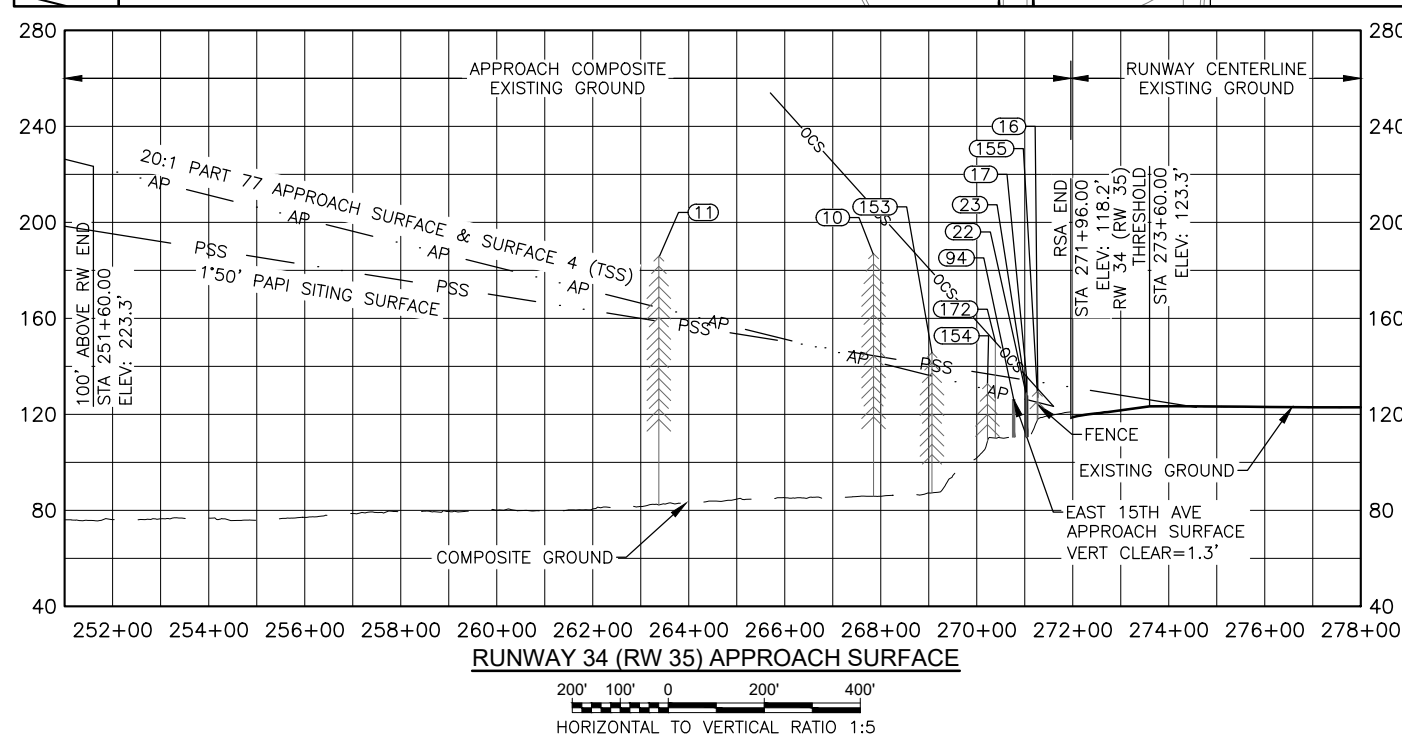
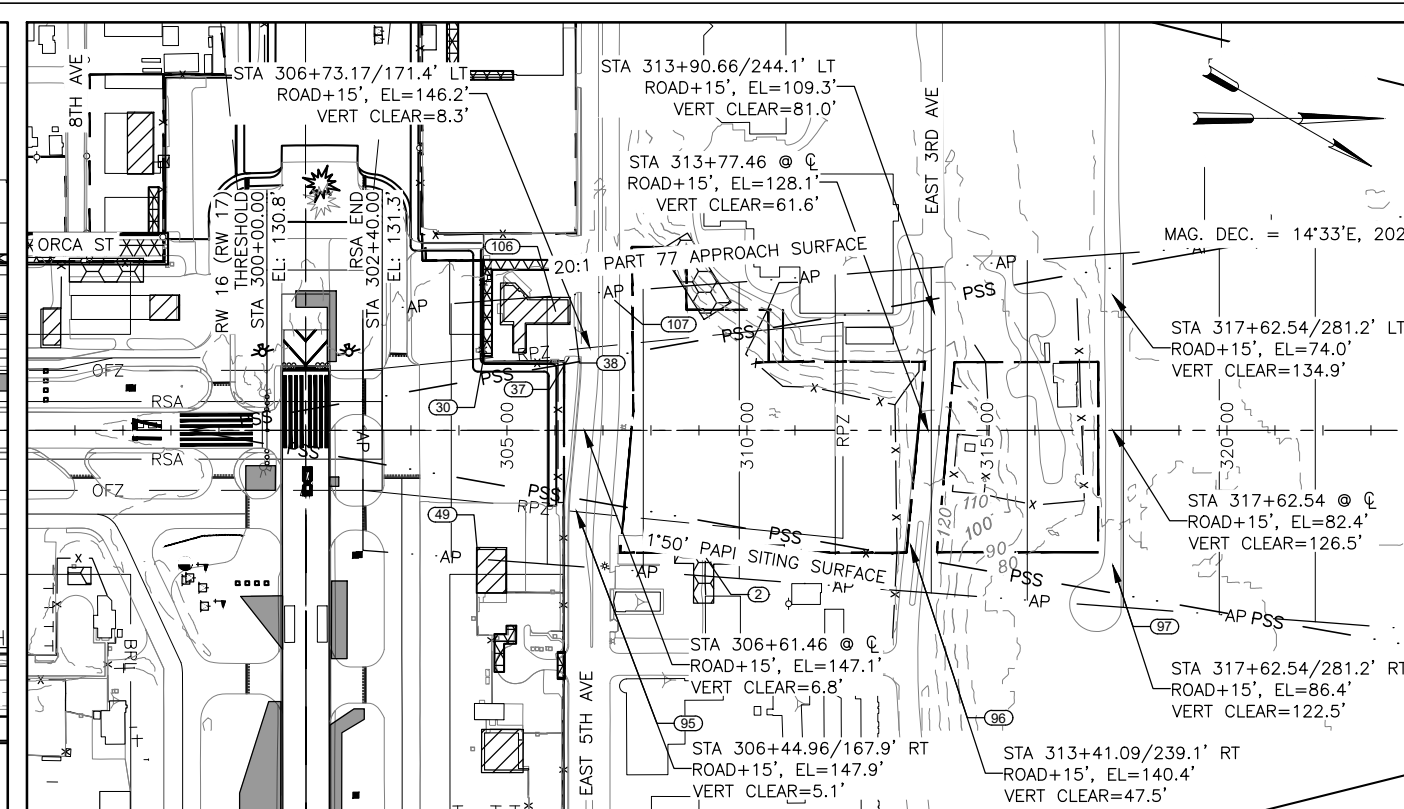
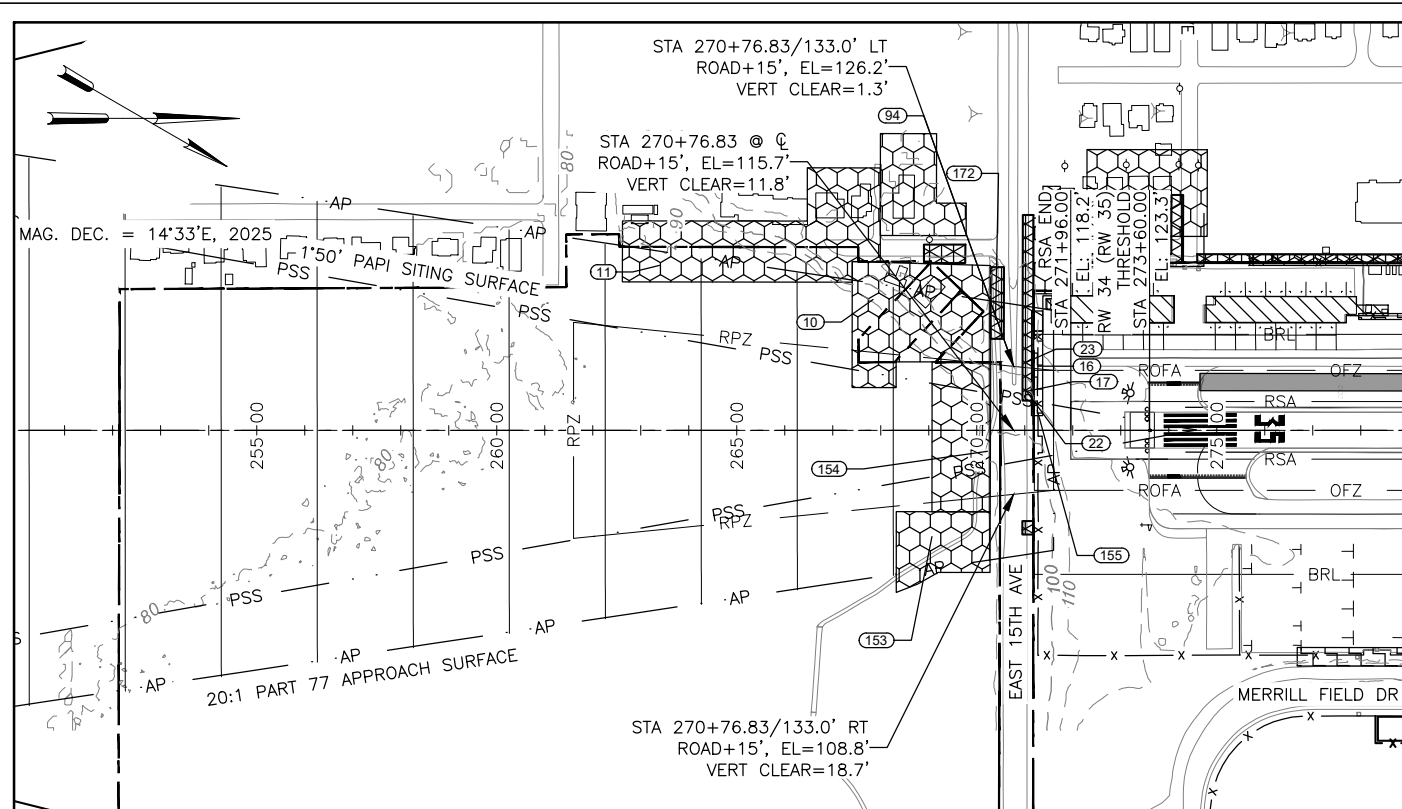

- NOTES:**
- (HP) = POINT OF HIGHEST PENETRATION.
 - THE CONTROLLING OBSTRUCTION FOR THE APPROACH TO RUNWAY 16 (RW 17) IS A BUILDING. THE OBSTRUCTION CLEARANCE SLOPE IS ESTABLISHED AS 7:1 PER AIRPORT GIS DATA INFORMATION PORTAL (ADIP), AIRPORT MASTER RECORDS DATA DICTIONARY, DATA ELEMENT 57.
 - THE CONTROLLING OBSTRUCTION FOR THE APPROACH TO RUNWAY 34 (RW 35) IS A POLE. THE OBSTRUCTION CLEARANCE SLOPE IS ESTABLISHED AS 4:1 PER AIRPORT GIS DATA INFORMATION PORTAL (ADIP), AIRPORT MASTER RECORDS DATA DICTIONARY, DATA ELEMENT 57.
 - THRESHOLD SITING CRITERIA FOR RUNWAY 16-34 (RW 17-35) IS DEFINED PER FAA AC 150/5300-13B, TABLE 3-2, SURFACE 2 FOR APPROACH END OF RUNWAY THAT SUPPORTS VISUAL ONLY PROCEDURES.
 - SEE AIRPORT AIRSPACE (SHEETS 17-19) FOR OBSTRUCTIONS TO PART 77 SURFACE.

LEGEND

	14 CFR PART 77 BRUSH OBSTRUCTION		14 CFR PART 77 LIGHT POLES, CATENARY OBSTRUCTION
	14 CFR PART 77 TREES OBSTRUCTION		14 CFR PART 77 CHAIN LINK FENCE OBSTRUCTION
	14 CFR PART 77 BUILDING OBSTRUCTION		OBSTRUCTION SEE PLAN VIEW

MERRILL FIELD AIRPORT (MRI)
ANCHORAGE, ALASKA
INNER PORTION OF RW 16-34 (RW 17-35)
APPROACH SURFACE

NO.	DATE	REVISION

FILE PATH AND NAME: \\jobs\24-020 Merrill Field Airport Engineering (MRI)\06_MRI_ALP_Update\CAD\Drawings\ALP-MRI-Inner Approach_RW 5-23.dwg DATE: 05/27/2025 DRAWN BY: AVA, VN REVIEWED BY: CUB

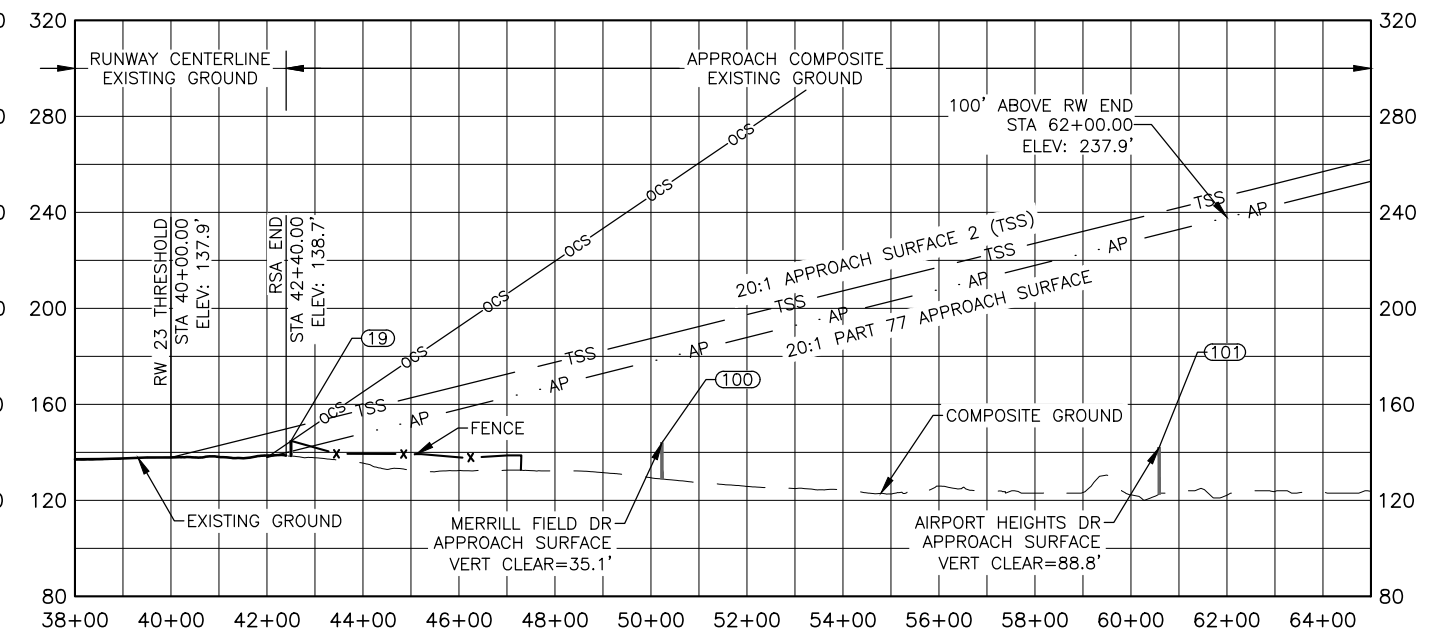
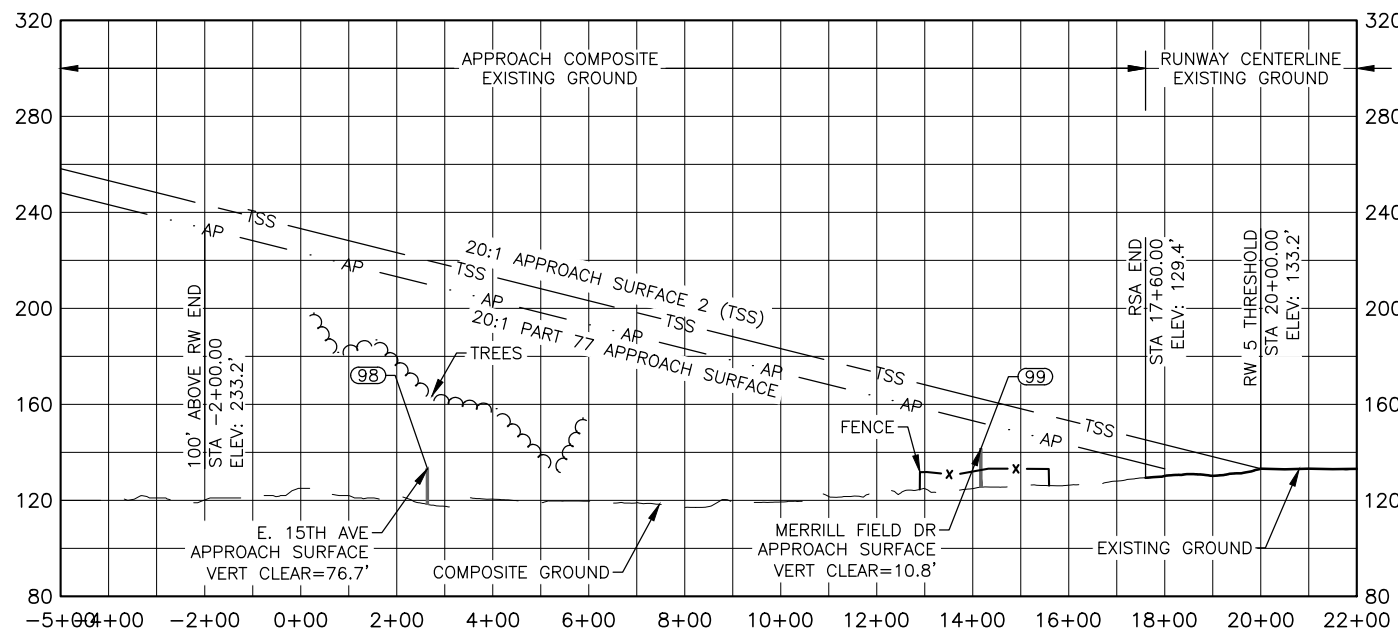
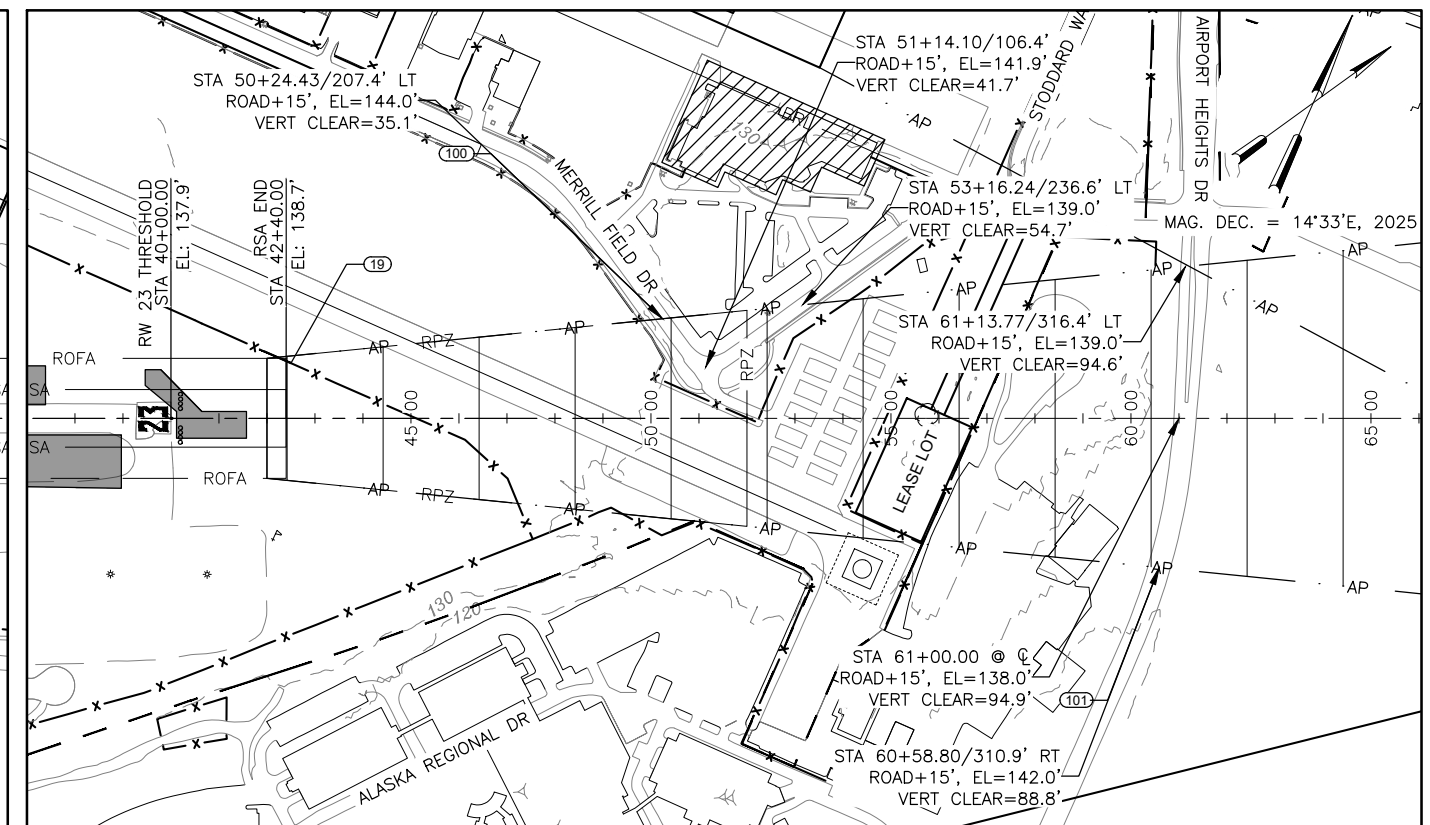
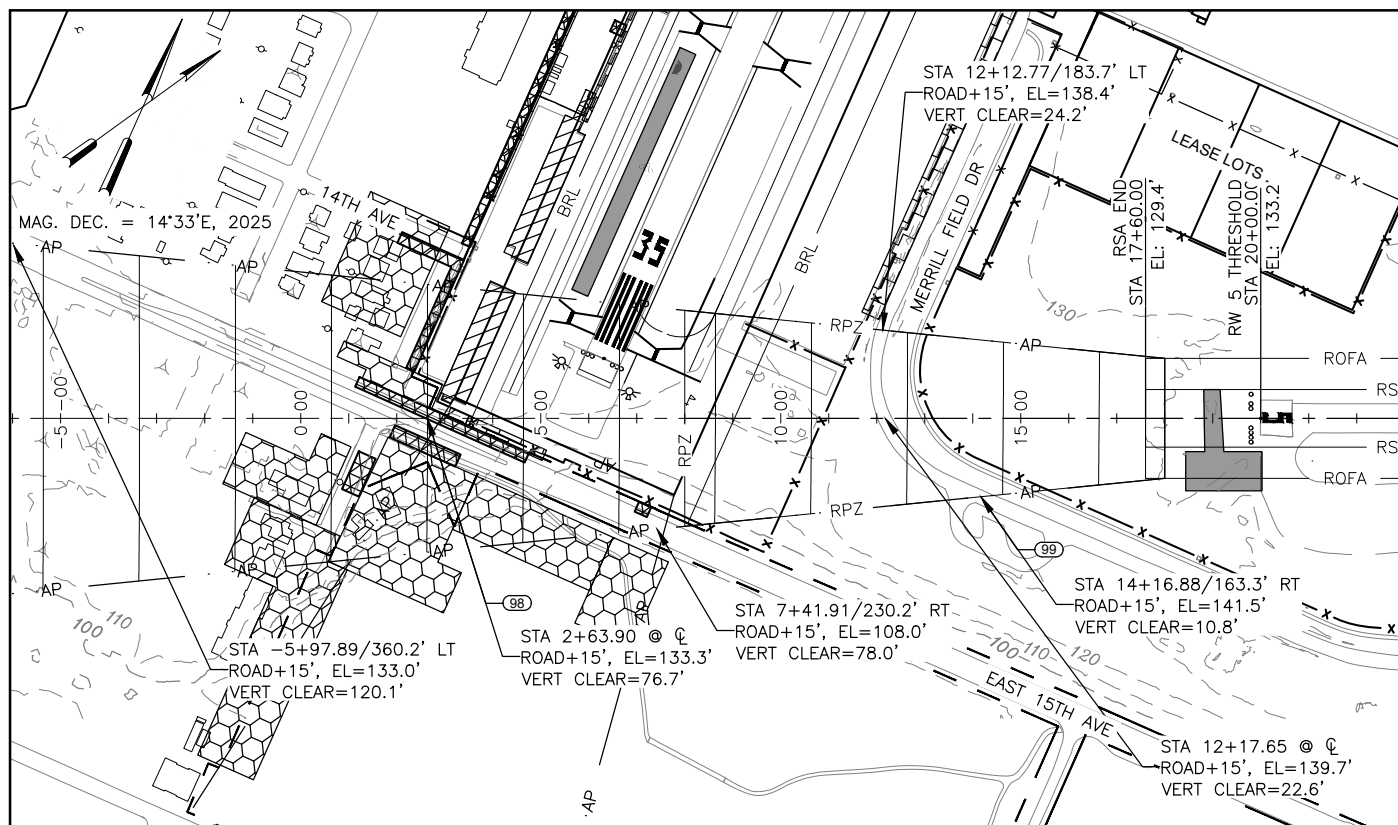

RUNWAY 5 APPROACH SURFACE

RUNWAY 23 APPROACH SURFACE

NOTES:

- (HP) = POINT OF HIGHEST PENETRATION.
- THERE IS NO CONTROLLING OBSTRUCTION FOR THE APPROACH TO RUNWAY 5. THE OBSTRUCTION CLEARANCE SLOPE IS ESTABLISHED AS 20:1 PER AIRPORT GIS DATA INFORMATION PORTAL (ADIP), AIRPORT MASTER RECORDS DATA DICTIONARY, DATA ELEMENT 57.
- THE CONTROLLING OBSTRUCTION FOR THE APPROACH TO RUNWAY 23 IS A FENCE. THE OBSTRUCTION CLEARANCE SLOPE IS ESTABLISHED AS 7:1 PER AIRPORT GIS DATA INFORMATION PORTAL (ADIP), AIRPORT MASTER RECORDS DATA DICTIONARY, DATA ELEMENT 57.
- THRESHOLD SITING CRITERIA FOR RUNWAY 5 AND RUNWAY 23 IS DEFINED PER FAA AC 150/5300-13B, TABLE 3-2, SURFACE 2 FOR APPROACH END OF RUNWAY THAT SUPPORTS VISUAL ONLY PROCEDURES.
- SEE AIRPORT AIRSPACE (SHEETS 17-19) FOR OBSTRUCTIONS TO PART 77 SURFACE.



LEGEND

- 14 CFR PART 77 BRUSH OBSTRUCTION
- 14 CFR PART 77 LIGHT POLES, CATENARY OBSTRUCTION
- 14 CFR PART 77 TREES OBSTRUCTION
- 14 CFR PART 77 CHAIN LINK FENCE OBSTRUCTION
- 14 CFR PART 77 BUILDING OBSTRUCTION
- OBSTRUCTION SEE PLAN VIEW

ID#	DESCRIPTION	STATION	OFFSET	ELEVATION	SURFACE PENETRATED	SURFACE ELEVATION	AMOUNT PENETRATED	DISPOSITION	STAGE TO CORRECT
98	ROAD+15' (HP)	2+63.90	CL	133.3'	NONE	210.0'	-	REMAIN	-
99	ROAD+15' (HP)	14+16.88	163.3' RT	141.5'	NONE	152.3'	-	REMAIN	-

ID#	DESCRIPTION	STATION	OFFSET	ELEVATION	SURFACE PENETRATED	SURFACE ELEVATION	AMOUNT PENETRATED	DISPOSITION	STAGE TO CORRECT
19	FENCE (HP)	42+50.26	115.0' LT	144.8'	APPROACH	140.4'	4.4'	LIGHT	NEAR TERM
100	ROAD+15' (HP)	50+24.43	207.4' LT	144.0'	NONE	179.1'	-	REMAIN	-
101	ROAD+15' (HP)	60+58.80	310.9' RT	142.0'	NONE	230.8'	-	REMAIN	-

MERRILL FIELD AIRPORT (MRI)

ANCHORAGE, ALASKA

INNER PORTION OF RW 5-23 APPROACH SURFACE

NO.	REVISION	DATE	BY

SHEET NO.:

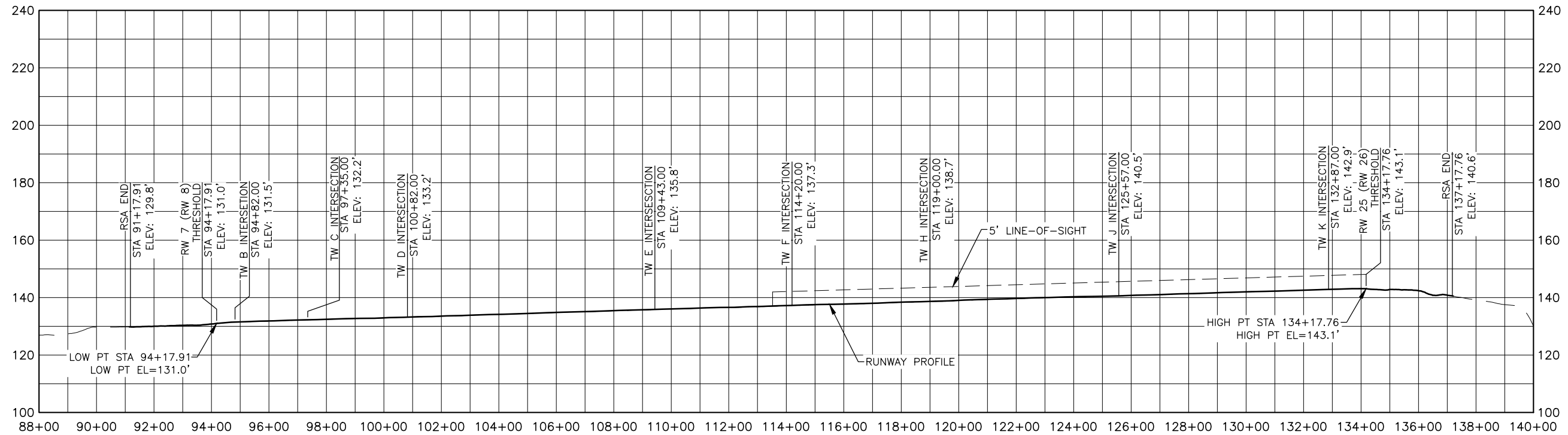

RUNWAY 7-25 (RW 8-26) PROFILE

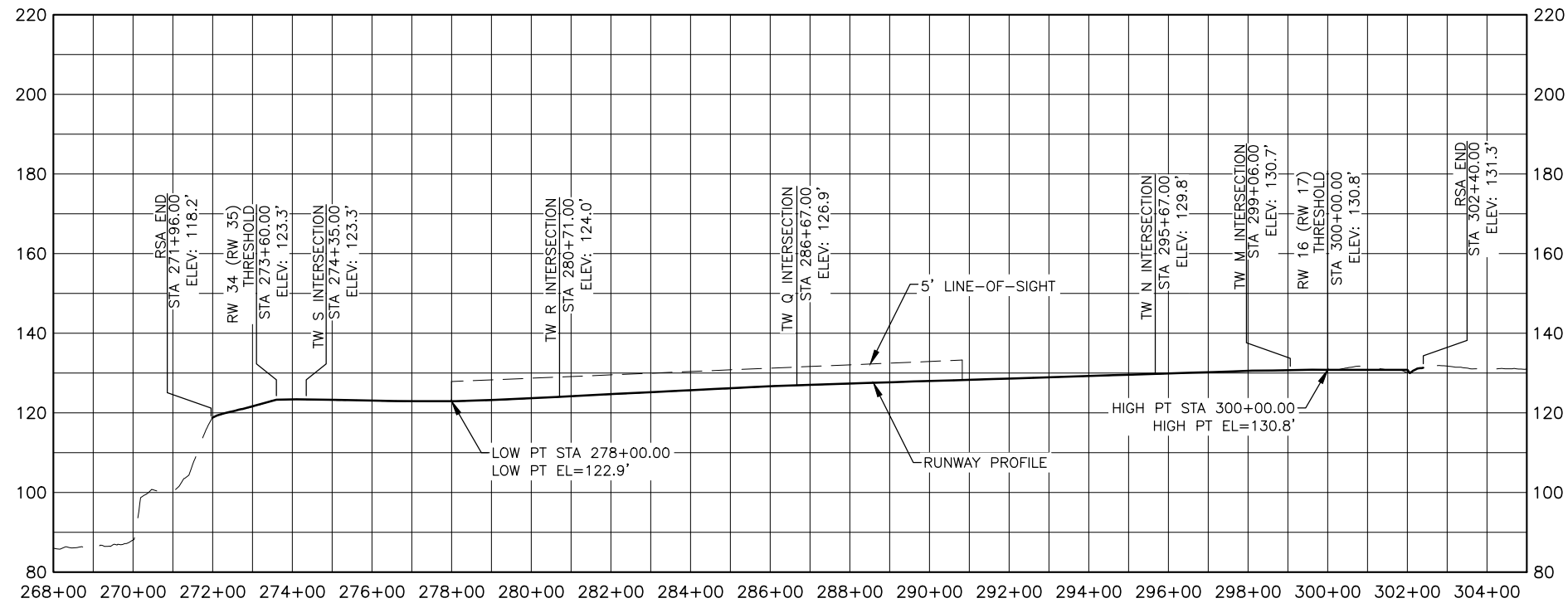

RUNWAY 16-34 (RW 17-35) PROFILE



NOTES:

- RUNWAY 7-25 (RW 8-26) MEETS LINE-OF-SIGHT CRITERIA PER FAA AC 150/5300-13B FOR RUNWAYS WITH FULL PARALLEL TAXIWAY.
- RUNWAY 16-34 (RW 17-34) MEETS LINE-OF-SIGHT CRITERIA PER FAA AC 150/5300-13B FOR RUNWAYS WITH FULL PARALLEL TAXIWAY.
- STATIONS FOR TAXIWAY INTERSECTIONS ARE APPROXIMATE.

MERRILL FIELD AIRPORT (MRI)

ANCHORAGE, ALASKA

RUNWAY PROFILES - SHEET 1 OF 2

NO.	REVISION	DATE	BY

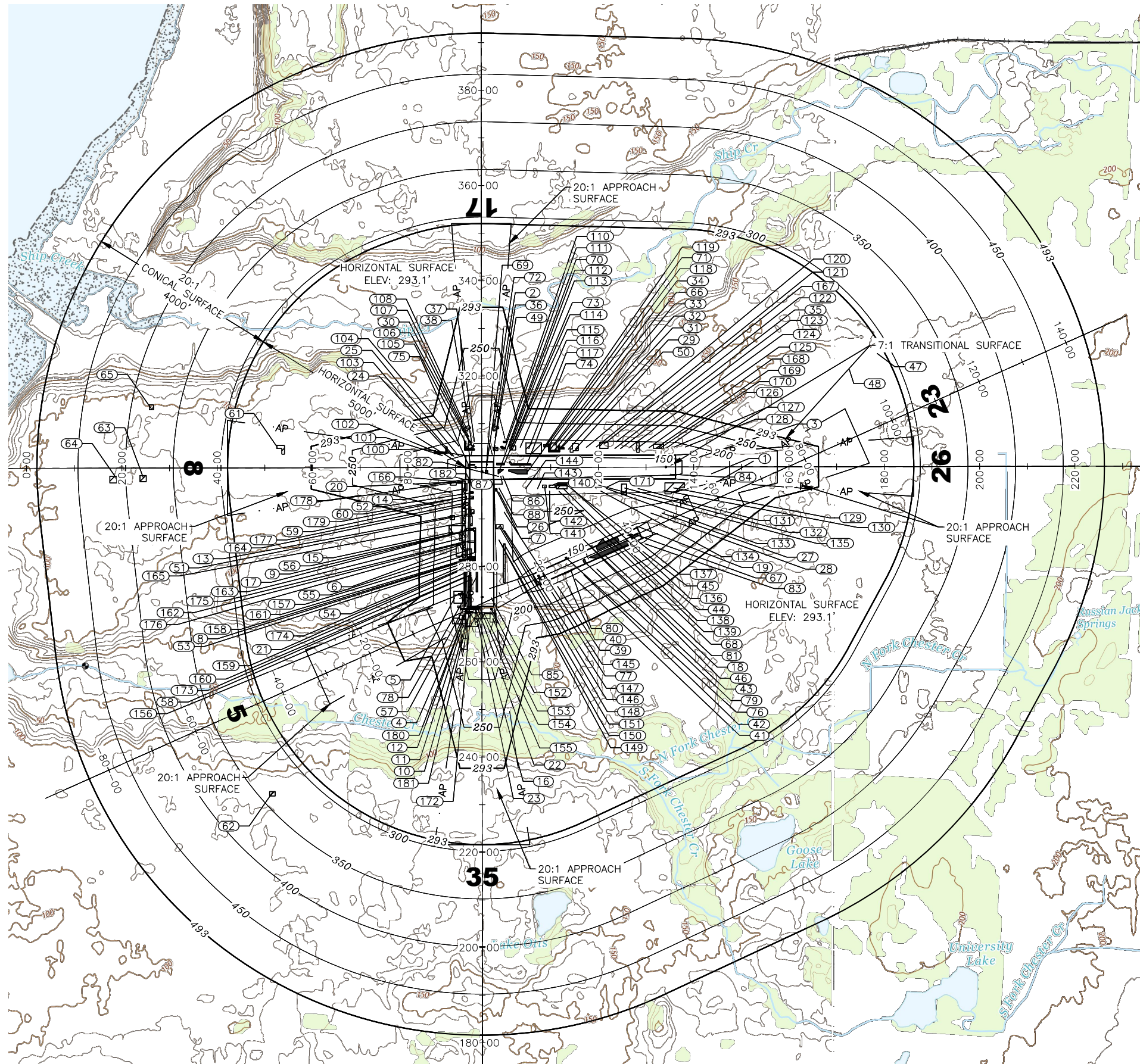

AIRPORT AIRSPACE PLAN

NOTES:

1. THE PRIMARY SURFACE WIDTH FOR RW 8-26 AND RW 17-35 IS 500'. THE PRIMARY SURFACE WIDTH FOR RW 5-23 IS 250'.
2. AIRPORT AIRSPACE PART 77 SURFACE SHOWN FOR ULTIMATE CONDITION.
3. THE AIRPORT AIRSPACE IS PROTECTED BY MUNICIPALITY OF ANCHORAGE AIRPORT ZONING HEIGHT REGULATIONS (AMC 21.65).
4. REFER TO INNER PORTION OF THE APPROACH SURFACE (SHEETS 10-14) FOR CLOSE IN OBSTRUCTIONS.
5. REFER TO SHEET 18 and 19 FOR 14 CFR PART 77 AIRPORT OBSTRUCTION DATA.
6. USGS QUAD ANCHORAGE (A-8) NE & NW QUADRANGLE, ALASKA, 2021.

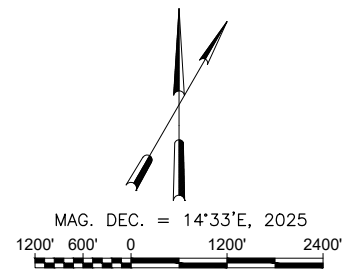

MERRILL FIELD AIRPORT (MRI)
 ANCHORAGE, ALASKA
AIRPORT AIRSPACE (14 CFR PART 77)

NO.	BY	DATE	REVISION

REVIEWED BY: CJB

DRAWN BY: AVA, AIL

DATE: 03/20/2025

FILE PATH AND NAME: H:\pba24\020 Merrill Field Airport Engineering (mif)06_mri_Alp Update\CAD\Drawings\ALP-MRI\Property Map.dwg

AIRPORT PROPERTY DETAILS

1. TRACT I - FEE SIMPLE:

A RESUBDIVISION OF THE ENTIRE PLAT OF MERRILL FIELD LEASE LOTS, FILED AS PLAT C-217, EXCEPT TRACTS B, C, & 4 AND ALSO EXCEPTING THOSE LANDS REVISED BY PLATS C-230; THE ENTIRE PLAT OF 64-136; THAT PORTION OF SECTION 16 BETWEEN AIRPORT HEIGHTS ROAD AND THE ABOVE REFERENCED LANDS NORTH OF THE SOUTH ROW OF MERRILL FIELD DRIVE AS SHOWN ON PLAT C-230; TRACTS 7, 8, 9, 10, FOURTH ADDITION TO ANCHORAGE TOWNSITE; TRACT C, ALASKA HOSPITAL SUBDIVISION, FILED AS PLAT 84-37; LOT 1A, BLOCK 10, MERRILL FIELD SUBDIVISION, FILED AS PLAT 67-99; INCLUDING THE VACATION OF ROW SHOWN ON MERRILL FIELD REPLAT, FILED AS PLAT 85-23.

EXCLUDING 3.00 ACRES OF ROW DEDICATED ALONG THE SOUTHERLY SIDE OF EAST 5TH AVENUE PER PLAT 2009-120.

SOURCE OF TITLE DOCUMENTS INCLUDE:

- BOOK 15 PAGE 333 (7/6/1929)
• BOOK 15 PAGE 334 (7/6/1929)
• BOOK 42 PAGE 148 (6/10/1936)
• BOOK 36 PAGE 5 (1/21/1943)
• FEDERAL PATENT NO. 1188090 (11/7/1958)
• BOOK 254 PAGE 319 (2/1/1963)
• BOOK 339 PAGE 62 (2/15/1967)
• STATE OF ALASKA PATENT NO. 857 BOOK 375 PAGE 70 (12/6/1968)
• BOOK 3 PAGE 272 (2/25/1975)
• STATE OF ALASKA PATENT NO. 4535 BOOK 451 PAGE 829 (11/7/1979)

2. TRACT II - FEE SIMPLE

TRACTS B & C, REPLAT TRACT 31, FOURTH ADDITION TO ANCHORAGE TOWNSITE, FILED AS PLAT C-154. EXCEPTING THEREFROM 0.15 ACRES RELEASED TO THE STATE OF ALASKA FOR GLENN HIGHWAY ROW PER MERRILL FIELD REPLAT, ADDN. NO. 6, FILED AS PLAT 2009-120.

SOURCE OF TITLE DOCUMENTS INCLUDE:

- BOOK 36 PAGE 123 (3/24/1943)

3. TRACT III - EXPIRED AVIGATION & HAZARD EASEMENT:

AVIGATION & HAZARD EASEMENT PER LEASE EXECUTED BY AND BETWEEN TERRITORY OF ALASKA, LESSOR AND CITY OF ANCHORAGE, LESSEE, RECORDED IN BOOK 201 AT PAGE 199, AND MODIFIED BY MISC. BOOK 233 AT PAGE 507, BOOK 17 AT PAGE 828, AND BOOK 89 AT PAGE 494. SAID LEASE EXPIRED ON JANUARY 31ST, 2013 AND HAS NOT BEEN RENEWED. THE AIRSPACE IN AND AROUND THE MERRILL FIELD AIRPORT IS PROTECTED BY MOA ZONING REGULATIONS (PAMC 21.06.030) AND OTHER GUIDELINES. SAID LEASE EXPIRED IN 2013.

4. TRACT IV - FEE SIMPLE

TRACTS 3 & 4, FOURTH ADDITION TO ANCHORAGE TOWNSITE, AS SHOWN ON THE OFFICIAL PLAT OF U.S. SURVEY NO. 1456, ACCEPTED JUNE 13, 1923.

SOURCE OF TITLE DOCUMENTS INCLUDE:

- FEDERAL PATENT NO. 1188090 (11/7/1958)
• STATE OF ALASKA PATENT NO. 857 BOOK 375 AT PAGE 70 (12/6/1968)

5. TRACT V - FEE SIMPLE

ALL OF TRACTS 1 & 2, FOURTH ADDITION TO ANCHORAGE TOWNSITE, AS SHOWN ON THE OFFICIAL PLAT OF U.S. SURVEY NO. 1456, ACCEPTED JUNE 13, 1923. EXCEPTING THEREFROM THAT PORTION OF ROW ISSUED TO STATE OF ALASKA DEPARTMENT OF TRANSPORTATION, AS SHOWN ON LAKE OTIS PARKWAY & DEBARR ROAD CHANNELIZATION ROW MAP, PROJECT NO. 58021, FILED AS PLAT 94-135.

SOURCE OF TITLE DOCUMENTS INCLUDE:

- STATE OF ALASKA PATENT NO. 857 BOOK 375 AT PAGE 70 (12/6/1968)

6. TRACT VI - FEE SIMPLE

LOTS 1 THRU 36, INCLUSIVE, BLOCK 1 AND LOTS 1 THRU 31, INCLUSIVE, BLOCK 2 OF EASTHAMPTON SUBDIVISION, FILED AS PLAT 79-54.

SOURCE OF TITLE DOCUMENTS INCLUDE:

- STATUTORY WARRANTY DEED IN DOCUMENT NO. 1981-021913-0 (4/29/1981).

7. TRACT VII - FEE SIMPLE

TRACT 9, MERRILL FIELD REPLAT ADDITION NO. 1, FILED AS PLAT 88-11.

SOURCE OF TITLE DOCUMENTS INCLUDE:

- DECLARATION OF TAKING IN BOOK 1107 AT PAGE 53 (6/4/1984)
• 2ND AMENDED DECLARATION OF TAKING IN BOOK 1748 AT PAGE 713 (6/16/1988)

8. TRACT VIII - FEE SIMPLE

LOTS 5, 6, 7, & 8, BLOCK 10, AND LOT 7, BLOCK 1, MERRILL FIELD SUBDIVISION, FILED AS PLAT P-164; LOT 5A, BLOCK 22B, THIRD ADDITION TO ANCHORAGE TOWNSITE, FILED AS PLAT 69-225; LOTS 1, 2, 3, & 4, BLOCK 23A, SUBDIVISION OF BLOCK 20, 21, 22, 23, & 24, THIRD ADDITION TO ANCHORAGE TOWNSITE, FILED AS PLAT C-28; LOTS 5A & 6A, BLOCK 23A, THIRD ADDITION TO ANCHORAGE TOWNSITE, FILED AS PLAT 77-238.

SOURCE OF TITLE DOCUMENTS INCLUDE:

- STATUTORY WARRANTY DEED IN DOCUMENT NO. 1986-079596-0 (10/29/1986)
• STATUTORY WARRANTY DEED IN DOCUMENT NO. 1986-079594-0 (10/29/1986)
• STATUTORY WARRANTY DEED IN DOCUMENT NO. 1986-024837-0 (4/21/1986)
• STATUTORY WARRANTY DEED IN DOCUMENT NO. 1986-079595-0 (10/29/1986)
• STATUTORY WARRANTY DEED IN DOCUMENT NO. 1986-092124-0 (12/15/1986)
• PERSONAL REPRESENTATIVE'S DEED IN DOCUMENT NO. 1986-092119-0 (12/15/1986)
• STATUTORY WARRANTY DEED IN DOCUMENT NO. 1986-092120-0 (12/15/1986)
• STATUTORY WARRANTY DEED IN DOCUMENT NO. 1986-092118-0 (12/15/1986)

- PERSONAL REPRESENTATIVE'S DEED IN DOCUMENT NO. 1986-092123-0 (12/15/1986)
• PERSONAL REPRESENTATIVE'S DEED IN DOCUMENT NO. 1986-092122-0 (12/15/1986)
• WARRANTY DEED IN DOCUMENT NO. 1986-092121-0 (12/15/1986)
• PERSONAL REPRESENTATIVE'S DEED IN DOCUMENT NO. 1986-092126-0 (12/15/1986)
• QUITCLAIM DEED IN DOCUMENT NO. 1986-092125-0 (12/15/1986)
• STATUTORY WARRANTY DEED IN DOCUMENT NO. 1986-092116-0 (12/15/1986)
• QUITCLAIM DEED IN DOCUMENT NO. 1986-092117-0 (12/15/1986)

9. TRACT IX - FEE SIMPLE

LOT 1A, BLOCK 1, MERRILL FIELD SUBDIVISION, THIRD ADDITION, FILED AS PLAT 84-139; LOTS 5, 6, 8, & 9, BLOCK 1, MERRILL FIELD SUBDIVISION, FILED AS PLAT P-164; LOT 1B, BLOCK 22B, THIRD ADDITION TO ANCHORAGE TOWNSITE, FILED AS PLAT 72-265; LOT 2B, BLOCK 23B, THIRD ADDITION TO ANCHORAGE TOWNSITE, FILED AS PLAT 66-114; LOTS 5 & 6, BLOCK 23B, SUBDIVISION OF BLOCK 20, 21, 22, & 23, THIRD ADDITION TO ANCHORAGE TOWNSITE, FILED AS PLAT C-28, EXCEPTING THEREFROM THE WEST 60 FEET.

SOURCE OF TITLE DOCUMENTS INCLUDE:

- WARRANTY DEED IN DOCUMENT NO. 1987-065850-0 (9/26/1987)
• WARRANTY DEED IN DOCUMENT NO. 1987-065852-0 (9/26/1987)
• WARRANTY DEED IN DOCUMENT NO. 1987-068683-0 (10/6/1987)
• WARRANTY DEED IN DOCUMENT NO. 1987-065851-0 (9/25/1987)
• WARRANTY DEED IN DOCUMENT NO. 1987-080948-0 (12/3/1987)
• WARRANTY DEED IN DOCUMENT NO. 1987-066182-0 (9/29/1987)

10. TRACT X - FEE SIMPLE

LOT 3A BLOCK 23B, A REPLAT OF THE EAST 1/2 OF LOTS 1, 2, & 3, BLOCK 23B, THIRD ADDITION, ANCHORAGE TOWNSITE, PER PLAT 71-169.

SOURCE OF TITLE DOCUMENTS INCLUDE:

- WARRANTY DEED IN DOCUMENT NO. 1989-020197-0 (3/24/1989)

11. TRACT XI - FEE SIMPLE

LOT 9 BLOCK 40, SUBDIVISION OF BLOCKS 36, 37, 38, 39, & 40, THIRD ADDITION TO ANCHORAGE TOWNSITE, FILED AS PLAT C-26.

SOURCE OF TITLE DOCUMENTS INCLUDE:

- WARRANTY DEED IN DOCUMENT NO. 1989-027469-0 (4/26/1989)

12. TRACT XII - FEE SIMPLE

LOTS 8, 10, 11, & 12 BLOCK 40, SUBDIVISION OF BLOCKS 36, 37, 38, 39, & 40, THIRD ADDITION TO ANCHORAGE TOWNSITE, FILED AS PLAT C-26.

SOURCE OF TITLE DOCUMENTS INCLUDE:

- STATUTORY WARRANTY DEED IN DOCUMENT NO. 1990-045091-0 (9/14/1990)

13. TRACT XIII - FEE SIMPLE

THE SOUTH 60 FEET OF THE NORTH 260 FEET OF BLOCK 11, EAST ADDITION TO ANCHORAGE TOWNSITE; LOTS 1B & 1C, BLOCK 9B, SUBDIVISION OF LOT 1A, BLOCK 9B, EAST ADDITION TO ANCHORAGE TOWNSITE, FILED AS PLAT 78-236; LOT 9 BLOCK 10, AND LOTS 10 & 11, BLOCK 1, MERRILL FIELD SUBDIVISION, FILED AS PLAT P-164; LOT 1B, BLOCK 23B, THIRD ADDITION TO ANCHORAGE TOWNSITE, FILED AS PLAT 66-114.

SOURCE OF TITLE DOCUMENTS INCLUDE:

- STATUTORY WARRANTY DEED IN DOCUMENT NO. 1992-000979-0 (1/8/1992)
• STATUTORY WARRANTY DEED IN DOCUMENT NO. 1991-034556-0 (8/19/1991)
• QUITCLAIM DEED IN DOCUMENT NO. 1992-005354-0 (2/7/1992)
• WARRANTY DEED IN DOCUMENT NO. 1992-013897-0 (4/6/1992)
• STATUTORY WARRANTY DEED IN DOCUMENT NO. 1991-039908-0 (9/23/1991)
• STATUTORY WARRANTY DEED IN DOCUMENT NO. 1991-044403-0 (10/21/1991)

14. TRACT XIV - FEE SIMPLE

LOT 1, EAST FIFTH AVENUE SUBDIVISION, PER PLAT 68-20. EXCEPTING THEREFROM 0.21 ACRES RELEASED TO THE STATE OF ALASKA FOR GLENN HIGHWAY ROW PER MERRILL FIELD REPLAT, ADDN. NO. 6, FILED AS PLAT 2009-120; THAT PORTION OF THE SW1/4 OF THE NE1/4, SECTION 20, TOWNSHIP 13 NORTH, RANGE 3 WEST, SEWARD MERIDIAN, ALSO KNOWN AS TRACT 8 EAST OF THE RESURVEY OF THE EASTCHESTER SUBDIVISION, & ADJACENT AREAS, FILED AS PLAT C-257A. EXCEPTING THEREFROM THAT PORTION CONVEYED TO THE CITY OF ANCHORAGE BY DEED IN BOOK 263 AT PAGE 75. ALSO EXCEPTING THEREFROM THAT PORTION TAKEN BY THE MUNICIPALITY OF ANCHORAGE BY DECLARATION OF TAKING IN BOOK 1107 AT PAGE 53, AND AS AMENDED BY 2ND AMENDED DECLARATION OF TAKING IN BOOK 1748 AT PAGE 713, ALSO KNOWN AS TRACT 9, MERRILL FIELD REPLAT ADDITION NO. 1, FILED AS PLAT 88-11.

SOURCE OF TITLE DOCUMENTS INCLUDE:

- STATUTORY WARRANTY DEED IN DOCUMENT NO. 1992-054671-0 (12/7/1992)
• CORPORATION QUITCLAIM DEED IN DOCUMENT NO. 1993-014122-0 (3/26/1993)

15. TRACT XV - FEE SIMPLE

LOT 4 BLOCK 23B, SUBDIVISION OF BLOCK 20, 21, 22, & 23, THIRD ADDITION TO ANCHORAGE TOWNSITE, FILED AS PLAT C-28.

SOURCE OF TITLE DOCUMENTS INCLUDE:

- STATUTORY WARRANTY DEED IN DOCUMENT NO. 1996-011211-0 (3/12/1996)

16. TRACT XVI - FEE SIMPLE

THE VACATION OF ROW OF EAST 13TH AVENUE BETWEEN NELCHINA STREET AND THE EAST BOUNDARY OF THE THIRD ADDITION TO ANCHORAGE TOWNSITE; THE VACATION OF ROW OF EAST 14TH AVENUE BETWEEN ORCA STREET AND THE EAST BOUNDARY OF THE THIRD ADDITION TO ANCHORAGE TOWNSITE. BOTH VACATIONS APPROVED PER MOA PLATTING AUTHORITY RESOLUTION NO. 96-34, FILED AS DOCUMENT NO.

1997-030803-0, AND REPLATTED FOR THE MERRILL FIELD REPLAT ADDN. NO. 4, FILED AS PLAT 97-42.

AND

LOT 5A BLOCK 23B, THIRD ADDITION TO ANCHORAGE TOWNSITE, PER PLAT 69-191. THE SOUTH HALF OF SAID LOT 5A WAS CONVEYED TO MOA DEPARTMENT OF PROJECT MANAGEMENT AND ENGINEERING, PER WARRANTY DEED IN DOCUMENT NO. 2002-007937-0, AND CORRECTIVE WARRANTY DEED IN DOCUMENT NO. 2002-040192-0.

SAID SOUTH HALF OF LOT 5A IS SUBJECT TO A RIGHT OF FLIGHT FOR THE PASSAGE OF AIRCRAFT, THE RIGHT TO RESTRICT THE HEIGHT OF STRUCTURES, AND THE PREVENTION OF ANY USE OF THE PROPERTY THAT WOULD INTERFERE WITH LANDING OR TAKING OFF OF AIRCRAFT AT THE MERRILL FIELD AIRPORT, AS DESCRIBED IN DOCUMENT NO. 2002-040192-0.

17. TRACT XVII - FEE SIMPLE

THE VACATION OF ROW OF A 30 FOOT BY 107.7 FOOT PORTION OF EAST 4TH AVENUE WEST OF LOT 1, EAST FIFTH AVENUE SUBDIVISION, FILED AS PLAT 68-20, AS APPROVED BY MOA PLATTING AUTHORITY RESOLUTION NO. 96-13A, FILED AS DOCUMENT NO. 1997-021177-0; THE VACATION OF ROW OF A PORTION OF EAST 7TH AVENUE BETWEEN MEDFRA AND ORCA STREETS, AND ORCA STREET BETWEEN EAST 7TH AND EAST 8TH AVENUES, AS APPROVED BY MOA PLATTING AUTHORITY RESOLUTION NO. 96-13B, FILED AS DOCUMENT NO. 1997-021178-0; THE VACATION OF ROW OF A PORTION OF ORCA STREET ADJACENT TO LOTS 8 THRU 12, BLOCK 40, THIRD ADDITION TO ANCHORAGE TOWNSITE, AS APPROVED BY MOA PLATTING AUTHORITY RESOLUTION NO. 96-13C, FILED AS DOCUMENT NO. 1997-021179-0; THE VACATION OF ROW OF SITKA STREET BETWEEN EAST 20TH AVENUE AND PARKSIDE DRIVE, AS APPROVED BY MOA PLATTING AUTHORITY RESOLUTION NO. 96-13D, FILED AS DOCUMENT NO. 1997-021180-0.

ALL OF THE ABOVE ROW VACATIONS WERE REPLATTED FOR THE MERRILL FIELD REPLAT ADDN. NO. 4, FILED AS PLAT 97-26.

18. TRACT XVIII - FEE SIMPLE

THE SOUTH 150 FEET OF BLOCK 1, THIRD ADDITION TO ANCHORAGE TOWNSITE, SHOWN AS AN UNSUBDIVIDED PORTION OF BLOCK 1, MERRILL FIELD SUBDIVISION, FILED AS PLAT P-164.

SOURCE OF TITLE DOCUMENTS INCLUDE:

- STATUTORY WARRANTY DEED IN DOCUMENT NO. 2007-043920-0 (7/11/2007)

19. TRACT XIX - FEE SIMPLE

ALL OF TRACT 2, THE EAST 175 FEET OF TRACT 3, AND THE EAST 175 FEET OF TRACT 5, REGIONAL FIRE TRAINING STATION SUBDIVISION, FILED AS PLAT 2008-116. SAID SUBDIVISION CONFORMS WITH THE LATEST VERSION OF THE MERRILL FIELD MASTER PLAN, AS ADOPTED BY THE MUNICIPAL ASSEMBLY.

SOURCE OF TITLE DOCUMENTS INCLUDE:

- STATE OF ALASKA PATENT NO. 4535 BOOK 451 PAGE 829 (11/7/1979)

20. TRACT XX - FEE SIMPLE

THE REMAINDER PORTION OF THE GLENN HIGHWAY ROW WITHIN LOT 3B, BLOCK 30B, MERRILL FIELD REPLAT, ADDN. NO. 6, FILED AS PLAT 2009-120, ALSO KNOWN AS THE NORTH 113 FEET OF LOT 3A, BLOCK 30B, EAST ADDITION TO ANCHORAGE TOWNSITE, FILED AS PLAT C-186; A PORTION OF THE GLENN HIGHWAY ROW ADJACENT TO THE EXISTING AIRPORT LEASE LOT 12C, BLOCK 2 MERRILL FIELD REPLAT, ADDN. NO. 6, FILED AS PLAT 2009-120; THE VACATION OF ROW OF MEDFRA STREET AS APPROVED BY MOA PLATTING AUTHORITY RESOLUTION NO. 2007-008, REPLATTED FOR THE MERRILL FIELD REPLAT, ADDN. NO. 6, FILED AS PLAT 2009-120.

SOURCE OF TITLE DOCUMENTS INCLUDE:

- COMMISSIONER'S QUITCLAIM DEED IN DOCUMENT NO. 2012-044875-0 (8/13/2010)

21. TRACT XXI - FEE SIMPLE

LOT 4A, BLOCK 40, THIRD ADDITION TO ANCHORAGE TOWNSITE, FILED AS PLAT 68-21.

SOURCE OF TITLE DOCUMENTS INCLUDE:

- WARRANTY DEED IN DOCUMENT NO. 2010-039713-0 (8/13/2010)

22. TRACT XXII - FEE SIMPLE

LOTS 10, 11, 12, 13, 14, 15, & 16, BLOCK 10, MERRILL FIELD SUBDIVISION, FILED AS PLAT P-164.

SOURCE OF TITLE DOCUMENTS INCLUDE:

- WARRANTY DEED IN DOCUMENT NO. 2015-048625-0 (10/16/2015)

23. TRACT XXIII - FEE SIMPLE

LOT 7, BLOCK 40, SUBDIVISION OF BLOCKS 36, 37, 38, 39, & 40, THIRD ADDITION TO ANCHORAGE TOWNSITE, FILED AS PLAT C-26.

SOURCE OF TITLE DOCUMENTS INCLUDE:

- WARRANTY DEED IN DOCUMENT NO. 2017-033406-0 (8/25/2017)

24. TRACT XXIV - AVIGATION AND HAZARD EASEMENT

TRACTS A & B OF ALASKA HOSPITAL SUBDIVISION, FILED AS PLAT 82-93; TRACTS A-1 & A-2 OF ALASKA HOSPITAL SUBDIVISION, FILED AS PLAT 84-37.

SOURCE OF TITLE DOCUMENTS INCLUDE:

- AVIGATION EASEMENT IN DOCUMENT NO. 1984-010220-0 (2/8/1984)

AIRPORT PROPERTY DETAIL NOTES

- 1. THE DESCRIPTIONS SHOWN ABOVE MAY NOT REFLECT THE EXACT LEGAL DESCRIPTION OF THE PARCEL.
2. THE DATES SHOWN IN PARENTHESIS IN THE ABOVE NOTES REPRESENT THE DATE OF RECORDING.
3. AREAS WERE COMPUTED FROM RECORDED INFORMATION.

MERRILL FIELD AIRPORT (MRI)

ANCHORAGE, ALASKA

PROPERTY MAP - SHEET 3 OF 3

Table with 10 columns and 1 row, containing vertical lines and the word 'REVISION' on the right side.

SHEET NO.:

23 OF 25

HALF-SCALE @ 11X17

