



**Municipality of Anchorage
Housing and Homelessness Services**

Office Use Only

Get Out Alive!

Disaster Preparedness and Emergency Evacuation Plan

A licensed homeless and transient shelter must have a disaster preparedness and emergency evacuation plan that includes evacuation procedures that will ensure the complete evacuation of clients, including clients with limited mobility, within 150 seconds (2 ½ minutes). This form is provided for your convenience to document your facility's Disaster Preparedness and Emergency Evacuation Plan or to use as a guideline for developing your own plan. All the requirements listed in this guideline are required as part of your Disaster Preparedness and Emergency Evacuation Plan.

The Disaster Preparedness and Emergency Evacuation Plan requires both a floor plan mapping your shelter's evacuation routes and a written plan describing the procedures to be followed.

The floor plan must include identification of:

- Smoke detectors, fire extinguishers, and carbon monoxide detectors;
- Escape routes from every room with doors and windows clearly marked for each level of the shelter facility; and
- Specified meeting place outside the facility.

The written plan must describe detailed procedures the shelter facility will follow, including:

- How the facility will ensure evacuation of everyone within 150 seconds, including clients with limited mobility, and clients who otherwise may need assistance in an emergency, including a client who is mentally, visually, or hearing impaired;
- What the facility will do during emergency situations or natural disasters that may affect the facility, including, as appropriate; fire, tsunami/ flooding, earthquake emergencies, lock-down, shelter in place and etc.;
- How the facility will conduct and record monthly emergency evacuation drills and ensure participation of all employees who are on duty during the scheduled drill;
- The location of disaster and first aid kit(s); and
- Training of staff on the implementation of the Disaster Preparedness and Emergency Evacuation Plan.

Sample Floor Plan Evacuation routes (each floor of the facility must be drawn separately)

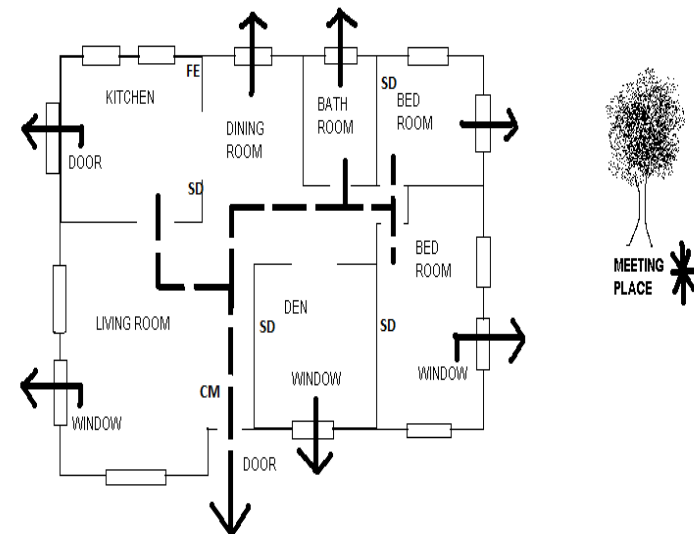

FE = Fire Extinguisher
SD = Smoke Detector
CM = Carbon Monoxide Detector

Facility Name: _____ Physical Address: _____

Facility Floor Plan:

[illegible]

Physical Address: _____

This image shows a single sheet of white paper with horizontal ruling lines. The lines are evenly spaced and run across the width of the page. There are no margins, text, or other markings on the paper.