

Submitted by: Chair of the Assembly at the request of
the Mayor

Prepared by: Maintenance & Operations Department

For Reading: December 13, 2005

CLERK'S OFFICE

APPROVED

Date: 1-24-06

ANCHORAGE, ALASKA

AO 2005-189

1 AN ORDINANCE SUBMITTING TO THE QUALIFIED VOTERS RESIDING IN THE
2 LAKEHILL LIMITED ROAD SERVICE AREA AND TO LOT 3, BLOCK 1, STONY BROOK
3 SUBDIVISION (TAX PARCEL 015-511-09-000-18); LOT 2, BLOCK 2, STONY BROOK
4 SUBDIVISION (TAX PARCEL 015-511-18-000-19); LOT 3, BLOCK 2, STONY BROOK
5 SUBDIVISION (TAX PARCEL 015-511-19-000-17); AND LOT 1, BLOCK 2, STONY BROOK
6 SUBDIVISION (TAX PARCEL 015-511-17-000-11) A BALLOT PROPOSITION TO ANNEX THE
7 STONY BROOK SUBDIVISION PARCELS ABOVE-REFERENCED TO LAKEHILL LRSA,
8 AND TO AMEND THE LAKEHILL LRSA BOUNDARIES IN ANCHORAGE MUNICIPAL
9 CODE SECTION 27.30.700, EFFECTIVE AS OF JANUARY 1, 2007.

10
11
12 WHEREAS, a petition has been received to alter the Lakehill LRSA by annexing Lot 3, Block 1,
13 Stony Brook Subdivision (Tax Parcel 015-511-09-000-18); Lot 2, Block 2, Stony Brook Subdivision
14 (Tax Parcel 015-511-18-000-19); Lot 3, Block 2, Stony Brook Subdivision (Tax Parcel 015-511-19-
15 000-17); and Lot 1, Block 2, Stony Brook Subdivision (Tax Parcel 015-511-17-000-11) to the Lakehill
16 LRSA and accordingly amending the Lakehill LRSA boundaries in Anchorage Municipal Code
17 section 27.30.700, effective as of January 1, 2007; and

18
19 WHEREAS, AS 29.35.450(c) requires a separate majority vote in the area to be annexed to the
20 Lakehill LRSA and a separate majority vote in the Lakehill LRSA; now therefore,

21
22 THE ANCHORAGE ASSEMBLY ORDAINS:

23
24 **Section 1.** Pursuant to Anchorage Municipal Charter 9.01(a), a ballot proposition in substantially
25 the following form shall be submitted to the qualified voters residing in the area to be annexed to the
26 Lakehill LRSA, namely, Lot 3, Block 1, Stony Brook Subdivision (Tax Parcel 015-511-09-000-18);
27 Lot 2, Block 2, Stony Brook Subdivision (Tax Parcel 015-511-18-000-19); Lot 3, Block 2, Stony
28 Brook Subdivision (Tax Parcel 015-511-19-000-17); and Lot 1, Block 2, Stony Brook Subdivision
29 (Tax Parcel 015-511-17-000-11), and to the qualified voters residing in the Lakehill LRSA at the
30 regular Municipal election April 4, 2006:

31
32 **Proposition** _____

33
34 APPROVING THE ANNEXING OF LOT 3, BLOCK 1, STONY BROOK
35 SUBDIVISION (TAX PARCEL 015-511-09-000-18); LOT 2, BLOCK 2, STONY
36 BROOK SUBDIVISION (TAX PARCEL 015-511-18-000-19); LOT 3, BLOCK 2,
37 STONY BROOK SUBDIVISION (TAX PARCEL 015-511-19-000-17); AND LOT
38 1, BLOCK 2, STONY BROOK SUBDIVISION (TAX PARCEL 015-511-17-000-
39 11) TO THE LAKEHILL LRSA AND AMENDING THE LAKEHILL LRSA
40 BOUNDARIES IN ANCHORAGE MUNICIPAL CODE SECTION 27.30.700,
41 EFFECTIVE AS OF JANUARY 1, 2007.

1 Shall the Lakehill LRSA boundaries be altered by annexing Lot 3, Block 1,
2 Stony Brook Subdivision (Tax Parcel 015-511-09-000-18); Lot 2, Block 2,
3 Stony Brook Subdivision (Tax Parcel 015-511-18-000-19); Lot 3, Block 2,
4 Stony Brook Subdivision (Tax Parcel 015-511-19-000-17); and Lot 1, Block
5 2, Stony Brook Subdivision (Tax Parcel 015-511-17-000-11) to the Lakehill
6 LRSA and accordingly amending the Lakehill LRSA boundaries in
7 Anchorage Municipal Code section 27.30.700, effective as of January 1,
8 2007?

9
10 Yes [] No []

11
12 Macbeth Drive is affected by this Proposition.

13
14 The existing mill rate in the Lakehill LRSA is 1.50 mills. Property owners
15 within the area to be annexed will incur an increase in property taxes
16 beginning with the tax year 2007.

17
18 **Section 2.** Anchorage Municipal Code section 27.30.700 is hereby amended by adding Lot 3,
19 Block 1, Stony Brook Subdivision (Tax Parcel 015-511-09-000-18); Lot 2, Block 2, Stony Brook
20 Subdivision (Tax Parcel 015-511-18-000-19); Lot 3, Block 2, Stony Brook Subdivision (Tax Parcel
21 015-511-19-000-17); and Lot 1, Block 2, Stony Brook Subdivision (Tax Parcel 015-511-17-000-11) to
22 the Lakehill LRSA, effective as of January 1, 2007.

23
24 **Section 3.** Section 2 of this ordinance shall become effective January 1, 2007 if, and only if, said
25 proposition is passed by a majority of qualified voters residing in the area to be annexed, namely,
26 Lot 3, Block 1, Stony Brook Subdivision (Tax Parcel 015-511-09-000-18); Lot 2, Block 2, Stony
27 Brook Subdivision (Tax Parcel 015-511-18-000-19); Lot 3, Block 2, Stony Brook Subdivision (Tax
28 Parcel 015-511-19-000-17); and Lot 1, Block 2, Stony Brook Subdivision (Tax Parcel 015-511-17-
29 000-11) and separately passed by a majority of the qualified voters residing in the Lakehill LRSA.
30 All other sections of this ordinance shall become effective upon passage and approval by the
31 Anchorage Assembly.

32
33 PASSED AND APPROVED by the Anchorage Municipal Assembly this 24th day of
34 January, 2006.

35
36 Annal. Fairclough
37
38 Chair

39
40 ATTEST:

41
42
43 Brian E. Dineen
44
45 Municipal Clerk

MUNICIPALITY OF ANCHORAGE
Summary of Economic Effects - General Government

AO 2005- 189

Title: AN ORDINANCE SUBMITTING TO THE QUALIFIED VOTERS RESIDING IN THE LAKEHILL LIMITED ROAD SERVICE AREA AND TO LOT 3, BLOCK 1, STONY BROOK SUBDIVISION (TAX PARCEL 015-511-09-000-18); LOT 2, BLOCK 2, STONY BROOK SUBDIVISION (TAX PARCEL 015-511-18-000-19); LOT 3, BLOCK 2, STONY BROOK SUBDIVISION (TAX PARCEL 015-511-19-000-17); AND LOT 1, BLOCK 2, STONY BROOK SUBDIVISION (TAX PARCEL 015-511-17-000-11) A BALLOT PROPOSITION TO ANNEX THE STONY BROOK SUBDIVISION PARCELS ABOVE-REFERENCED TO LAKEHILL LRSA, AND TO AMEND THE LAKEHILL LRSA BOUNDARIES IN ANCHORAGE MUNICIPAL CODE SECTION 27.30.700, EFFECTIVE AS OF JANUARY 1, 2007.

Sponsor: Mayor
Preparing Agency: Maintenance and Operations Department
Others Impacted: N/A

Mill Levy Changes: Reduction in Expenditures and Revenues based on the Lakehill LRSA maximum 1.50 mills. Assumed general annual assessed valuation increase of 5% per annum based on 3 year assessment history.

	FY07	FY08	FY09	FY10	FY11
Operating Expenditures:					
1000 Personal Services	-	-	-	-	-
2000 Supplies	2,580	2,710	2,850	3,000	3,150
3000 Contribution to Others	-	-	-	-	-
4000 Debt Service	-	-	-	-	-
5000 Capital Outlay	-	-	-	-	-
Total Direct Costs:	2,580	2,710	2,850	3,000	3,150
Add: 6000 Charge from Others	-	-	-	-	-
Less: 7000 Charge to Others	-	-	-	-	-
Function Cost:	2,580	2,710	2,850	3,000	3,150
Revenues:	2,580	2,710	2,850	3,000	3,150
Capital:	None	None	None	None	None
Positions:	None	None	None	None	None

PUBLIC SECTOR ECONOMIC EFFECTS:

No substantial public sector economic effects anticipated. Public sector estimated economic negative effects based on the maximum 1.50 mill levy are less than \$3,150 in year 2007 or any of the next four years. (Estimated 2007 Assessed Valuation of the proposed annexing parcels is \$1,720,000 x Service Area maximum mill levy of 1.50 mills = \$2,580 for Tax Year 2007).

PRIVATE SECTOR ECONOMIC EFFECTS:

No substantial private sector economic effects anticipated. Private sector estimated economic negative effects are less than \$3,150 in year 2007 or any of the next four years. If approved, private property owners of the proposed annex parcels will pay an increase property tax in the amount of \$150 per \$100,000 assessed value annually for the Lakehill LRSA annual road maintenance service costs.

Prepared by: Gerald A. Pineau, Senior Admin. Officer, Resource Management Division
Recommended by: Alan J. Czajkowski, Director, Maintenance & Operations Dept.
Attached: Proposed De-Annex Parcels Map
Lakehill LRSA Map



MUNICIPALITY OF ANCHORAGE
ASSEMBLY MEMORANDUM

AM 902-2005

Meeting Date: December 13, 2005

1 **FROM:** MAYOR

2
3 **SUBJECT:** AN ORDINANCE SUBMITTING TO THE QUALIFIED VOTERS RESIDING IN
4 THE LAKEHILL LIMITED ROAD SERVICE AREA AND TO LOT 3, BLOCK 1,
5 STONY BROOK SUBDIVISION (TAX PARCEL 015-511-09-000-18); LOT 2,
6 BLOCK 2, STONY BROOK SUBDIVISION (TAX PARCEL 015-511-18-000-19);
7 LOT 3, BLOCK 2, STONY BROOK SUBDIVISION (TAX PARCEL 015-511-19-
8 000-17); AND LOT 1, BLOCK 2, STONY BROOK SUBDIVISION (TAX PARCEL
9 015-511-17-000-11) A BALLOT PROPOSITION TO ANNEX THE STONY BROOK
10 SUBDIVISION PARCELS ABOVE-REFERENCED TO LAKEHILL LRSA, AND
11 TO AMEND THE LAKEHILL LRSA BOUNDARIES IN ANCHORAGE
12 MUNICIPAL CODE SECTION 27.30.700, EFFECTIVE AS OF JANUARY 1, 2007.
13

14 The ordinance amends the Lakehill LRSA by annexing Lot 3, Block 1, Stony Brook Subdivision (Tax
15 Parcel 015-511-09-000-18); Lot 2, Block 2, Stony Brook Subdivision (Tax Parcel 015-511-18-000-
16 19); Lot 3, Block 2, Stony Brook Subdivision (Tax Parcel 015-511-19-000-17); and Lot 1, Block 2
17 Stony Brook Subdivision (Tax Parcel 015-511-17-000-11) to the Lakehill LRSA and amending the
18 Lakehill LRSA boundaries in Anchorage Municipal Code section 27.30.700, effective as of January 1,
19 2007.
20

21 The property owners petitioned to be annexed to the Lakehill LRSA. The annexation proposal meets
22 the requirements of the Municipal Charter and Code, State Statutes, and Assembly legislative policies.
23 The four parcels are accessible from Macbeth Drive and immediately abut the easterly boundary of the
24 Lakehill LRSA. Annexation to the existing Lakehill LRSA is in conformance with legislative policy
25 to minimize the number of new service areas, especially when it is feasible and practical to annex.
26

27 In order for the annexation to be effective, AS 29.35.450(c) requires a separate majority vote in the
28 Lakehill LRSA and a separate majority vote in the area proposed to be annexed to the Lakehill LRSA.
29

30 The Lakehill LRSA Board of Supervisors concurs and endorses the annexation of the four parcels to
31 the Lakehill LRSA, effective as of January 1, 2007.
32

33
34 THE ADMINISTRATION RECOMMENDS, AT THE REQUEST OF PETITIONING
35 RESIDENTS, THE ORDINANCE FOR A BALLOT PROPOSITION AMENDING THE
36 LAKEHILL LRSA BOUNDARIES BY ANNEXING LOT 3, BLOCK 1, STONY BROOK
37 SUBDIVISION (TAX PARCEL 015-511-09-000-18); LOT 2, BLOCK 2, STONY BROOK
38 SUBDIVISION (TAX PARCEL 015-511-18-000-19); LOT 3, BLOCK 2, STONY BROOK
39 SUBDIVISION (TAX PARCEL 015-511-19-000-17); AND LOT 1, BLOCK 2 STONY BROOK
40 SUBDIVISION (TAX PARCEL 015-511-17-000-11) TO THE LAKEHILL LRSA AND
41 AMENDING THE LAKEHILL LRSA BOUNDARIES IN ANCHORAGE MUNICIPAL CODE
42 SECTION 27.30.700, EFFECTIVE AS OF JANUARY 1, 2007.
43

- 1
- 2 Prepared by: Gerald A. Pineau, Sr. Adm. Officer, Resource Management Division
- 3 Recommended by: Alan J. Czajkowski, Director, Maintenance and Operations Department
- 4 Fiscal concurrence: Jeffrey E. Sinz, Chief Fiscal Officer
- 5 Concur: Denis C. LeBlanc, Municipal Manager
- 6 Respectfully submitted: Mark Begich, Mayor

Lakehill

Limited Road Service Area

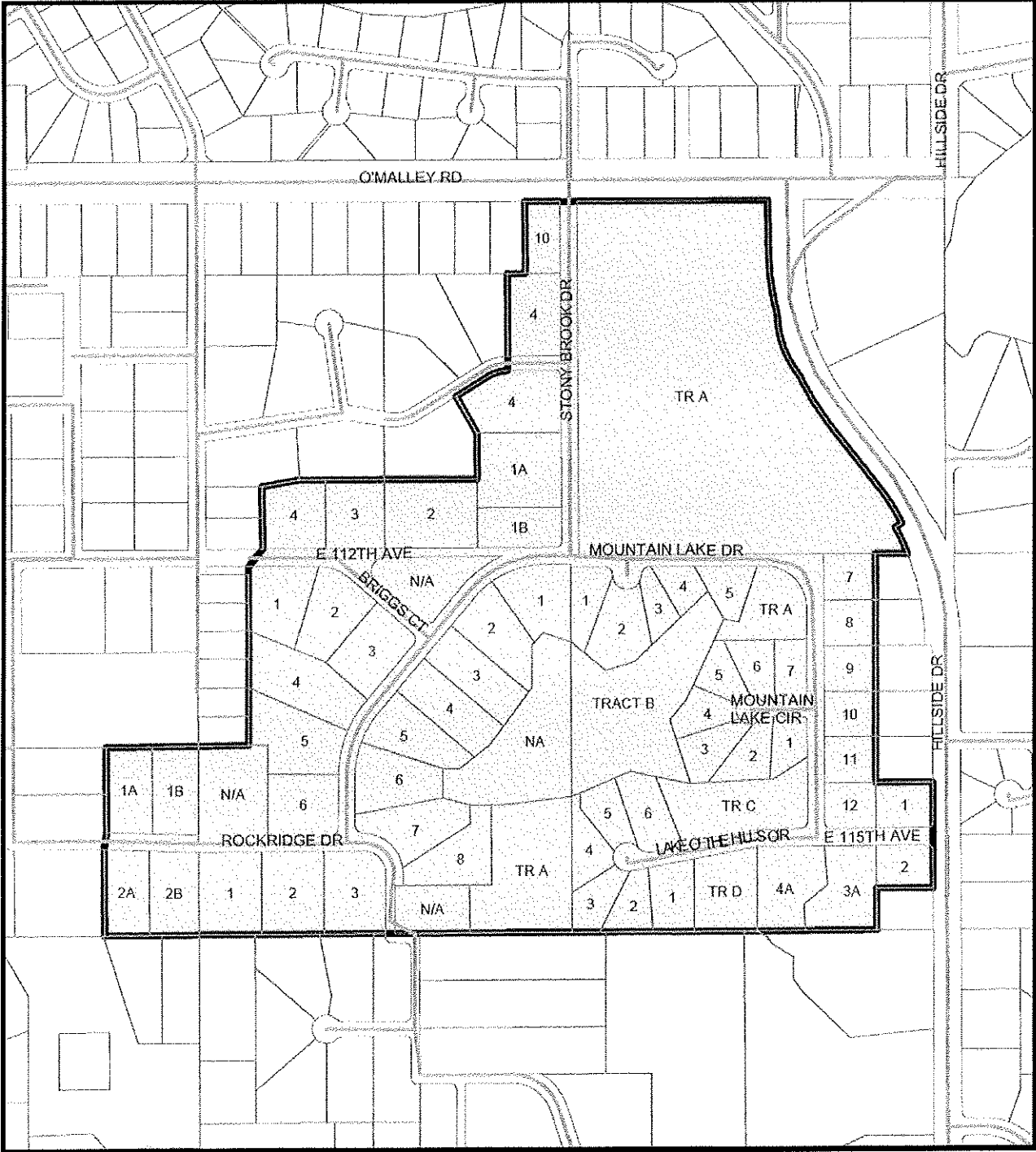

Content Information**Content ID :** 003440**Type:** Ordinance - AO

Ordinance Annexing Four Macbeth Drive Parcels to Lakehill

Title: LRSA, Effective as of January 1, 2007, Ballot Proposition for April 4, 2006 General Election**Author:** pineaug**Initiating Dept:** StreetMaint**Date Prepared:** 10/24/05 11:47 AM**Director Name:** Alan J. Czajkowski**Assembly Meeting
Date MM/DD/YY:** 12/13/05**Public Hearing Date
MM/DD/YY:** 1/10/06M.O.A.
2005 DEC -2 PM 1:31
CLERKS OFFICE**Workflow History**

<u>Workflow Name</u>	<u>Action Date</u>	<u>Action</u>	<u>User</u>	<u>Security Group</u>	<u>Content ID</u>
AllOrdinanceWorkflow	10/24/05 12:04 PM	Checkin	pineaug	Public	003440
AllOrdinanceWorkflow	10/24/05 3:02 PM	Reject	czajkowskij	Public	003440
AllOrdinanceWorkflow	10/24/05 3:35 PM	Checkin	pineaug	Public	003440
StreetMaint_SubWorkflow	10/24/05 4:41 PM	Approve	czajkowskij	Public	003440
OMB_SubWorkflow	10/27/05 9:54 AM	Approve	mitsonjl	Public	003440
AllOrdinanceWorkflow	11/4/05 1:39 PM	Reject	fehlenrl	Public	003440
AllOrdinanceWorkflow	11/9/05 8:20 AM	Checkin	pineaug	Public	003440
StreetMaint_SubWorkflow	11/9/05 1:24 PM	Approve	czajkowskij	Public	003440
OMB_SubWorkflow	11/15/05 10:01 AM	Approve	mitsonjl	Public	003440
Legal_SubWorkflow	11/15/05 2:48 PM	Approve	fehlenrl	Public	003440
MuniManager_SubWorkflow	11/25/05 2:02 PM	Approve	leblancdc	Public	003440
MuniMgrCoord_SubWorkflow	12/2/05 10:26 AM	Approve	abbottmk	Public	003440