

# Application for Park Master Plan

Municipality of Anchorage  
 Planning Department  
 PO Box 196650  
 Anchorage, AK 99519-6650



PETITIONER		PETITIONER REPRESENTATIVE (if any)	
Name (last name first) <b>Anchorage Parks &amp; Recreation Dept., Steve Rafuse</b>		Name (last name first)	
Mailing Address <b>Municipality Of Anchorage PO Box 196650 Anchorage, AK 99519-6650</b>		Mailing Address	
Contact Phone: Day <b>907-343-4586</b> Evening <b>907-343-4586</b>		Contact Phone: Day Evening	
Fax <b>907-249-7542</b>		Fax	
E-mail <b>rafusesj@muni.org</b>		E-mail	

PROPERTY INFORMATION			
Property Tax # <b>013-044-50-000, 012-182-14-000, 12-182-15-000, 013-061-02-000, 013-071-42-000, 013-071-43-000</b>			
Site Street Address: <b>8200 Stormy Place; 100E. 76<sup>th</sup> Avenue</b>			
Current legal description: (use additional sheet if necessary)  <b>See Attached</b>			
Zoning: <b>R2M, I-2</b>	Acreage: <b>63.19</b>	Grid #: <b>SW2230, SW2130, SW2131</b>	Underlying plat #: <b>74-0153, 77-0124, 74-0016</b>
Park Name: <b>Taku Lake Park</b>			
Park Classification: <input checked="" type="checkbox"/> Community Use <input type="checkbox"/> Special Use <input type="checkbox"/> Natural Resource Use <input type="checkbox"/> Neighborhood Use <input type="checkbox"/> Large Urban <input type="checkbox"/> Regional <input type="checkbox"/> Playlot, Mini Park, Vest Pocket <input type="checkbox"/> Not classified/other			
<input checked="" type="checkbox"/> New master plan <input type="checkbox"/> Amendment/revision to existing master plan    Original Case #:			

I hereby certify that (I am)(I have been authorized to act for) owner of the property described above and that I petition for a park master plan in conformance with Title 21 of the Anchorage Municipal, Code of Ordinances. I understand that payment of the application fee is nonrefundable and is to cover the costs associated with processing this application, and that it does not assure approval of the master plan. I also understand that assigned hearing dates are tentative and may have to be postponed by Planning Department staff or the Planning and Zoning Commission, for administrative reasons.

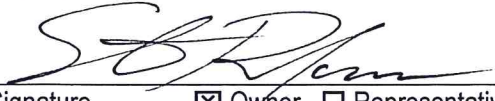

Signature     Owner     Representative (Agents must provide written proof of authorization)

Date **May 30, 2018**

Print Name **Steve Rafuse**

Accepted by: <b>Shawn Odell</b>	Poster & Affidavit: <b>3+1</b>	Fee: <b>5400.00</b>	Case Number: <b>2018-0082</b>	Requested Meeting Date: <b>08/13/18</b>
------------------------------------	-----------------------------------	------------------------	----------------------------------	--

**COMPREHENSIVE PLAN INFORMATION**

Anchorage 2020 Urban/Rural Services:  Urban  Rural

Anchorage 2020 Major Elements – site is within or abuts:

- Major employment center
- Redevelopment/mixed use area
- Town center
- Neighborhood commercial center
- Industrial reserve
- Transit - supportive development corridor
- District/area plan area:

Chugiak-Eagle River Land Use Classification:

- Commercial
- Industrial
- Parks/open space
- Public lands/institutions
- Town center
- Transportation/community facility
- Alpine/slope affected
- Special study area
- Development reserve
- Residential at \_\_\_\_\_ dwelling units per acre
- Environmentally sensitive area

Girdwood- Turnagain Arm Land Use Classification

- Commercial
- Industrial
- Parks/open space
- Public lands/institutions
- Resort
- Transportation/community facility
- Alpine/slope affected
- Special study area
- Reserve
- Residential at \_\_\_\_\_ dwelling units per acre
- Mixed use
- Rural homestead

**ENVIRONMENTAL INFORMATION** (All or portion of site affected)

- Wetland Classification:  None  "C"  "B"  "A"
- Avalanche Zone:  None  Blue Zone  Red Zone
- Floodplain:  None  100 year  500 year
- Seismic Zone (Harding/Lawson):  "1"  "2"  "3"  "4"  "5"

**RECENT REGULATORY INFORMATION** (Events that have occurred in last 5 years for all or portion of site)

- Rezoning - Case Number:
- Preliminary Plat  Final Plat - Case Number(s):
- Conditional Use - Case Number(s):
- Zoning variance - Case Number(s):
- Land Use Enforcement Action for
- Building or Land Use Permit for Picnic Shelter
- Wetland permit:  Army Corp of Engineers  Municipality of Anchorage

**APPLICATION REQUIREMENTS**

- 1 copy required:  Signed application (original)
- Watershed sign off form, completed
- 8 ½" by 11" copy of park master plan
- 35 copies required:  Signed application (copies)
- Park master plan
- Assembly Ordinance enacting zoning special limitations, if applicable
- Applicable parks board resolution or summary of parks board meeting(s)

(Additional information may be required.)

# TAKU LAKE PARK MASTER PLAN

---

PUBLIC HEARING DRAFT



M A R C H 2 0 1 8

# ACKNOWLEDGEMENTS

---

The Municipality of Anchorage Parks and Recreation Department and the planning team would like to recognize and thank all the individuals and organizations who have worked to create the *Taku Lake Park Master Plan*. A special thanks to the members of the advisory group for their dedication, insight and assistance. Additional thanks to the technical advisors and agency representatives who have shared their expertise and have provided input along the way.

## MUNICIPALITY OF ANCHORAGE

- John Rodda, Director of Parks & Recreation
- Josh Durand, Parks Superintendent

## PLANNING TEAM

### MOA Parks & Recreation

- Steve Rafuse, Project Manager
- Michelle Fehribach, Community Engagement Coordinator

### Bettisworth North

- Jonny Hayes, Landscape Architect

### R&M Consultants

- Van Le, Planner
- Taryn Oleson, Planner
- Katie Chan, Graphic Designer

## ADVISORY GROUP MEMBERS

- Kathie Anderson
- Kelly Borgstede
- Jason Borgstede
- Dana Griffin
- Matt Hemry
- Timothy Huit
- Doug Molyneaux
- Rebecca Roberts
- Jeff Schmitz

## TECHNICAL ADVISORS & AGENCY REPRESENTATIVES

- Blake Adolfae: Alaska Railroad Corporation
- Brittany Blain: ADF&G - Sport Fishing Division
- Dave Battle: ADF&G - Wildlife Division
- Kyle Cunningham: MOA Watershed Mgmt.
- Kris Langley: MOA Traffic
- Paul Hatcher: AWWU
- Francis McLaughlin: MOA Current Planning
- Stephanie Mormillo: MOA Traffic
- Joe Sanks: AWWU
- Tracy Smith: ADF&G - Habitat Division
- James Starzec: DOT&PF
- Cory Standorf: ADF&G - Wildlife
- Jeff Urbanus: MOA Watershed Mgmt.

# counter

## CHAPTER 1: INTRODUCTION

6

- 8 Overview
- 9 Land Use and Context  
Community Profile
- 10 History and Background  
Purpose of the Master Plan
- 10.1 Goal of the Master Plan
- 11 Guiding Principles
- 11.1 Core Values & Strategic Goals
- 11.2 Planning and Policy Documents
- 11.3 Antelope Valley Fair, Natural Resources, and Recreation Facility Plan
- 12 Antelope Valley
- 13 2040 Land Use Plan  
Antelope Valley and Regulations
- 14 Antelope Valley Regional Air Quality Management Plan  
Antelope Valley Regional Air Quality Management Plan

## CHAPTER 2: EXISTING CONDITIONS

16

- 18 Overview  
The Natural Environment
- 18.1 Topography
- 18.2 Soils
- 19 Vegetation
- 19.1 Riparian Wetlands
- 21 Land Use
- 21.1 Agriculture
- 21.2 Residential
- 21.3 Commercial
- 22 Developed Facilities
- 22.1 Access and Connectivity
- 24 Utilities
- 25 Use Areas
- 26 Rural Gateway
- 27 Urban Gateway
- 28 Core Area
- 29 Airport Area
- 29.1 North Valley

## CHAPTER 3: PLANNING AND PUBLIC INVOLVEMENT

30

- 32 Overview  
Planning and Public Involvement Process
- 32.1 Review of the Master Plan
- 33.1 Review of the Master Plan
- 34.1 Review of the Master Plan
- 36 Key Takeaways
- 36.1 Planning and Public Involvement
- 37.1 Review of the Master Plan
- 38.1 Review of the Master Plan

# nts

## ○ CHAPTER 4: THE MASTER PLAN

# 40

- 42** | Overview
  - Vision
  - Core Values
  - Preferred Alternative
    - 44. North Gateway
    - 48. Damocell Creek Stream Corridor
    - 52. Core Area
    - 56. South Gateway
    - 62. General Park Installations
    - 67. Programming
      - Maintenance

## ○ CHAPTER 5: IMPLEMENTATION

# 68

- 70** | Overview
  - Plan Approval and Adoption Process
  - Implementation Table
- 71** | Municipality of Anchorage Standard Specifications (M.A.S.S) Regulatory Framework – Title 21 Land Use Regulations
  - Funding Sources
    - 71. Municipal Park Bonds
    - State and Federal Grants
    - Fundraising
    - Capital Improvement Program (CIP)
    - Public-Private Partnerships
- 72** | Appendix A: Resolutions



TAKU LAKE PARK | master plan

# **CHAPTER 1: INTRODUCTION**

## OVERVIEW

Taku Lake Park is a 63.19 acre park located along the Campbell Creek Greenbelt in the Taku/Campbell neighborhood of Anchorage. The park is classified as a community use park and is comprised of six individual parcels, all owned by the Municipality of Anchorage and managed by the Parks and Recreation Department.

Taku Lake Park features both developed facilities and natural areas providing visitors with a variety of recreational experiences. While Taku Lake Park has well-used facilities, two of the most popular features at the park are the relatively undeveloped waterbodies of Campbell Creek and Taku Lake. In addition to providing opportunities for fishing, boating, and wildlife viewing; these natural areas also provide important habitat for fish and wildlife.

Residents and user groups alike identify Taku Lake Park as a valuable community asset. As the only community use park in the Taku/Campbell area, Taku Lake Park provides important opportunities for active and passive recreation in a quiet natural environment.

The park also offers convenient connections to the Campbell Creek Trail system. As part of the larger multi-use trail system, many bicycle commuters and neighborhood residents travel through or use the park on a daily basis.

The most recent master plan was completed in 1997 and upgrades to facilities are needed to address current issues and meet the demand for recreational facilities. The *Taku Lake Park Master Plan* provides a framework for the future management, maintenance and development of the park. The plan seeks to address issues and concerns, and identifies priorities for future improvements at the park.



## LAND USE AND CONTEXT

Located in the geographic center of the Anchorage Bowl, Taku Lake Park is the only community use park in the area. The park is surrounded by a mix of land uses including residential, commercial, and industrial; providing important separation between land uses historically considered incompatible.

To the north, west and south of the park is a mix of high density multi-family housing and single-family residential. Dimond Blvd, directly south of the park, is a Regional Commercial Center and Corridor as defined by the Anchorage 2040 Land Use Plan Map. Land uses to the east of the park are a mix of commercial, retail, and industrial with properties between the park and railroad corridor zoned I-1 Light Industrial and I-2 Heavy Industrial.

Taku Lake Park is accessible by vehicle with parking lots at two locations: Stormy Place in the south of the park, and 76th Ave in the northeast of the park approximately 100 yards west of the King Street intersection. Non-motorized trail users can access the park from the northeast and southwest via the Campbell Creek Trail and the north and south via the C Street Trail.



## COMMUNITY PROFILE

Approximately a quarter of Anchorage's population lives in the Taku Lake Park area. Twenty-three percent (69,368) of Anchorage's total population (299,107) lives in a census tract within two miles of the park. There are twelve census tracts with approximately 30% or more of their total area within a two mile buffer of Taku Lake Park. This sub-area includes census tracts: 18.01, 19, 23.02, 23.03, 24, 25.01, 25.02, 26.01, 26.02, 26.03, 27.12, and 28.11.

Income, population, and housing tenure vary greatly by census tract within the sub-area. Median household income across census tracts ranges from \$47,057 to \$108,655, with the sub-area median (\$76,512) slightly less than Anchorage as a whole (\$78,326). Households in census tracts to the east and west of Taku Lake Park tend to have higher incomes than census tracts to the north and south of the park.

Housing tenure in the sub-area mirrors Anchorage as a whole with 60% of households' owner occupied. Within the sub-area, housing tenure follows a similar pattern to median household income with home ownership higher in areas with higher household income.

The sub-area is also more diverse than Anchorage as a whole, with 61% identifying as white compared to 64.9% for Anchorage. Within the sub-area, census tracts vary significantly with more diverse census tracts such as 19 identifying as only 38.3% white compared to 72.1% in census tract 24.

The median age of the population in the sub-area is slightly older than Anchorage as a whole. However, median age varies greatly between census tracts. For example, the median age in census tract 19 is 28.7 while the median age in census tract 24 is 40.6.

Source: American Fact Finder, American Community Survey (2011-15)

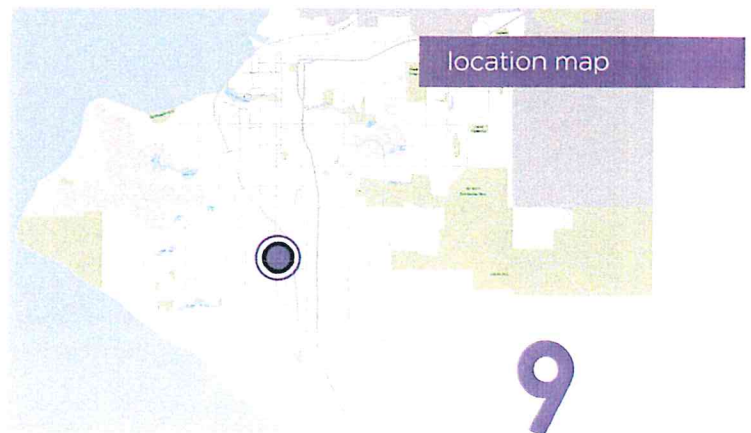

## HISTORY AND BACKGROUND

Taku Lake was originally formed as the result of gravel extraction in the area throughout the 1960s. In 1976, the Municipality acquired the property and in 1978 two tennis courts were constructed off of Rainy Place.

During the 1980s, development of the park began with the addition of two new parking lots, an adult fitness area, picnic areas, shoreline improvements, trails and open space. In 1989, the Anchorage Kiwanis Club donated a floating dock with ADA access. This dock was later removed after a 2002 incident in which a man drowned.

In the 1990s, Taku Lake Park saw further development with the addition of a picnic shelter and the construction of the Campbell Creek Trail.

In 1997, the Taku-Campbell Community Council and the Parks and Recreation Commission approved a master plan identifying further upgrades to existing facilities.

In 2003, a playground was built but was later destroyed in 2014 by arson. In 2004, a small skatepark was built and later upgraded with funding from the Anchorage Park Foundation in 2011. Also in 2004, a bridge across Campbell Creek was constructed connecting the park with C Street at 76th Ave.

In 2016, Anchorage Parks and Recreation began working with community members and park users to update the master plan for Taku Lake Park.

## PURPOSE OF THE MASTER PLAN

The *Taku Lake Park Master Plan* provides a guiding vision for the management, maintenance and development of Taku Lake Park by aiming to balance recreational uses with the preservation of important natural resources. This master plan identifies current and future needs, addresses issues and concerns, and establishes a framework for future development, management and maintenance consistent with the 20-year vision for the park.



### GOALS OF THE MASTER PLAN

- Understand community recreation needs as it relates to Taku Lake Park
- Identify and prioritize future improvements consistent with the community vision for the park
- Balance the development of new facilities with the preservation of existing natural areas
- Provide much needed investment and upgrades at the park
- Improve access, connections, and circulation to address areas of congestion and minimize conflicts between park and trail users
- Address community safety concerns such as homeless camps, vandalism, and petty crime
- Identify and develop strategic partnerships with public and private organizations to better manage, maintain, program, and invest in Taku Lake Park
- Create a tool for future fundraising

## GUIDING PRINCIPLES

The mission of the Anchorage Parks and Recreation Department is to ensure that Anchorage parks are well maintained and safe for the public. This mission is embodied in the motto "Healthy Parks, Healthy People".

To fulfill this mission, Anchorage Parks and Recreation is guided by a set of eight strategies or core values. These strategies guide the Parks and Recreation Department in the management of Municipal parklands and were established in the *Anchorage Bowl Park, Natural Resource, and Recreation Facility Plan (2006)*.

These eight strategies serve as the basis for future action and decision-making and are the product of a comprehensive and on-going public engagement process.

## CORE VALUES & STRATEGIC GOALS

1. Improve Maintenance and Stewardship of What We Have
2. Private-Public Partnership
3. Parks as Community Building Blocks
4. Parks as Economic Engines
5. Balanced Services & Facilities for a Diverse Community
6. Access and Connections
7. Stewardship of Natural Resources
8. Creating a Strong Parks and Recreation Organization

## PLANNING AND POLICY DOCUMENTS

Planning documents provide the framework for growth and development in Anchorage and identify tools to plan for future change. Comprehensive or area-specific plans, articulate the community's vision for the future based on identified priorities and shared values. These plans provide goals, objectives, strategies and policies that are intended to actively work to achieve the community vision. Specific use and functional plans provide more detail and direction for achieving use-specific goals. The following plans, policies, and principles helped to inform the development of the *Taku Lake Park Master Plan*.

### ANCHORAGE BOWL PARK, NATURAL RESOURCES, AND RECREATION FACILITY PLAN

The *Anchorage Bowl Park, Natural Resources, and Recreation Facility Plan (Park Plan)* provides a model for applying a systematic approach to the planning of parks, recreation, and natural use areas. The plan provides community leaders and citizens with measurable, objective, and defensible processes to acquire, develop, and manage parks, natural resources, and recreation facilities in the Anchorage Bowl.

The *Park Plan* classifies Taku Lake Park as a Community Use Area or Community Park. Community Use Areas serve a broader purpose and population than local neighborhood parks.

They provide opportunities for social interaction across neighborhoods, have higher technical design requirements, and increase the economic development potential of an area.

The *Park Plan* identifies broad strategies for improving Community Use Areas including "upgrades to existing parks and expanding facilities where possible to improve use, meet ADA and safety issues". Additional strategies include improvements to "access, trails, and connections" with specific recommendations for Taku Lake Park to "improve play areas, picnic grounds and waterfront areas". Redesign and development of Taku Lake Park may be appropriate to achieve the safety and use improvements desired.

## ANCHORAGE 2020

---

*Anchorage 2020* is the comprehensive plan for the Anchorage Bowl, which was adopted by the Assembly in 2001. This comprehensive plan is intended to guide development in Anchorage as the city continues to grow. The Plan provides general goals, objectives and policies on land use and recommends specific actions to guide decision makers over the life of the plan.

The *Taku Lake Park Master Plan* supports the following goals identified in the in *Anchorage 2020 Comprehensive Plan*;

- **Natural Open Space:** A network of natural open spaces throughout the community that preserves and enhances Anchorage's scenic vistas, fish, wildlife, and plant habitats and their ecological functions and values.
- **Water Resources:** Water resources and watersheds that are protected and enhanced for their enduring viability and values.
- **Wetlands:** A system of wetlands with functions and values that are preserved and enhanced.
- **Wildlife:** A wide diversity of fish, wildlife and habitats throughout the Municipality that thrives and flourishes in harmony with the community
- **Parks, Trails, and Recreation:** A sustainable and accessible system of recreational facilities, parks, trails, and open spaces that meets year-round neighborhood and community-wide needs.
- **Neighborhood Identity and Vitality:** A variety of safe, pleasant, and distinctive neighborhoods responsive to the diverse needs of residents, with good access to schools, recreation, natural areas and community facilities
- **Safety:** A community where people and property are safe.
- **Harmony with Nature:** An urban place that develops in harmony with its natural setting and is mindful of its natural hazards.



## 2040 LAND USE PLAN MAP

---

The *2040 Anchorage Land Use Plan Map* serves two main functions; to designate the future location and intensity of different land uses in the Anchorage Bowl and to help ensure the distribution of land uses will meet the future needs of Anchorage's growing population.

The *2040 Land Use Plan* carries forward the existing land uses of Taku Lake Park and the surrounding neighborhood. To the northwest of the park is multi-family housing, to the south, compact mixed housing and commercial uses, and to the east along 76th and King Street to the railroad corridor is light industrial/commercial land uses.

## MARIJUANA POLICY AND REGULATIONS

---

Taku Lake Park is located near industrial and commercial land uses which include the cultivation and sale of marijuana. The State of Alaska legalized the commercial cultivation, testing, and sale of marijuana in 2015. There are use-specific standards for marijuana establishments, as defined in *Anchorage Municipal Code (AMC) Title 21.05.055*, and requirements for separation from protected land uses. Parks themselves are not a protected land use that would require a minimum separation distance from marijuana establishments; however, some facilities within a park may be considered a protected land use.

Playgrounds, athletic fields and neighborhood recreation centers are protected land uses requiring a minimum of 500 feet of separation from marijuana establishments. Licenses for marijuana establishments are granted for the individual business owner, not the property.



## ANCHORAGE PEDESTRIAN PLAN

---

The *Anchorage Pedestrian Plan* was adopted in 2007 and establishes a 20-year framework for pedestrian facility improvements in the Anchorage Bowl. The plan identifies deficiencies in pedestrian infrastructure, makes recommendations for improvements, and lists priority projects for future investments.

Priority pedestrian projects were generally determined by using four criteria: pedestrian use potential; pedestrian-vehicle crash history; Anchorage 2020 policies; and proximity to schools, parks, neighborhood shopping and hospitals. The *Anchorage Pedestrian Plan* identifies improvements to the Dimond Boulevard and C Street pedestrian intersection near Taku Lake Park.

## ANCHORAGE BICYCLE PLAN

---

The *Anchorage Bicycle Plan* was adopted in 2010 and establishes a 20-year roadmap for bicycle infrastructure in the Municipality of Anchorage. The plan considers the Campbell Creek Trail as part of the Core Bicycle Network (Figure 11 of the *Anchorage Bicycle Plan*).

The Proposed Bicycle Network retains the Campbell Creek Trail through Taku Lake Park as an existing separated multi-use pathway and identifies King Street from Dimond Boulevard to 76th Avenue as an area eligible for bike lanes. The Proposed Bicycle Network also identifies the portion of 76th Avenue from the Alaska Railroad west to Taku Lake Park as a shared use roadway priority project.

Additionally, the *Anchorage Bicycle Plan* identifies roadway locations with the highest number of bicycle-vehicle crashes. Between 2002 and 2006, a total of 19 crashes occurred on Dimond Boulevard between the Seward Highway and C Street.

## AREAWIDE TRAILS PLAN

---

The *Areawide Trails Plan* was adopted in 1996 and serves as the primary 20 year planning and policy document for the development of trails throughout the Municipality of Anchorage. The *Areawide Trails Plan* establishes the foundation, policies and recommendations for all trail improvements and focuses on the development of integrated trails serving multiple recreational users and alternative modes of transportation.

The following goals relevant to Taku Lake Park and the Campbell Creek Trail are identified in the *Areawide Trails Plan* for the purpose of establishing a comprehensive trail system:

- Provides safe, convenient, year-round access to transit, schools, shops, major employment centers, historical facilities, and parks and recreational facilities;
- Strengthens the sense of community and neighborhood by linking neighborhoods and increasing the opportunity for people to interact;
- Provides recreation for people of all ages, abilities, and financial status;
- Provides new opportunities for outdoor education;
- Reduces crime by bringing responsible recreationalists into an area

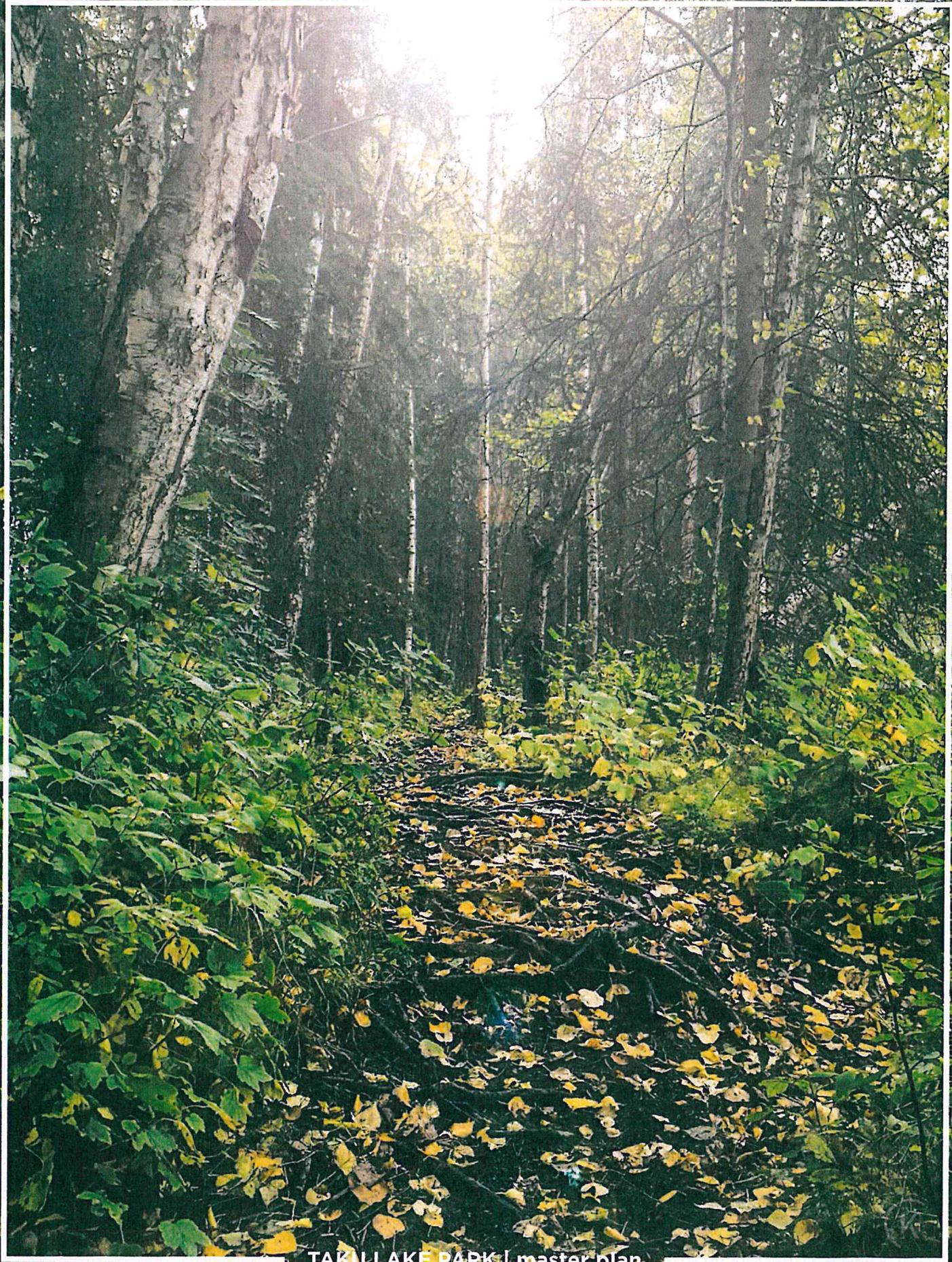

TAKU LAKE PARK | master plan



## **CHAPTER 2: EXISTING CONDITIONS**

## OVERVIEW

Taku Lake Park is a Community Use park located along the Campbell Creek Greenbelt in the Taku/Campbell neighborhood of Anchorage. The 63.19 acre park is a mix of developed facilities and natural areas providing visitors with a variety of park experiences in one easily accessible location. In addition to providing opportunities for recreation, the park provides valuable habitat for birds, fish, and wildlife.

Taku Lake Park is comprised of four distinct use areas, each unique and ranging in level of development and type of facilities. The North and South Gateway Areas are more developed and support a higher concentration of facilities. The Core Area and Campbell Creek Stream Corridor are home to important natural resources and are generally less developed.

The planning team utilized a variety of methods to evaluate existing conditions. Field research was conducted to identify use patterns and inventory conditions on the ground. Experts and stakeholders were interviewed to identify issues and to better understand how the park is used through the seasons. Additionally, data was collected and analyzed to determine development history, natural resource management practices, demographic trends, and facility use patterns.

This chapter describes existing conditions and is organized into three sections: the Natural Environment, Developed Facilities, and Use Areas.

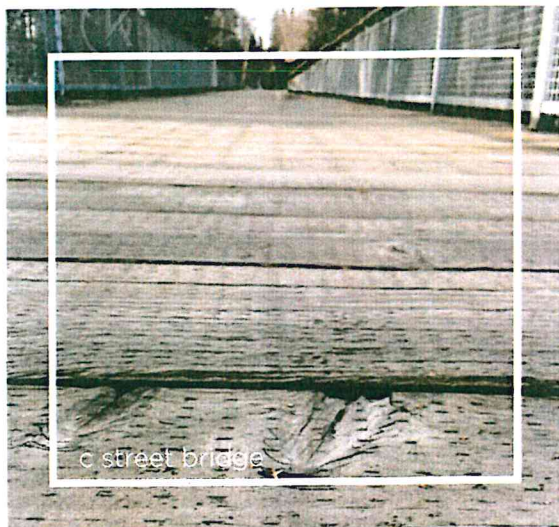

## THE NATURAL ENVIRONMENT

### TOPOGRAPHY

Most of Taku Lake Park is relatively flat with the average elevation between 65 and 75 feet above sea level. There are changes in elevation along the Lake Loop Trail east of Taku Lake, on the bluff west of Campbell Creek, and in the South Gateway area. MOA Geographic Information Systems (GIS) data shows Taku Lake at an elevation 62 feet above sea level. The highest point in the park, 96 feet above sea level, is located in the forested area south and east of Taku Lake. The lowest point in the park, 58 feet above sea level, is at C Street where Campbell Creek exits the park. The South Gateway area is slightly elevated from the rest of the park, between 65-85 feet above sea level. The North Gateway area is mostly flat at 62 to 75 feet above sea level, with the exception of the hill directly south of the parking lot which reaches an elevation of 90 feet above sea level.

Source: FEMA Flood Insurance Rate Map (FIRM) Panel 0744D

### SOILS

Taku Lake is a man-made lake and the result of gravel extraction during the 1960s. Aerial imagery and historic accounts suggest that gravel mining occurred until ground water inundation made operations too difficult. A review of Alaska Department of Fish and Game (ADF&G) bathymetric maps illustrate current lake depths, providing some insight into the extent of gravel operations.

The United States Department of Agriculture (USDA) Natural Resources Conservation Service identifies alluvial soils in low lying areas along the stream corridor and adjacent to the lake with intermixed layers of loam, silt, clay and gravel. Upland forests along the south boundary of the park are identified as being predominantly sand and gravel with silt, loam and clay at moderate depths. Because of variations in soils and depth of water table, geotechnical analysis should be conducted prior to future development.

Source: Alaska Department of Fish and Game, Taku Campbell Lake Bathymetric Map and Fishing Information, <http://www.adfg.alaska.gov/index.cfm?adfg=fishingSportLakeData.lakeDetail&LakeID=57>

Source: United States Department of Agriculture (USDA) Natural Resources Conservation Service (NRCS) Custom Soil Resource Report and Web Soil Survey (WSS) Map

## VEGETATION

Prior to gravel extraction, the area occupied by Taku Lake Park was a mix of spruce and treeless bog. Today, trees and woody shrubs dominate the park landscape. Native cottonwood (*Populus balsamifera*), black spruce (*Picea mariana*), and red alder (*Alnus rubra*) are the dominant species in low lying areas and along Campbell Creek. Native birch (*Betula papyrifera*) and white spruce (*Picea glauca*) are found in the upland forest south and east of Taku Lake.

The invasive Mayday tree, also known as the European Bird Cherry (*Prunus padus*), has an established presence in the park, most notably in areas along the Campbell Creek stream corridor. Without management and targeted eradication, this invasive species poses a threat to native ecosystems due to vigorous growth and rapid expansion.

Native and ornamental landscape plantings are located near the North Gateway parking area and in the raingarden, installed in 2007. The raingarden was established as a pilot project and is monitored by the Municipality of Anchorage Division of Watershed Management. The raingarden has performed beyond expectations and is projected to accommodate additional capacity.

Source: *Environmental Atlas of the Greater Anchorage Area Borough, Alaska*, Edited by Lidia L. Selkregg, 1972, p. 88)



## FISH AND WILDLIFE

Taku Lake Park and the Campbell Creek greenbelt provide important habitat to a variety of bird, fish, and wildlife populations. The area provides temporary and permanent residence for Chinook (King) salmon, Sockeye (Red) salmon, Coho (Silver) salmon, rainbow trout, beavers, moose, bear and a variety of birds.





The ADF&G records show 9,441 Chinook (King) salmon and 25,343 rainbow trout stocked in Taku Lake since 2012, or roughly 1,574 Chinook salmon and 4,223 rainbow trout stocked annually. ADF&G also stocks Campbell Creek with rainbow trout and Coho salmon. Fishing for Coho salmon is permitted on Campbell Creek from July 14th through September 30th in the area between Dimond Blvd. and Shelikof St. While fishing for Coho salmon is seasonally permitted, current ADF&G management prohibits fishing for Chinook and Sockeye salmon in Campbell Creek.

In recent years, beavers have become increasingly more active at Taku Lake and along Campbell Creek. Beavers removing trees have had negative impacts on shoreline health leading to erosion and destabilization in some areas. However, much of the vegetation sought by beavers has already been removed leaving beavers likely to move on and forage elsewhere.

Source: *Sport Fishing Lake Information*, Alaska Department of Fish and Game, <http://www.adfg.alaska.gov/index.cfm?adfg=Sport-StockingHatcheriesSearch.locationSearchResults&Stocking-AreaID=57&AreaID=2&SpeciesID=all&TopRecords=20>

Source: *Area Sport Fishing Reports*, Alaska Department of Fish and Game, [https://www.adfg.alaska.gov/sf/FishingReports/index.cfm?ADFG=R2.summary&Area\\_key=1&RecordID=7](https://www.adfg.alaska.gov/sf/FishingReports/index.cfm?ADFG=R2.summary&Area_key=1&RecordID=7)



-  Campbell Creek
-  Floodway
-  100 Year Floodplain
-  500 Year Floodplain
-  Class A Wetlands

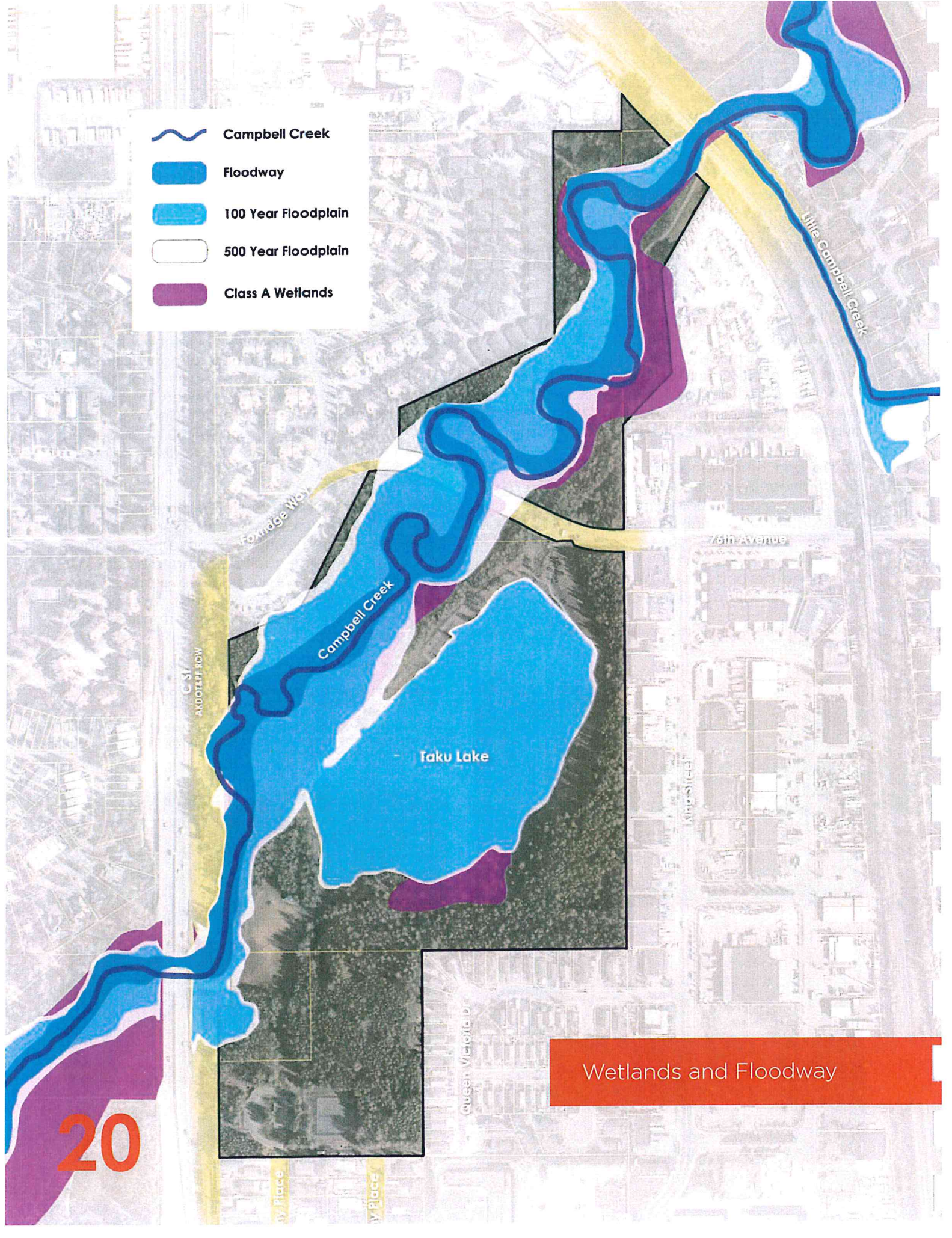

Wetlands and Floodway

# THE NATURAL ENVIRONMENT

## CAMPBELL CREEK

Campbell Creek is an anadromous stream originating in the Chugach Mountains. The creek flows through Anchorage as it makes its way to Cook Inlet. The creek traverses Taku Lake Park in an undeveloped riparian corridor directly west of the Campbell Creek Trail. The creek is part of the larger Campbell Creek Watershed which includes three upstream tributaries that drain approximately 70 square miles of land.

Campbell Creek is a key feature within the park, providing important habitat to fish and wildlife as well as opportunities for recreation. Fishing, boating, and wildlife viewing are all popular activities along Campbell Creek at Taku Lake Park. Campbell Creek also serves important ecosystem functions as it conveys meltwater and stormwater from upstream and surrounding areas that are increasing in development density, such as the UMED district and the C Street/King Street area respectively.

*Source: A Cultural And Historical Geography Of Campbell Creek, Anchorage, Alaska, Cherie Northon, Ph.D. For the Alaska Humanities Forum, August 2007)*

## TAKU LAKE

Taku Lake is a freshwater lake encompassing approximately 11.9 acres. The average depth of the lake is around 14-feet with a maximum depth of 22-feet just off of the western shore near the former fishing dock. Recently replaced culverts should increase overflow capacity into Campbell Creek, reducing flooding along the Campbell Creek Trail. There is evidence of subgrade flows or spring water entering the lake along the northwest edge, identified by consistent observations of late freeze-up and early thaws in that area. Taku Lake is a popular fishing destination with excellent shore fishing. ADF&G regularly stocks the lake with rainbow trout and Chinook salmon. Because of Taku Lake's cold water temperatures, swimming is not recommended.

*Source: Alaska Department of Fish and Game, Taku Campbell Lake Bathymetric Map and Fishing Information, <http://www.adfg.alaska.gov/index.cfm?adfg=fishingSportLakeData.lakeDetail&LakeID=57>*

## WETLANDS

Taku Lake Park includes two classified wetlands identified in the Anchorage Wetlands Management Plan. The Campbell Creek stream corridor and the majority of its floodplain are designated as Class A wetlands. Taku Lake and the low-lying area extending from the south shore are also designated as Class A wetlands. Additional wetland areas may exist in low lying areas in the south portion of the park between the fitness area and lawn. Field observations have identified areas of standing water and wetland vegetation not identified in the Anchorage Wetlands Management Plan. Additional geotechnical analysis should be conducted prior to future construction to confirm that selected sites are suitable for development.

*Source: Anchorage Wetlands Management Plan, Municipality of Anchorage Long Range Planning Department and Division of Watershed Management, 2012*

## FLOODPLAIN

Taku Lake Park includes a significant portion of land stretching along the north and west edges of the park that are located within the Campbell Creek floodway and flood plain. Generally, areas immediately adjacent to the stream are within the floodway, with the flood plain engrossing low areas that average 250-feet to 300-feet wide following the corridor. The flood plain includes additional areas that encompass the lake and its shores, as well as a low elevation portion of land at the southwest corner of the park near the C Street trail. Seasonal fluctuations and flooding can occur during spring melt and after periods of heavy rain.

*Source: FEMA Flood Insurance Rate Map (FIRM) Panel 0744D)*

*Source: MOA Geographic Information Systems Mapping*

## DEVELOPED FACILITIES

### ACCESS AND CONNECTIONS

**Vehicles and Parking:** Visitors arriving by vehicle can park at one of two parking lots located at the periphery of the park. This includes the North Gateway and South Gateway parking lots.

The North Gateway parking lot is located at the end of East 76th Avenue, 100 yards west of the King Street intersection. The parking lot has 34 spaces including two ADA, and a dead-end turnaround with a service gate used to access utilities and maintain the park. In the near term, the North Gateway area will continue to be the primary vehicle access point by visitors due to its proximity to major roads and easy access to popular park facilities. Traffic is anticipated to increase with the completion of the Seward Highway and 76th Avenue underpass project, connecting Taku Lake Park to neighborhoods east of the Seward Highway.

The South Gateway parking lot is located at the end of Stormy Way, a short unimproved local road accessible from westbound lanes on Dimond Boulevard. The parking lot has 38 parking spaces, including two ADA parking spaces, with a two-way traffic loop for ease in navigation. This parking lot is anticipated to see more traffic in the coming years as new facilities identified in this master plan are constructed.

**Pedestrian and Bicycle:** Pedestrians and bicyclist can easily access Taku Lake Park from the surrounding areas and adjoining neighborhoods. Taku Lake Park is located along the Campbell Creek Trail system providing pedestrians and bicyclists safe and convenient access to the park. The Campbell Creek Trail enters Taku Lake Park at the C Street underpass and continues north leaving the park at the Alaska Railroad underpass. Within the park, the Campbell Creek Trail and short spur trails provide access to the North and South Gateways as well as Taku Lake and the Campbell Creek stream corridor.

Taku Lake Park is also accessible at two locations via the C Street pathway. From the south, the C Street pathway intersects with the Campbell Creek Trail at the underpass in the southwest of the park. From the north, trail users along the C Street pathway can enter the park at Foxridge Way via a long bridge connecting to the Campbell Creek Trail at the south end of Taku Lake.

An asphalt paved trail at the end of Rainy Place and Queen Victoria Drive connect the neighborhood and commercial areas to the South Gateway area. Within the park, informal paths connect trails and facilities to surrounding neighborhoods.

### THE CAMPBELL CREEK TRAIL

The Campbell Creek Trail is one of Anchorage's premier multi-use trails providing access to Taku Lake Park from areas throughout the city. The trail traverses the park from north to south, connecting use areas within the park. The trail is paved 8-10 feet wide and groomed in the winter for Nordic skiing, walking, and fat-tire biking. Trail modifications, such as widening the trail to 12 feet and adding jogging shoulders, can improve circulation and minimize congestion in high use areas of the park.

**Right-of-Way:** An undeveloped right-of-way (ROW) traverses the park from 76th Ave west to C Street via Foxridge Way. Based on conversations with the Municipal Traffic Department, there are no current plans to develop the 76th Avenue ROW through the park. Further, a future road connection would be unlikely given the existing residential development, challenging topography and sensitive stream habitat. Vacation of the ROW is possible; however, a utility easement will need to be maintained for access to Anchorage Water and Wastewater Utility (AWWU) facilities and other utilities.

# Access and Connections

C Street Pathway

Foxridge Circle

MOA ROW

Campbell Creek Trail

Taku Lake

Lake Loop trail (Soft Surface)

Stormy Place  
MOA ROW

Rainy Place  
MOA ROW

Park Access Easements

Sorcere Ct

Queen Victoria St

King Street

Schoon Street

77th Avenue

80th Avenue

Dante Avenue



76th Avenue

-  Bike + Pedestrian Access Point
-  Vehicle Access Point
-  Parking Lot

## DEVELOPED FACILITIES

### UTILITIES

Utilities run throughout Taku Lake Park, providing access to sewer, water, and power. Currently, only lighting is developed within the park.

**Lighting:** Park standard lighting is installed along the Campbell Creek Trail and paved multi-use trail connecting the North and South Gateways. The South Gateway has lighting in the parking lot, skatepark, playground, and existing pavilion. The North Gateway parking lot has two lights.



**Water:** Water is available but currently undeveloped within the park. An AWWU water main runs through the park within the 76th Avenue Right-of-Way. A second water main runs along the south boundary of the park between Stormy Place and Queen Victoria Drive.

**Sewer:** Sewer is available but currently undeveloped within the park. AWWU maintains a sewer main running parallel to the Campbell Creek Trail along the west side of Taku Lake. The North Gateway and Campbell Creek Trail provide vehicle access to manholes needed to service the sewer line. A second sewer main runs north from Stormy Place through the park connecting to the sewer main near the southwest corner of Taku Lake.

**Stormwater:** Taku Lake and Campbell Creek provide valuable ecosystem services through the conveyance of stormwater from properties adjacent to the park. Campbell Creek receives stormwater from the Foxwood residential neighborhood, C Street (major arterial), and the King Street/76th Avenue light industrial district. Runoff from the Foxwood neighborhood and the King Street/76th Avenue areas are generally serviced by Oil-Grit Separators (OGS) prior to outfall into the stream. Maintenance of those systems is critical to maintaining the health of riparian and stream habitat. Runoff from C Street is not treated prior to discharge into the stream, but only serves a limited stretch of roadway.

Taku Lake serves as a collection basin for stormwater runoff from the residential neighborhood and commercial area south of the park. The system includes an OGS located within an easement on Queen Victoria Drive with overland treatment in vegetated areas before reaching the lake. The raingarden in the North Gateway effectively treats stormwater from the parking lot prior to entering Taku Lake.



## USE AREAS

Taku Lake Park has both developed facilities and natural areas which are organized into four geographic use areas. These areas include the North Gateway, South Gateway, Campbell Creek Stream Corridor, and Core Area. More developed areas such as the North and South Gateways have a higher concentration of developed facilities. While natural areas such as the Campbell Creek Stream Corridor and the Core Area see more passive use and have less intensive development.

STREAM  
CORRIDOR

NORTH  
GATEWAY

CORE AREA

SOUTH  
GATEWAY

## SOUTH GATEWAY

The South Gateway area has the highest concentration of developed facilities and is intended to be the most active area of the park. The South Gateway features a small skatepark, exercise stations, two tennis courts, a parking lot, and trail access. The playground was destroyed by arson in 2014 and has yet to be rebuilt. The South Gateway is currently under-used and with upgrades to facilities has the potential to be a city-wide destination.

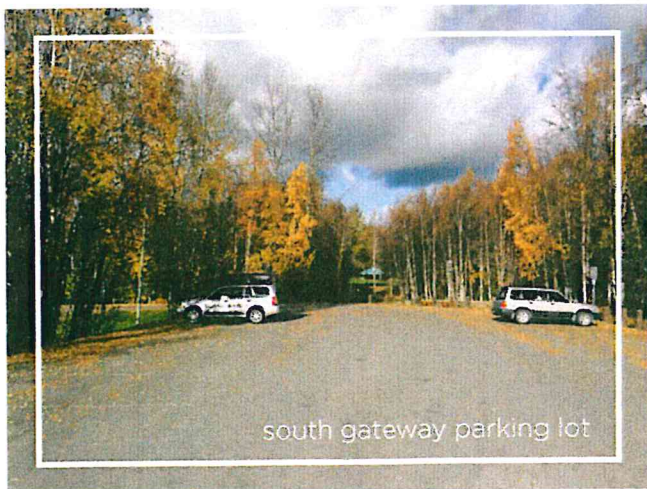

## NORTH GATEWAY

---

The North Gateway area is the primary vehicle access point into the park and provides convenient access to Taku Lake, Campbell Creek, and the trail system. The North Gateway features a large sloping lawn that is popular in the summer months, a parking lot, interpretive panels, rain garden, and access to fishing along Taku Lake and Campbell Creek. The North Gateway is also a popular starting point for trips beyond the boundaries of the park on the Campbell Creek Trail.

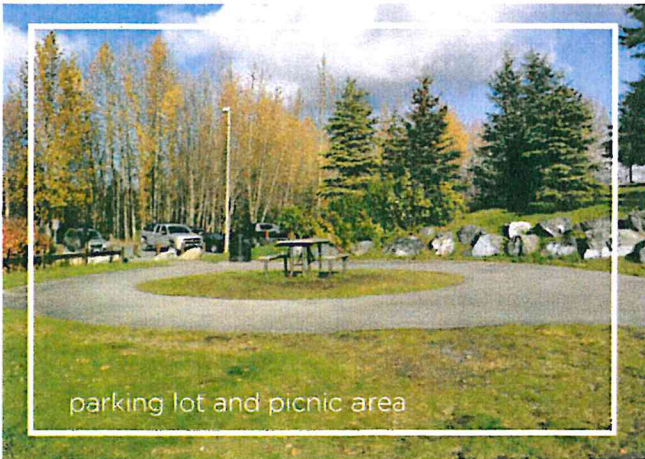

## CORE AREA

The Core Area is the heart of Taku Lake Park and includes the popular Lake Loop Trail, Taku Lake, the Campbell Creek Trail, and large lawn and pavilion. Park visitors enjoy a variety of seasonal activities in the Core Area including fishing, hiking, wildlife viewing, dog walking and boating in the summer; as well as Nordic skiing, sledding, and fat-tire biking in the winter.

The Core Area along the western edge of Taku Lake is one of the busiest areas of the park. This has resulted in shoreline trampling and erosion in high use areas. Further, the proximity of the Campbell Creek Trail to these high use areas has resulted in conflicts between trail users and park visitors.



lake loop trail

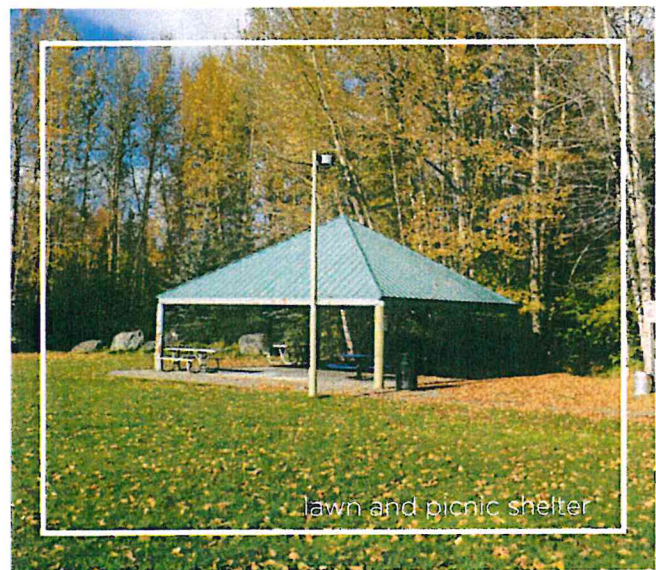

lawn and picnic shelter

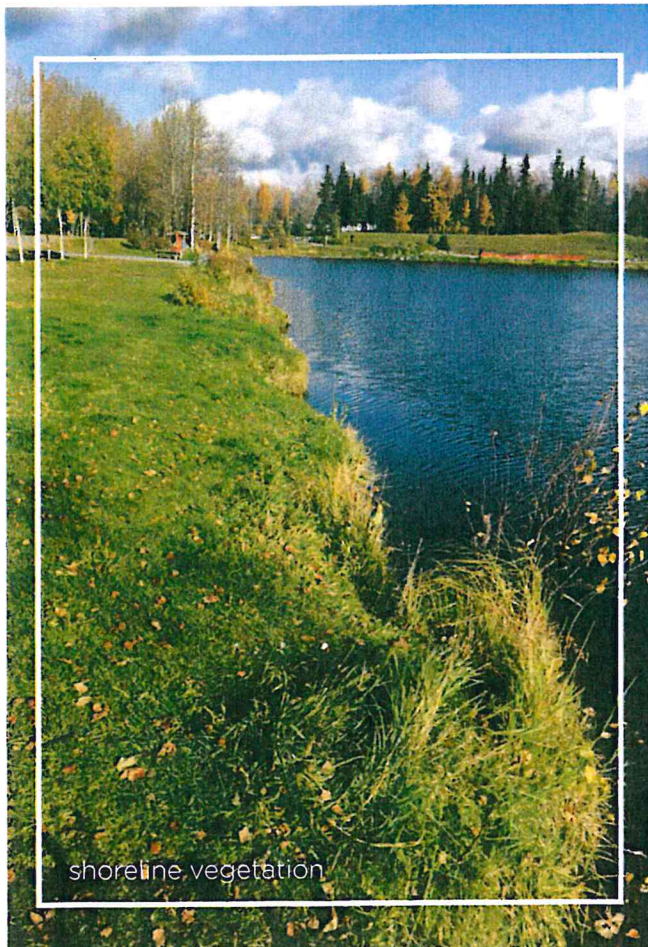

shoreline vegetation



campbell creek trail

## CAMPBELL CREEK STREAM CORRIDOR

The Campbell Creek Stream Corridor is a key feature within Taku Lake Park providing opportunities for recreation while also serving important ecosystem and habitat functions. The stream corridor is part of the larger Campbell Creek Greenbelt and development within the stream corridor is limited to the Campbell Creek Trail and supporting infrastructure. Recreation within the stream corridor is highly valued by paddlers, anglers, and wildlife enthusiasts. However, years of unfettered access has resulted in a complex network of trampled footpaths and eroded stream access points. In recent years, coordinated re-vegetation efforts between the MOA, ADF&G, and USFWS have helped to rehabilitate damaged areas within the greenbelt. Future efforts should consider controlled access to minimize future erosion while still supporting recreation within the stream corridor.

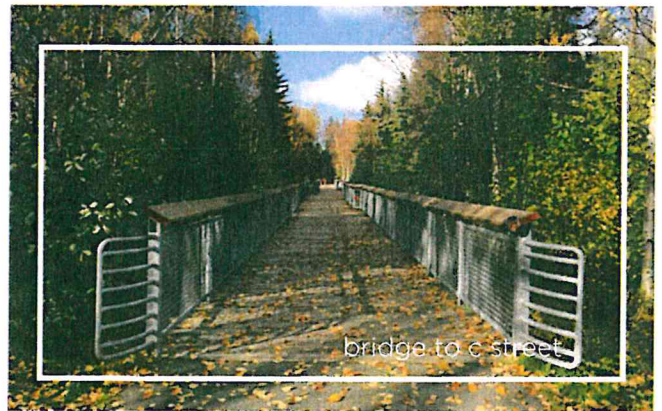
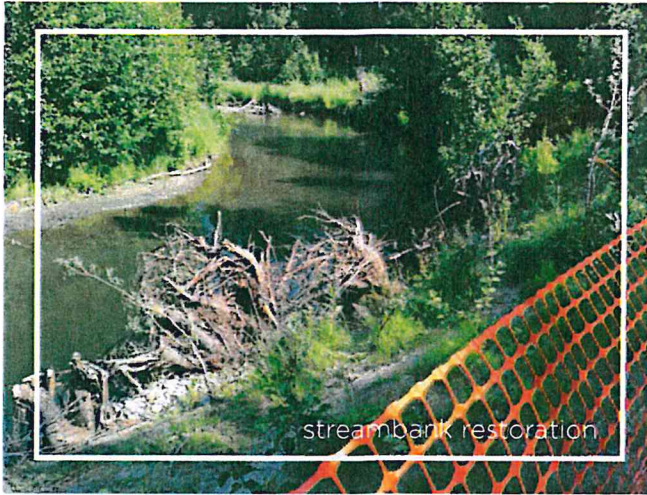



TAKU LAKE PARK | master plan

**CHAPTER 3:  
PLANNING AND  
PUBLIC INVOLVEMENT**

## OVERVIEW

Planning and public involvement is essential to ensure the long-term success of the *Taku Lake Park Master Plan*. Development of the master plan is guided by a number of factors including existing conditions, public preferences for management and development, and best practices in natural resource and public lands management.

This chapter is organized in two sections. The first section, Planning and Public Involvement Process, describes the planning and public involvement process used to guide the development of the master plan. The second section, Key Takeaways, provides a summary of common themes and key takeaways used to inform the development of the master plan.

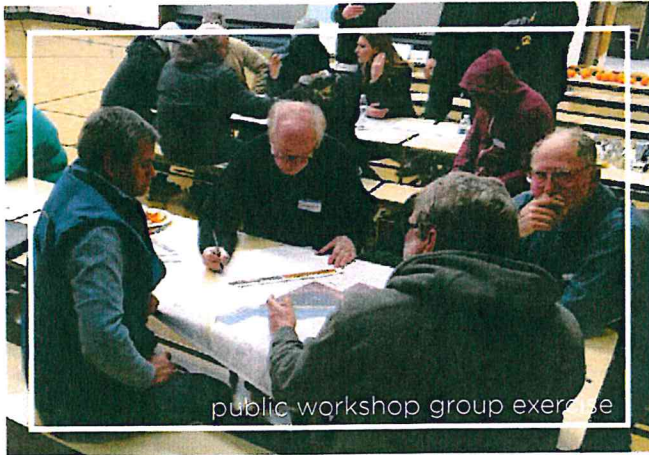

## PLANNING AND PUBLIC INVOLVEMENT PROCESS

The Taku Lake Park Master Plan provides a 20 year vision that identifies current and future needs and provides a framework for the management, maintenance, and development of the park.

Development of the Taku Lake Park Master Plan follows a three step process:

1. Research and Site Inventory
2. Outreach and Public Involvement
3. Concept Development and Master Plan

### RESEARCH AND SITE INVENTORY

Information was gathered early in the process to provide a foundation for future public involvement and plan development. The planning team conducted field research to identify use patterns and inventory existing conditions (see chapter 2).

Policy documents and land use plans were reviewed to provide context and ensure conformance with adopted plans. Experts and stakeholders were also interviewed to identify issues and concerns as well as to better understand user perceptions of the park.

### RESEARCH AND SITE INVENTORY

### OUTREACH AND PUBLIC INVOLVEMENT



## OUTREACH AND PUBLIC INVOLVEMENT

Meaningful public involvement throughout the process ensures that the future management and development of Taku Lake Park is consistent with the needs and desires of the community. The *Taku Lake Park Master Plan* was developed over a year long process that included three meetings with an advisory group, two community workshops, an online community survey, and an agency coordination meeting. All meeting summaries and outreach materials are included as Appendix B: Meeting Materials and Minutes

 **Outreach:** Outreach to stakeholders and the Taku/Campbell community occurred throughout the plan development process with emphasis on major milestones; such as before community workshops, to share meeting information and results, and to distribute the online survey.

 **Advisory Group:** An advisory group representing user groups and the Taku/Campbell community worked with the planning team throughout the development of the master plan to ensure that recommendations align with community priorities. Advisory group members represented a diverse range of park users including representatives from the tennis, skateboarding, and dog walking community; business owners, elementary school faculty, neighborhood residents, and Trail Watch program members.

 **Online Survey:** An online survey was conducted following the first community workshop to better understand how people use the park. Respondents were asked what issues and concerns they would like to see addressed and what future improvements they would like to see in the park. Survey results were used to help to identify preferences for future management and development. The survey results were shared with the advisory group and at the second Community Workshop.



 **Community Workshops:** The planning team hosted two community workshops to gather input, identify issues, and solicit feedback from members of the public. Workshops were held at the "visioning" and "concept development" phases and were used to identify priorities and inform the development of the master plan.

 **Agency Coordination:** An agency coordination meeting was held at the "concept development" phase to ensure that future recommendations are both feasible and complimentary to development in and around the park. The planning team met with state and local agency representatives to review information gathered to date and to discuss any possible opportunities and/or constraints that may impact implementation. Input from this meeting was used to refine concept alternatives into a preferred master plan.

### CONCEPT DEVELOPMENT AND MASTER PLAN



AGENCY  
COORDINATION  
MEETING



PUBLIC MEETING #2



ADVISORY GROUP  
MEETING #3



PARKS AND RECREATION  
COMMISSION APPROVAL



PLANNING AND ZONING  
COMMISSION APPROVAL

## CONCEPT DEVELOPMENT AND MASTER PLAN

Concept alternatives were developed utilizing a collaborative design approach based on community identified priorities. Concept alternatives are intended to illustrate the community's vision and provide a visual representation of public preferences for future improvements.

The planning team worked with the advisory group to develop three concept alternatives illustrating potential approaches to future development of the park. Prior to advancing these concepts for public review, the planning team met with state and local agencies to determine feasibility and identify possible constraints. Concept alternatives were refined and presented to the public at the second community workshop for additional input and feedback.



### CONCEPT ALTERNATIVES

Because of Taku Lake Park's size and distinct use areas, each concept was split into three regions: North Gateway, South Gateway, and Core Area.

Enlargements of the North and South Gateway areas were provided at the second workshop to illustrate spatial relationships under different development scenarios (see next page).

Public workshop participants worked in groups and were tasked with identifying their preferred alternative for each park region. Input was recorded and a final preferred alternative was developed.

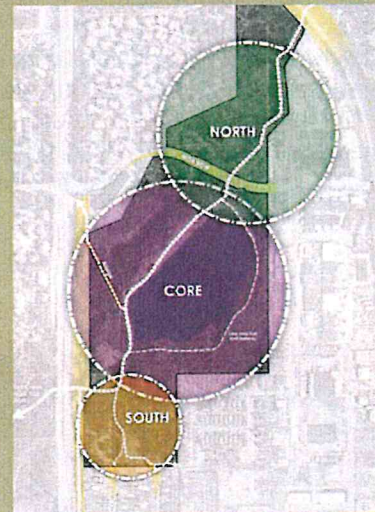

taku lake park - north gateway concepts

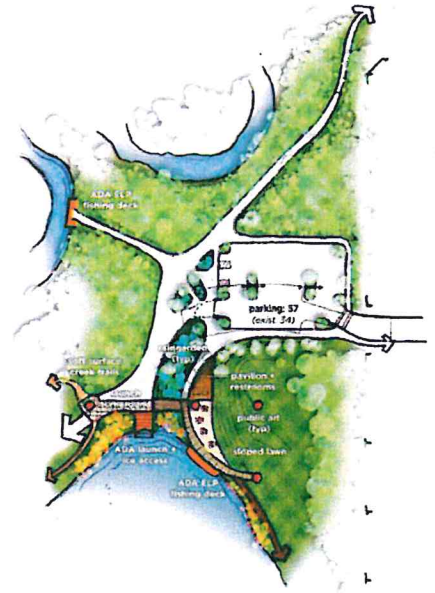
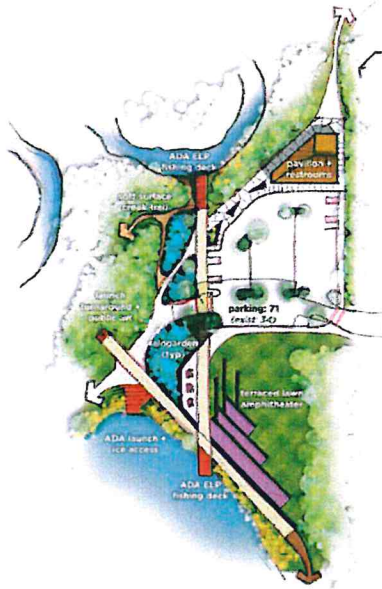
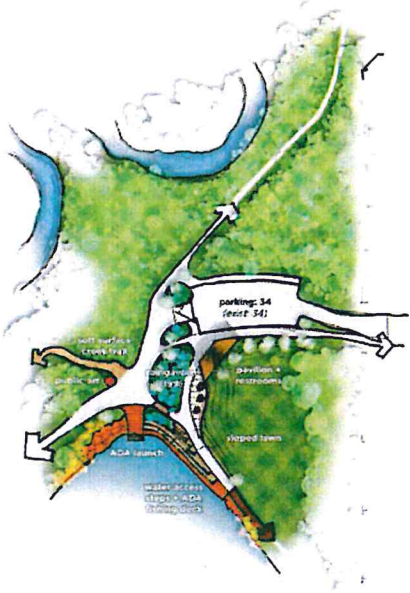

taku lake park - south gateway concepts

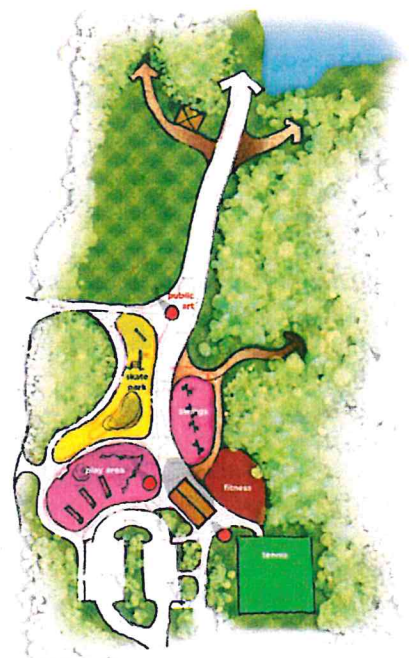
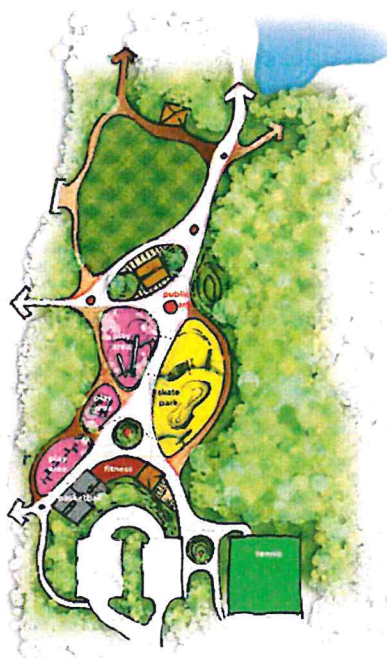
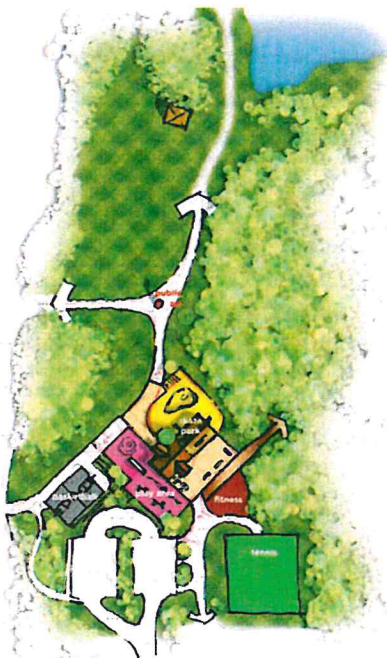

## KEY TAKEAWAYS

Public input gathered throughout the planning process yielded common themes which were used to inform the development of the master plan. Through a variety of methods such as online surveys, public workshops, and advisory group meetings; community members provided valuable information, helping the planning team to identify key assets and priorities for future management and development.



## COMMON THEMES

Members of the community identified numerous attributes which they consider make Taku Lake Park special. These common themes are widely recognized by the public as worth preserving or improving at the park.

**Access to Nature:** Taku Lake Park is valued as an oasis in the middle of an increasingly urbanizing Anchorage.

**A Balance of Developed Facilities and Natural Areas:** Taku Lake Park has a good balance of developed facilities and undeveloped natural areas.

**Location and Access:** Taku Lake Park's central location makes the park easily accessible from the Campbell Creek Trail, neighborhoods and nearby commercial areas.

**Year-round Recreation:** Taku Lake Park provides opportunities for recreation in all seasons of the year.

**Taku Lake and Campbell Creek:** Taku Lake Park features unique natural attractions such as Taku Lake and Campbell Creek, as well as forest and riparian areas that support wildlife.

**A Variety of Trails:** Taku Lake Park has a variety of trails providing for a range of experiences, including the Campbell Creek Trail and the Lake Loop trail.

**Mix of Activities:** Taku Lake Park's balance of developed facilities, natural areas, trails, and amenities provide something for everyone to enjoy the park.

## COMMUNITY PRIORITIES

---

Community priorities for the future of Taku Lake Park range from improving maintenance and restoring damaged natural areas to investments in new facilities and safety improvements. The following community priorities were regularly expressed during the public involvement process.

**New Amenities:** Community members identified new amenities such as benches, trash cans, mutt mitt stations, bike racks, interpretive information, and restrooms to make the park more welcoming.

**Lighting and Safety Improvements:** Public safety improvements such as lighting and better visibility in parking lots and along trails were identified as a high community priority.

**Replacement of the Playground:** Since the playground was destroyed by arson in 2014, community members have advocated for a new playground at Taku Lake Park.

**Upgrades to Facilities:** Upgrades to existing facilities and investments in new facilities to support existing uses were identified as a community priority.

**Restoration of Natural Areas:** Management of natural resources including the restoration of damaged riparian areas, eroded streambanks, and the removal of invasive species were identified as a high priority.

**Access to Taku Lake and Campbell Creek:** Community members wish to maintain access to Taku Lake and Campbell Creek but in a manner that does not damage or negatively impact habitat.

**Continued Maintenance and Trail Improvements:** The community strongly supports trails at Taku Lake Park and wishes to see continued investments in trail upgrades and maintenance to support year-round recreation.

**More Opportunities for Winter Recreation:** Community members would like to use Taku Lake Park more in the winter and have identified the possibility of the lake being used for ice skating.

**Address Conflicts between Trail and Park Users:** Many community members identified areas of congestion and conflict on the Campbell Creek Trail in Taku Lake Park, particularly when dogs are off-leash, and wish to find solutions to improve overall safety.



campbell creek

## OPPORTUNITIES AND CHALLENGES

---

The planning process revealed numerous opportunities and challenges which this master plan seeks to address. The following list is based on research and site inventory, outreach and public involvement; and was used to help identify and prioritize future design, programming, maintenance and management recommendations.

**Improving Safety:** Community members are concerned about homeless camps, drug deals and petty crime occurring in empty parking lots. Adding lighting and improving visibility into parking lots as well as developing facilities that increase overall park usage will add more eyes on the park and should help deter negative activities in the future.

**Upgrading Facilities:** Taku Lake Park needs investment to meet public demand for high quality recreation facilities. Opportunities for investment include a more permanent and larger skatepark, tennis court upgrades, permanent restrooms, ADA accessible fishing platforms, a new playground, pavilions, lighting, and trail upgrades.

**Providing Amenities:** Amenities provide an opportunity to make a low-dollar high-impact on the park. New amenities such as bike racks, trash cans, dog waste stations, interpretive and educational kiosks, restrooms, and wayfinding can go a long way to improving park user's perception of cleanliness and safety.

**Improving Maintenance:** Regular maintenance of park facilities is important to maintaining public health and safety. It also minimizes the negative impact of vandalism and builds community pride and ownership. There are additional opportunities to engage volunteers to help clear vegetation to improve sight lines along trails and near parking lots.

taku lake in early spring



**Supporting Year-round Recreation:** Recreation in Taku Lake Park is largely seasonal and has the potential for more year-round activities. Members of the public were largely supportive of winter ice maintenance for skating on Taku Lake and regular trail grooming along the Campbell Creek Trail.

**Improving Circulation in High Use Areas and Along Trails:** Taku Lake Park has several high-use areas that cause congestion along trails and conflicts among park and trail users. Opportunities exist to improve circulation in these areas by modifying trails, expanding trail options, and adding wayfinding signage to minimize conflicts and improve safety.

**Fostering Partnerships:** Many public and private organizations have expressed interest in improving Taku Lake Park. Opportunities exist to develop partnerships with public agencies and private organizations to assist in the management, maintenance, and fundraising for future projects and capital improvements at Taku Lake Park.

**Balancing Natural Areas with Developed Recreation Areas:** Taku Lake Park is loved for both its developed facilities and natural areas. There are both opportunities and challenges in preserving this balance over time. As development of the park moves forward, it will be important to balance development of new facilities with the preservation and restoration of existing natural areas.

**Protecting the Natural Environment:** Protecting important natural resources will ensure that the park can be used for years into the future. There are opportunities to protect and enhance the natural environment through erosion control, invasive species mitigation, and fish and wildlife habitat restoration. Additionally, proactive management and monitoring of park use patterns will help to mitigate issues before they become problems.





TAKU LAKE PARK | master plan

# **CHAPTER 4: THE MASTER PLAN**

## OVERVIEW

The *Taku Lake Park Master Plan* provides a 20-year vision for the management, maintenance and development of the park. The plan is the product of extensive public engagement and collaboration with local stakeholders. It embodies the community's vision to provide active and healthy year-round recreational opportunities while preserving important natural resources for future generations.

*Taku Lake Park is a safe, outdoor recreation destination that balances its natural green space and accessible waterways with a variety of unique, year-round activities for people of all ages and abilities, providing the community a natural oasis within the context of residential, commercial and industrial development.*

## VISION

The vision statement embodies the community's vision for the next 20 years at Taku Lake Park. It is a compilation of the contributions made during the master planning process by members of the advisory group, attendees of the community workshops, and online survey respondents. The vision is the guiding theme of the design development process for the future Taku Lake Park.

## CORE VALUES

The planning process revealed a number of themes in which there was general agreement among members of the public regarding the qualities that make Taku Lake Park special. These qualities or core values guide the development of this master plan, providing a foundation by which recommendations are formulated.

- Celebrate Taku Lake and Campbell Creek
- A Park for All Ages and Abilities to Participate in Recreation Together
- Maintain Taku Lake Park as a "Natural Oasis"
- Improve Access, Visibility And Connections into the Park
- Maintain a Balance of Developed Facilities and Natural Areas
- A Safe, Clean and Well Maintained Park
- Invest in Taku Lake Park for the Future

## PREFERRED ALTERNATIVE

The preferred alternative is a graphic representation of desired future conditions and is accompanied by a series of recommendations intended to guide future planners and decision makers. It maintains the natural character of Taku Lake Park while identifying much needed upgrades to facilities.

The preferred alternative includes graphics and recommendations organized by the use area:

- North Gateway
- Campbell Creek Stream Corridor
- Core Area
- South Gateway

In addition to these use areas, the preferred alternative includes a discussion on general park considerations, programming, and maintenance.

Recommendations provide a framework for future management and development decisions to realize the long-term vision for the park. They reflect community priorities and seek to address issues. Recommendations are informed by best practices in recreation and natural resource management.

Preferred Alternative  
Master Plan



## NORTH GATEWAY

The North Gateway is a welcoming, year-round destination with convenient access to developed facilities, natural amenities, and the trail system. The area supports recreation along Campbell Creek and Taku Lake, provides a hub for activities and community events, and serves as a jumping off point for the Campbell Creek Trail. The North Gateway should invite, orient, and encourage visitors to explore further into the park and provide easily accessible activities to engage visitors of all abilities.

**North Gateway Access and Circulation:** The master plan identifies additional parking and upgrades to pathways to support new development and facilitate safe circulation. The North Gateway is a high use area with a large concentration of recreation facilities in close proximity to the parking lot and Campbell Creek Trail. Future site design should consider the types of uses and circulation patterns when defining pathways to enable safe circulation and minimize potential conflicts between fast moving trail users and park users.

- Consider circulation patterns and types of uses in defining pathways to minimize user conflicts
- Construct trails to support use of developed facilities and natural areas within the North Gateway area
- Install directional signage and wayfinding to direct park users to facilities and points of interest
- Provide lighting to improve safety and user experience



**North Gateway Parking Lot:** The parking lot at 76th Avenue serves as the primary access point for the North Gateway area. The master plan recommends expanding the parking lot and improving circulation to support development of new facilities. Parking lot design should account for loading and unloading of visitors and their recreational gear.

- Expand parking by approximately 20 spaces and improve internal circulation
- Provide lighting and landscaping as per Title 21 requirements
- Maintain clear lines of sight in and around the parking lot to deter negative/illegal activity
- Utilize existing raingarden to manage stormwater runoff
- Maintain access gates for utility corridor, park maintenance, and emergency vehicle access

**Raingarden:** The raingarden is a highly successful feature and serves as the primary treatment for stormwater runoff from the 76th Ave parking lot. The master plan recommends maintaining the existing raingarden until future site development requires an expansion of the raingarden or other Low Impact Development (LID) improvements to accommodate additional stormwater intake.

- Monitor and manage vegetation and sediment deposits in the raingarden to maintain stormwater runoff treatment capacity
- Evaluate existing capacity and develop additional LID improvements to accommodate stormwater from future development
- Maintain and upgrade interpretive and educational elements describing the function, design and importance of LID stormwater management practices

North Gateway  
preferred alternative

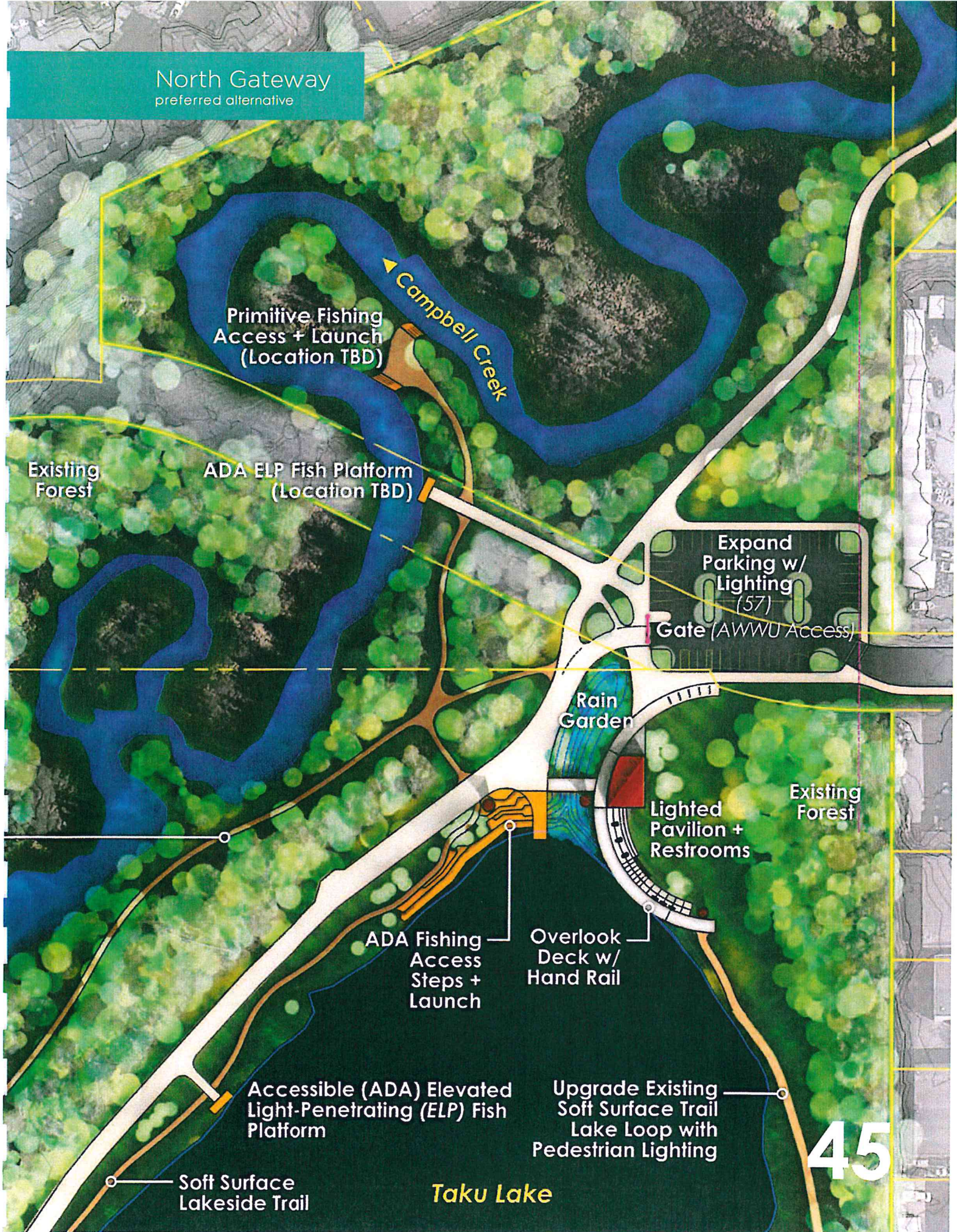

Primitive Fishing  
Access + Launch  
(Location TBD)

Campbell Creek

Existing  
Forest

ADA ELP Fish Platform  
(Location TBD)

Expand  
Parking w/  
Lighting  
(57)

Gate (AWWU Access)

Rain  
Garden

Existing  
Forest

Lighted  
Pavilion +  
Restrooms

ADA Fishing  
Access  
Steps +  
Launch

Overlook  
Deck w/  
Hand Rail

Accessible (ADA) Elevated  
Light-Penetrating (ELP) Fish  
Platform

Upgrade Existing  
Soft Surface Trail  
Lake Loop with  
Pedestrian Lighting

Soft Surface  
Lakeside Trail

Taku Lake

45

**North Gateway Pavilion and Restroom Facility:** A new lighted pavilion and restroom facility will serve as the anchor to activities in the North Gateway. The pavilion was originally identified in the 1997 master plan; however, was not developed and remains a community priority. The pavilion's architectural features should be cohesive with the natural aesthetic of the park and similar in character and construction to the South Gateway structure to minimize maintenance costs. The pavilion and restroom should be easily accessible from the 76th Avenue parking area to facilitate year-round use by individuals, groups and community organizations.

- Construct a new pavilion with lighting to support community use and events
- Develop a permanent restroom facility, or portable toilet facilities with a decorative screen fence, if a permanent facility is not feasible
- Provide access to electrical outlets to support community events
- Provide amenities such as picnic tables, benches, trash cans, grills and hot coal bins to support use
- Provide ADA accessible pathways and access
- Incorporate area lighting and maintain clear lines of sight to discourage misuse and vandalism

**Taku Lake ADA Fishing Access Steps and Launch:** The master plan recommends hardened shoreline access to Taku Lake at the north end of the lake to minimize erosion and improve access to recreation on Taku Lake. Over the years, heavy use in this area has destroyed vegetation and eroded the shoreline. Shoreline access should be ADA accessible and include fishing steps and a non-motorized boat launch. Facilities are intended to support fishing, the launching of personal watercraft, and winter recreation and maintenance.

- Provide a gradual, hardened lake shore ADA access point at the north end of Taku Lake to support recreation and maintenance
- Provide a year-round shoreline destination that is easily accessible from the parking lot
- Design and incorporate shoreline hardening that appears and feels natural, and is characteristic of natural/local materials
- Present varying levels of access for users of all ages and abilities by incorporating a series of gradual steps or similar approach into the water
- Consider circulation and other area uses in the design process to minimize user conflicts

examples of ADA fishing steps and launch



riverside steps lünen, germany

photo credit: Claudia Dreyße

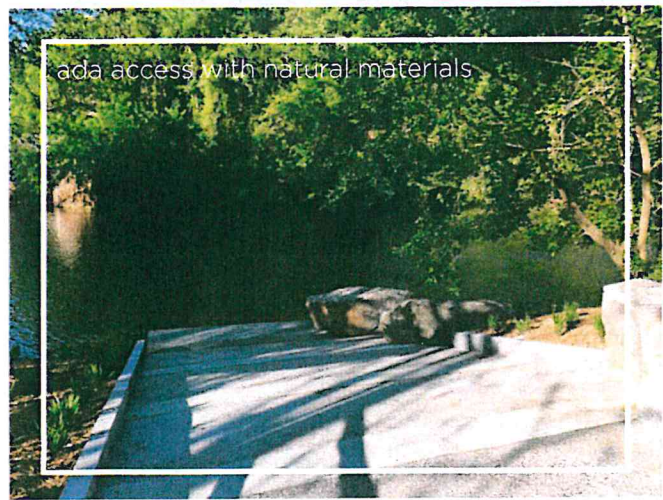

ada access with natural materials

ben burton boat launch athens, georgia

sun hill and future overlook deck area



**Taku Lake Overlook Deck:** The popular south-facing hill and shoreline east of the raingarden are among the most heavily used areas in Taku Lake Park. To support continued use and minimize future erosion, the master plan recommends the development of an overlook deck.

- Provide an elevated all-seasons overlook deck to support a variety of uses and minimize erosion
- Maintain and expand ADA accessible pedestrian connections to overlook deck
- Provide opportunities for elevated and ADA accessible fishing points
- Provide amenities to support use such as benches, trash cans, signage, and wayfinding

The overlook deck serves as an extension of the pavilion area with high visibility and convenient access to parking and other facilities in the North Gateway. The overlook deck offers visitors views of Taku Lake, convenient soft-surface trail access, and a safe location to pause, gather and enjoy lakeside recreation and leisure.

- Rehabilitate damaged shoreline areas utilizing Best Management Practices (BMPs)
- Consider hand rail or barrier design solutions that allow for maximum visibility and deter future erosion from exploration beyond the deck edge
- Incorporate designs or art features to provide visual interest that are cohesive with the natural aesthetic of the park

## CAMPBELL CREEK STREAM CORRIDOR

---

The Campbell Creek Stream Corridor is an important recreation destination and natural area offering a quiet and intimate experience in nature that changes with the seasons. The undeveloped portions of the corridor are desired to remain a highly naturalized environment, with very limited development. The master plan recommends limited development to support current and anticipated uses such as boating, fishing, and wildlife viewing. No development is recommended to occur north or west of the stream.

**Campbell Creek Access and Circulation:** The master plan identifies the development of trails to protect natural resources and improve access to recreation on Campbell Creek. Unfettered access within the stream corridor has resulted in the creation of social trails, negatively impacting water quality, fish and wildlife habitat. The creation of a soft surface trail and an ADA accessible trail is intended to direct foot traffic to designated access points, minimizing the trampling of vegetation and the erosion of streambanks.

- Develop a soft surface trail within the Campbell Creek stream corridor to facilitate access to recreation and natural resources
- Provide an ADA accessible path to the elevated light-penetrating platform on Campbell Creek
- Install directional signage and wayfinding to direct trail users to destinations, minimizing the creation of social trails and potential for future trampling
- Install interpretive information to increase public awareness of important natural resources including local fish and wildlife
- Monitor and manage public use of the natural areas to minimize any potential negative impacts to fish and wildlife habitat

**Campbell Creek Primitive Fishing Access and Launch:** The North Gateway area is a popular take-out point for boating excursions originating upstream. The master plan recommends a primitive fishing access and launch to support continued use of the stream for fishing and boating. The location should be determined at the time of development and with input from stakeholders and partner agencies to ensure that it adequately serves the intended purpose of providing recreational access and habitat preservation. Facilities should be safe, easily accessible, and include appropriate signage such as wayfinding and interpretive information.

- Work with stakeholders and partner organizations such as ADF&G to identify an appropriate location for a primitive fishing access and launch
- Provide a formal soft surface path to the designated access point
- Install regulatory and interpretive information to increase public awareness of important natural resources and local fish and wildlife
- Re-vegetate social trails and rehabilitate streambanks to enhance riparian habitat and improve water quality
- Monitor and manage public use of the natural areas to minimize the potential impacts to stream banks, riparian areas, and important fish and wildlife habitat

# Campbell Creek Stream Corridor

preferred alternative

Primitive Fishing  
Access + Launch  
(Location TBD)

ADA ELP Fish Platform  
(Location TBD)

Campbell Creek

Upgrade existing  
social trails to  
Soft-Surface Trails



**Habitat and Natural Resource Management:** The stream corridor within Taku Lake Park is part of the larger Campbell Creek Watershed and provides important ecosystem services and habitat for birds, fish and wildlife. Active and proactive management of the stream corridor is necessary to maintain the integrity of this environment and to ensuring the continued use as a recreation area. The master plan recommends the management of resources and the prioritization of improvements that reinforce Take Lake Park's role as a combined recreation and natural resource area along the Campbell Creek stream corridor.

- Conserve and manage the Campbell Creek stream corridor as a valuable riparian stream corridor
- Partner with agencies and organizations to implement streambank habitat restoration projects to improve the overall health of Campbell Creek
- Utilize the latest BMPs for design and construction along streambanks and within the stream corridor
- Re-vegetate social trails within the stream corridor to enhance riparian habitat and water quality
- Re-vegetate eroded shoreline areas to enhance water quality and fish habitat
- Monitor and manage public access and use within the stream corridor to mitigate any negative impacts to fish and wildlife habitat
- Provide educational and interpretive features to engage users and highlight the value of the Campbell Creek stream corridor
- Remove invasive species such as European Bird Cherry (*Prunus padus*) to support native forest health

**Campbell Creek ADA Fish Platform:** The North Gateway area is a popular access point for anglers fishing along Campbell Creek. The master plan recommends the development of an ADA accessible elevated light-penetrating platform (ELP) to accommodate anglers and visitors of all abilities and to protect sensitive streambank ecology. Protecting streambank vegetation ensures water quality thereby improving fish habitat. The platform should be easily reached via an ADA accessible trail and include appropriate signage such as wayfinding and interpretive information.

- Install an ADA accessible elevated light-penetrating platform along Campbell Creek to facilitate wildlife viewing and fishing
- Utilize best management practices and partner organization knowledge to identify an appropriate location for the fish platform
- Install interpretive information to increase public awareness of important natural resources and local fish and wildlife
- Monitor and manage public use of the platform area to minimize any potential negative impacts to fish and wildlife habitat

example of ADA fishing platform



credit: Alaska DNR Bing's Landing, Kenai River, AK



## PARTNERSHIPS

Management and implementation of stream corridor projects will require coordination at many levels and should utilize federal, state, and local partner's expertise and resources. Management partners include: MOA Watershed Management, US Fish and Wildlife Service, Alaska Department of Fish and Game, Alaska Department of Natural Resources, the Anchorage Waterways Council.

## CORE AREA

The Core Area is the heart of Taku Lake Park and includes a variety of trail experiences and opportunities for recreation. The Core Area is defined by Taku Lake and the Campbell Creek Trail and includes the popular lake loop trail. The master plan does not propose any major changes to the Core Area as public input strongly supports maintenance and management of existing facilities and natural areas. The master plan does propose upgrades to trails and the reconstruction of a lakeside fishing platform.

**Core Area Access and Circulation:** Trail modifications are recommended to reduce congestion and improve circulation in high use areas. As the main corridor within Taku Lake Park, the Campbell Creek Trail is often congested in locations where trails intersect and park visitors congregate. This is particularly so along the western shore of Taku Lake, where fast moving cyclists and commuters share the trail with more leisurely travelers, side-by-side groups, and the occasional off-leash dog. Widening of the Campbell Creek Trail combined with an extension of the Lake Loop Trail to the west is recommended to better accommodate the variety of trail users and to improve overall circulation.

- Widen the Campbell Creek Trail through the park to minimize congestion and better accommodate multiple modes of travel
- Consider developing soft surface shoulders along the Campbell Creek Trail to separate fast and slow moving traffic, and provide a surface for jogging
- Extend the Lake Loop Trail to the west to provide a continuous walking loop separate from the Campbell Creek Trail
- Provide directional signage and wayfinding at key trail intersections to help visitors safely navigate the park
- Selectively thin vegetation along the trails to improve visibility and safety
- Provide additional lighting in high-use areas and intersections for added visibility and safety

**Campbell Creek Trail:** The Campbell Creek Trail is one of Anchorage's premier multi-use trails providing access to Taku Lake Park from areas throughout the city. Within the park, the trail is the main bike and pedestrian corridor, connecting visitors to the North and South Gateways as well as to Taku Lake and the Campbell Creek stream corridor. The popularity of the trail and close proximity to high-use facilities has created areas of congestion resulting in conflicts among trail users. The master plan recommends several trail modifications to improve overall safety and to reduce future trail user conflicts.

- Widen the Campbell Creek Trail through the park to minimize congestion and better accommodate multiple modes of travel
- Consider developing soft surface shoulders along the Campbell Creek Trail to separate slower moving traffic and provide added recreational benefit
- Modify trail alignments at sharp bends to minimize cut-through and to improve safety at trail intersections and in areas with limited visibility
- Provide additional lighting in high-use areas and intersections for added visibility and safety
- Provide signage and wayfinding at key trail intersections to help visitors safely navigate the park
- Improve grading and drainage to increase the long-term durability of the trail
- Monitor changing trends in trail use to better understand user needs and better serve the public
- Maintain the trail as a year-round recreation asset
- Consider AWWU access and P&R maintenance needs in the planning and development of future improvements within the trail corridor

**Core Area**  
preferred alternative



Accessible (ADA) Elevated  
Light-Penetrating (ELP) Fish  
Platform

Soft Surface  
Lakeside Trail

Upgrade Existing Soft  
Surface Lake Loop Trail

Expand width of  
Campbell Creek  
Greenbelt Trail from  
South Gateway to  
North Gateway

Lake Loop Trail

Upgrade  
Existing  
Pavilion  
Lighting

Revegetate  
Trail Edge

Open  
Lawn

**Lake Loop Trail:** The Lake Loop Trail is a well-used soft surface trail originating in the North Gateway and continuing south around the east side of Taku Lake. In its current form, the Lake Loop ends at the Campbell Creek Trail where it is often used to make a complete .6 mile loop. The master plan proposes continuing the Lake Loop Trail to the west of the Campbell Creek Trail into the stream corridor where it travels north returning to the North Gateway. This extension will help to alleviate congestion on the Campbell Creek Trail and will create a complete nature loop trail.

- Maintain the trail surface to ADA accessibility standards to the greatest extent feasible
- Extend the Lake Loop Trail to the west to provide a continuous walking loop separate from the Campbell Creek Trail
- Provide directional signage and wayfinding at key trail intersections to help visitors safely navigate the park
- Selectively thin vegetation along the trail to improve visibility and safety
- Consider pedestrian level lighting on the eastern section of the Lake Loop to support year-round recreation

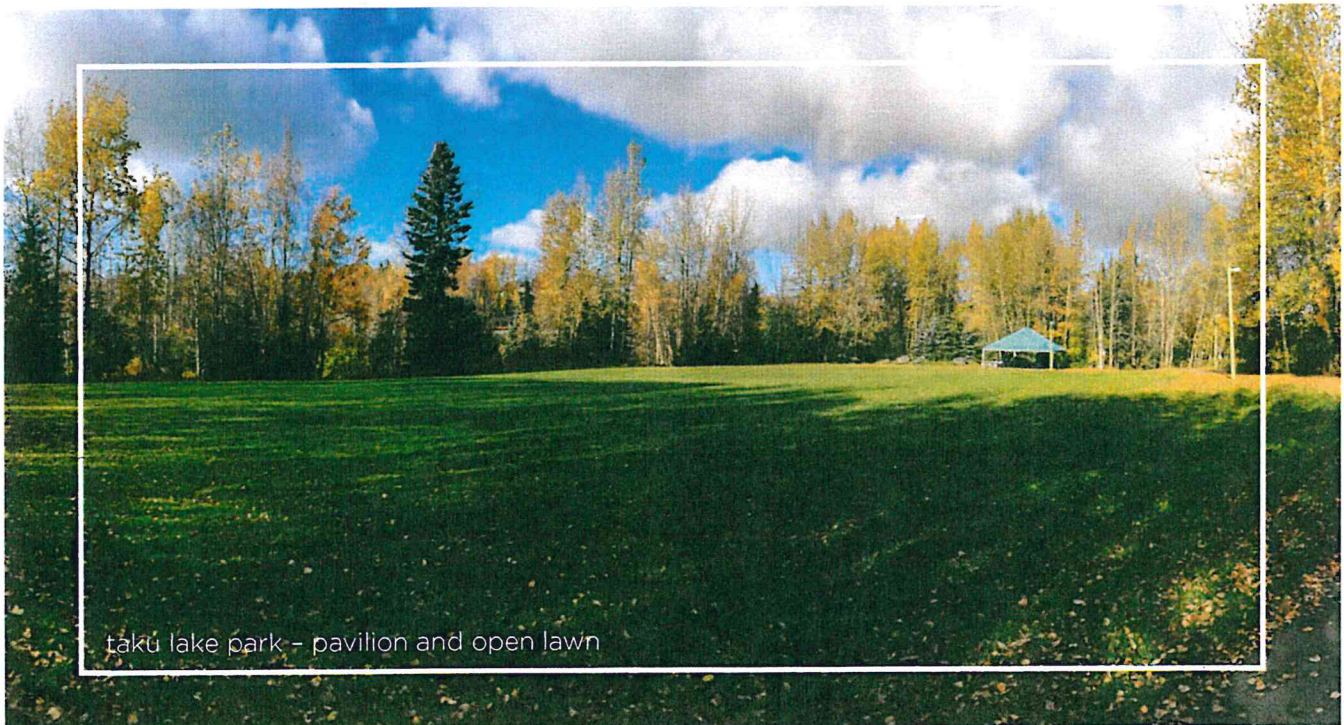



**Pavilion and Open Lawn:** The existing picnic pavilion is one of the few permanent constructed facilities within Taku Lake Park and is considered to be a valuable asset by the community. The pavilion and open lawn are to maintain their same general footprint with a small extension of the open lawn and circulation improvements to the Campbell Creek Trail. The master plan recommends maintenance and upgrades to the existing pavilion and its surroundings to support continued community use.

- Repair and paint worn, damaged and vandalized surfaces and features of the pavilion
- Install additional amenities such as picnic tables, trash cans, and hot coal bins to improve user experience
- Install LED vandal-resistant lighting to improve security and visibility during dark periods
- Selectively thin nearby vegetation to improve visibility
- Expand the open lawn to the south of the Campbell Creek Trail to strengthen the connection between developed facilities and invite visitors further into the park
- Add landscaping to areas along the Campbell Creek Trail to eliminate cut-through traffic and better define the open lawn and pavilion as a unique destination

**Taku Lake Fishing Platform:** The western shore of Taku Lake was the former site of a popular fishing platform that was removed due to maintenance and safety issues. The master plan recommends construction of a new ADA accessible elevated light-penetrating platform (ELP) to provide a highly desired amenity in the heart of the park.

- Work with agency and organizational partners to install an ADA accessible elevated light-penetrating fishing platform
- Revegetate heavily disturbed shoreline areas surrounding the platform to discourage shoreline water access and to improve water quality
- Provide regulatory signage and interpretive information to educate and inform the public about water quality, habitat, fish and wildlife, and recreation on Taku Lake
- Monitor public use of the lake and platform and adjust management strategies to address issues as they arise

## SOUTH GATEWAY

---

The South Gateway provides an active year-round recreation destination for individuals and families to gather, recreate, and socialize. The area extends from the parking lot to the south shore of Taku Lake and includes developed facilities, forested natural areas, open lawn and trails. The South Gateway is intended to be a gathering point, offering a range of highly desirable recreation for all ages and abilities in one easily accessible location. The area also serves to introduce visitors to a wider slate of potential recreational interests. The South Gateway area should welcome, orient, and encourage visitors to explore further into the park and provide a safe, natural and exciting place to gather and enjoy their favorite activities.

**South Gateway Access and Circulation:** The master plan identifies upgrades to access and circulation to support the development of new facilities in the South Gateway. Facilities are to be connected via ADA accessible paved trails. Future site design should consider the location and type of facility when defining pathways to ensure safe circulation. Connections to the neighborhood should be improved with trail upgrades and clearly defined park access points. Vehicle access is from Stormy Place and maintains the existing 38 parking spaces.

- Develop paved trails in concert with construction of new facilities to accommodate safe circulation
- Consider circulation patterns and types of uses in defining pathways to minimize user conflicts
- Resurface existing paved trails to eliminate heaves, splits and other damage
- Install directional signage and wayfinding to direct park users to facilities and use areas
- Provide additional lighting to improve safety and user experience
- Consider modifications to the inside radius of the Campbell Creek Trail-South Gateway spur trail intersection to provide better visibility and a safer intersection for bicyclists and pedestrians
- Resurface neighborhood-park trail access from Rainy Place, Stormy Place and Queen Victoria Drive

**South Gateway Parking Lot:** The existing asphalt paved parking area with 38 parking spaces will continue to serve as a key vehicle access point for the South Gateway. Parking lot use is anticipated to increase as new facilities are developed and existing facilities are upgraded. The master plan recommends the following improvements:

- Perform routine maintenance to the asphalt and adjacent areas and resurface as needed
- Continue to manage the existing parking lot as a year-round facility
- Install an access control gate to minimize after hours activity in the park
- Incorporate area lighting improvements as electrical systems are updated and expanded to accommodate nearby site development

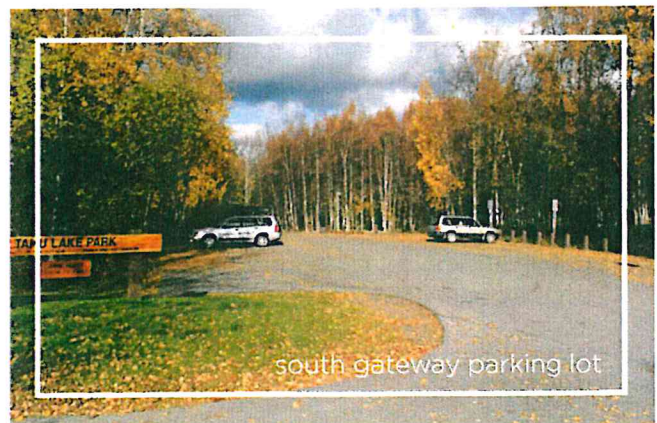

South Gateway  
preferred alternative

Campbell Creek

Upgrade Existing Pavilion Lighting

Revegetate Trail Edge

Open Lawn

Widen Trail Curve Radii

Soft Surface Forest Trails

Existing Forest

Skatepark

Picnic Area

Play Area

Swings

2-5 play

Basketball

Fitness

Pavilion + Restrooms

Existing Forest

Existing Parking (38)

Existing Tennis

Gate

Stormy Place

Rainy Place

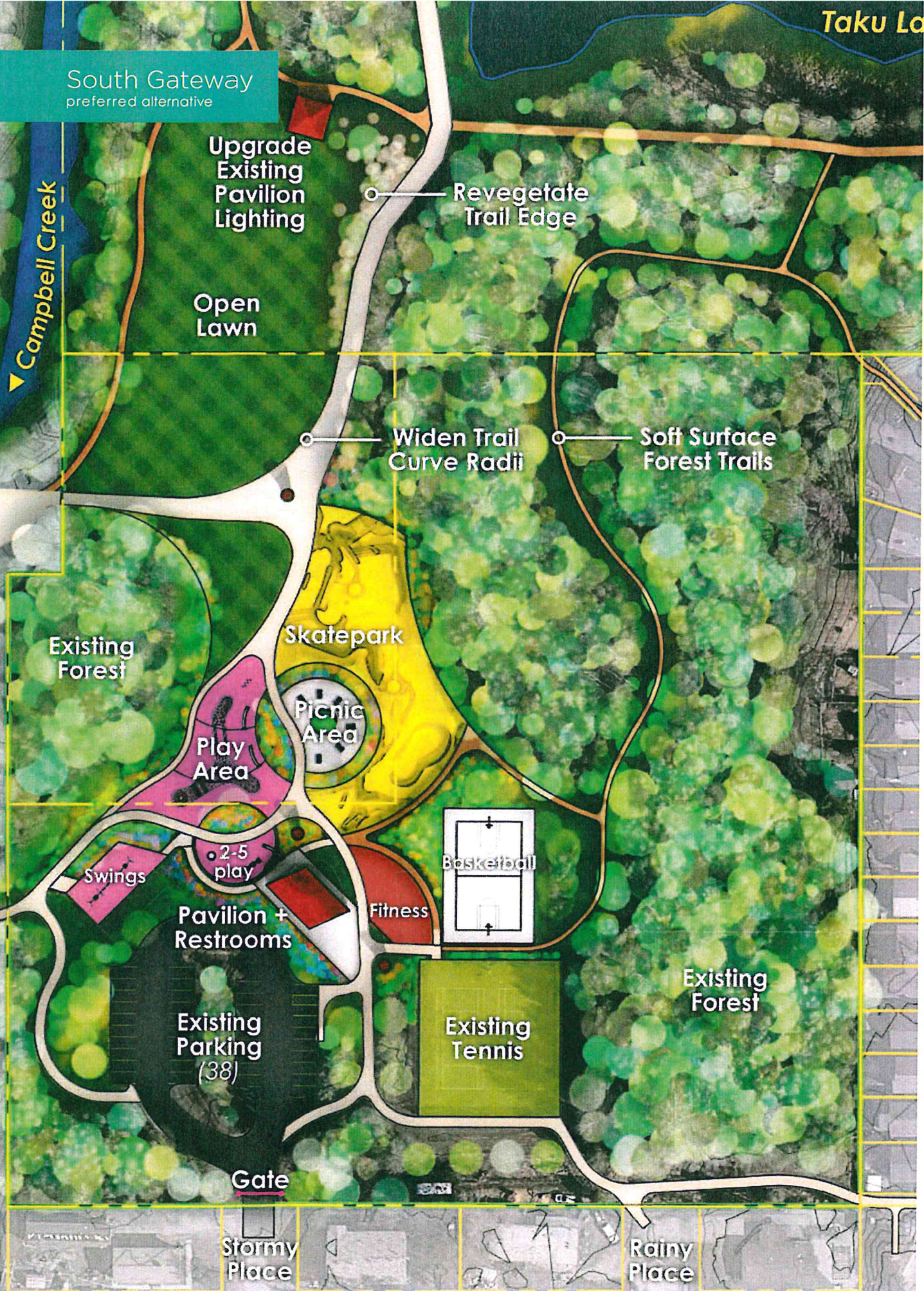

**South Gateway Pavilion and Restroom Facility:** A new lighted pavilion and restroom facility will serve as a visible destination and hub to activities in the South Gateway area. The master plan recommends the development of a combined pavilion and restroom facility to support year-round use by individuals, groups and community organizations. The pavilion and restroom should be easily accessible from the parking area and include amenities to support use. The pavilion's architectural features should be similar in character and construction to the North Gateway structure and designed to fit within the larger aesthetic of the South Gateway area.

- Construct a lighted pavilion with unique architectural features and fitting within the natural aesthetic of the park, that is visible and easily accessible from the parking area
- Develop a permanent restroom facility, or portable toilet facilities with a decorative screen fence, if a permanent facility is not feasible
- Provide electrical outlets to support community events
- Provide amenities such as picnic tables, benches, trash cans, grills and hot coal bins to support use
- Provide ADA accessible pathways and access
- Incorporate area lighting and maintain clear lines of sight from adjacent areas to discourage misuse and vandalism
- Install signage and wayfinding to help visitors navigate the park

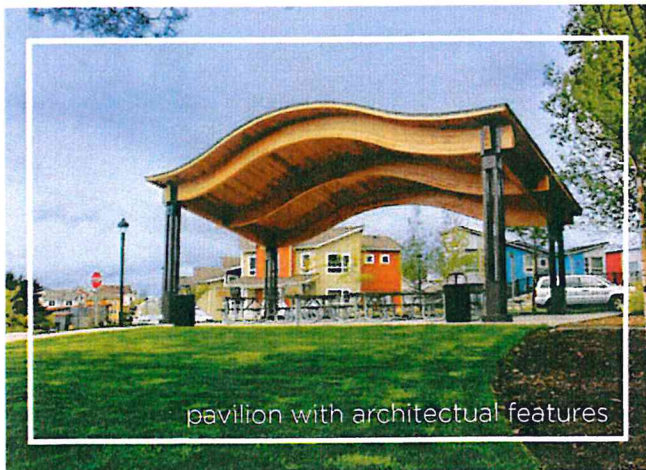

pavilion with architectural features

credit: Polygon Shelters

**Play Area:** The master plan recommends a destination play area with creative and interesting features that attract visitors to the park year-round. The play area should be accessible, inclusive, and incorporate unique elements, configurations, or themes that celebrate the park. The play area should also complement other facilities, helping to give the South Gateway area a cohesive feel and strong identity.

- Develop an inclusive play area in close proximity to complementary uses such as the central picnic area, pavilion and restroom, and parking area; and nearby other active recreation facilities such as tennis courts, skatepark and basketball court
- Utilize unitary surfacing that meets or exceeds ADA guidelines
- Maintain clear lines of sight into and through the play area to minimize hiding spaces, discourage vandalism, and allow for easy supervision and monitoring
- Install perimeter controls, such as fencing and/or landscaping, to improve child safety and supervision as well as prevent conflicts with other more active uses
- Work with partner organizations to identify, fund, and incorporate inclusive play features for all ages and abilities
- Incorporate public art or artful features to provide visual interest, increase ownership and offer playful expression within a public setting

examples of play areas and pavilions



inclusive play features at the south anchorage sports park

credit: anchorage park foundation

**Skatepark:** The existing skatepark is a heavily used and well-loved feature within the park. The popularity of use and potential to expand and increase activity within the park supports the establishment of a more advanced and permanent skatepark within the South Gateway area. The master plan recommends collaborating with local skateboard businesses, organizations and enthusiasts to design, construct, manage and maintain a regional skatepark destination at Taku Lake Park.

- Construct a permanent skatepark that is suitable for hosting small to medium sized events and can support a variety of skill levels
- Provide a mix of features for all levels of the skate community, organized to invite beginners and encourage skills development for more advanced riders
- Clearly define the skatepark area, considering spatial relationships to other use areas, to discourage users from expanding the skatepark beyond the intended use area
- Provide lighting, fencing, spectator areas, and amenities to encourage safe use and discourage negative activity
- Consider design features that may be covered or protected in the future to extend use during inclement weather
- Consider skate-able art by incorporating art features into the skatepark where possible to expand the function, interest, ownership and aesthetic of the skatepark
- Partner with businesses, organizations, and individual enthusiasts to fund, design, manage, program, and maintain the skatepark

examples of skate parks



credit: Clairemont Times



credit: designboom.com

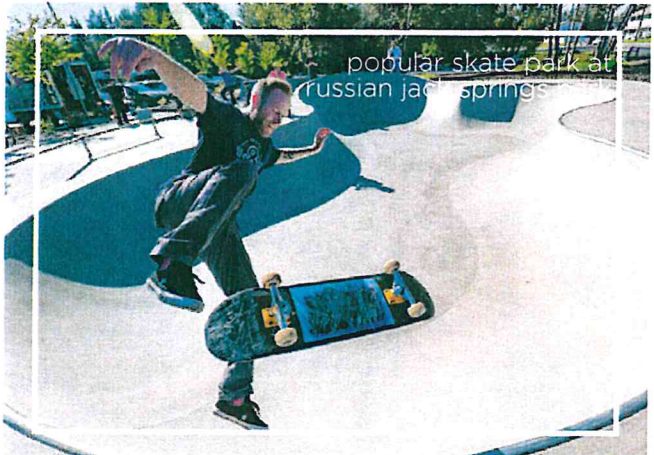

credit: anchorage park foundation

**Central Picnic Area:** The South Gateway area will benefit from a central meeting and gathering point to support activities and enhance user comfort and experience. The master plan recommends the incorporation of a centrally located picnic area. The picnic area is intended to provide a buffer between adjacent uses while enabling parents, guardians or program sponsors to supervise children recreating in multiple areas. The picnic area also provides a secondary location for picnicking in the event the pavilions are programmed or rented.

- Provide a hardscaped picnic area with amenities to support use of area recreation facilities by individuals, families and groups
- Develop picnic area to provide a physical separation and transition between the skatepark and other recreation facilities to provide a safe buffer between various uses
- Incorporate lighting and clear lines of sight between the picnic area and nearby uses to encourage active supervision, discourage negative behavior, and improve safety
- Incorporate and include edible and ornamental landscape vegetation and/or public art features to provide a natural and aesthetically pleasing experience

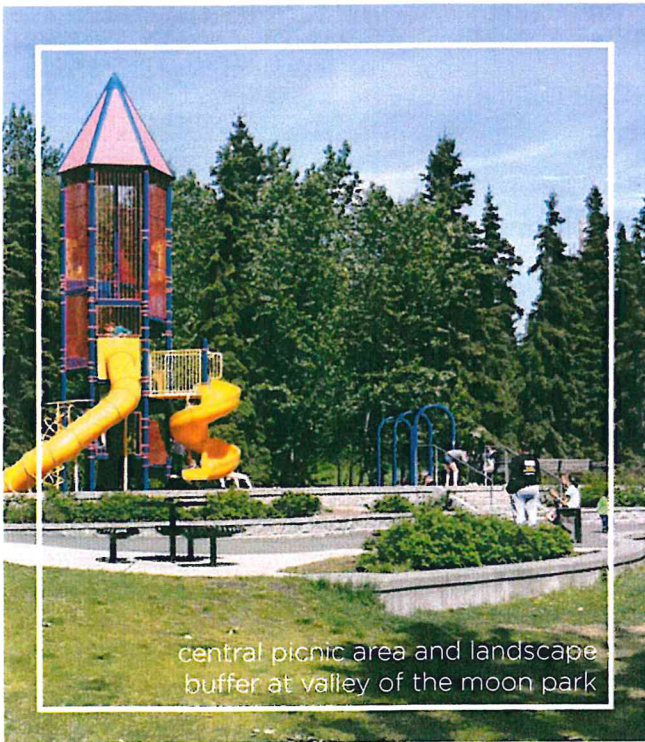

**Fitness Area:** The existing fitness area is a destination for outdoor circuit and strength training. Improvements to the fitness area are recommended to improve accessibility, visibility and usability.

- Update signage, repair damaged or worn features, and replace obsolete or unsafe equipment
- Provide additional equipment or selectively replace equipment to increase durability and usability
- Improve visibility and circulation within and around the fitness area to provide better access and awareness of its location and features
- Upgrade surfacing and remove vertical curbs to improve ADA accessibility within and around equipment
- Partner with businesses, organizations, and individual enthusiasts to modernize, program, and maintain the fitness area



**Basketball Court:** The South Gateway area was identified as a recreation destination that caters to a variety of interests and age groups. A new basketball court is recommended to provide an additional activity that is highly desired by the community, easy to maintain, and complements the other uses.

- Construct a single, full size basketball court with asphalt pavement and official striping
- Provide basic amenities such as seating and trash cans to support active and continuous use
- Install containment fencing, as appropriate, to reduce conflicts with adjacent uses and prevent rolling of basketballs into areas where retrieval is difficult
- Provide seasonal maintenance of the court to remove debris and seal asphalt periodically to ensure long-term use



**Tennis Courts:** The existing tennis courts are in generally good condition but currently under-used. The master plan recommends retaining the existing courts in their current location and making the necessary improvements to increase playability.

- Perform routine and seasonal maintenance to ensure long-term viability of the tennis courts
- Resurface and re-stripe the tennis courts when routine maintenance no longer supports quality play
- Partner with the organizations such as the Alaska Tennis Association to conduct outreach, increase programming, and fund and execute minor improvements of the tennis courts



**Nature Trail:** A new nature trail is identified in the area south of Taku Lake and is accessible from the South Gateway parking lot. The trail provides additional opportunities to recreate in nature while maintaining the forested buffer between developed park facilities and the neighborhood.

- Develop a new soft-surface nature trail in the forested area south of Taku Lake and east of the South Gateway facilities to provide additional opportunities for recreation



## GENERAL PARK CONSIDERATIONS

**Trails:** Taku Lake Park has a variety of trail types and experiences making it a valued community asset and year-round destination. The Campbell Creek Trail links areas within the park and provides excellent access to the park from areas across the city. Soft surface trails within the park allow for a more quiet contemplative recreation experience in nature.

**Paved Multi-use Trails:** Bicycle and pedestrian paths are highly desired by the community for active recreation and leisure uses. The master plan identifies a more robust network of multi-use paved connectors linking areas of the park and improving overall circulation. Existing multi-use trails vary in condition from poor to good with some locations creating unsafe conditions for bicyclists and pedestrians. The master plan recommends upgrading existing multi-use trails to support new development and improve overall circulation.



**Soft Surface Trails:** Soft surface trails provide opportunities for quiet contemplation and more intimate experiences in nature. New soft surface trails identified in this plan should serve to protect sensitive ecosystems, particularly near Campbell Creek, by focusing foot traffic on designated trails, thereby minimizing trampling and erosion that results from the creation of social trails. New soft surface trails are identified in three locations: 1) the forested area directly south of Taku Lake; 2) the high-use lakeside area west of Taku Lake; and, 3) the Campbell Creek Stream Corridor. General soft surface trail guidelines are below.

- Develop new soft surface trails to improve circulation, link facilities, and provide new opportunities for recreation while reducing trampling, erosion, and damage to sensitive habitat areas
- Develop trails in accordance with stream protection setbacks as required by Anchorage Municipal Code Title 21 Land Use Code
- Construct soft surface trails to meet accessibility requirements to the greatest extent practicable
- Re-vegetate existing social trails within the Campbell Creek Stream Corridor once soft surface trails are formalized to minimize further trampling and erosion
- Maintain existing mature vegetation along trails to the extent practicable while selectively pruning and thinning to improve safety and visibility
- Engage community partners and volunteers to fundraise and build soft surface trails
- Provide wayfinding throughout the park to improve safety, orient visitors, and encourage further explorations into the park

**Signage and Wayfinding:** Signage helps improve overall safety and user experience; and typically includes a mix of regulatory, wayfinding, interpretive and educational. Signage should be context sensitive and installed at appropriate locations throughout the park.

- Implement a wayfinding signage program with consistent themes, identity and sign hierarchy to help park and trail users locate activity areas and points of interest
- Install distance markers along secondary trails to support the wayfinding program, encourage healthy exercise and physical training, and provide a point of reference in case of emergency
- Provide interpretive information to increase public awareness of important natural resources and local fish and wildlife
- Install kiosks with park rules signs at access points and locations where specific uses require additional rules or regulations

**Amenities:** The master plan recommends the installation of park standard amenities in high-use locations to support and enhance park user's experience. The following amenities should be provided at appropriate locations within Taku Lake Park:

- Benches and seating
- Picnic tables
- Bear-proof trash cans
- Dog waste stations
- Rules and regulatory signage
- Wayfinding and information kiosks
- Interpretive information
- Bicycle racks
- Monofilament fishing line and lure waste receptacles

examples of amenities in anchorage parks



### Landscape and Vegetation Management:

Maintaining the natural character of the park was described as a high priority throughout the public involvement process. The master plan recommends the management of native vegetation within the park to maintain the function and appeal of the park as a natural urban oasis. Management of forest vegetation should include routine maintenance; such as brush clearing to increase visibility and invasive species removal to improve forest health. Forested areas should remain more or less as-is to maintain a vegetative buffer along the boundaries of the park. New landscape areas and plantings should be appropriate to USDA Hardiness Zone 4a, with preference given to native species, edible, and traditional medicinal plants to enhance the public use and purpose of the park.

- Prioritize the preservation and enhancement of existing native vegetation through best management practices to improve forest health
- Remove invasive species such as *Prunus padus* (European Bird Cherry or Mayday trees) to support native forest health
- Manage vegetation and thin brush along the periphery of activity areas and trail corridors to maintain clear lines of sight, improve safety and supervision, and prevent user or wildlife conflicts
- Maintain the vegetative buffer along the boundaries of the park to retain the character and attraction of the park
- Install landscape plantings compatible with adjacent uses; such as play areas, trails, streambanks and shorelines
- Design landscape areas to be easily maintained by volunteers and the Parks and Recreation Department



**Public Art:** Public art has been identified as a potential place-making opportunity within Taku Lake Park. Public art provides areas of interest through visual and experiential expressions of place within a park setting. The concept of public art or artful features was supported during the planning process with a strong desire for features that reinforce the distinct natural beauty of the park. The master plan recommends the incorporation of public art as standalone public art installations or as a component of the development process. The master plan identifies potential locations for public art installations; however, specific locations should be determined at a future time on a case by case basis.

- Identify and engage local, state, and national agencies and organizations as partners to initiate public art projects, identify funding opportunities, and provide technical support
- Encourage local and multi-cultural artist participation in public art projects within the park
- Consider educational, interpretive, or environmental art features to engage and educate users about natural resources and wildlife within the park
- Develop criteria for evaluating public art projects and outline the process for public involvement and approvals



**Utilities:** Improvements identified in this master plan will require coordination with local utilities to service facilities such as pavilions and restrooms. The master plan recommends the expansion of electrical service for improved trail and area lighting, and the installation of water and sewer service tie-ins for restroom facilities.

**Electrical:** Power and lighting upgrades should adhere to the latest approved standards and design criteria, and comply with AMC Title 21 requirements for specific uses, such as parking. The master plan recommends that lighting is added along select multi-use paths and within active use areas to enhance year-round recreation, ensure public safety, and discourage vandalism and other illegal activities.

- Expand trail lighting consistent with MOA standards for fixtures and poles at heights appropriate in scale and character for intended use
- Upgrade and install LED lighting fixtures to minimize long-term maintenance and operations costs
- Utilize lighting that minimizes light pollution into adjacent residential areas
- Consider lighting for use in design features or for specific uses on site, such as the skatepark, pavilions, or play area
- Consider providing power with protected, lockable and weatherproof covers in high-use areas of the park such as the skatepark and pavilions to support events

**Sanitary Sewer and Water:** Installation of water and sanitary sewer service lines are recommended in the North Gateway and South Gateway areas to support the development of permanent restroom facilities.

- Coordinate sanitary sewer and water service tie-in locations and installation with AWWU

**Stormwater Management:** Development identified in this master plan will require stormwater conveyance and treatment to address runoff from impervious surfaces. The success of the existing raingarden provides precedence in planning for and implementing Low Impact Design (LID) strategies to protect water quality. The master plan recommends stormwater infrastructure consistent with LID Best Management Practices, otherwise known as Green Infrastructure.

- Partner with MOA Watershed Management to identify, prioritize and fund Green Infrastructure projects to treat stormwater runoff from new development
- Maintain interpretive and educational signage at the existing raingarden describing the benefits of Green Infrastructure and watershed health
- Monitor and evaluate stormwater management systems to proactively address stormwater runoff challenges or system failures



rain garden informational signage

**Encroachments:** Over the years, private properties along Queen Victoria Drive have encroached on public parkland with the clearing of trees and development of small outbuildings. The master plan recommends working with land owners to remove structures and rehabilitate damaged parkland. If voluntary compliance is not achieved, formal or legal action should be considered to resolve the issue.

**Off-Site Recommendations:** During the master planning process, several items were identified as either issues needing to be resolved or community priorities that could not be accommodated in this master plan. The master plan acknowledges these items and presents them in this document for future discussion.

**Traffic Calming:** Residents on Stormy Place have identified speeding and the need for street upgrades such sidewalks, stormwater infrastructure, and lighting. The planning team has discussed this issue with MOA Traffic and recommend that residents request a formal traffic study through the Taku-Campbell Community Council.

**Enhance Vegetative Buffers (C Street):** Members of the community have expressed a strong desire to preserve vegetation along the C Street corridor to minimize the visual and audible impacts of traffic. C Street is managed by the Alaska Department of Transportation (DOT). The master plan recommends working with DOT to ensure that future road work considers any potential negative impacts to park users and that these impacts are mitigated.

**Recreation or Nature Center:** Participants at the community workshops expressed a strong desire for a recreation center in the Taku-Campbell area. South Anchorage and the Taku-Campbell area does not currently have any public indoor recreation facilities near the park. While many participants see the value in having a recreation or nature center at Taku Lake Park, a location outside of the park was ultimately found preferable. The master plan recommends that the Municipality consider development of a recreation center in the future in the general Taku-Campbell area to meet levels of service for indoor recreation.

**Dog Park:** Dog walking is a popular activity at Taku Lake Park and off-leash dogs are not uncommon. While many people expressed the desire for an off-leash dog park at Taku Lake Park, many people were adamantly opposed citing concerns over the effects on the natural environment. The master plan does not recommend an off-leash dog park at Taku Lake Park.

In 2017, new off-leash dog park facilities were developed at the South Anchorage Sports Park, two miles south of Taku Lake Park. And in 2018, a new off-leash dog park will be developed at Whisper Faith Kovach Park, one mile to the east on 76th Ave/Lore Rd.



## PROGRAMMING

---

New facilities identified in this master plan will help to facilitate special events and programming. Taku Lake Park is already a popular location for community gatherings. With the addition of new pavilions and restrooms at both the North and South Gateways and upgrades to the existing pavilion and lawn, the park will be well suited in the future to host a variety of community events. Facility rentals also provide an opportunity for the Municipality to generate revenue, providing a return on investment over time. The Municipality should work with community partners and businesses to help sponsor events and program the park.

## MAINTENANCE

---

Regular maintenance provides for a clean, healthy, and enriching park experience. This master plan recommends regular trash pick-up, the provision of restrooms, and the installation of new amenities to improve the health and appearance of Taku Lake Park. New amenities such as trash cans, benches, mutt mitts, kiosks, signage, wayfinding and interpretive panels should be provided at appropriate locations within the park. New bear-proof trash cans should be installed and emptied at regular intervals to support year-round use. Further, monofilament recycling stations should be provided at popular fishing locations to encourage healthy use of waterbodies.

Additionally, there was a strong desire by members of the public for year-round recreation at Taku Lake Park. The master plan recommends continued grooming of the Campbell Creek Trail and the maintenance of Taku Lake for ice skating in the winter. While this may not always be feasible given changes in maintenance and operations budgets from year to year, it is important to consider winter recreation as a strategy for activating the park with positive use.

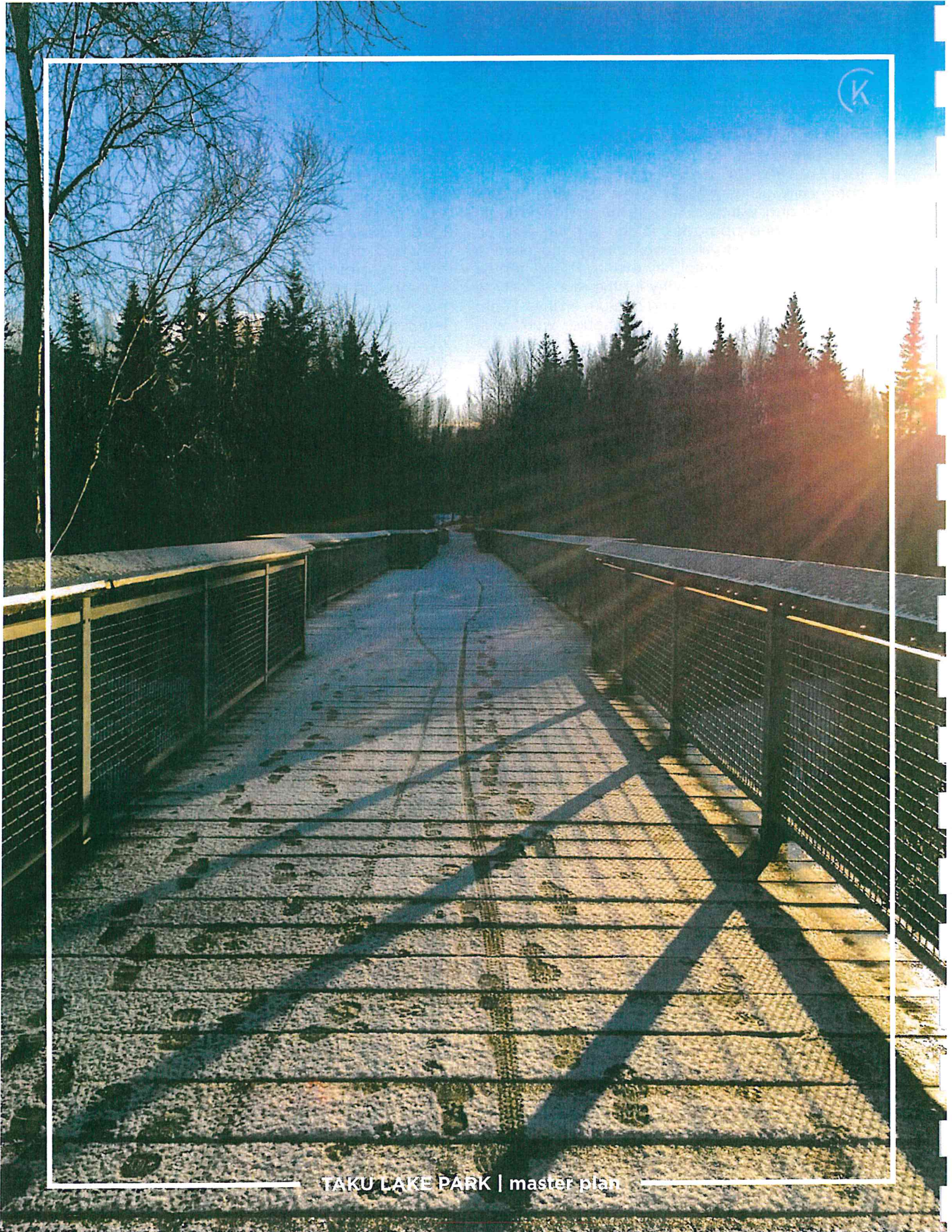

TAKU LAKE PARK | master plan

# **CHAPTER 5: IMPLEMENTATION**

## OVERVIEW

The *Taku Lake Park Master Plan* provides a blueprint for the management, maintenance, and development of Taku Lake Park over the next 20 years. The following implementation section describes some of the steps needed to realize the community's vision identified in this master plan. Timelines for implementation strategies are approximate and based on the information, knowledge, and priorities of the community at the time of master plan development. Priorities may shift in the community and time frames may change with them.

## PLAN APPROVAL AND ADOPTION PROCESS

Approval and adoption of the *Taku Lake Park Master Plan* is a three step process:

1. Taku-Campbell Community Council
2. Parks and Recreation Commission
3. Planning and Zoning Commission

## IMPLEMENTATION TABLE

	IMPLEMENTATION STRATEGIES	ESTIMATED COSTS	TIMEFRAME	IMPLEMENTING PARTY
01	PLAN ADOPTION	\$5,500	0 - 6 MONTHS	PRD, PRC, PZC, PLANNING DEPT.
02	FUNDRAISING FOR IMPROVEMENTS	TBD	ONGOING	PRD, RESIDENTS, ADVISORY GROUP, APF, USER GROUPS
03	<i>monitor &amp; manage</i> NATURAL RESOURCES	TBD	ONGOING	PRD, ADF&G, MOA WATERSHED MGMT., USFWS
04	<i>improvements:</i> SOUTH GATEWAY	\$2 MILLION	0 - 2 YEARS	PRD
05	<i>improvements:</i> NORTH GATEWAY	\$15 MILLION	1 - 5 YEARS	PRD
06	<i>improvements:</i> CORE NATURAL AREA	\$500,000	1 - 5 YEARS	PRD
07	<i>improvements:</i> CAMPBELL CREEK STREAM CORRIDOR AREA	\$500,000	1 - 5 YEARS	PRD
08	DEVELOP A PUBLIC ART CRITERIA FOR SELECTION & DESIGN OF NEW PARK ART FEATURES	\$25,000	1 - 5 YEARS	PRD
09	<i>review &amp; update</i> MASTER PLAN	\$50,000	LONG RANGE 10 - 20 YEARS	PRD, RESIDENTS

## MUNICIPALITY OF ANCHORAGE STANDARD SPECIFICATIONS (M.A.S.S)

Implementation of the *Taku Lake Park Master Plan* at the site design level will conform to specifications for construction established in the *Municipality of Anchorage Standard Specifications (M.A.S.S.)*.

## REGULATORY FRAMEWORK - TITLE 21 LAND USE REGULATIONS

Implementation of the *Taku Lake Park Master Plan* will conform to zoning and land use regulations established by *Anchorage Municipal Code, Title 21 Land Use Planning*. As master plan improvements are implemented through site design; on-site development shall adhere to all required property setbacks, stream setbacks, landscape requirements, parking requirements, allowable uses and dimensional standards to ensure conformance with Title 21 regulations.

## FUNDING SOURCES

### MUNICIPAL PARK BONDS

Historically, park improvement projects have been funded in large part by the passage of voter supported Municipal Park Bonds. Continued engagement with the public and successful implementation of park projects demonstrates the value of investments in park improvement projects.

### STATE AND FEDERAL GRANTS

State and federal grants provide various levels of funding for capital improvement projects in parks. In recent years, state legislative grants have helped fund millions of dollars in investments in Anchorage parks. However, this source of funding has proven less reliable in times of budgetary uncertainty. A variety of federal grants are also available and worth pursuing. For example, the recently completed *Muldoon Town Square Park Master Plan* (now Chanshtnu Muldoon Park) was used to support a successful Land Water and Conservation Fund (LWCF) grant application, which yielded \$750,000 in funding to further park development.

### FUNDRAISING

Local residents and business owners who support the vision of Taku Lake Park may be inclined to contribute time or resources to the future park development. The master plan supports continued engagement with local residents and businesses to build community ownership and leverage funds to provide added value to park improvement project.

### CAPITAL IMPROVEMENT PROGRAM

The Municipality of Anchorage uses the Capital Improvement Program (CIP) as the main planning and budgeting tool to identify desired public facilities and capital improvements over a six year cycle. Park development projects are not typically top priorities on the CIP but do receive support and funding when available.

### PUBLIC-PRIVATE PARTNERSHIPS

Implementation of the improvements identified in this master plan for Taku Lake Park may benefit from funding from non-governmental sources. Collaboration with community partners such as the Anchorage Park Foundation have proven successful in leveraging available funds and matching grants.

Philanthropic interests provide another potential source of funding for park improvements. Organizations such as the Rasmuson Foundation, have worked closely with the Anchorage Park Foundation to invest millions of dollars into improving Anchorage Parks. Local business and major corporations have also contributed to park improvement projects over the years and provide another avenue for funding.

## APPENDIX A: RESOLUTIONS

Resolution of Support  
for  
Parks and Rec Master Plan Update  
for  
Taku Lake Park

Whereas the Master Plan for Taku Lake Park has gone through a thorough public input process and

Whereas Parks and Rec has produced a sensible and sustainable Master Plan for Taku Lake Park  
and

Whereas the Update takes into account as much of the future needs as possible

Therefore, Be it Resolved, Taku Campbell Community Council supports the Master Plan as Parks  
has presented it.

Respectfully Submitted,

Jeff Schmitz

Secretary and Chair, Streets and Trails Committee

Signed,

Ron Jordan, President

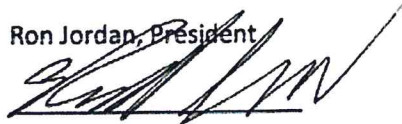

May 11 2017

Votes: Yay: 8 Nay: 0



**Municipality of Anchorage, Alaska  
Parks & Recreation Commission**

632 W. 6<sup>th</sup> Avenue, Suite 630  
P.O. Box 196650  
Anchorage, AK 99519  
Tel 907-343-4355

URL [www.muni.org/departments/parks](http://www.muni.org/departments/parks)



**PRC RES NO. 2018-09  
TAKU LAKE PARK MASTER PLAN**

WHEREAS, the Anchorage Parks and Recreation Commission serves in an advisory capacity to both the Mayor and the Assembly; and

WHEREAS, the Anchorage Parks and Recreation Commission has the responsibility and duty to provide for the long term vision of our park system by ensuring that a balance of parks, natural resources, and recreation facilities provides for the health, welfare, and safety of all residents of the Anchorage Bowl; and

WHEREAS, the most recent master plan for Taku Lake Park was completed in 1997 and upgrades are needed to address current issues and meet the demand for recreational facilities; and

WHEREAS, the proposed Taku Lake Park Master Plan provides a guiding vision for the management, maintenance and development of Taku Lake Park by aiming to balance recreational uses with the preservation of important natural resources; and

WHEREAS, the Anchorage Parks and Recreation Department worked with local stakeholders throughout the planning process to identify and prioritize improvements and to develop a 20-year vision for Taku Lake Park; and

WHEREAS, the Taku Lake Park Master Plan embodies the community's vision to provide active and healthy year-round recreational opportunities while preserving important natural resources for future generations; and

WHEREAS, the recommendations proposed in the Taku Lake Park Master Plan attempt to balance the diverse wants and needs of park users and are informed by best practices in recreation and natural resource management; and

WHEREAS, the Taku Lake Park Master Plan is supported by the Taku-Campbell Community Council; and

NOW, THEREFORE, BE IT RESOLVED that the Anchorage Parks and Recreation Commission approves the Taku Lake Park Master Plan as submitted by the Parks and Recreation Department.

PASSED AND APPROVED by the Anchorage Parks and Recreation Commission this 10th day of May, 2018.

ATTEST:   
John Rodda, Director  
Parks & Recreation Department

  
Chair  
Parks and Recreation Commission

PARKS & RECREATION COMMISSION  
Municipality of Anchorage, Alaska



TAKU LAKE PARK | master plan

# Municipality of Anchorage

## PARKS & RECREATION DEPARTMENT



### TAKU LAKE PARK LEGAL DESCRIPTION

Status: Dedicated

Address: 100 E 76<sup>th</sup> Ave, 99518; 8200 Stormy Pl, 99518

Size: 63.19 acres

Property Tax ID/Parcel Size/Legal Description/Plat *(from north to south)*

1. 013-044-50-000 (3.57 acres) Thomson Industrial TR A-1 (Plat 74-0153)
2. 012-182-14-000 (10.41 acres) Campbell Glen #2 TR A-2 (Plat 77-0124)
3. 012-182-15-000 (2.28 acres) Campbell Glen #2 TR D PTN (Plat 77-0124)
4. 013-061-02-000 (36.91 acres) Campbell Glen #2 E Less PTN (Plat not listed on MOA Parcel Information Page)
5. 013-071-42-000 (7.60 acres) Campbell Creek Greenbelt Lt 76A (Plat 74-0016)
6. 013-071-43-000 (2.24 acres) Campbell Creek Greenbelt Lt 76 (Plat not listed on MOA Parcel Information Page)

Grid: SW2230, SW2130, SW2131

Township Range Section: 12N R3W Section 07; 12N R3W Section 06

Zoning: R2M, I-2

**WMS WATERCOURSE MAPPING SUMMARY**

Per the requirements for watercourse verification outlined in Project Management and Engineering Operating Policy and Procedure #8 and Planning Department Operating Policy and Procedure #1 (effective June 18, 2007), MOA Watershed Management Services has inspected the following location for the presence or absence of stream channels or other watercourses, as defined in Anchorage Municipal Code (21.35).

- Project Case Number or Subdivision Name: Taku Lake Park Master Plan
- Project Location, Tax ID, or Legal Description: Taku Lake Park: 8200 Stormy Place; 100E. 76th Avenue  
013-044-50-000, 012-182-14-000, 12-182-15-000, 013-061-02-000, 013-071-42-000, 013-071-43-000
- Project Area (if different from the entire parcel or subdivision): \_\_\_\_\_

In accordance with the requirements and methods identified, WMS verifies that this parcel, project area, or application:

\_\_\_\_\_ **DOES NOT** contain stream channels and/or drainageways, as identified in WMS field or archival mapping information.\*

X KBC **DOES** contain stream channels and/or drainageways **AND** these are located and identified on submittal documents in general congruence with WMS field and archival mapping information.  
*New or additional mapping **IS NOT REQUIRED**.*\*

\_\_\_\_\_ Contains stream channels and/or drainageways **BUT** one or more streams or other watercourses:  

- are **NOT** shown on submittal documents, or
- are **NOT** depicted adequately on submittal documents for verification, or
- are **NOT** located or identified on submittal documents in general congruence with WMS field and archival mapping information.

*New or additional mapping **IS REQUIRED** and must be re-submitted for further review and verification.*\*

\_\_\_\_\_ Presence of stream channels and/or drainageways is unknown **AND** field verification is not possible at this time. WMS will verify as soon as conditions and prioritized resources allow.

\* Streams omitted in error by WMS or others remain subject to MOA Code and must be shown in new mapping upon identification of the error.

**ADDITIONAL INFORMATION:**

- |  |  |                                      |                                |
|--|--|--------------------------------------|--------------------------------|
| <input type="checkbox"/> Y <input checked="" type="checkbox"/> N | WMS written drainage recommendations are available.      | <input type="checkbox"/> Preliminary | <input type="checkbox"/> Final |
| <input type="checkbox"/> Y <input checked="" type="checkbox"/> N | WMS written field inspection report or map is available. | <input type="checkbox"/> Preliminary | <input type="checkbox"/> Final |
| <input type="checkbox"/> Y <input checked="" type="checkbox"/> N | Field flagging and/or map-grade GPS data is available.   |                                      |                                |

Inspection Certified By:

Date:



6/1/18

# 2018-0082

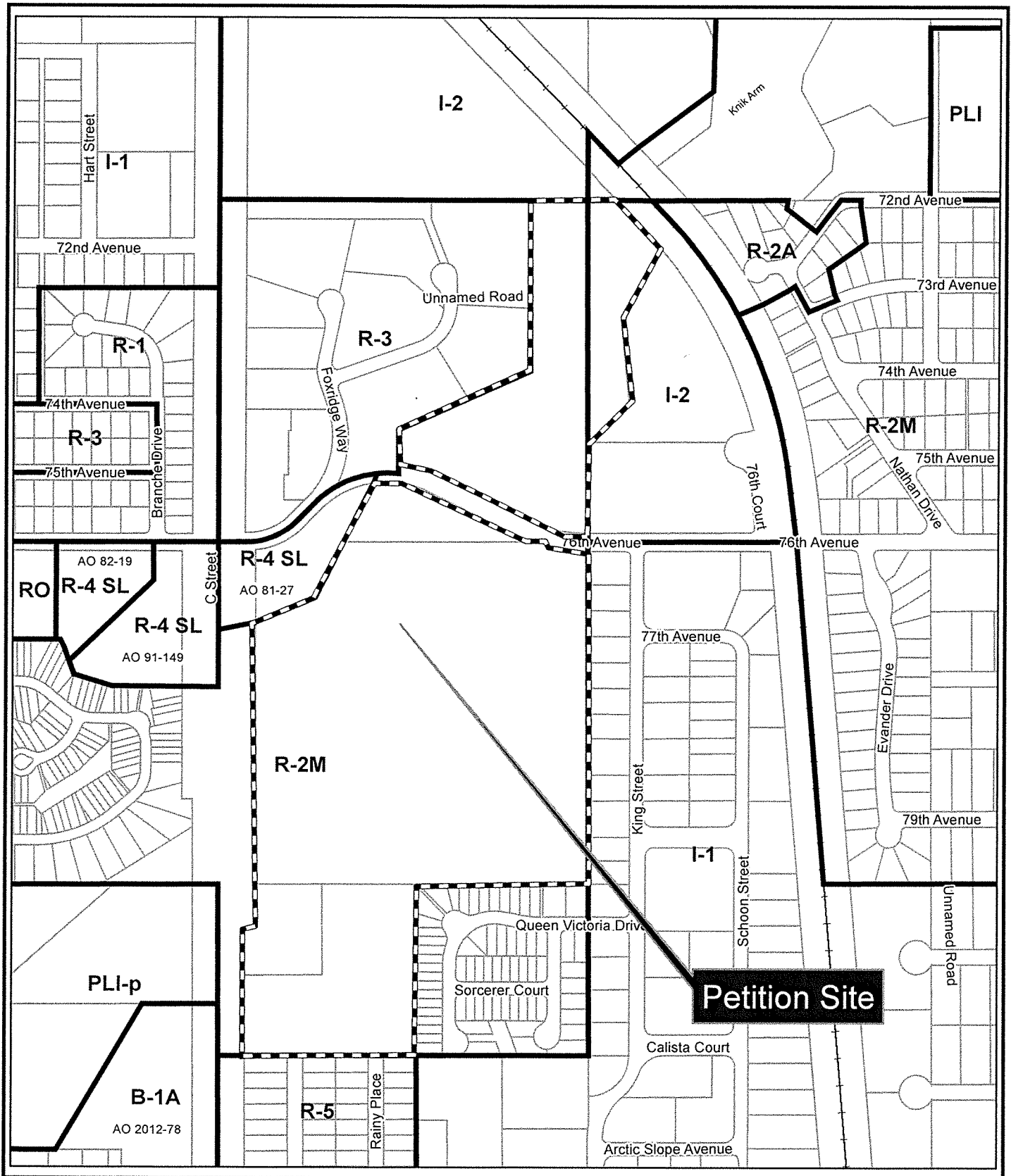

# 2018-0082

