

SEE PAGE GM 3

SEE PAGE GM 2

LEGEND



BENCH MARK

1234 MITS INDENTIFICATION NO.

GW 1 MONUMENT NAME

5012 GRID NUMBER



GM 1

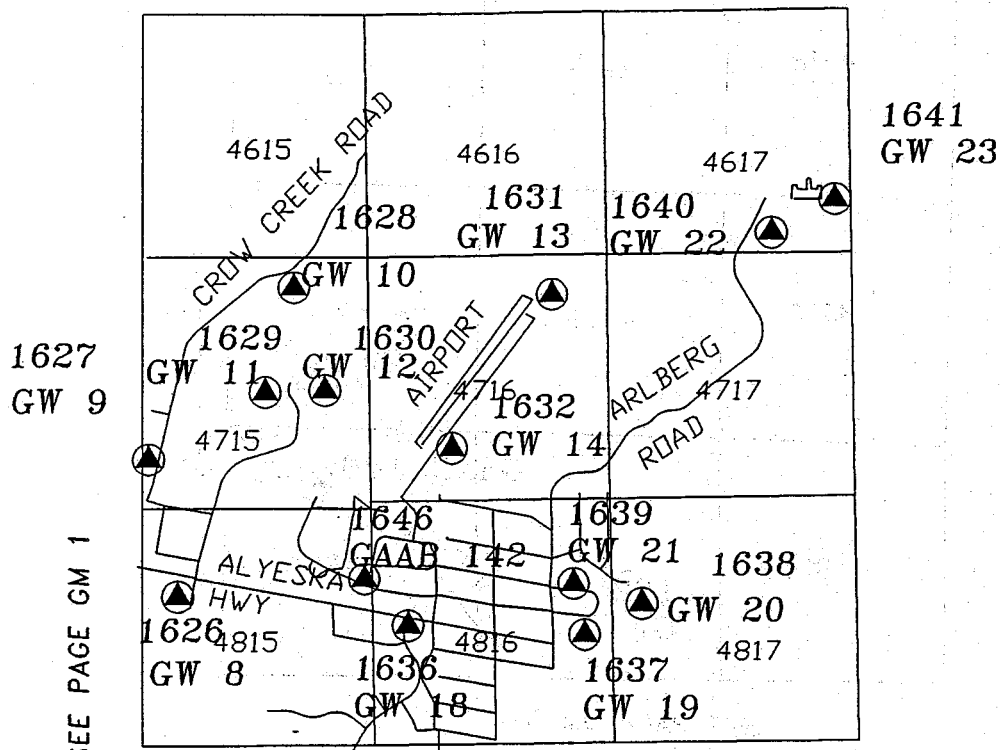

1627
GW 9

SEE PAGE GM 1

1641
GW 23

SEE PAGE GM 4

LEGEND

- ▲ BENCH MARK
- 1234 MITS INDENTIFICATION NO.
- GW 1 MONUMENT NAME
- 5012 GRID NUMBER

GM 2

SEE PAGE GM 1

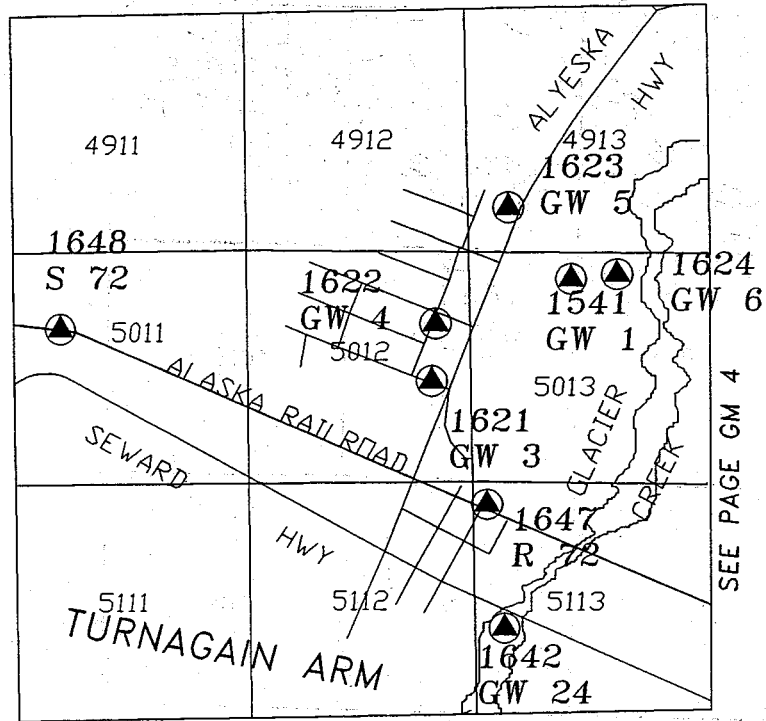

LEGEND

-  BENCH MARK
- 1234 MITS INDENTICATION NO.
- GW 1 MONUMENT NAME
- 5012 GRID NUMBER

GM 3

SEE PAGE GM 2

SEE PAGE GM 3

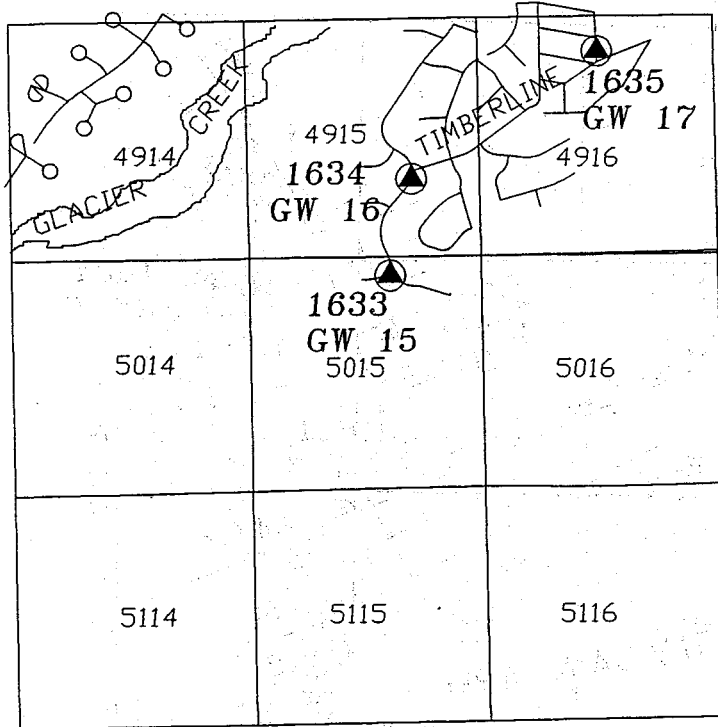

LEGEND



BENCH MARK

1234 MITS INDENTIFICATION NO.

GW 1 MONUMENT NAME

5012 GRID NUMBER

GM 4

NAME INDEX

NAME	MITS ID	100 SCALE GRID NO.	ELEVATION	DESC. PAGE	MAP PAGE
GAAB 140	1645	4814	113.92	GD-1	GM 1
GAAB 142	1646	4815	145.83	GD-1	GM 2
GW 1	1541	5013	56.79	GD-2	GM 3
GW 3	1621	5012	70.85	GD-2	GM 3
GW 4	1622	5012	102.70	GD-3	GM 3
GW 5	1623	4913	81.34	GD-3	GM 3
GW 6	1624	5013	63.57	GD-4	GM 3
GW 7	1625	4813	121.34	GD-4	GM 1
GW 8	1626	4815	103.93	GD-5	GM 2
GW 9	1627	4715	139.02	GD-5	GM 2
GW 10	1628	4715	165.24	GD-6	GM 2
GW 11	1629	4715	148.88	GD-6	GM 2
GW 12	1630	4715	148.84	GD-7	GM 2
GW 13	1631	4716	164.58	GD-7	GM 2
GW 14	1632	4716	128.28	GD-8	GM 2
GW 15	1633	5015	257.62	GD-8	GM 4
GW 16	1634	4915	170.84	GD-9	GM 4
GW 17	1635	4916	251.22	GD-9	GM 4
GW 18	1636	4816	164.21	GD-10	GM 2
GW 19	1637	4816	264.48	GD-10	GM 2
GW 20	1638	4817	295.27	GD-11	GM 2
GW 21	1639	4816	236.11	GD-11	GM 2
GW 22	1640	4617	249.52	GD-12	GM 2
GW 23	1641	4617	263.52	GD-12	GM 2
GW 24	1642	5113	30.45	GD-13	GM 3
R 72	1647	5113	24.17	GD-14	GM 3
S 72	1648	5011	17.61	GD-14	GM 3

GI 1

GRID INDEX

100 SCALE GRID NO.	MITS ID	NAME	ELEVATION	DESC. PAGE	MAP PAGE
4617	1640	GW 22	249.52	GD-12	GM 2
4617	1641	GW 23	263.52	GD-12	GM 2
4715	1627	GW 9	139.02	GD-5	GM 2
4715	1628	GW 10	165.24	GD-6	GM 2
4715	1629	GW 11	148.88	GD-6	GM 2
4715	1630	GW 12	148.84	GD-7	GM 2
4716	1631	GW 13	164.58	GD-7	GM 2
4716	1632	GW 14	128.28	GD-8	GM 2
4813	1625	GW 7	121.34	GD-4	GM 1
4814	1645	GAAB 140	113.92	GD-1	GM 1
4815	1646	GAAB 142	145.83	GD-1	GM 2
4815	1626	GW 8	103.93	GD-5	GM 2
4816	1636	GW 18	164.21	GD-10	GM 2
4816	1637	GW 19	264.48	GD-10	GM 2
4816	1639	GW 21	236.11	GD-11	GM 2
4817	1638	GW 20	295.27	GD-11	GM 2
4913	1623	GW 5	81.34	GD-3	GM 3
4915	1634	GW 16	170.84	GD-9	GM 4
4916	1635	GW 17	251.22	GD-9	GM 4
5011	1648	S 72	17.61	GD-14	GM 3
5012	1621	GW 3	70.85	GD-2	GM 3
5012	1622	GW 4	102.70	GD-3	GM 3
5013	1541	GW 1	56.79	GD-2	GM 3
5013	1624	GW 6	63.57	GD-4	GM 3
5015	1633	GW 15	257.62	GD-8	GM 4
5113	1642	GW 24	30.45	GD-13	GM 3
5113	1647	R 72	24.17	GD-14	GM 3

GI 2

Monument ID: [01645] Surveyor: [USKH]]
 Book-Page: [646- 48] LS Number: []]
 Recvy Date: [/ /] Monument Name: [GAAB 140]]
 Maint Date: [/ /] Monument Cond: []]
 Grids: [4814] Status Code: [V] (C,G,V)]
 Township: T 0N, R 0, SM Sec 0 Type Code:[19] Deep Bench]
 Subdivision: [] Corner:[]]
 S.I. Locate: [] Legal:[]]
 Dig X Coord: [0] SP X Coord: [] 3 Order, 0 Class]
 Dig Y Coord: [0] SP Y Coord: []]
 SP Z Coord: [113.92]Datum: 1972 Adjustment]
 GPS Code: [] Inertial Code: [] Photo Code: []]
 Proj. Name: []]

Comments or Markings:

Description:

[Beginning at the intersection of the Seward Hwy. and Alyeska Hwy.; thence]
 [northerly 2.0 miles along Alyeska Hwy. to the intersection with Crow Creek]
 [Road. The bench mark is in the northwest quadrant of the intersection 33]
 [feet west of the centerline of Crow Creek Road, 45 feet north of the center]
 [line of the Alyeska Hwy., 4 feet north of a light pole, and 6 feet south-]
 [west of a STOP sign. The bench mark is a standard 0.3 foot dia. USC&GS cap]
 [on 13 feet of 5/8" Copperweld drive to refusal. The cap is 0.6 feet below]
 [ground encased in a 4 inch dia. ductile iron pipe, top of pipe is 0.2 feet]
 [above the cap.]

Monument ID: [01646] Surveyor: [USKH]]
 Book-Page: [646- 49] LS Number: []]
 Recvy Date: [/ /] Monument Name: [GAAB 142]]
 Maint Date: [/ /] Monument Cond: []]
 Grids: [4815] Status Code: [V] (C,G,V)]
 Township: T 0N, R 0, SM Sec 0 Type Code:[19] Deep Bench]
 Subdivision: [] Corner:[]]
 S.I. Locate: [] Legal:[]]
 Dig X Coord: [0] SP X Coord: [] 3 Order, 0 Class]
 Dig Y Coord: [0] SP Y Coord: []]
 SP Z Coord: [145.83]Datum: 1972 Adjustment]
 GPS Code: [] Inertial Code: [] Photo Code: []]
 Proj. Name: []]

Comments or Markings:

Description:

[Beginning at the intersection of the Seward Hwy. and Alyeska Hwy.; thence]
 [northerly 2.6 miles along Alyeska Hwy. to in the intersection with Donner]
 [Loop Road; thence north on Donner Loop Road 0.1 mile to the intersection]
 [with Davos Road. The bench mark is in the northeast quadrant of the inter-]
 [section, 37 feet east of the centerline of Donner Loop Road and 37 feet]
 [north of the centerline of Davos Road.]
 [The bench mark is a standard 0.3 foot dia. USC&GS brass cap on 5/8" Copper-]
 [weld driven to refusal. The cap is 0.6 feet above ground encased in 4"]
 [ductile iron pipe, the pipe is 0.2 feet above the cap.]

GD-1

Monument ID: [01541] Surveyor: [DOWL]
 Book-Page: [2511- 15] LS Number: []
 Recvy Date: [/ /] Monument Name: [MOA GW 1]
 Maint Date: [/ /] Monument Cond: [GOOD]
 Grids: [5013] Status Code: [V] (C,G,V)
 Township: T 0N, R 0, SM Sec 0 Type Code:[18] 1/2" Anchor bolt
 Subdivision: [] Corner:[]
 S.I. Locate: [] Legal:[]
 Dig X Coord: [0] SP X Coord: [] 3 Order, 0 Class
 Dig Y Coord: [0] SP Y Coord: []
 SP Z Coord: [56.79] Datum: 1972 Adjustment
 GPS Code: [N] Inertial Code: [N] Photo Code: []
 Proj. Name: []

Comments or Markings:

[
 Description:
 [Beginning at the intersection of the Alyeska Highway and Ruane Road;
 [thence southeasterly along Ruane Road 1172 feet; thence southwesterly 140
 [feet to the northern most corner of the shop building at the Girdwood
 [Sanitary Waste Facility. A 1/2" x 3 3/4" anchor bolt with 2" diameter
 [washer is 0.85 feet from said corner on the northwest face of the building.]
 [Bench mark is 1.15 feet above asphalt. Use top of threads for elevation.]
]
]
]
]

Monument ID: [01621] Surveyor: [USKH]
 Book-Page: [0- 0] LS Number: []
 Recvy Date: [/ /] Monument Name: [GW 3]
 Maint Date: [/ /] Monument Cond: []
 Grids: [5012] Status Code: [V] (C,G,V)
 Township: T 0N, R 0, SM Sec 0 Type Code:[18] 1/2" Anchor bolt
 Subdivision: [] Corner:[]
 S.I. Locate: [] Legal:[]
 Dig X Coord: [0] SP X Coord: [] 3 Order, 0 Class
 Dig Y Coord: [0] SP Y Coord: []
 SP Z Coord: [70.85] Datum: 1972 Adjustment
 GPS Code: [] Inertial Code: [] Photo Code: []
 Proj. Name: []

Comments or Markings:

[
 Description:
 [Beginning at the intersection of the Seward Highway and Alyeska Highway;
 [thence northerly 0.3 miles to Forest Station Road; thence westerly 247
 [feet; thence southerly 106 feet to the easterly corner of the Forest
 [Station Building; thence along the easterly face of the building 44 feet
 [to the southerly corner of the building; thence northwesterly 12 feet
 [along the southerly face to the benchmark. The benchmark is 1.0 feet
 [easterly of double doors on building and 1.0 feet above ground.
 [Benchmark is a 4" x 1/2" all-thread set horizontally 2 1/2" deep in building
 [foundation. A 2" stainless steel washer with benchmark I.D. stamped on it
 [with a 1" nut. Use top of threads for elevation.]
]
]
]

Monument ID: [01622] Surveyor: [USKH]
 Book-Page: [0- 0] LS Number: []
 Recvy Date: [/ /] Monument Name: [GW 4]
 Maint Date: [/ /] Monument Cond: []
 Grids: [5012] Status Code: [V] (C,G,V)
 Township: T 0N, R 0, SM Sec 0 Type Code:[19] Deep Bench
 Subdivision: [] Corner:[]
 S.I. Locate: [] Legal:[]
 Dig X Coord: [0] SP X Coord: [] 3 Order, 0 Class
 Dig Y Coord: [0] SP Y Coord: []
 SP Z Coord: [102.70] Datum: 1972 Adjustment
 GPS Code: [] Inertial Code: [] Photo Code: []
 Proj. Name: []

Comments or Markings:

Description:

[Beginning at the intersection of the Seward Hwy and the Alyeska Hwy;
 [northerly 0.51 miles along the Alyeska Hwy to the intersection of
 [Gunnysack Mine Road; thence northwesterly approx. 350 feet to the inter-
 [section with Sproat Road. The bench mark is in the southern quadrant of
 [the intersection. The bench mark is 28 feet south of the centerline of
 [Gunnysack Mine Road and 41 feet east of the centerline of Sproat Road.
 [The bench mark bears N 65°30' E 11.5 feet from a manhole.
 [The bench mark is a 2" diameter aluminum cap on 1/2" aluminum rod driven
 [10.5 feet to refusal. The bench mark is encased in 6" PVC that extends
 [0.5 feet above the ground.]

Monument ID: [01623] Surveyor: [USKH]
 Book-Page: [0- 0] LS Number: []
 Recvy Date: [/ /] Monument Name: [GW 5]
 Maint Date: [/ /] Monument Cond: []
 Grids: [4913] Status Code: [V] (C,G,V)
 Township: T 0N, R 0, SM Sec 0 Type Code:[18] 1/2" Anchor bolt
 Subdivision: [] Corner:[]
 S.I. Locate: [] Legal:[]
 Dig X Coord: [0] SP X Coord: [] 3 Order, 0 Class
 Dig Y Coord: [0] SP Y Coord: []
 SP Z Coord: [81.34] Datum: 1972 Adjustment
 GPS Code: [] Inertial Code: [] Photo Code: []
 Proj. Name: []

Comments or Markings:

Description:

[Beginning at the intersection of the Seward Hwy. and Alyeska Hwy; thence
 [northerly along the Alyeska Hwy. 0.79 miles to the intersection at Ruane
 [Road. The bench mark is in the east side of a manhole in the west ditch
 [of the Alyeska Hwy at the intersection. The bench mark is 34 feet west of
 [the centerline of Alyeska Hwy and 21 feet east of the centerline of the
 [bike trail and 32 feet S.E. of power pole #L12B. Bench mark is 1.8 feet
 [above ground an 1.5 feet below manhole lid.
 [Bench mark is a 3-1/2" x 1/2" stainless steel anchor bolt with 2" stainless
 [steel washer with I.D. stamped on it.]

GD-3

Monument ID: [01624] Surveyor: [USKH]
 Book-Page: [0- 0] LS Number: []
 Recvy Date: [/ /] Monument Name: [GW 6]
 Maint Date: [/ /] Monument Cond: []
 Grids: [5013] Status Code: [V] (C,G,V)
 Township: T 0N, R 0, SM Sec 0 Type Code:[18] 1/2" Anchor bolt
 Subdivision: [] Corner:[]
 S.I. Locate: [] Legal:[]
 Dig X Coord: [0] SP X Coord: [] 3 Order, 0 Class
 Dig Y Coord: [0] SP Y Coord: []
 SP Z Coord: [63.57] Datum: 1972 Adjustment
 GPS Code: [] Inertial Code: [] Photo Code: []
 Proj. Name: []

Comments or Markings:

Description:

[Beginning at the intersection of the Seward Hwy. and the Alyeska Hwy:
 [thence northerly along the Alyeska Hwy. 0.79 miles to the intersection
 [at Ruane Road; thence southeasterly approx. 1000 feet to the refuse trans
 [fer main building; thence easterly 37 feet along the northerly wall;
 [thence north 9.5 feet to the bench mark. The bench mark is 3.0 feet above
 [ground and 0.5 below top of a drive in a concrete retaining wall outside
 [the western most garage door.
 [The bench mark is a 3-1/2" x 1/2" stainless steel anchor bolt with 2" stainless
 [steel wash with I.D. stamped on it.]

Monument ID: [01625] Surveyor: [USKH]
 Book-Page: [0- 0] LS Number: []
 Recvy Date: [/ /] Monument Name: [GW 7]
 Maint Date: [/ /] Monument Cond: []
 Grids: [4813] Status Code: [V] (C,G,V)
 Township: T 0N, R 0, SM Sec 0 Type Code:[19] Deep Bench
 Subdivision: [] Corner:[]
 S.I. Locate: [] Legal:[]
 Dig X Coord: [0] SP X Coord: [] 3 Order, 0 Class
 Dig Y Coord: [0] SP Y Coord: []
 SP Z Coord: [121.34] Datum: 1972 Adjustment
 GPS Code: [] Inertial Code: [] Photo Code: []
 Proj. Name: []

Comments or Markings:

Description:

[Beginning at the intersection of the Seward Hwy. and Alyeska Hwy, thence
 [northerly 1.42 miles along the Alyeska Hwy. approximately 290 feet north
 [of Glacier Ave., 13 feet west of the bike trail, 4.5 feet west of power
 [pole #L21, 10 feet south of the driveway to "Winter Creek Plumbing &
 [Heating", 70 feet west of the centerline of Alyeska Hwy.
 [Bench mark is a 2" aluminum cap on 9.5 feet of drive rod driven to refusal.
 [Benchmark is encased in a 6" PVC extending 0.5 feet above ground. A 2"x4"
 [witness post is one foot from benchmark.]

GD-4

Monument ID: [01626] Surveyor: [USKH]
 Book-Page: [0- 0] LS Number: []
 Recvy Date: [/ /] Monument Name: [GW 8]
 Maint Date: [/ /] Monument Cond: []
 Grids: [4815] Status Code: [V] (C,G,V)
 Township: T 0N, R 0, SM Sec 0 Type Code:[18] 1/2" Anchor bolt
 Subdivision: [] Corner:[]
 S.I. Locate: [] Legal:[]
 Dig X Coord: [0] SP X Coord: [] 3 Order, 0 Class
 Dig Y Coord: [0] SP Y Coord: []
 SP Z Coord: [103.93]Datum: 1972 Adjustment
 GPS Code: [] Inertial Code: [] Photo Code: []
 Proj. Name: []

Comments or Markings:

Description:

[Beginning at the intersection of the Seward Hwy. and Alyeska Hwy.; thence
 [northerly 2.20 miles along the Alyeska Hwy. to the intersection with
 [Hightower Road; thence southerly 438 feet along Hightower Road; thence west]
 [128 feet to the southeast corner of Anchorage Firestation #15. The bench
 [mark is 6.2 feet north and 4.5 feet west of the southeast corner of the
 [fire station building in the southern most garage door.
 [The bench mark is a 1/2" x 4" stainless steel anchorage bolt set vertically]
 [in the concrete garage floor. The bolt extends 1" above the floor, use top]
 [of bolt for elevation.]

Monument ID: [01627] Surveyor: [USKH]
 Book-Page: [0- 0] LS Number: []
 Recvy Date: [/ /] Monument Name: [GW 9]
 Maint Date: [/ /] Monument Cond: []
 Grids: [4715] Status Code: [V] (C,G,V)
 Township: T 0N, R 0, SM Sec 0 Type Code:[19] Deep Bench
 Subdivision: [] Corner:[]
 S.I. Locate: [] Legal:[]
 Dig X Coord: [0] SP X Coord: [] 3 Order, 0 Class
 Dig Y Coord: [0] SP Y Coord: []
 SP Z Coord: [139.02]Datum: 1972 Adjustment
 GPS Code: [] Inertial Code: [] Photo Code: []
 Proj. Name: []

Comments or Markings:

Description:

[Beginning at the intersection of the Alyeska Hwy. and Crow Creek Road;
 [thence northerly 0.24 miles along Crow Creek Road. The bench mark is
 [34 feet west of the centerline of Crow Creek Road, 9 feet northeast of
 [a power pole, 10 feet south of the southern most entrance to the "Double
 [Musky Inn". The bench mark is 31 feet east of a small log cabin and 13 feet
 [north of the centerline of a drainage ditch.
 [The bench mark is a 2" diameter aluminum cap on 9 feet 5 inches of 5/8"
 [drive rod driven to refusal. Bench mark is encased in 6" dia. PVC pipe
 [that extends 6" above ground. A 2" X 4" Witness Post is 1 foot from the
 [bench mark.]

GD-5

Monument ID: [01628] Surveyor: [USKH]
 Book-Page: [0- 0] LS Number: []
 Recvy Date: [/ /] Monument Name: [GW 10]
 Maint Date: [/ /] Monument Cond: []
 Grids: [4715] Status Code: [V] (C,G,V)
 Township: T 0N, R 0, SM Sec 0 Type Code:[19] Deep Bench
 Subdivision: [] Corner:[]
 S.I. Locate: [] Legal:[]
 Dig X Coord: [0] SP X Coord: [] 3 Order, 0 Class
 Dig Y Coord: [0] SP Y Coord: []
 SP Z Coord: [165.24] Datum: 1972 Adjustment
 GPS Code: [] Inertial Code: [] Photo Code: []
 Proj. Name: []

Comments or Markings:

Description:

[Beginning at the intersection of the Alyeska Hwy. and Crow Creek Road;
 [thence northerly 0.7 miles along Crow Creek Road to the "cul de sac"
 [where the State maintained portion of the road ends. The bench mark is 35
 [feet east of the centerline of Crow Creek Road, 13 feet south of a 2.3 foot
 [diameter Spruce, 8 feet southeast of a 1.5 foot diameter Spruce, and 10
 [feet northeast of a 1.5 foot diameter Spruce.
 [Bench mark is a 2" aluminum cap on 9 feet 7 inches of 5/8" drive rod driven
 [to refusal. Bench mark is encased in 6" dia. PVC that extends 6" above
 [ground. A 2" x 4" Witness Post is 1 foot from bench mark.]

Monument ID: [01629] Surveyor: [USKH]
 Book-Page: [0- 0] LS Number: []
 Recvy Date: [/ /] Monument Name: [GW 11]
 Maint Date: [/ /] Monument Cond: []
 Grids: [4715] Status Code: [V] (C,G,V)
 Township: T 0N, R 0, SM Sec 0 Type Code:[18] 1/2" Anchor bolt
 Subdivision: [] Corner:[]
 S.I. Locate: [] Legal:[]
 Dig X Coord: [0] SP X Coord: [] 3 Order, 0 Class
 Dig Y Coord: [0] SP Y Coord: []
 SP Z Coord: [148.88] Datum: 1972 Adjustment
 GPS Code: [] Inertial Code: [] Photo Code: []
 Proj. Name: []

Comments or Markings:

Description:

[Beginning at the intersection of the Alyeska Hwy. and Hightower Road;
 [thence northerly along Hightower Road to the Girdwood Elementary School.
 [The bench mark is at the northwest corner of the school/Municipal Library.
 [The benchmark is on the west face 0.17 feet south of the northwest corner
 [and 0.9 feet above the ground.
 [The bench mark is a 4½ " x ½" stainless all-thread set horizontally that
 [has a washer with I.D. stamped on it, with 3/4" nut. Bench mark extends
 [2" from wall. Use top of thread for elevation.]

GD-6

Monument ID: [01630] Surveyor: [USKH]
 Book-Page: [0- 0] LS Number: []
 Recvy Date: [/ /] Monument Name: [GW 12]
 Maint Date: [/ /] Monument Cond: []
 Grids: [4715] Status Code: [V] (C,G,V)
 Township: T 0N, R 0, SM Sec 0 Type Code:[18] 1/2" Anchor bolt
 Subdivision: [] Corner:[]
 S.I. Locate: [] Legal:[]
 Dig X Coord: [0] SP X Coord: [] 3 Order, 0 Class
 Dig Y Coord: [0] SP Y Coord: []
 SP Z Coord: [148.84]Datum: 1972 Adjustment
 GPS Code: [] Inertial Code: [] Photo Code: []
 Proj. Name: []

Comments or Markings:

Description:

[Beginning at the intersection of the Alyeska Hwy. and Hightower Road;
 [thence northerly along Hightower Road to the Girdwood Elementary School.
 [Bench mark is on the south side of the school, at the center school
 [entrance, outside of the school main office. Bench mark is west of the
 [entrance, before the steps, in a concrete wing wall. Bench mark is 23.4
 [feet south of the main entrance doors, 0.6 feet above ground, and 0.5 feet
 [west of the east face of a wing wall.
 [Bench mark is a 4" x 1/2" stainless steel anchor bolt set 3" deep with a
 [2" dia. stainless steel washer with I.D. stamped on it and 3/4" nut. Use
 [top of threads for elevation.

Monument ID: [01631] Surveyor: [USKH]
 Book-Page: [0- 0] LS Number: []
 Recvy Date: [/ /] Monument Name: [GW 13]
 Maint Date: [/ /] Monument Cond: []
 Grids: [4716] Status Code: [V] (C,G,V)
 Township: T 0N, R 0, SM Sec 0 Type Code:[19] Deep Bench
 Subdivision: [] Corner:[]
 S.I. Locate: [] Legal:[]
 Dig X Coord: [0] SP X Coord: [] 3 Order, 0 Class
 Dig Y Coord: [0] SP Y Coord: []
 SP Z Coord: [164.58]Datum: 1972 Adjustment
 GPS Code: [] Inertial Code: [] Photo Code: []
 Proj. Name: []

Comments or Markings:

Description:

[Beginning at the intersection of the Seward Hwy. and Alyeska Hwy.; thence
 [northeasterly 2.51 miles along the Alyeska Hwy. to the intersection of
 [Donner Loop Road; turn left (north) on Donner Loop, go one block to Davos
 [Road, turn left (west) go one block on Davos to Mt. Hood Drive; turn right]
 [(north) on Mt. Hood Drive, go 0.27 miles to the Girdwood Airport. The Bench
 [mark is at the north end of the runway, 291 feet east of the centerline,
 [57 feet east of the access road that parallels the runway and N 66° E, 41.5]
 [feet from a sanitary sewer manhole. Bench mark is a 2" dia. aluminum cap
 [on 7.5 feet of 5/8" drive rod. Mon is 0.2 feet below ground in a 6" dia.
 [PVC pipe that extends 6" above ground.

GD-7

Monument ID: [01632] Surveyor: [USKH]
 Book-Page: [0- 0] LS Number: []
 Recvy Date: [/ /] Monument Name: [GW 14]
 Maint Date: [/ /] Monument Cond: []
 Grids: [4716] Status Code: [V] (C,G,V)
 Township: T 0N, R 0, SM Sec 0 Type Code:[18] 1/2" Anchor bolt
 Subdivision: [] Corner:[]
 S.I. Locate: [] Legal:[]
 Dig X Coord: [0] SP X Coord: [] 3 Order, 0 Class
 Dig Y Coord: [0] SP Y Coord: []
 SP Z Coord: [] Datum: 1972 Adjustment
 GPS Code: [] Inertial Code: [] Photo Code: []
 Proj. Name: []

Comments or Markings:

Description:
 [Beginning at the intersection of the Seward Hwy. and Alyeska Hwy. thence;
 [northeasterly 2.51 miles along the Alyeska Hwy. to the intersection of
 [Donner Loop Road; turn left (north) on Donner Loop, go one block to Davos
 [Road, turn left (west) go one block on Davos to Mt. Hood Drive; turn right
 [(north) on Mt. Hood Drive, go 0.27 miles to the Girdwood Airport. The
 [bench mark is 31 feet east of the centerline of the road at this point. The
 [bench mark is 130 feet southeast of the southeast corner of a brown
 [aluminum hanger.
 [Bench mark is a 4" x 1/2" stainless steel anchor bolt set 2 3/4" deep
 [horizontally in a large rock. Use top of threads for elevation.]

Monument ID: [01633] Surveyor: [USKH]
 Book-Page: [0- 0] LS Number: []
 Recvy Date: [/ /] Monument Name: [GW 15]
 Maint Date: [/ /] Monument Cond: []
 Grids: [5015] Status Code: [V] (C,G,V)
 Township: T 0N, R 0, SM Sec 0 Type Code:[18] 1/2" Anchor bolt
 Subdivision: [] Corner:[]
 S.I. Locate: [] Legal:[]
 Dig X Coord: [0] SP X Coord: [] 3 Order, 0 Class
 Dig Y Coord: [0] SP Y Coord: []
 SP Z Coord: [] Datum: 1972 Adjustment
 GPS Code: [] Inertial Code: [] Photo Code: []
 Proj. Name: []

Comments or Markings:

Description:
 [Beginning at the intersection of the Seward Hwy. and Alyeska Hwy.; thence
 [northerly 2.66 miles along the Alyeska Hwy. to Timberline Drive; thence
 [right (south) on Timberline Drive 1 mile to the intersection with Virgin
 [Creek Road. Bench mark is in a 8 to 10 foot diameter rock, 32 feet east
 [northeast of the intersection. Bench mark bears N 31° E, 96 feet from a
 [fire hydrant in the southeast quadrant of the intersection and S 17° E, 66
 [feet from a concrete guard post on the east side of Timberline and north
 [of the intersection. Bench mark is a 4" x 1/2" stainless steel all thread
 [set 2 5/8" deep into the face of the rock 2.6 feet above ground.
 [Use top of threads for for elevation.]

Monument ID: [01634] Surveyor: [USKH]
 Book-Page: [0- 0] LS Number: []
 Recvy Date: [/ /] Monument Name: [GW 16]
 Maint Date: [/ /] Monument Cond: []
 Grids: [4915] Status Code: [V] (C,G,V)
 Township: T 0N, R 0, SM Sec 0 Type Code:[19] Deep Bench
 Subdivision: [] Corner:[]
 S.I. Locate: [] Legal:[]
 Dig X Coord: [0] SP X Coord: [] 3 Order, 0 Class
 Dig Y Coord: [0] SP Y Coord: []
 SP Z Coord: [170.84] Datum: 1972 Adjustment
 GPS Code: [] Inertial Code: [] Photo Code: []
 Proj. Name: []

Comments or Markings:

Description:

[Beginning at the intersection of the Seward Hwy. and Alyeska Hwy.; thence
 [northerly 2.66 miles along the Alyeska Hwy. to the intersection with
 [Timberline Drive, thence southerly 0.52 miles along Timberline Drive to
 [the intersection with Alta Drive. Benchmark is in the southwest corner of
 [the intersection, 25 feet south of the centerline of Alta Drive and 41 feet
 [west of the centerline of Timberline Drive, 6 feet southwest of a "YIELD"
 [and street sign.
 [Bench mark is a 2" dia. aluminum cap on 14.7 feet of 5/8" drive rod driven
 [to refusal encased in a 6" PVC pipe that extends 6" above ground.]

Monument ID: [01635] Surveyor: [USKH]
 Book-Page: [0- 0] LS Number: []
 Recvy Date: [/ /] Monument Name: [GW 17]
 Maint Date: [/ /] Monument Cond: []
 Grids: [4916] Status Code: [V] (C,G,V)
 Township: T 0N, R 0, SM Sec 0 Type Code:[18] 1/2" Anchor bolt
 Subdivision: [] Corner:[]
 S.I. Locate: [] Legal:[]
 Dig X Coord: [0] SP X Coord: [] 3 Order, 0 Class
 Dig Y Coord: [0] SP Y Coord: []
 SP Z Coord: [251.22] Datum: 1972 Adjustment
 GPS Code: [] Inertial Code: [] Photo Code: []
 Proj. Name: []

Comments or Markings:

Description:

[Beginning at the intersection of the Seward Hwy. and Alyeska Hwy.; thence
 [northerly 2.82 miles along the Alyeska Hwy. to the intersection with
 [Alyeska Ave.; thence right (south) 0.34 miles to the intersection of
 [Alyeska Ave with Tern St. and Lower Road. The bench mark is in the north
 [east corner of the intersection, 36 feet east of the centerline of Alyeska
 [Ave., 37 feet north of the centerline of Tern St., 24.6 feet southwest of
 [the southwest corner of a garage for the Glacier View Condos, and 18 feet
 [northwest of the STOP sign on Tern St. Bench mark is a 4" x 1/2" stainless
 [steel anchor bolt set horizontally 2 5/8" deep in a large rock, 1.0 feet
 [above ground. Use top of threads for elevation.]

GD-9

Monument ID: [01636] Surveyor: [USKH]
 Book-Page: [0- 0] LS Number: []
 Recvy Date: [/ /] Monument Name: [GW 18]
 Maint Date: [/ /] Monument Cond: []
 Grids: [4816] Status Code: [V] (C,G,V)
 Township: T 0N, R 0, SM Sec 0 Type Code:[19] Deep Bench
 Subdivision: [] Corner:[]
 S.I. Locate: [] Legal:[]
 Dig X Coord: [0] SP X Coord: [] 3 Order, 0 Class
 Dig Y Coord: [0] SP Y Coord: []
 SP Z Coord: [164.21] Datum: 1972 Adjustment
 GPS Code: [] Inertial Code: [] Photo Code: []
 Proj. Name: []

Comments or Markings:

Description:
 [Beginning at the intersection of the Seward Hwy. and Alyeska Hwy.; thence
 [northerly 2.62 miles along the Alyeska Hwy. to the intersection with
 [Timberline Drive. The bench mark is 67 feet south of the centerline of the
 [Alyeska Hwy., 22 feet south of a light pole, 34 feet west of the center-
 [line of Timberline Drive and 59 feet west of a STOP sign on Timberline Dr.
 [Bench mark is a 2" dia. aluminum cap set on 10.1 feet of 5/8" drive rod
 [driven to refusal. Cap is 0.2 feet below ground encased in a 6" PVC pipe
 [that extends 6" above ground. A 2" x 4" Witness Post is 1 foot from the
 [bench mark.]

Monument ID: [01637] Surveyor: [USKH]
 Book-Page: [0- 0] LS Number: []
 Recvy Date: [/ /] Monument Name: [GW 19]
 Maint Date: [/ /] Monument Cond: []
 Grids: [4816] Status Code: [V] (C,G,V)
 Township: T 0N, R 0, SM Sec 0 Type Code:[18] 1/2" Anchor bolt
 Subdivision: [] Corner:[]
 S.I. Locate: [] Legal:[]
 Dig X Coord: [0] SP X Coord: [] 3 Order, 0 Class
 Dig Y Coord: [0] SP Y Coord: []
 SP Z Coord: [264.48] Datum: 1972 Adjustment
 GPS Code: [] Inertial Code: [] Photo Code: []
 Proj. Name: []

Comments or Markings:

Description:
 [Beginning at the intersection of the Seward Hwy. and Alyeska Hwy.; thence
 [northerly approximately 3 miles to the end of the Alyeska Hwy. where it
 ["tees" with Arlberg Ave.; thence south 182 feet; thence east 188 feet to
 [the southwest corner of the concrete "DAY LODGE" building at Alyeska Resort]
 [Bench mark is on the south face, 0.2 feet north of the southwest corner
 [0.2 feet above the ground.
 [Bench mark is a 4" x 1/2" stainless steel all-thread set horizontally 2 5/8"
 [deep into the concrete wall. Bench mark has a 2" dia. stainless steel
 [washer with I.D. stamped on it and a 3/4" nut. Use top of threads for
 [elevation.]

GD-10

MITS V2.2
 Monument ID: [01638] Surveyor: [USKH]
 Book-Page: [0- 0] LS Number: []
 Recvy Date: [/ /] Monument Name: [GW 20]
 Maint Date: [/ /] Monument Cond: []
 Grids: [4817] Status Code: [V] (C,G,V)
 Township: T 0N, R 0, SM Sec 0 Type Code:[18] 1/2" Anchor bolt
 Subdivision: [] Corner:[]
 S.I. Locate: [] Legal:[]
 Dig X Coord: [0] SP X Coord: [] 3 Order, 0 Class
 Dig Y Coord: [0] SP Y Coord: []
 SP Z Coord: [295.27] Datum: 1972 Adjustment
 GPS Code: [] Inertial Code: [] Photo Code: []
 Proj. Name: []

Comments or Markings:

Description:

[Beginning at the intersection of Seward Hwy. and Alyeska Ave.; thence
 [northerly approximately 3 miles to end of the Alyeska Hwy. where it "Tees"
 [with Arlburg Ave., thence north on Arlburg Ave. 367 feet to the entrance
 [to the Alyeska Resort; thence east 741 feet to the northwest corner of the
 [Alyeska Resort "NUGGET INN" building at 100 Olympic Circle. The bench mark
 [is on the north wall 0.1 feet east of the northwest corner and 1.1 feet
 [above ground.
 [Bench mark is a 4" x 1/2" stainless steel all-thread set horizontally 2"
 [deep in the wall. A 2" dia. stainless steel washed with I.D. stamped on it
 [Use top of threads for elevation.

MITS V2.2
 Monument ID: [01639] Surveyor: [USKH]
 Book-Page: [0- 0] LS Number: []
 Recvy Date: [/ /] Monument Name: [GW 21]
 Maint Date: [/ /] Monument Cond: []
 Grids: [4816] Status Code: [V] (C,G,V)
 Township: T 0N, R 0, SM Sec 0 Type Code:[18] 1/2" Anchor bolt
 Subdivision: [] Corner:[]
 S.I. Locate: [] Legal:[]
 Dig X Coord: [0] SP X Coord: [] 3 Order, 0 Class
 Dig Y Coord: [0] SP Y Coord: []
 SP Z Coord: [236.11] Datum: 1972 Adjustment
 GPS Code: [] Inertial Code: [] Photo Code: []
 Proj. Name: []

Comments or Markings:

Description:

[Beginning at the intersection of the Seward Hwy. and Alyeska Hwy.; thence
 [northerly approximately 3 miles to the end of Alyeska Hwy. where it "Tees"
 [at Arlburg Ave.; thence north along Arlburg Ave. 497 feet to the north
 [entrance to Olympic Circle; thence east on Olympic Circle 133 feet to a
 [bridge over the creek. Bench mark is 17 feet south of the centerline of
 [North Olympic Circle on the north face of the west concrete bridge abutment
 [1.7 feet above ground, 0.2 feet east of the west end. Bench mark is a 3 1/2"
 [stainless steel anchor bolt set horizontally 2 3/8" deep. A 2" dia. stain-
 [less steel washer with I.D. stamped on it and 3/4" nut are on the bolt.
 [Use top of threads for elevation.

Monument ID: [01640] Surveyor: [USKH]
 Book-Page: [0- 0] LS Number: []
 Recvy Date: [/ /] Monument Name: [GW 22]
 Maint Date: [/ /] Monument Cond: []
 Grids: [4617] Status Code: [V] (C,G,V)
 Township: T 0N, R 0, SM Sec 0 Type Code:[18] 1/2" Anchor bolt
 Subdivision: [] Corner:[]
 S.I. Locate: [] Legal:[]
 Dig X Coord: [0] SP X Coord: [] 3 Order, 0 Class
 Dig Y Coord: [0] SP Y Coord: []
 SP Z Coord: [249.52] Datum: 1972 Adjustment
 GPS Code: [] Inertial Code: [] Photo Code: []
 Proj. Name: []

Comments or Markings:

Description:
 [Beginning at the intersection of the Seward Hwy. and Alyeska Hwy.; thence
 [northerly approximately 3 miles to the end of Alyeska Hwy. where it "tees"
 [with Arlberg Ave.; thence northerly along Arlberg Ave. 0.93 miles to the
 [south corner of the Alyeska Prince Hotel; thence northwest 14.4 feet to
 [the corner of the decorative concrete on the building's foundation; thence
 [0.2 feet northeast to the bench mark.
 [Bench mark is a 4" x 1/2" stainless steel anchor bolt set horizontally 2 1/2"
 [deep into the concrete 3.0 feet above the ground. Anchor bolt has a 2" dia.
 [stainless steel washer with I.D. stamped on it and 3/4" nut. Use top of
 [threads for elevation.]

Monument ID: [01641] Surveyor: [USKH]
 Book-Page: [0- 0] LS Number: []
 Recvy Date: [/ /] Monument Name: [GW 23]
 Maint Date: [/ /] Monument Cond: []
 Grids: [4617] Status Code: [V] (C,G,V)
 Township: T 0N, R 0, SM Sec 0 Type Code:[18] 1/2" Anchor bolt
 Subdivision: [] Corner:[]
 S.I. Locate: [] Legal:[]
 Dig X Coord: [0] SP X Coord: [] 3 Order, 0 Class
 Dig Y Coord: [0] SP Y Coord: []
 SP Z Coord: [263.52] Datum: 1972 Adjustment
 GPS Code: [] Inertial Code: [] Photo Code: []
 Proj. Name: []

Comments or Markings:

Description:
 [Beginning at the intersection of the Seward Hwy. and Alyeska Hwy.; thence
 [northerly approximately 3 miles to the end of the Alyeska Hwy. at the "Tee"
 [with Arlberg Ave.; thence northeasterly 1.31 miles along Arlberg Ave. to
 [the tram building at the Alyeska Prince Hotel. The bench mark is on the
 [inside corner of tram building, 32.1 feet southeast of the northmost corner
 [and under a large "take up" spool for the tram mounted on the exterior of
 [the building.
 [The bench mark is a 4" x 1/2" stainless steel anchor bolt set horizontally
 [2 1/2" deep into the concrete wall 2.5 feet above ground. A 2" dia. stainless
 [washer with I.D. is on bolt. Use top of threads for elevation.]

GD-12

Monument ID: [01642] Surveyor: [USKH]
 Book-Page: [0- 0] LS Number: []
 Recvy Date: [/ /] Monument Name: [GW 24]
 Maint Date: [/ /] Monument Cond: []
 Grids: [5113] Status Code: [V] (C,G,V)
 Township: T 0N, R 0, SM Sec 0 Type Code:[18] 1/2" Anchor bolt
 Subdivision: [] Corner:[]
 S.I. Locate: [] Legal:[]
 Dig X Coord: [0] SP X Coord: [] 3 Order, 0 Class
 Dig Y Coord: [0] SP Y Coord: []
 SP Z Coord: [30.45] Datum: 1972 Adjustment
 GPS Code: [] Inertial Code: [] Photo Code: []
 Proj. Name: []

Comments or Markings:

Description:

[Beginning at the intersection of the Seward Hwy. and Alyeska Hwy.; thence]
 [southeasterly along the Seward Hwy. approximately 1100 feet to a bridge.]
 [The bench mark is on the northerly face of the bridge. It is 3.4 feet from]
 [the corner of the northwesterly bridge curb, 16' from the centerline of the]
 [Seward Hwy., and S 77° W, 21.5 feet from a vertical culvert water monitor-]
 [ing station. Bench mark is 0.4 feet down from top of bridge.]
 [Bench mark is a 4" x 1/2" stainless steel all-thread set 2 1/2" deep in the]
 [side of bridge. A 2" I.D. stainless steel washer with I.D. stamped on it]
 [and a 3/4" washer are on the all-thread. Use top of threads for elevation.]

GD-13

Monument ID: [01647] Surveyor: [USC & GS]]
 Book-Page: [0- 0] LS Number: []]
 Recvy Date: [/ /] Monument Name: [R 72]]
 Maint Date: [/ /] Monument Cond: []]
 Grids: [5113] Status Code: [V] (C,G,V)
 Township: T 0N, R 0, SM Sec 0 Type Code:[19] Deep Bench
 Subdivision: [] Corner:[]]
 S.I. Locate: [] Legal:[]]
 Dig X Coord: [0] SP X Coord: [] 3 Order, 0 Class
 Dig Y Coord: [0] SP Y Coord: []]
 SP Z Coord: [24.17] Datum: 1972 Adjustment
 GPS Code: [] Inertial Code: [] Photo Code: []]
 Proj. Name: []]

Comments or Markings:

Description:

[9.9 miles northwest along the Alaska Railroad from the microwave building]
 [at Portage, 0.25 mile east of the station at Girdwood, 113 feet northeast]
 [of a power pole, 73 feet southwest of the center of a gravel road crossing]
 [68 feet west of the center of a graveled road, 28 feet south of the rail,]
 [17.5 feet west of siding sign GIRDWOOD and 1.5 feet north of a metal wit-]
 [ness post. A standard USC&GS disk clamped to a Copperweld encased in 5"]
 [case iron pipe that projects 7 inches.]
 []
 []
 []

Monument ID: [01648] Surveyor: [USC & GS]]
 Book-Page: [0- 0] LS Number: []]
 Recvy Date: [/ /] Monument Name: [S 72]]
 Maint Date: [/ /] Monument Cond: []]
 Grids: [5011] Status Code: [V] (C,G,V)
 Township: T 0N, R 0, SM Sec 0 Type Code:[19] Deep Bench
 Subdivision: [] Corner:[]]
 S.I. Locate: [] Legal:[]]
 Dig X Coord: [0] SP X Coord: [] 3 Order, 0 Class
 Dig Y Coord: [0] SP Y Coord: []]
 SP Z Coord: [17.61] Datum: 1972 Adjustment
 GPS Code: [] Inertial Code: [] Photo Code: []]
 Proj. Name: []]

Comments or Markings:

[ELEVATION BY USKH THE USC&GS 1972 ELEVATION WAS 17.956]

Description:

[10.9 miles northwest along the Alaska Railroad from the microwave station]
 [building at Portage, 192 feet southwest of the center of the crossing of]
 [the Seward Hwy., 62 feet southeast of the centerline of the highway, 19]
 [feet northwest of the northwest rail, 2.0 feet north of a metal witness]
 [post, about 8 feet lower than the track. The bench mark is a standard]
 [USC&GS brass cap clamped on 20 feet of 5/8" Copperweld, encased in 5" cast]
 [iron which projects 4".]
 []
 []
 []

GD-14