

VICINITY MAP
ANCHORAGE, ALASKA



Know what's **below**.
Call before you dig.



UNOFFICIAL
GRAPHIC SCALE
0 1/4 1/2 MILE

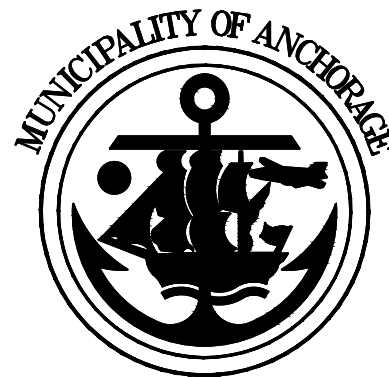

ANCHORAGE
PARK
FOUNDATION



KIWANIS FISH CREEK PARK 2013 TENNIS COURT IMPROVEMENTS

3611 TURNAGAIN BLVD.
ANCHORAGE, AK 99517

GENERAL NOTES:

1. CONSTRUCTION SHALL BE COMPLETED IN ACCORDANCE WITH THE MUNICIPALITY OF ANCHORAGE STANDARD SPECIFICATIONS, STREETS—DRAINAGE—UTILITIES—PARKS, DATED 2009 HEREAFTER REFERRED TO AS M.A.S.S., AND PROJECT SPECIAL PROVISIONS OR UNLESS OTHERWISE NOTED ON THESE PLANS.
2. DRAWING SCALES ON SHEETS WITHIN THESE PLANS MAY VARY AND SHOULD BE NOTED PRIOR TO USE.
3. CONTRACTOR SHALL OBTAIN ALL NECESSARY PERMITS PRIOR TO BEGINNING CONSTRUCTION. THE PERMITS SHALL BE MAINTAINED AT THE JOB SITE.
4. ALL QUANTITIES SHOWN HEREIN ARE APPROXIMATE. IT SHALL BE THE THE CONTRACTORS RESPONSIBILITY TO VERIFY ALL QUANTITIES.
5. THE CONTRACTOR SHALL BE RESPONSIBLE FOR DETERMINING THE EXACT LOCATION OF ALL EXISTING UTILITIES WITHIN THE LIMITS OF CONSTRUCTION, WHETHER OR NOT SAID UTILITIES ARE SHOWN ON THE PLANS. THIS RESPONSIBILITY INCLUDES CONTACTING UTILITY COMPANIES FOR LOCATIONS OR POTHOLING PRIOR TO CONSTRUCTION. ANY DAMAGE TO EXISTING UTILITIES DURING CONSTRUCTION IS THE RESPONSIBILITY OF THE CONTRACTOR.
6. CONTRACTOR SHALL RESTORE DISTURBED PROPERTY TO PRECONSTRUCTION CONDITION(S), UNLESS OTHERWISE DIRECTED BY THE ENGINEER. PAYMENT FOR RESTORING DISTURBED PROPERTY SHALL BE CONSIDERED INCIDENTAL TO THE PROJECT AND NO SEPARATE PAYMENT SHALL BE MADE, UNLESS BID ITEMS ARE PROVIDED.

APPROVED BY:

Daniel A Sullivan

DANIEL A. SULLIVAN
MAYOR

John H. Rader

JOHN RODDA
DIRECTOR PARKS AND RECREATION

SHEET INDEX:

C1 TITLE SHEET
C2 DEMOLITION PLAN
C3 IMPROVEMENT PLAN, SECTION AND DETAIL

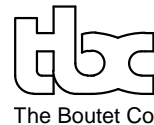

ANCHORAGE PARK FOUNDATION
Healthy Parks, Healthy People



KIWANIS FISH CREEK PARK-TENNIS COURT

3611 TURNAGAIN BLVD
ANCHORAGE, AK 99517

TITLE SHEET

SCALE	HOR. N/A	DATE: 11/19/2012	GRID: SW1727	SHEET	C1 of 3
	VER. N/A	STATUS			

SITE IMPROVEMENTS:

- S-1
- SWPPP – IF NECESSARY, OBTAIN AND MANAGE TYPE 1 SWPPP (13,000 SF DISTURBANCE).
- D-1
- REMOVE EXISTING SIGNAGE – REMOVE AND DISPOSE ALL EXISTING TENNIS COURT RELATED SIGNS.
- D-2
- REMOVE EXISTING NETS AND NET POSTS – REMOVE AND DISPOSE NETS, NET POSTS AND ASSOCIATED P.C.C. FOOTINGS.
- D-3
- REMOVE EXISTING PAVEMENT – SAWCUT, DEMO AND DISPOSE (±13,000 SQUARE FEET) EXISTING ASPHALT PAVEMENT. SAWCUT SHALL REFLECT MINIMUM DISTANCE FROM FENCE LINE NECESSARY TO AVOID DISTURBANCE OF EXISTING CHAIN LINK FENCE, FENCE POSTS AND FOOTINGS.

LEGEND

- PROPERTY LINE
- EXISTING ASPHALT PAVEMENT TO REMAIN UNDISTURBED
- EXISTING CHAIN LINK FENCE TO REMAIN UNDISTURBED
- EXISTING ASPHALT PAVEMENT TO BE REMOVED (ITEM D-2 OF SITE IMPROVEMENTS)
- PROPOSED ASPHALT PAVEMENT (ITEM I-2 OF SITE IMPROVEMENTS)
- GRADE BREAK
- PROPOSED NOVACRYLIC SURFACE SYSTEM U.S. OPEN-GREEN COLOR SCHEME (ITEM I-3 OF SITE IMPROVEMENTS)
- PROPOSED NOVACRYLIC SURFACE SYSTEM U.S. OPEN-BLUE COLOR SCHEME (ITEM I-3 OF SITE IMPROVEMENTS)
- PROPOSED NOVATEX TENNIS COURT STRIPE U.S. TENNIS 2-INCH WIDE WHITE LINE PAINT (ITEM I-4 OF SITE IMPROVEMENTS)
- PROPOSED NOVATEX TENNIS COURT STRIPE U.S. TENNIS 2-INCH WIDE YELLOW LINE PAINT (ITEM I-4 OF SITE IMPROVEMENTS)

DEMOLITION PLAN

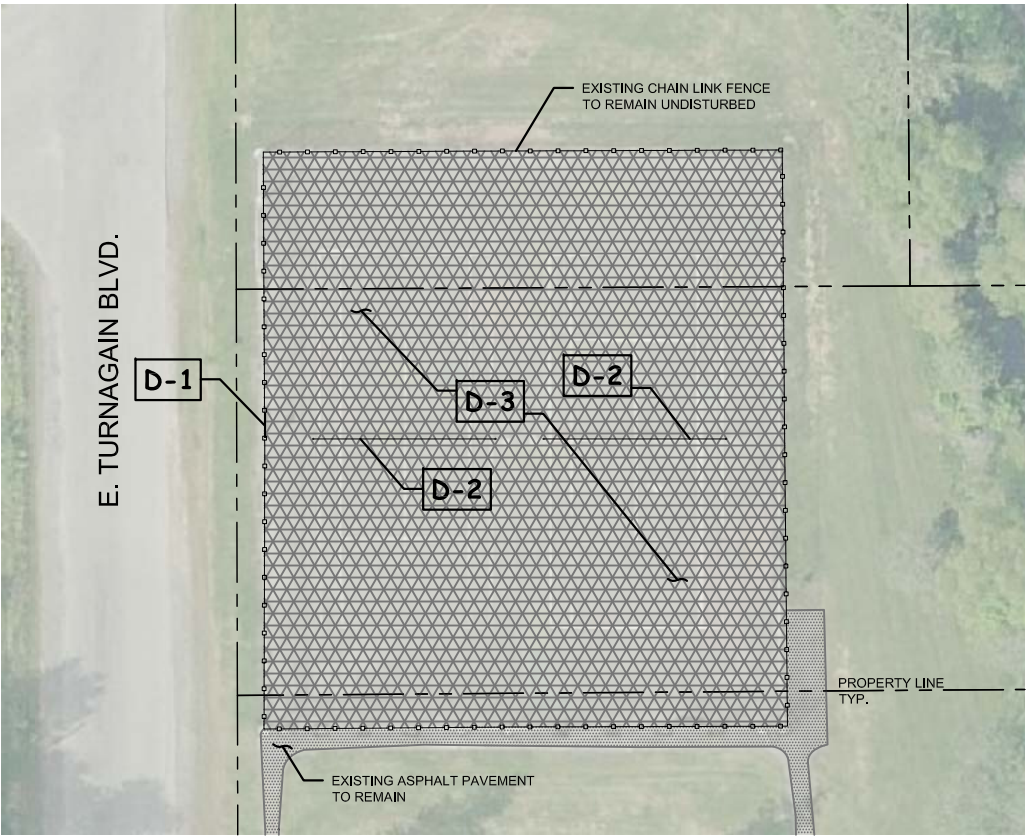
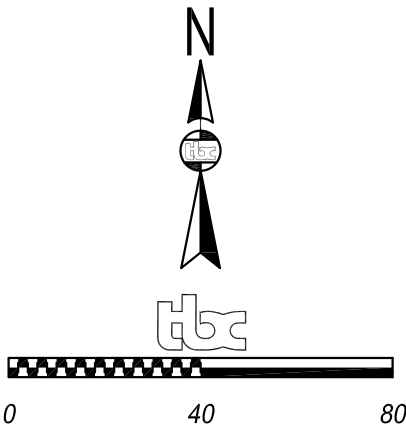

ANCHORAGE PARK FOUNDATION
Healthy Parks, Healthy People



KIWANIS FISH CREEK PARK-TENNIS COURT			
3611 TURNAGAIN BLVD ANCHORAGE, AK 99517			
DEMOLITION PLAN			
SCALE	HOR. 1"=40' VER. N/A	DATE: 11/19/2012 STATUS	GRID: SW1727 SHEET C2 of 3

SCALE	HOR. VARIES	DATE: 12/11/2012	GRID: SW1727	SHEET	C3 of 3
	VER. N/A	STATUS			