



Perspective 1



Perspective 2



ID Sculpture

591 South Boulevard
Gunnison, CO 81230
www.IDSculpture.com
970.641.1747

Kincaid Park

Anchorage
Alaska

100% CD

Schematic rendering to
represent intent

All IDS projects are designed to meet or exceed ASTM 1487-11. Not all equipment may be appropriate for all children. Supervision is required. ASTM compliant safety surfacing is required under and around all play equipment. The Americans with Disabilities Act (ADA) may require your play area to be accesible, please consult with an ADA professional to ensure compliance.

Date:

5/27/16

Drawing Title:

Perspectives

Sheet #:

A.01.1

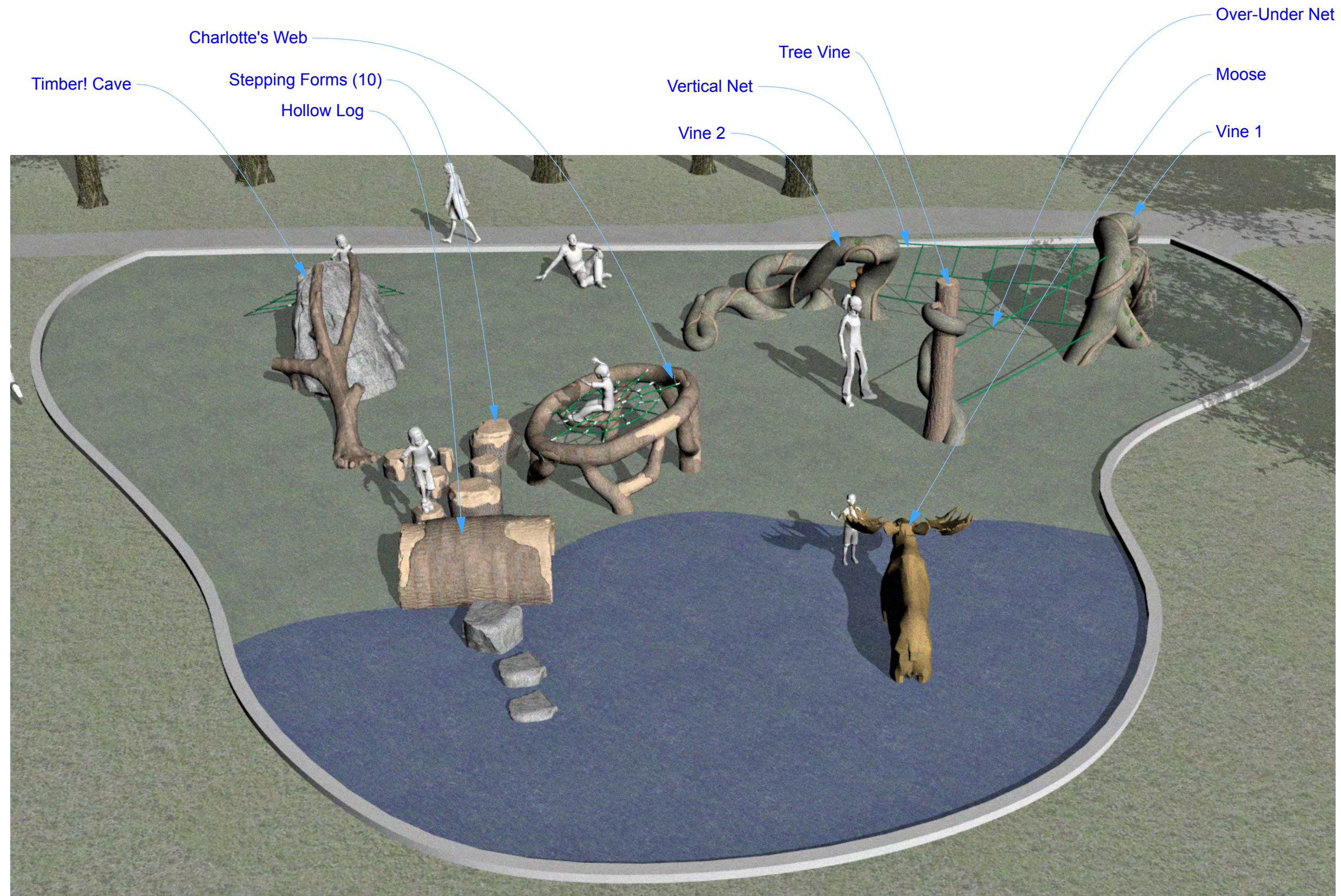

Layout

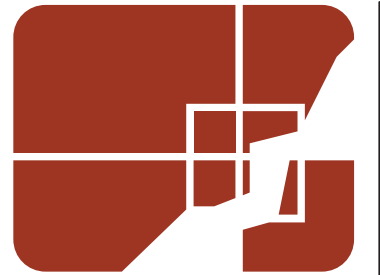

591 South Boulevard
Gunnison, CO 81230
www.IDSculpture.com
970.641.1747

Kincaid Park

Anchorage
Alaska

100% CD

Schematic rendering to
represent intent

All IDS projects are designed to meet
or exceed ASTM 1487-11.

Not all equipment may be appropriate
for all children.

Supervision is required.

ASTM compliant safety surfacing is
required under and around all play
equipment.

The Americans with Disabilities Act
(ADA) may require your play area to
be accessible, please consult with an
ADA professional to ensure
compliance.

Date:

5/27/16

Drawing Title:

Perspective

Sheet #:

A.01.2

Moose - 1,350 lbs

Vine 1 - 5,000 lbs

Vine 2 (a) - 3,800 lbs

Vine 2 (b) - 2,200 lbs

Tree Vine - 1,000 lbs

Charlotte's Web - 2,500 lbs

Timber! Cave - 8,000 lbs

Hollow log - 2,600 lbs

Stepping Forms - 200-600 lbs

Typical concrete pier
Fiber reinforced concrete pier
2500 psi, By Others

Tree Vine:
24" reinforced concrete slab

Vine 1:
1' reinforced concrete slab

Vine 2:
9 1/2" reinforced concrete slab
approx 3 cubic yards

Moose:
6" reinforced concrete slab

Stepping Forms (10):
12"x30" fiber reinforced concrete pier
Desired height above TPS given

Hollow Log:
4" reinforced concrete slab

Low point of sculpture

Charlotte's Web:
6" reinforced concrete slab

Timber!Cave:
4" integral footing

16"x36" Fiber reinforced concrete pier (3)

Plan Layout

SCALE: $\frac{3}{32}" = 1'-0"$



*All IDS projects are designed to meet or exceed ASTM 1487-11.
Not all equipment may be appropriate for all children.
Supervision is required.
ASTM compliant safety surfacing is required under and around all play equipment.
The Americans with Disabilities Act (ADA) may require your play area to be accessible, please consult with an ADA professional to ensure compliance.*

A.01.3



591 South Boulevard
Gunnison, CO 81230
www.IDSculpture.com
970.641.1747

Kincaid Park

Anchorage
Alaska

100% CD

All IDS projects are designed to meet or exceed ASTM 1487-11. Not all equipment may be appropriate for all children. Supervision is required. ASTM compliant safety surfacing is required under and around all play equipment. The Americans with Disabilities Act (ADA) may require your play area to be accesible, please consult with an ADA professional to ensure compliance.

Date:

5/27/16

Drawing Title:

Hollow Log

Sheet #:

A.01.4

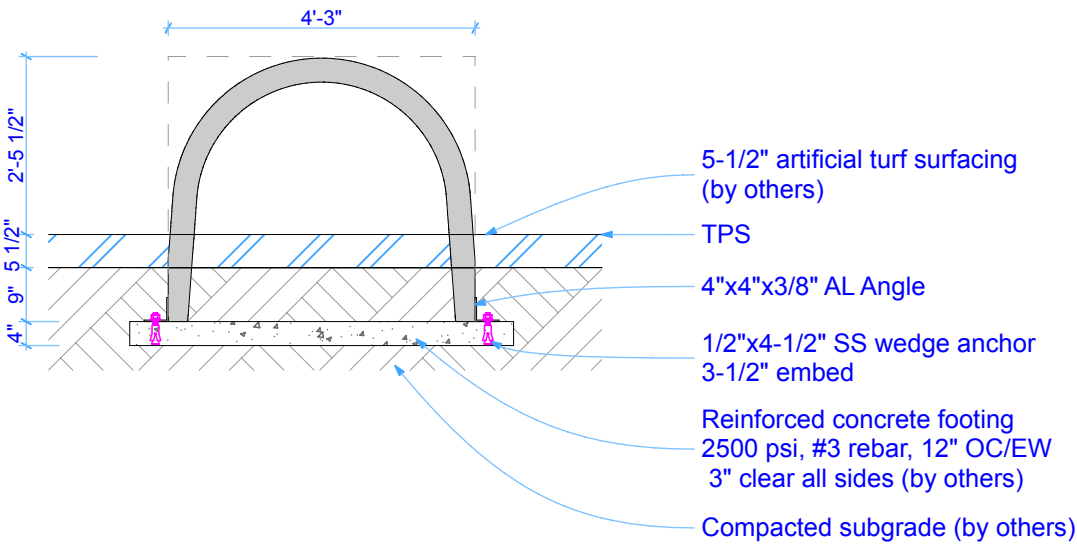
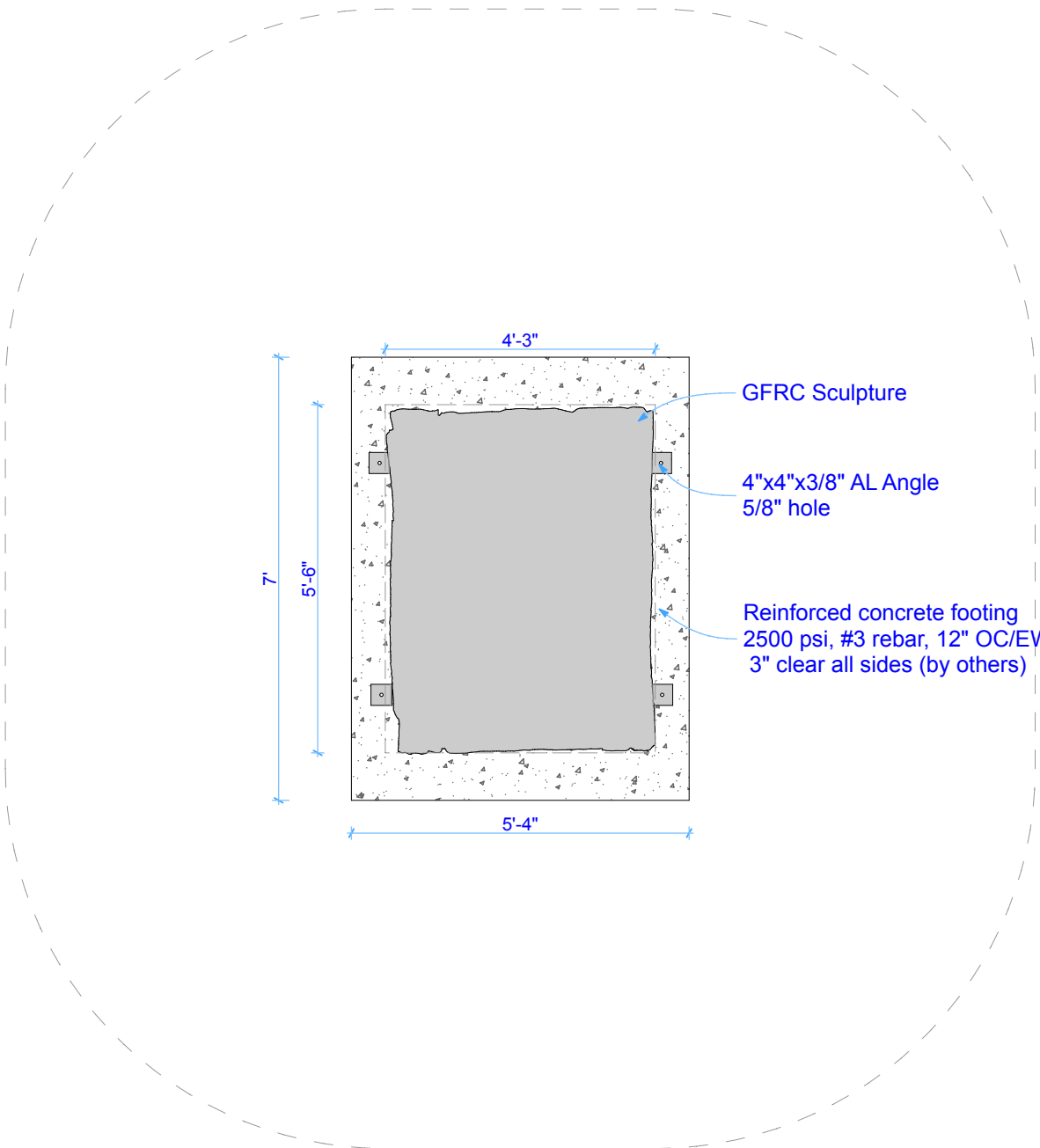

W-02

Hollow Log Plan
SCALE: 3/8" = 1'-0"



W-02

Hollow Log Section
SCALE: 3/8" = 1'-0"



Installation Note: Finished height of stepping forms may be varied by lowering concrete footing.
Installation is wet set.

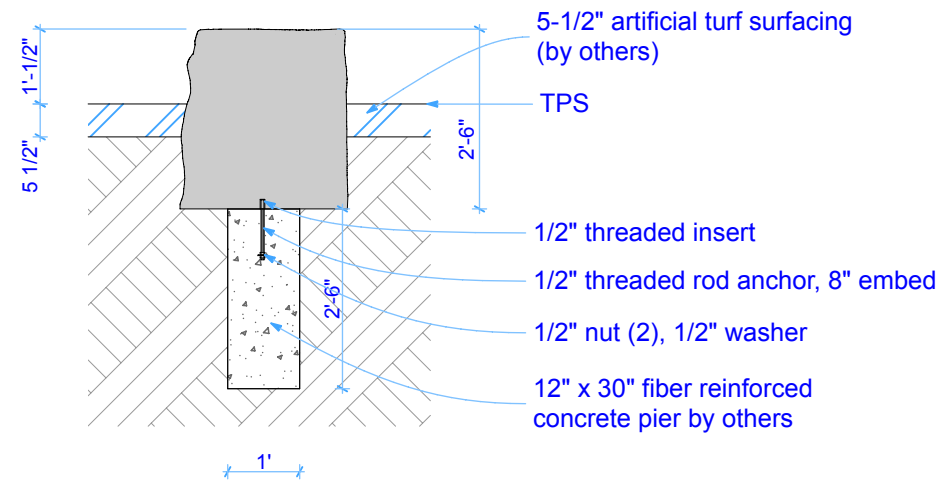

Installation Note: Max Fall Height above TPS:
2-5 year olds: 20"
5-12 year olds: 30"

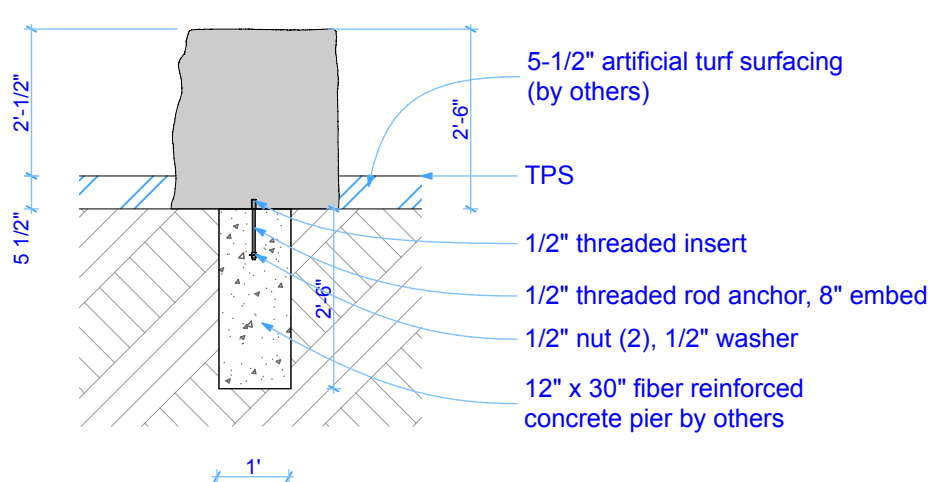

W-05 Stepping Forms Sections
SCALE: 3/8" = 1'-0"

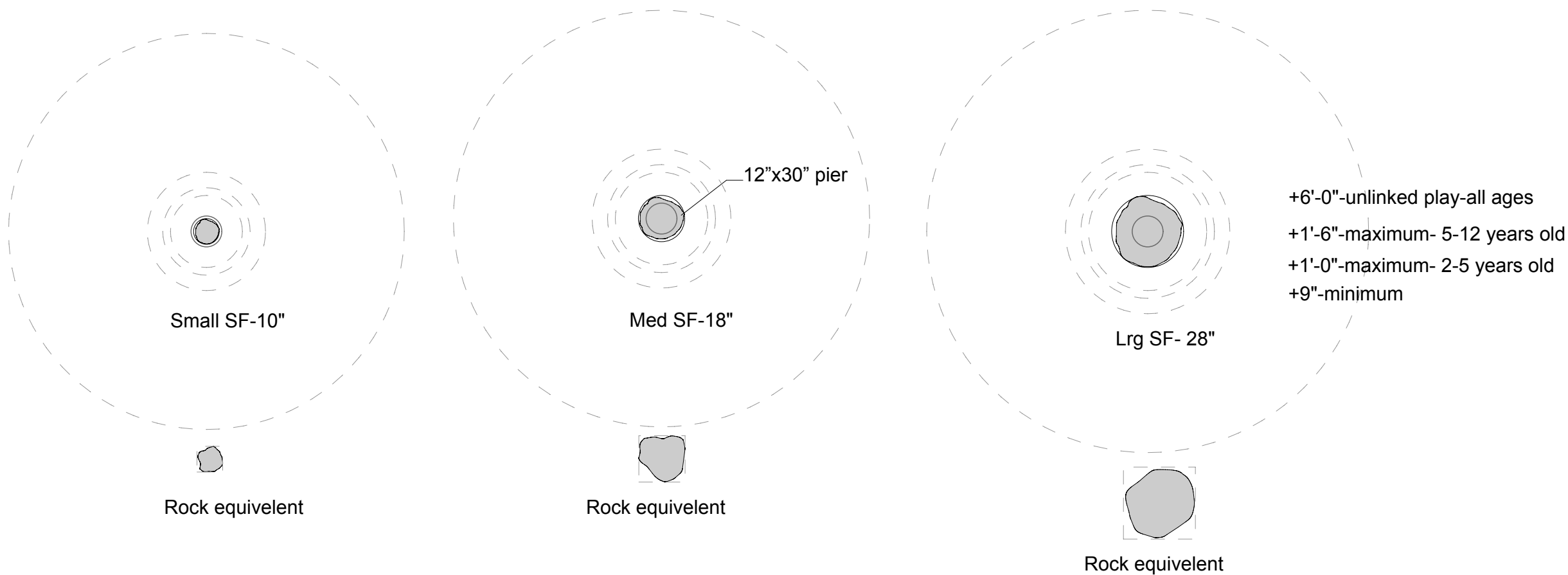

W-05 Stepping Forms Plans
SCALE: 1/4" = 1'-0"



ID Sculpture

591 South Boulevard
Gunnison, CO 81230
www.IDSculpture.com
970.641.1747

Kincaid Park
Anchorage
Alaska

100% CD

All IDS projects are designed to meet or exceed ASTM 1487-11.
Not all equipment may be appropriate for all children.
Supervision is required.
ASTM compliant safety surfacing is required under and around all play equipment.
The Americans with Disabilities Act (ADA) may require your play area to be accesible, please consult with an ADA professional to ensure compliance.

Date:

5/27/16

Drawing Title:

Stepping Forms

Sheet #:

A.01.5

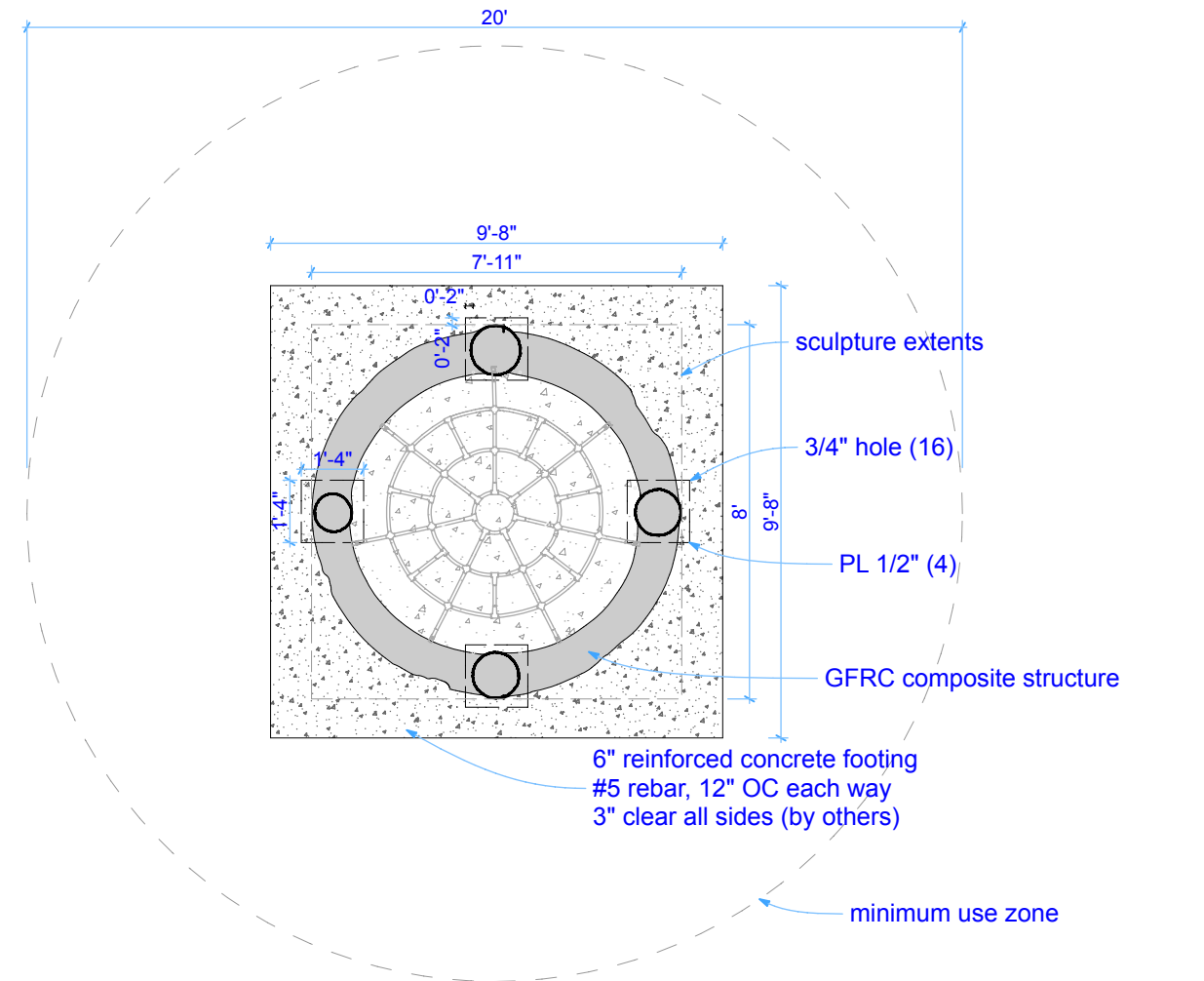

W-03 Charlotte's Web Plan
SCALE: 1/4" = 1'-0"

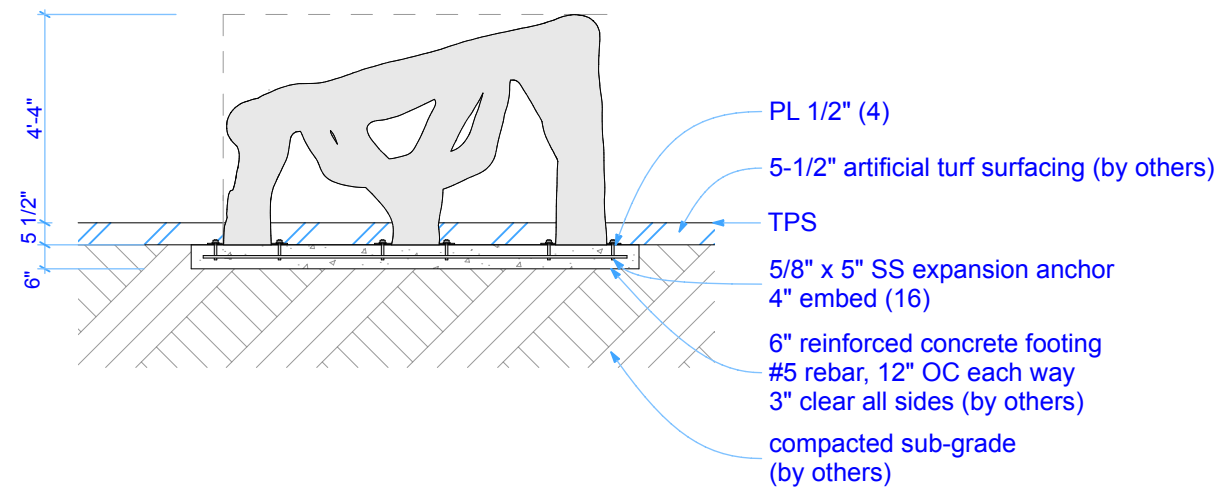

W-03 Charlotte's Web Section
SCALE: 1/4" = 1'-0"

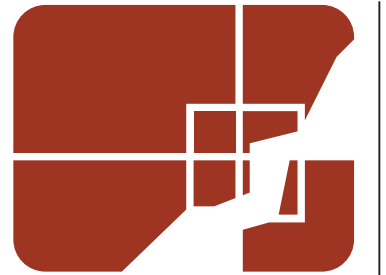

ID Sculpture

591 South Boulevard
Gunnison, CO 81230
www.IDSculpture.com
970.641.1747

Kincaid Park

Anchorage
Alaska

100% CD

All IDS projects are designed to meet or exceed ASTM 1487-11. Not all equipment may be appropriate for all children. Supervision is required. ASTM compliant safety surfacing is required under and around all play equipment. The Americans with Disabilities Act (ADA) may require your play area to be accessible, please consult with an ADA professional to ensure compliance.

Date:

5/27/16

Drawing Title:

Charlotte's Web

Sheet #:

A.01.6

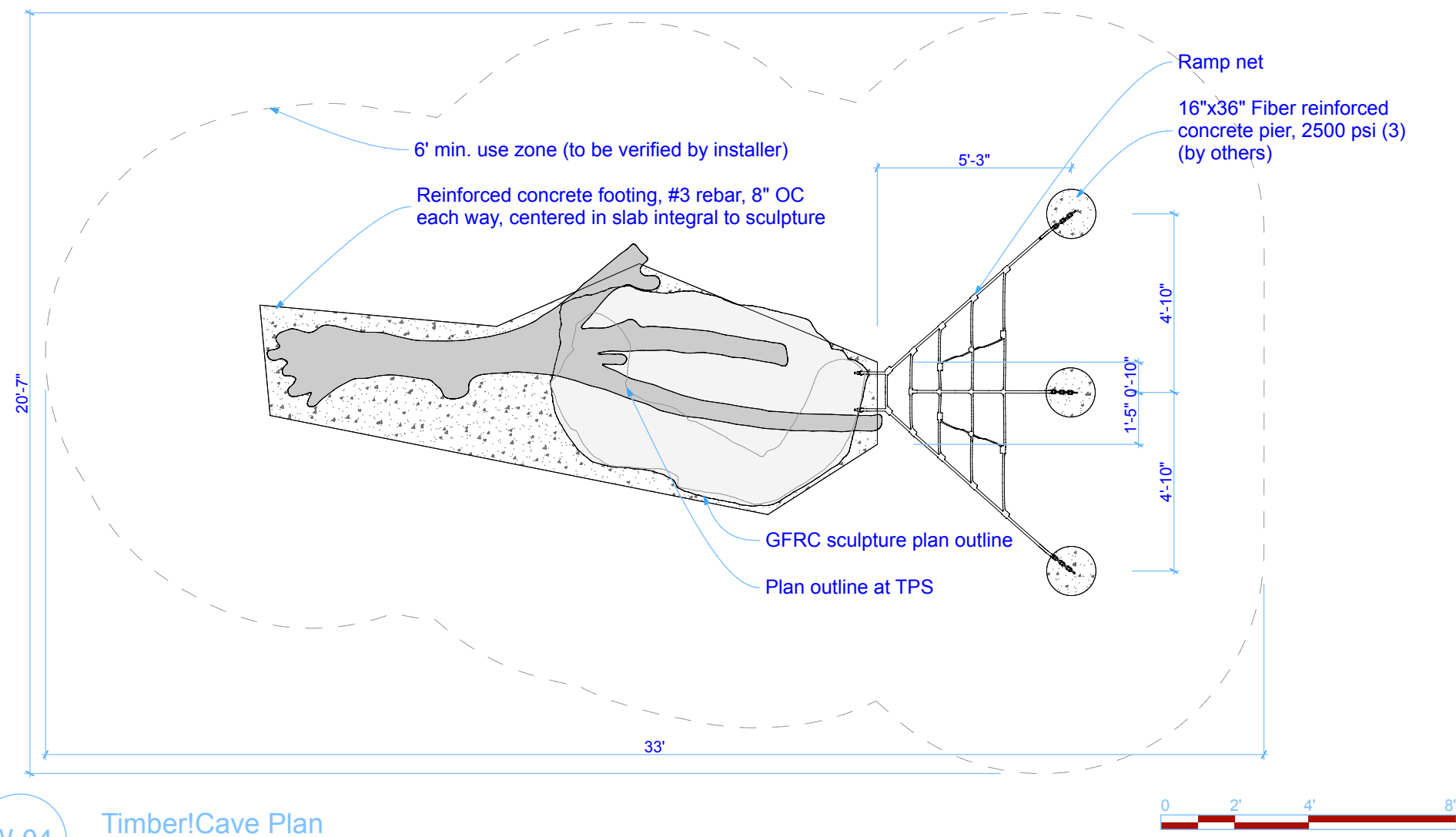

W-04

Timber!Cave Plan
SCALE: 1/4" = 1'-0"

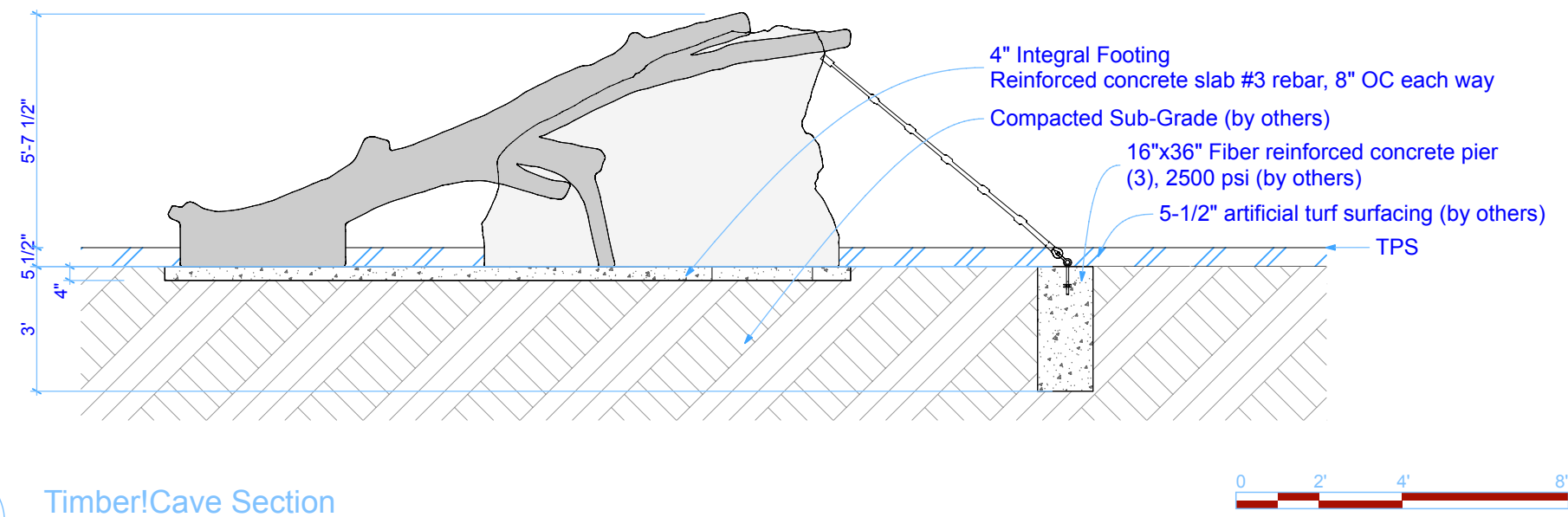

W-04

Timber!Cave Section
SCALE: 1/4" = 1'-0"



591 South Boulevard
Gunnison, CO 81230
www.IDSculpture.com
970.641.1747

Kincaid Park

Anchorage
Alaska

100% CD

All IDS projects are designed to meet or exceed ASTM 1487-11.
Not all equipment may be appropriate for all children.
Supervision is required.
ASTM compliant safety surfacing is required under and around all play equipment.
The Americans with Disabilities Act (ADA) may require your play area to be accessible, please consult with an ADA professional to ensure compliance.

Date:

5/27/16

Drawing Title:

Timber! Cave

Sheet #:

A.01.7

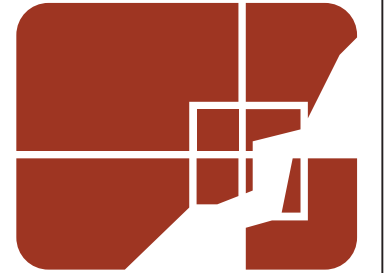
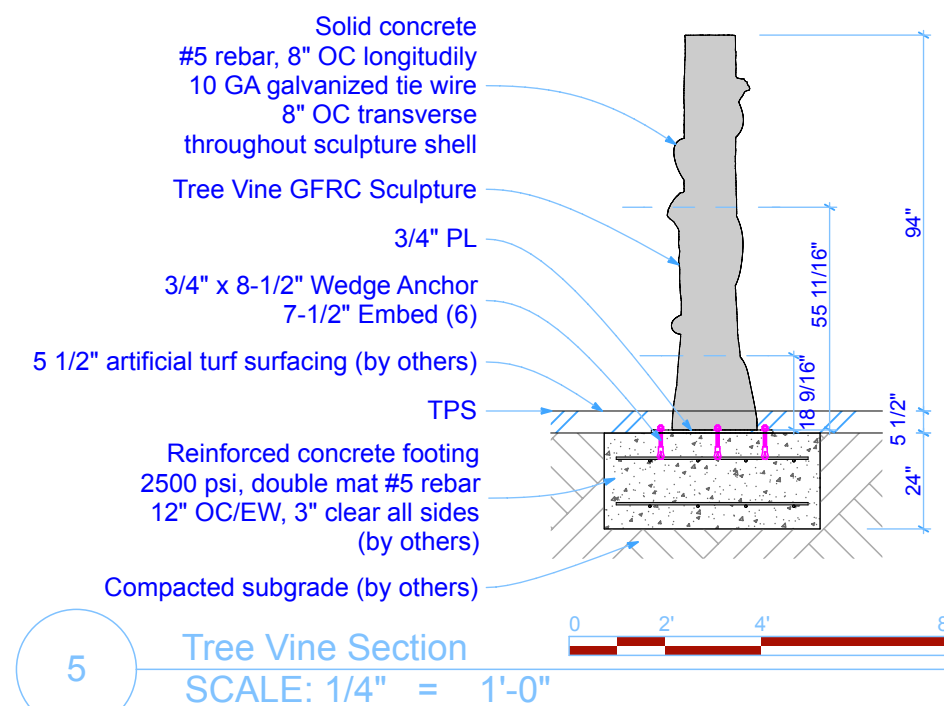
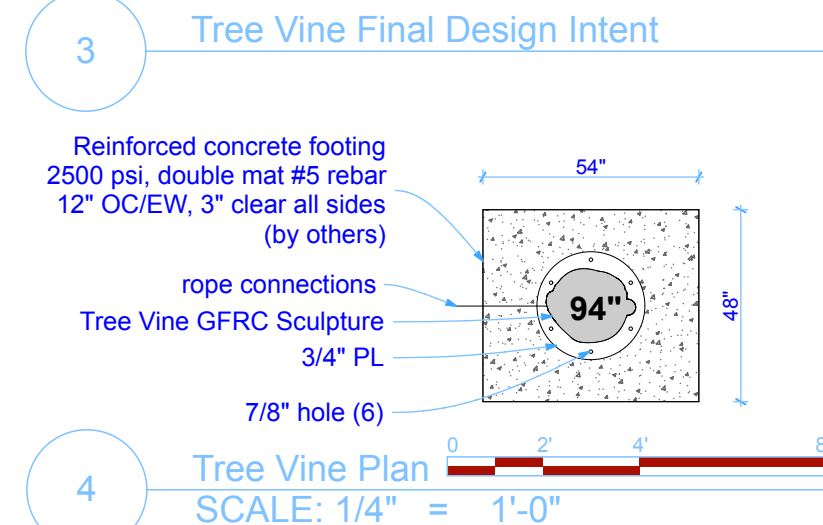
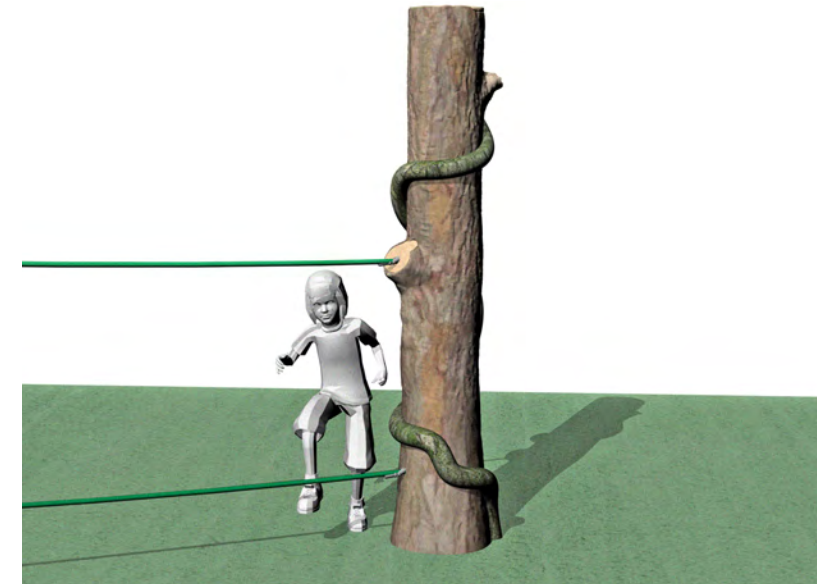
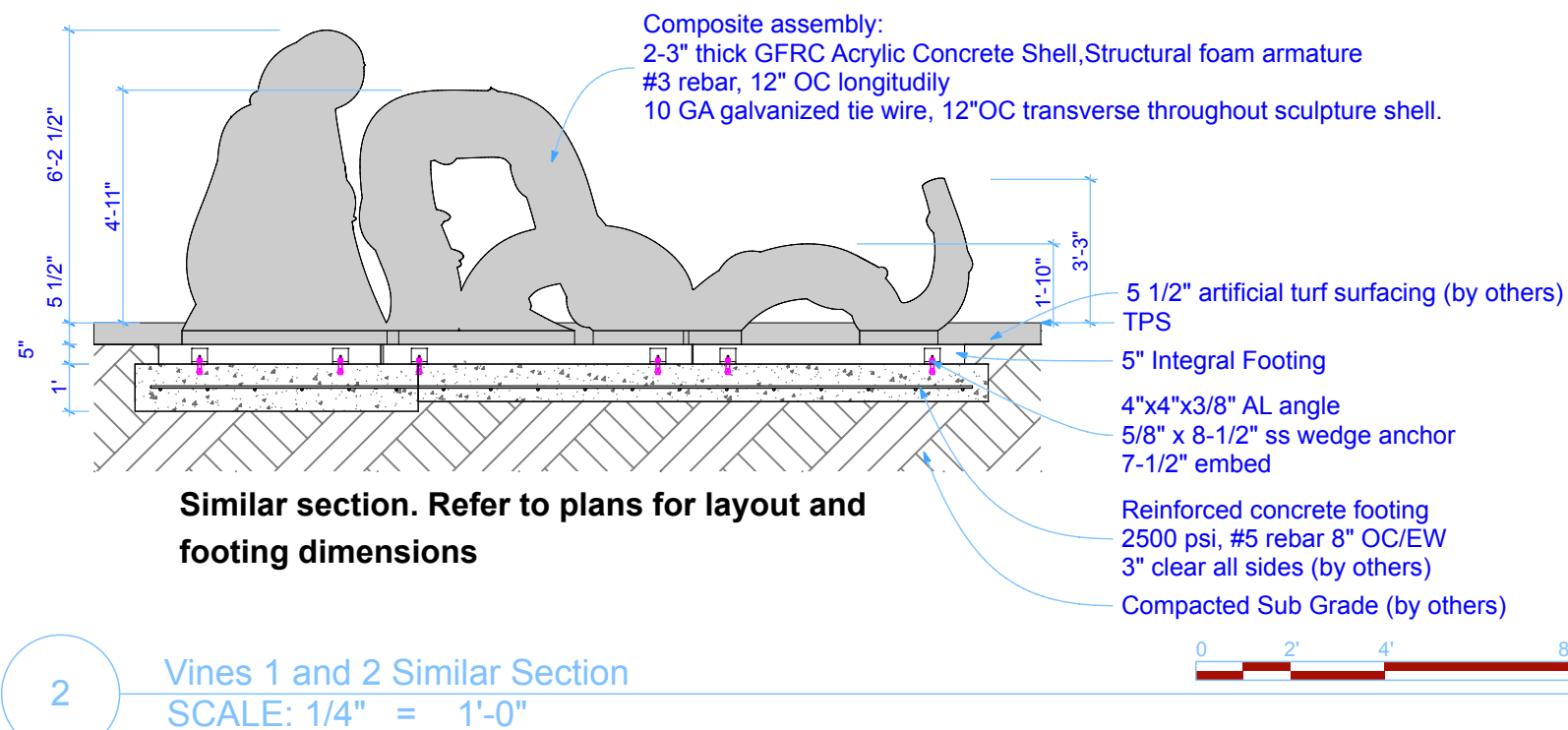
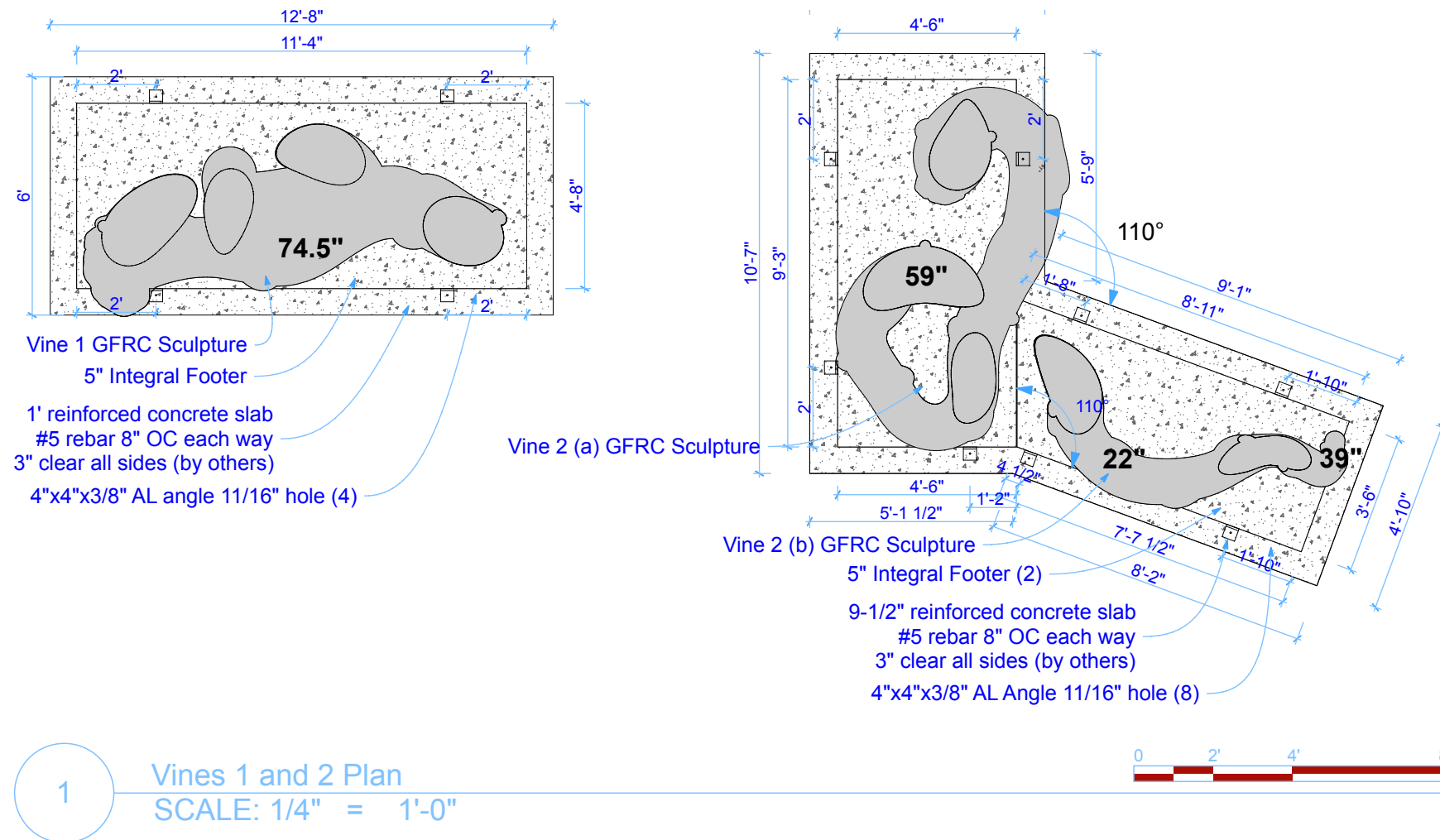

591 South Boulevard
Gunnison, CO 81230
www.IDSculpture.com
970.641.1747

Kincaid Park

Anchorage
Alaska

100% CD

*All IDS projects are designed to meet or exceed ASTM 1487-11.
Not all equipment may be appropriate for all children.
Supervision is required.
ASTM compliant safety surfacing is required under and around all play equipment.
The Americans with Disabilities Act (ADA) may require your play area to be accessible, please consult with an ADA professional to ensure compliance.*

Date: _____

5/27/16

Drawing Title:

Vines

Sheet #:

A.01.8

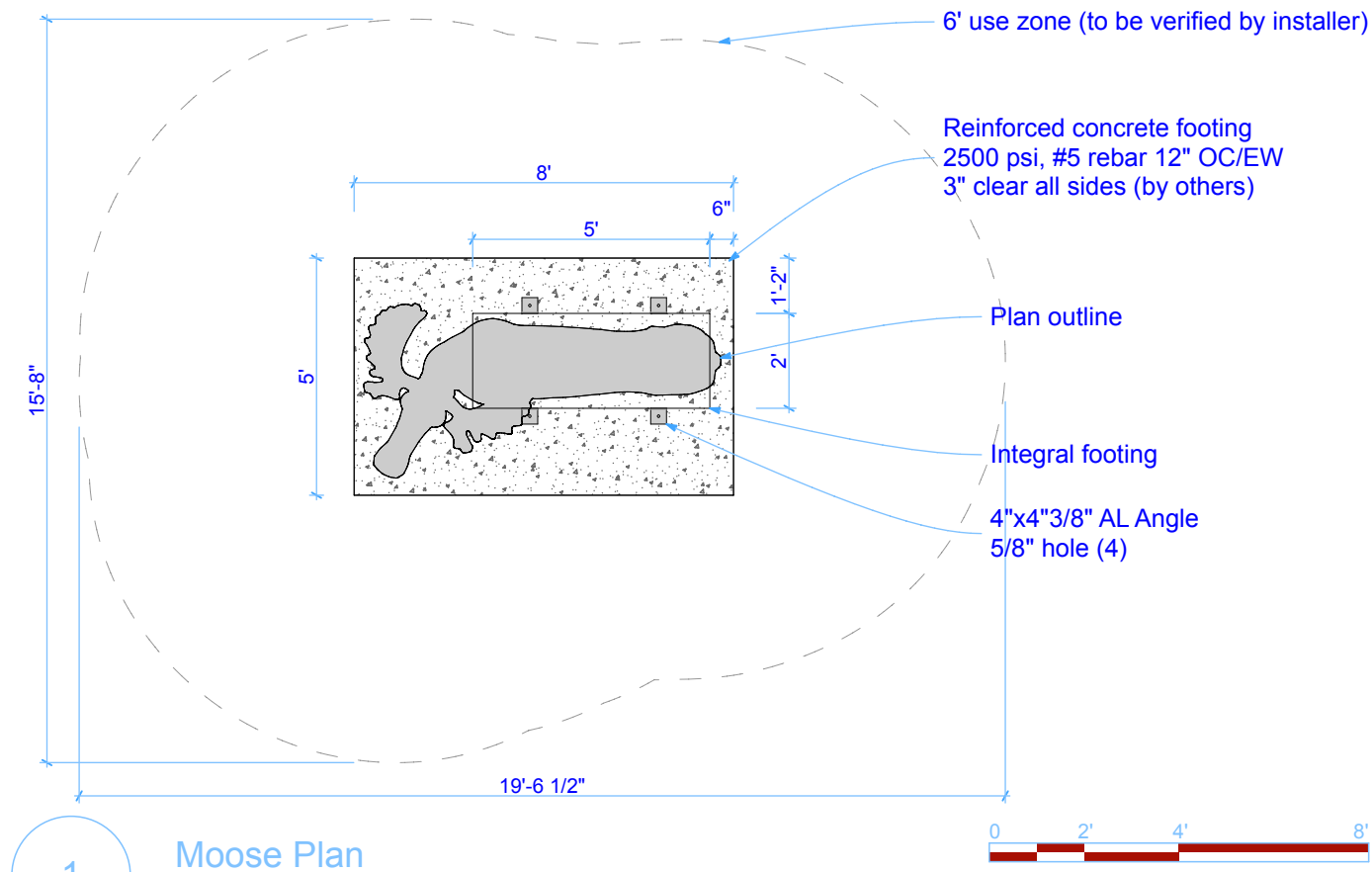

1

Moose Plan
SCALE: 1/4" = 1'-0"

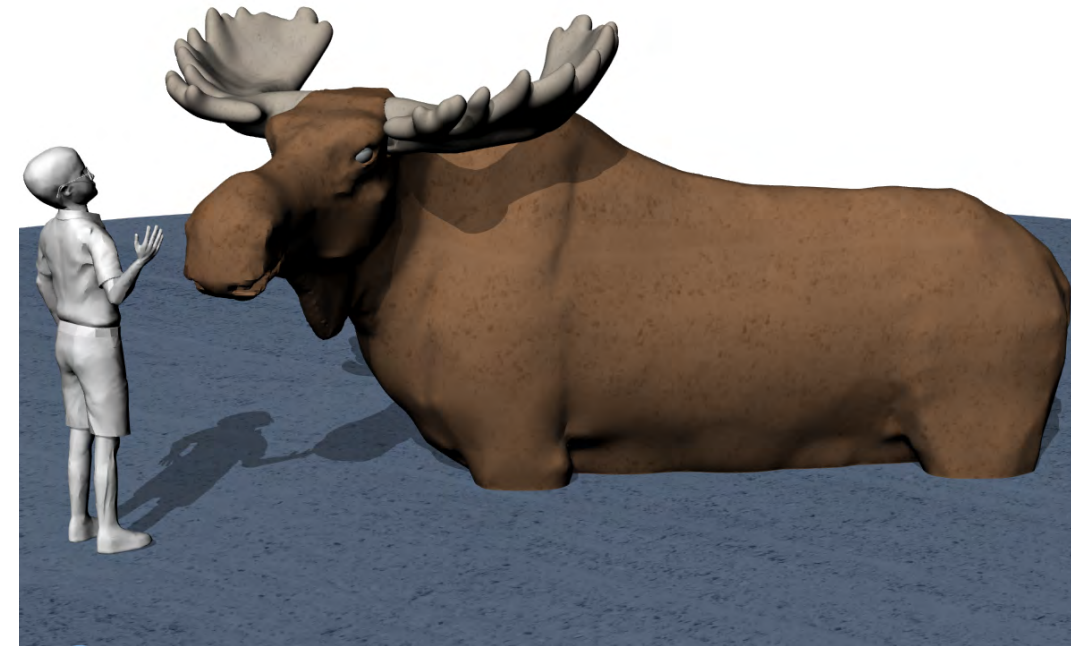

3

Moose Final Design Intent

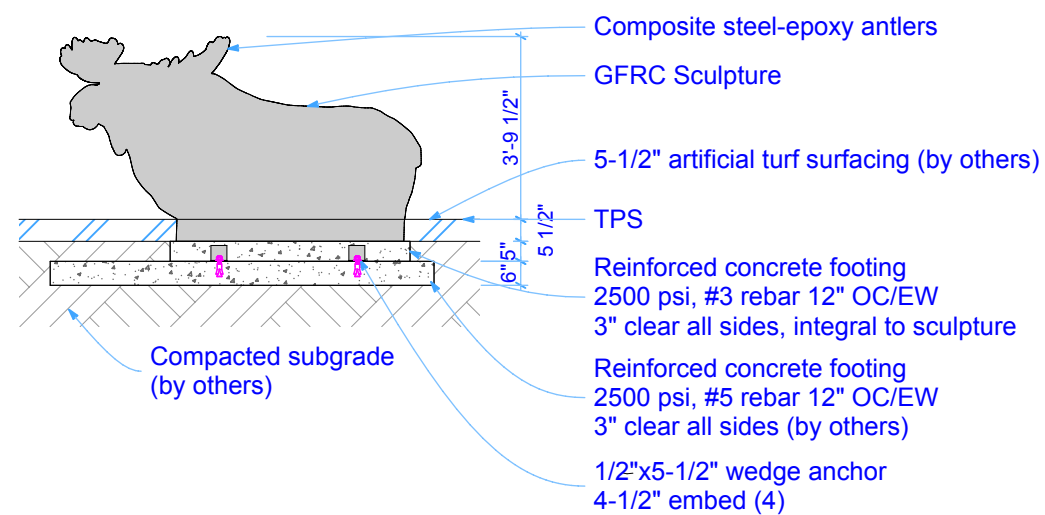

2

Moose Section
SCALE: 1/4" = 1'-0"

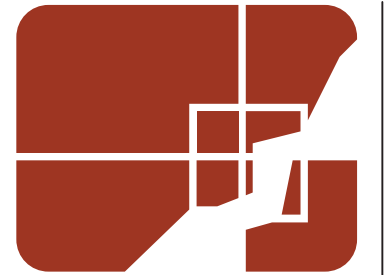

ID Sculpture

591 South Boulevard
Gunnison, CO 81230
www.IDSculpture.com
970.641.1747

Kincaid Park

Anchorage
Alaska

100% CD

All IDS projects are designed to meet or exceed ASTM 1487-11.
Not all equipment may be appropriate for all children.
Supervision is required.
ASTM compliant safety surfacing is required under and around all play equipment.
The Americans with Disabilities Act (ADA) may require your play area to be accessible, please consult with an ADA professional to ensure compliance.

Date:

5/27/16

Drawing Title:

Moose

Sheet #:

A.01.9

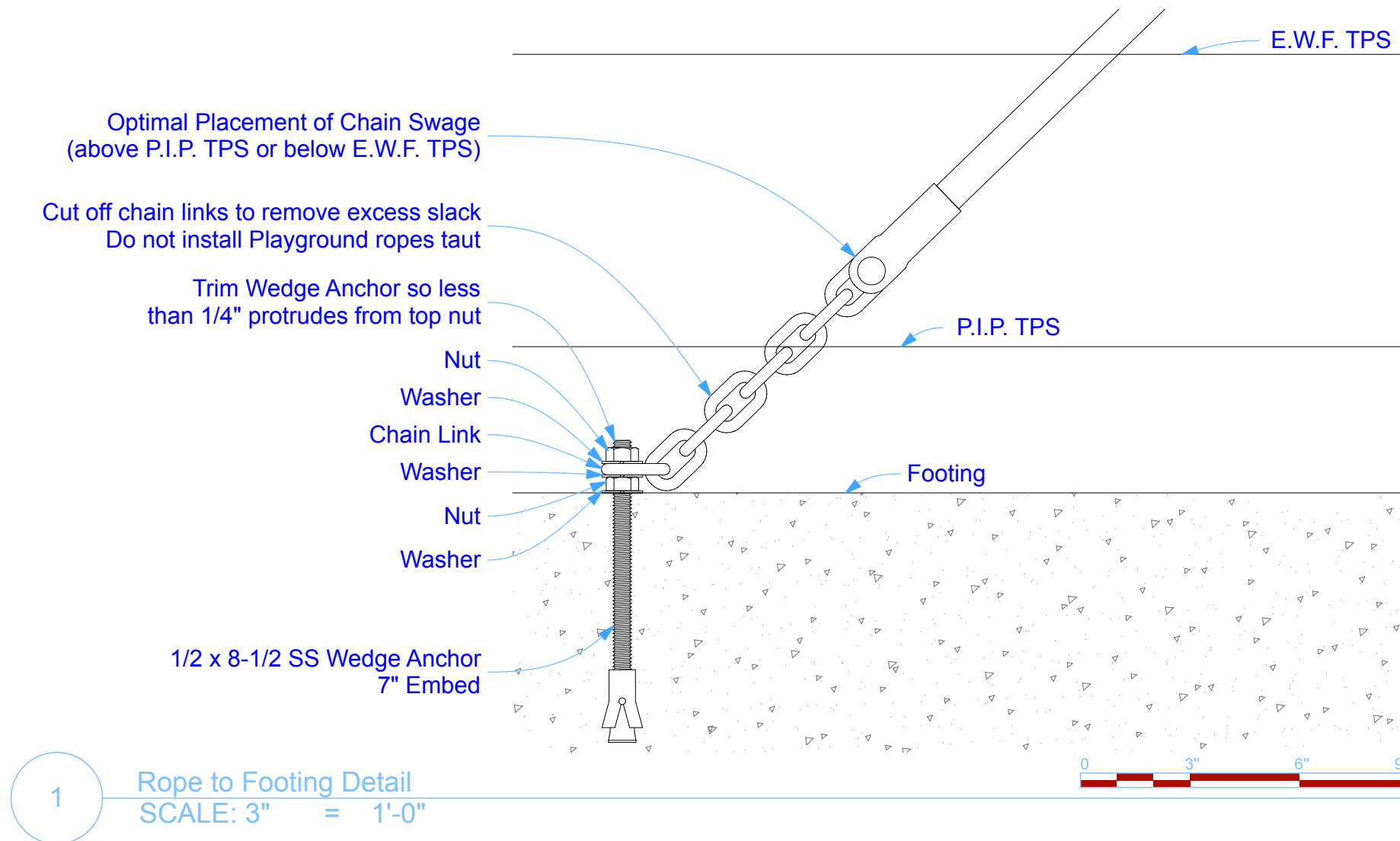

2 Female Threaded Connection



3 Installed Connector



591 South Boulevard
Gunnison, CO 81230
www.IDSculpture.com
970.641.1747

Kincaid Park

Anchorage
Alaska

100% CD

All IDS projects are designed to meet or exceed ASTM 1487-11.
Not all equipment may be appropriate for all children.
Supervision is required.
ASTM compliant safety surfacing is required under and around all play equipment.
The Americans with Disabilities Act (ADA) may require your play area to be accessible, please consult with an ADA professional to ensure compliance.

Date:

5/27/16

Drawing Title:

Rope Connections

Sheet #:

A.01.10