

STEP 5



PLUG IN YOUR CAR

- Plug the timer into the outlet and hang it on the pole or building.
- The dial will now rotate once every 24-hours, allowing electricity to flow for only the interval between the trippers. The "time of day" reading will remain accurate as long as power is not interrupted.
- Check timer by plugging in an outdoor appliance to ensure power is supplied at the correct time. If your extension cord has a lighted plug, the light will be lit only when power is supplied.
- Plug your vehicle's block heater into the bottom of the timer after your last trip of the day.
- Your timer is programmed and ready for the next day.

PLUGAT20.ORG



Municipal Department of Health
and Human Services
Environmental Quality Program

343-4200

This publication, released by the Municipality of Anchorage Department of Health and Human Services, was produced at a cost of \$0.57 per copy by Northern Printing, Anchorage, AK for the purpose of encouraging block heater use to reduce carbon monoxide emissions from vehicles.

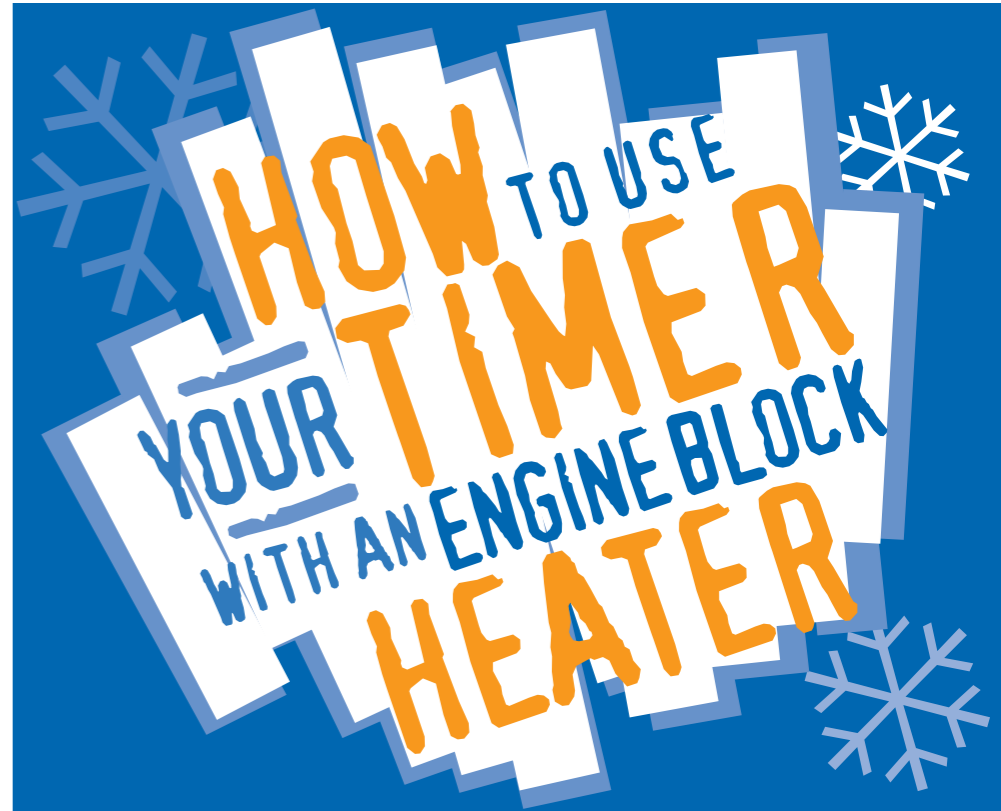

A mechanical timer is a convenient way to save energy when using your engine block heater. Just two hours of engine pre-heating before your daily commute reduces air pollution and engine wear.

STEP 1

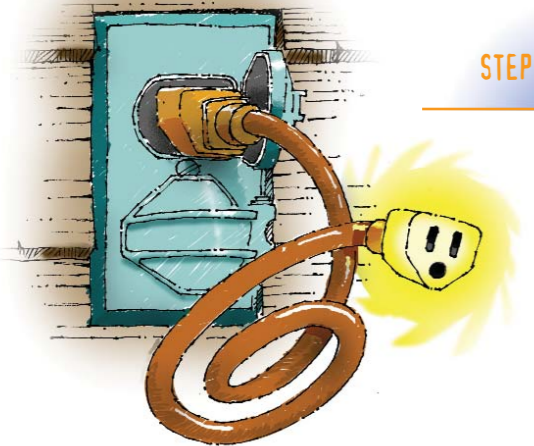

SAFETY FIRST!

Read the safety information on the back of the timer.

Note:

- Timers should only be used with one block heater at a time so their 15-amp capacity is not exceeded.
- Install timers at least 3 feet above ground level to avoid shock hazard.
- See *Outdoor Electrical Safety Check* at PLUGAT20.ORG or call 343-4200 for a copy of the booklet.

USE OUTLETS THAT HAVE CONTINUOUS POWER (I.E. NOT CONTROLLED BY A SWITCH).

Test only with appliance suitable for outdoor use.

STEP 2

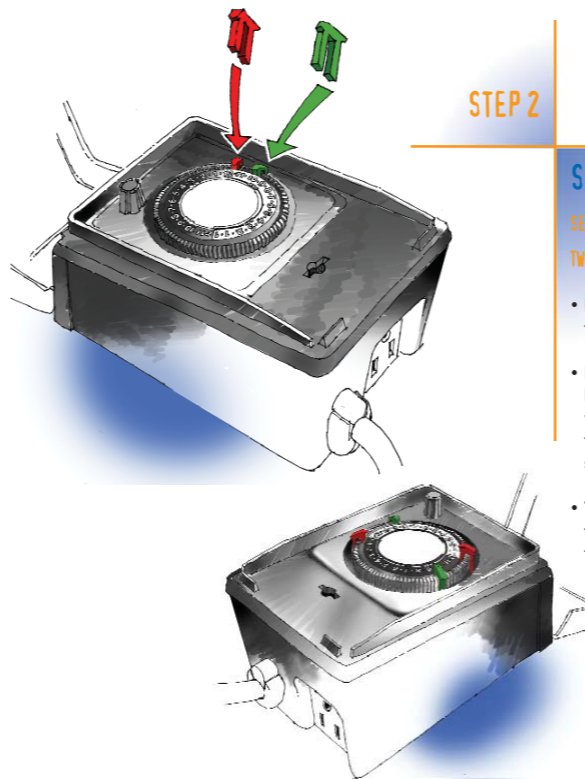

SET THE TIMER

SET THE TIMER TO SUPPLY ELECTRICITY TO THE BLOCK HEATER TWO HOURS BEFORE YOUR CUSTOMARY COMMUTE TIME.

- Pull out the red and green 'trippers' on the timer face.
- Insert green (start) tripper at the time your block heater should turn on. For example, if you usually leave at 7:30 am, insert the green tripper at 5:30 am and insert red tripper to stop the supply of electricity at 7:30 am.
- The second set of trippers may be set for use for another car with a different departure time. Plug second car in as you leave.

STEP 3

MOUNT THE TIMER

Insert a screw or nail at least 3 feet above the ground to hang the timer. The cord from the timer must reach the electrical outlet.



SET THE TIMER TO ACTUAL TIME.

An arrow in the center of the dial points to "time of day". Set for actual time when you plug it in. The am hours have the white background and the pm hours a black background. Turn the dial clockwise (to the right) until it agrees with your watch.

STEP 4

