



Municipality of Anchorage

Development Services Department
On-Site Water and Wastewater Section
4700 Elmore Street
P.O. Box 196650
Anchorage, AK 99519-6650
www.muni.org/onsite
(907) 343-7904



PERMIT REQUIREMENTS FOR A PRIVATE WATER WELL

Permit. An application to drill a new or replacement well shall be submitted to this department by the property owner or their agent prior to commencement of drilling operations for a single family or duplex water well. A permit for a private water well shall not be issued if there is no existing or permitted on-site wastewater disposal system or connection to public sewer service for the property available, scheduled and approved. The permit for a private water well shall be valid for one year from the date of issue.

Application. The application shall be on a form provided by the department. It shall be signed by the property owner or authorized agent attesting that the well will be sited, drilled and completed in accordance with standards and provisions in AMC Chapters 15.55 and 15.65. The applicant shall submit an accurate site plan signed by the property owner or property owner's agent drawn on an 8-1/2 by 11-inch sheet (or larger if necessary) to a scale not smaller than 1 inch to 50 feet. The site plan shall show:

1. Legal description of the lot or parcel;
2. Location of the proposed well;
3. Lot lines, roads, rights-of-way and easements on or adjacent to the lot;
4. Location of all proposed or existing structures on the lot;
5. Measured distance to all existing water supply wells within 50 feet of the proposed well site and the location of all wells within 200 feet of the subject and adjacent properties;
6. All applicable protective well radii; and
7. The location or proposed location of all components listed below and areas containing hazardous waste or other potential pollutants within 150 feet of the proposed well.

The minimum separation requirements between a private water supply well and specified facilities or areas shall be:

<u>SEPARATION OF WELL FROM:</u>	<u>MIN. SEPARATION DISTANCE IN FEET</u>
Curtain drain	25
Petroleum hydrocarbon storage tank	25
Private sewer service line	25
Animal containment areas	50
Advanced wastewater treatment system	50
Public sewer trunk line	75
Sewage holding tank	75
Manure/animal excreta storage areas	100
Septic tank	100
Septic absorption field	100
Public sewer manhole or clean-out	100
Any other source of potential contamination	75

Attention: The well driller shall provide a well log to the On-Site Water & Wastewater Section within 30 days of well completion and the pump installer shall provide a pump installation log to the On-Site Water & Wastewater Section within 30 days of pump installation. Water sample results for total coliform, nitrates and arsenic, as well as a well decommissioning log (if applicable) shall also be submitted to close out the permit.

Well Permit Site Plan Requirements



Scale 1" = 50'

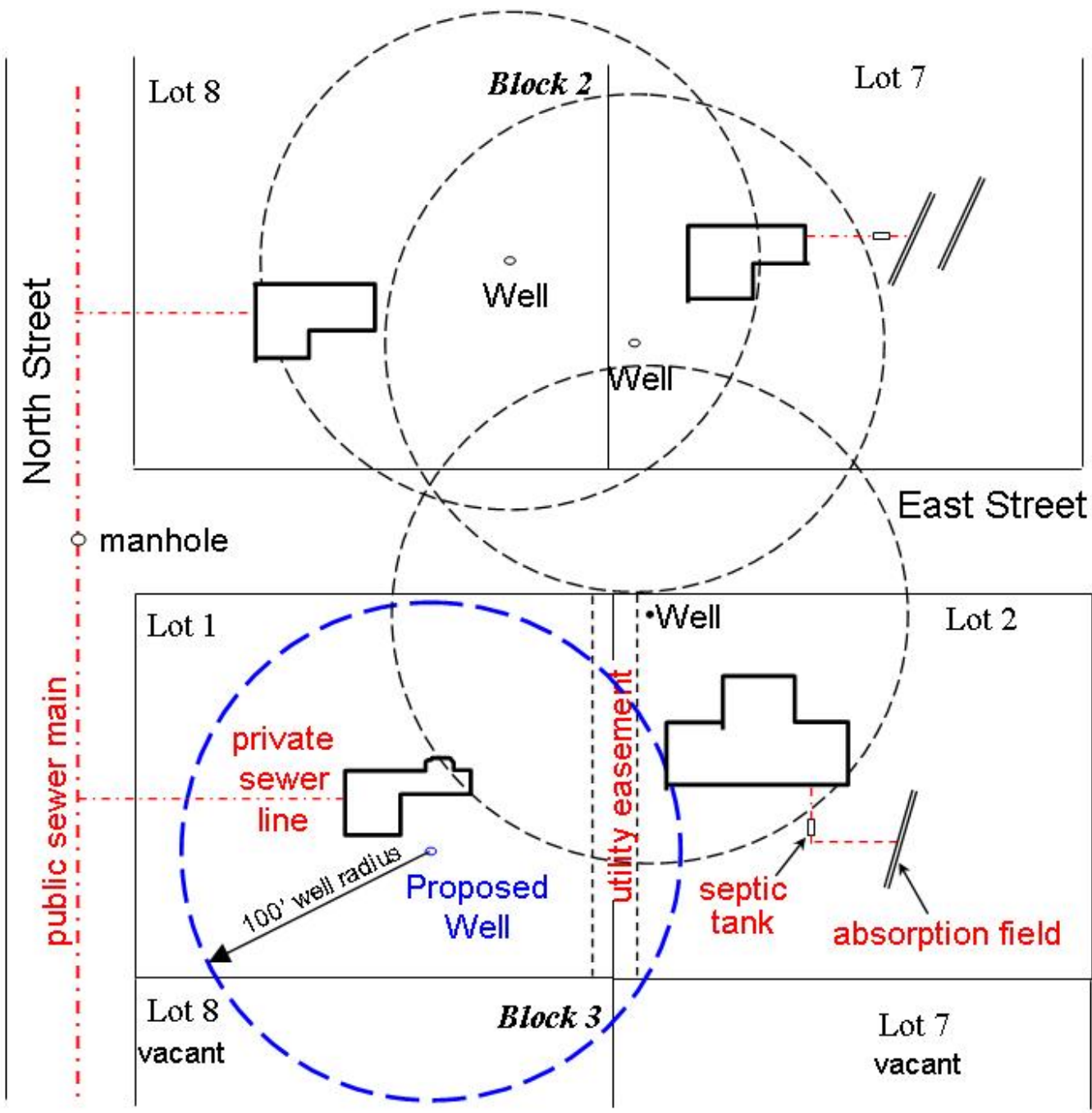

Owner's Signature